

(SUBMIT IN TRIPLICATE)

UNITED STATES
DEPARTMENT OF THE INTERIOR
GEOLOGICAL SURVEY

Indian Agency Navajo Tribal
Council

Allottee _____
Lease No. 14-20-603-2168

SUNDRY NOTICES AND REPORTS ON WELLS

RECEIVED

NOTICE OF INTENTION TO DRILL	<input checked="" type="checkbox"/>	SUBSEQUENT REPORT OF WATER SHUT-OFF	JUN 22 1960
NOTICE OF INTENTION TO CHANGE PLANS	<input type="checkbox"/>	SUBSEQUENT REPORT OF SHOOTING OR ACIDIZING	
NOTICE OF INTENTION TO TEST WATER SHUT-OFF	<input type="checkbox"/>	SUBSEQUENT REPORT OF ALTERING CASING	
NOTICE OF INTENTION TO REDRILL OR REPAIR WELL	<input type="checkbox"/>	SUBSEQUENT REPORT OF REDRILLING OR REPAIR	U. S. GEOLOGICAL SURVEY
NOTICE OF INTENTION TO SHOOT OR ACIDIZE	<input type="checkbox"/>	SUBSEQUENT REPORT OF ABANDONMENT	FARMINGTON, NEW MEXICO
NOTICE OF INTENTION TO PULL OR ALTER CASING	<input type="checkbox"/>	SUPPLEMENTARY WELL HISTORY	
NOTICE OF INTENTION TO ABANDON WELL	<input type="checkbox"/>		

(INDICATE ABOVE BY CHECK MARK NATURE OF REPORT, NOTICE, OR OTHER DATA)

June 22, 1960

Ojo Amarillo

Well No. 4 is located 1980 ft. from S line and 1980 ft. from W line of sec. 27

NE/4 SW/4 Section 27

29N

14W

NMPM

(1/4 Sec. and Sec. No.)

(Twp.)

(Range)

(Meridian)

Undesignated

San Juan

New Mexico

(Field)

(County or Subdivision)

(State or Territory)

The elevation of the derrick floor above sea level is 5707 ft.

DETAILS OF WORK

(State names of and expected depths to objective sands; show sizes, weights, and lengths of proposed casings; indicate mudlogging jobs, cementing points, and all other important proposed work)

It is intended to drill a well through the Lower Gallup Formation using rotary tools and mud circulation. Possible productive intervals will be perforated and sandall fractured.

Estimated Total Depth 5470'.

Casing Program:

9-5/8" at 160' with 125 sacks cement circulated to surface.

5-1/2" at 5470' with 200 sacks cement.

The NE/4 SW/4 of Section 27 is dedicated to this well.

NE/4 SW/4 Section 27 Navajo Tribal 14-20-603-2168



I understand that this plan of work must receive approval in writing by the Geological Survey before operations may be commenced.

Company El Paso Natural Gas Products Company

Address Post Office Box 1560

Farmington, New Mexico

ORIGINAL SIGNED BY: JOHN J. STROJEK

By

Title Petroleum Engineer

ORIGINAL SIGNED BY JOHN T. ...

NEW MEXICO OIL CONSERVATION COMMISSION

Well Location and Acreage Dedication Plat

Section A.

Date June 22, 1960

Operator El Paso Natural Gas Products Company Lease Ojo Amarillo Navajo Tribal
14-20-603-2163
Well No. 4 Unit Letter K Section 27 Township 29 North Range 14 West NMPM
Located 1980 Feet From South Line, 1980 Feet From West Line
County San Juan G. L. Elevation 5695 Dedicated Acreage 40 Acres
Name of Producing Formation Gallup Pool Undesignated

1. Is the Operator the only owner* in the dedicated acreage outlined on the plat below?
Yes X No .
2. If the answer to question one is "no," have the interests of all the owners been consolidated by communitization agreement or otherwise? Yes No . If answer is "yes,"
Type of Consolidation
3. If the answer to question two is "no," list all the owners and their respective interests below:

Owner

Land Description

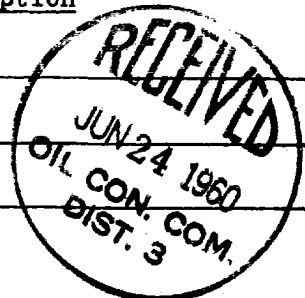

Section. B

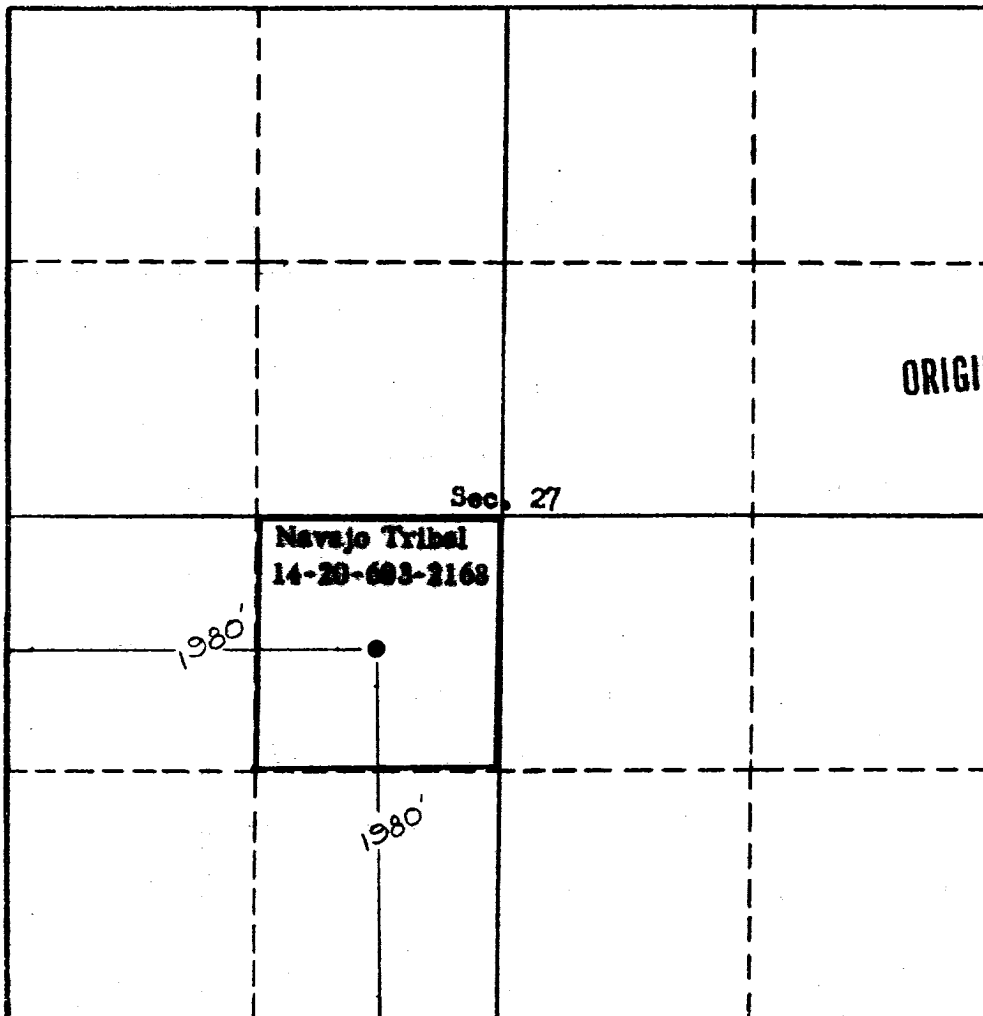

This is to certify that the information in Section A above is true and complete to the best of my knowledge and belief.

El Paso Natural Gas Products Co.

(Operator)

ORIGINAL SIGNED BY: JOHN J. STROJEK
(Representative)

Box 1560, Farmington, New Mexico

Address

This is to certify that the well location shown on the plat in Section B was taken from field notes of actual surveys made by me or under my supervision and that the same is true and correct to the best of my knowledge and belief.

Date Surveyed June 16, 1960

Ernest V. Echohawk
Ernest V. Echohawk
Registered Land Surveyor.

Certificate No. 1545

101-170-0000