

(SUBMIT IN TRIPLICATE)

Indian Agency Navajo

UNITED STATES
DEPARTMENT OF THE INTERIOR
GEOLOGICAL SURVEY

Allottee _____
Lease No. 11-20-603-2172

| | | |
|--|----|--|
| | | |
| | 25 | |
| | | |

SUNDRY NOTICES AND REPORTS ON WELLS

| | | | |
|---|-------------------------------------|--|--|
| NOTICE OF INTENTION TO DRILL | <input checked="" type="checkbox"/> | SUBSEQUENT REPORT OF WATER SHUT-OFF | |
| NOTICE OF INTENTION TO CHANGE PLANS | | SUBSEQUENT REPORT OF SHOOTING OR ACIDIZING | |
| NOTICE OF INTENTION TO TEST WATER SHUT-OFF | | SUBSEQUENT REPORT OF ALTERING CASING | |
| NOTICE OF INTENTION TO REDRILL OR REPAIR WELL | | SUBSEQUENT REPORT OF REDRILLING OR REPAIR | |
| NOTICE OF INTENTION TO SHOOT OR ACIDIZE | | SUBSEQUENT REPORT OF ABANDONMENT | |
| NOTICE OF INTENTION TO PULL OR ALTER CASING | | SUPPLEMENTARY WELL HISTORY | |
| NOTICE OF INTENTION TO ABANDON WELL | | | |

(INDICATE ABOVE BY CHECK MARK NATURE OF REPORT, NOTICE, OR OTHER DATA)

Navajo Tribe of Indians "L" _____ July 21, 19 61

Well No. 15 is located 2110 ft. from N line and 1850 ft. from E line of sec. 25

SW NE Section 25 29N 11W 11PM

(1/4 Sec. and Sec. No.) (Twp.) (Range) (Meridian)

Cha Cha Gallup San Juan New Mexico

(Field) (County or Subdivision) (State or Territory)

The elevation of the derrick floor above sea level is _____ ft. 5637' Ungraded Ground.

DETAILS OF WORK

(State names of and expected depths to objective sands; show sizes, weights, and lengths of proposed casings; indicate mudding and cementing points, and all other important proposed work)

Rotary drilling equipment will be used to drill to approximately 5400' to the Gallup Sand. Casing Program: 200' of 8-5/8" OD sals casing cemented to surface. Production String: Required amount of 4-1/2" OD sals casing cemented with required amount of cement. Howco method of cementing will be used. Mud Program: Minimum mud for samples will be used. Electric logs, etc., will be run before setting casing or abandonment. Stimulation treatments such as acidizing or fracturing may be employed in completion.

NOTE: Location moved 130' South and 130' East of true location due to nature of terrain.

I understand that this plan of work must receive approval in writing by the Geological Survey before operations may be commenced.

Company Humble Oil & Refining Company

Address P. O. Box 3062,
Durango, Colorado

By B. M. BRADLEY
Title Dist. Supt.

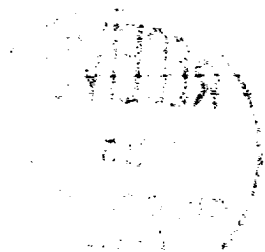

| | |
|---------------------------|-----|
| NUMBER OF COPIES RECEIVED | |
| DISTRIBUTION | |
| SANTA FE | |
| FILE | |
| U.S.C. | |
| LAND OFFICE | |
| TRANSPORTER | OIL |
| PRODUCTION OFFICE | GAS |
| OPERATOR | |

NEW MEXICO OIL CONSERVATION COMMISSION **WELL LOCATION AND ACREAGE DEDICATION PLAT**

FORM C-12F
Revised 5/1/57

SEE INSTRUCTIONS FOR COMPLETING THIS FORM ON THE REVERSE SIDE

SECTION A

| | | | | |
|--|--------------------------------------|---|--------------------------------------|---------------------------|
| Operator HUMBLE OIL & REFINING COMPANY | | Lease NAVAJO TRIBE OF INDIANS "L" LEASE | | Well No. 15 |
| Unit Letter G | Section 25 | Township 29 North | Range 14 West | County San Juan |
| Actual Footage Location of Well: 2110 feet from the North line and 1850 feet from the East line | | | | |
| Ground Level Elev. 5637 ungraded | Producing Formation Gallup | Pool Cha Cha Gallup | Dedicated Acreage 60 Acres | |

1. Is the Operator the only owner in the dedicated acreage outlined on the plat below? YES ☒ NO ☐ ("Owner" means the person who has the right to drill into and to produce from any pool and to appropriate the production either for himself or for himself and another. (65-3-29 (e) NMSA 1935 Comp.)
2. If the answer to question one is "no," have the interests of all the owners been consolidated by communization agreement or otherwise? YES ☐ NO ☐ If answer is "yes," Type of Consolidation _____
3. If the answer to question two is "no," list all the owners and their respective interests below:

| Owner | Land Description |
|-------|------------------|
| | |
| | |

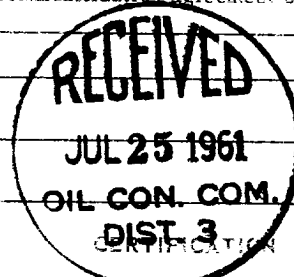

SECTION B

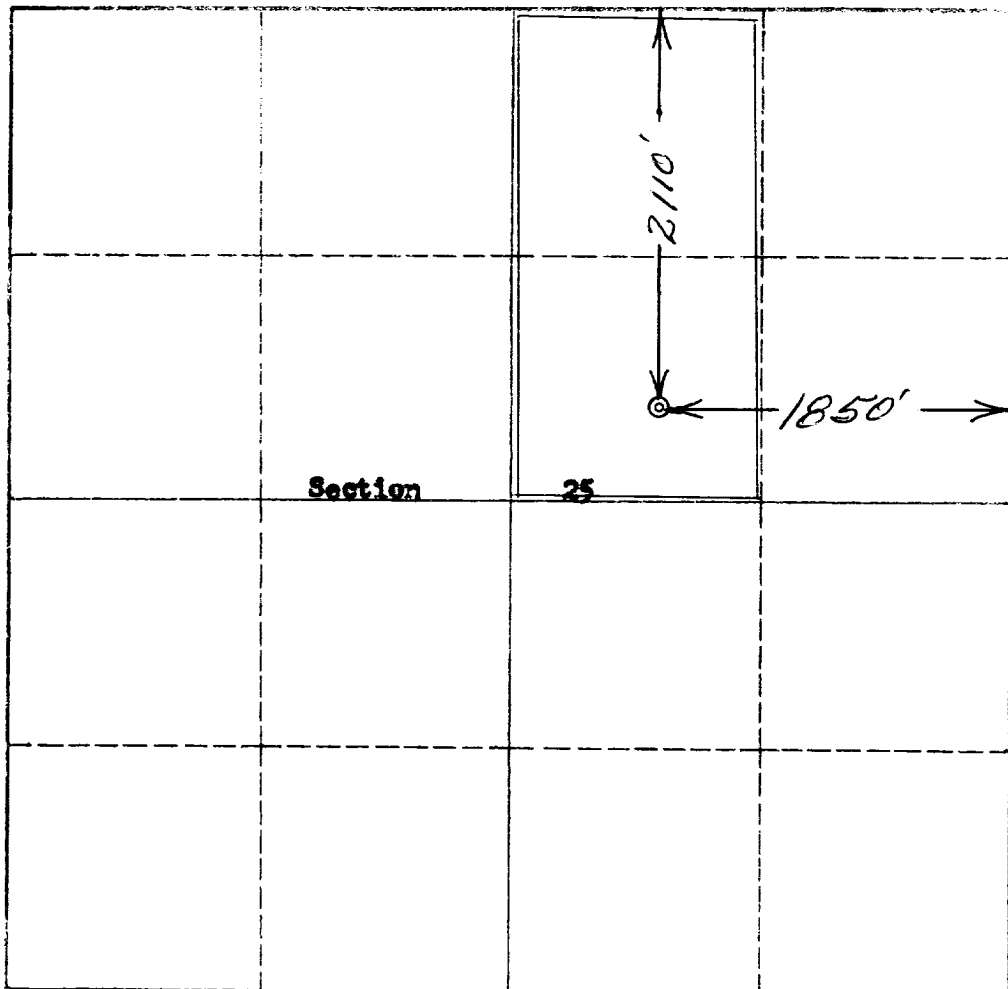

I hereby certify that the information in SECTION A above is true and complete to the best of my knowledge and belief.

| | |
|----------|--------------------------------------|
| Name | B. M. BRADLEY |
| Position | Dist. Supt. |
| Company | Humble Oil & Refining Co. |
| Date | July 21, 1961 |

I hereby certify that the well location shown on the plat in SECTION B was plotted from field notes of actual surveys made by me or under my supervision, and that the same is true and correct to the best of my knowledge and belief.

| | |
|---|---------------------------------|
| Date Surveyed | 20 July 1961 |
| Registered Professional Engineer and/or Land Surveyor | Robert H. Bradley |
| | San Juan Engineering Co. |
| Certificate No. | FE & IS 2463 |

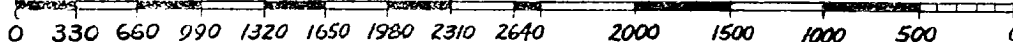

INSTRUCTIONS FOR COMPLETION OF FORM C-128

1. Operator shall furnish and certify to the information called for in Section A.
2. Operator shall outline the dedicated acreage for *both* oil and gas wells on the plat in Section B.
3. A registered professional engineer or land surveyor registered in the State of New Mexico or approved by the Commission shall show on the plat the location of the well and certify this information in the space provided.
4. All distances shown on the plat must be from the outer boundaries of the Section.
5. If additional space is needed for listing owners and their respective interests as required in question 3 of Section A, please use space below.