



**LTR**



**Job separation sheet**



NUMBER OF COPIES RECEIVED	
DISTRIBUTION	
SANTA FE	
FILE	
U.S.G.S.	2
LAND OFFICE	
TRANSPORTER	
OIL GAS	
PRODUCTION OFFICE	
OPERATOR	

NEW MEXICO OIL CONSERVATION COMMISSION  
Santa Fe, New Mexico

Form C-101  
Revised (12/1/55)

NOTICE OF INTENTION TO DRILL

Notice must be given to the District Office of the Oil Conservation Commission and approval obtained before drilling or recompletion begins. If changes in the proposed plan are considered advisable, a copy of this notice showing such changes will be returned to the sender. Submit this notice in QUINTUPLICATE. One copy will be returned following approval. See additional instructions in Rules and Regulations of the Commission. If State Land submit 6 Copies Attach Form C- 128 in triplicate to first 3 copies of form C-101

Farmington, New Mexico

June 3, 1964

OIL CONSERVATION COMMISSION  
SANTA FE, NEW MEXICO

Gentlemen:

You are hereby notified that it is our intention to commence the Drilling of a well to be known as

PAN AMERICAN PETROLEUM CORPORATION

Black Gas Unit

(Company, or Operator)

1

6

, Well No. ...., in. .... The well is

(Lease)

(Unit)

located 1190 feet from the North line and 1650 feet from the

West

line of Section 29, T. 29N, R. 10W, NMPM.

(GIVE LOCATION FROM SECTION LINE)

Basin Dakota

Pool, San Juan County

If State Land the Oil and Gas Lease is No. ....

If patented land the owner is F. L. Lawson & J. W. Wilkinson

Address Antee, New Mexico

We propose to drill well with drilling equipment as follows: Rotary - surface to total depth.

The status of plugging bond is Statewide

Drilling Contractor Brinkerhoff Drilling Co.  
870 Denver Club Bldg.  
Denver, Colorado

We intend to complete this well in the Dakota formation at an approximate depth of 6500 feet.

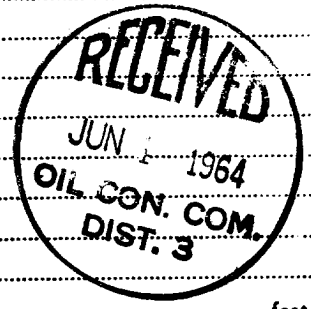

D	C	B	A
	X		
E	F	G	H
	Section 29		
L	K	J	I
M	N	O	P

CASING PROGRAM

We propose to use the following strings of Casing and to cement them as indicated:

Size of Hole	Size of Casing	Weight per Foot	New or Second Hand	Depth	Sacks Cement
12-1/4	8-5/8	24#	New	800	700
7-7/8	4-1/2	10.5#	New	6500	1500 (2-stage tool at base of Mesaverde)

If changes in the above plans become advisable we will notify you immediately.

ADDITIONAL INFORMATION (If recompletion give full details of proposed plan of work.)

Copies of location plat attached. Copies of any logs run will be submitted upon completion of well.

Approved  
Except as follows:

6-4, 1964

Sincerely yours,

PAN AMERICAN PETROLEUM CORPORATION

(Company or Operator)

By F. L. Nabers

ORIGINAL SIGNED BY F. H. HOLLINGSWORTH

Position District Engineer

Send Communications regarding well to

Name

Address

OIL CONSERVATION COMMISSION

By R. R. Kendrick

## NEW MEXICO OIL CONSERVATION COMMISSION

## Well Location and Acreage Dedication Plat

## SECTION A.

Date June 3, 1964

Operator PAN AMERICAN PETROLEUM CORPORATION Lease BLACK GAS UNIT  
 Well No. 1 Unit Letter C Section 29 Township 29 NORTH Range 10 WEST NMPM  
 Located 1190 Feet From NORTH Line, 1650 Feet From WEST Line  
 County SAN JUAN G. L. Elevation Report Later Dedicated Acreage 320 Acres  
 Name of Producing Formation Dakota Pool Basin Dakota

1. Is the Operator the only owner\* in the dedicated acreage outlined on the plat below? Yes No X  
 2. If the answer to question One is "No," have the interests of all the owners been consolidated by communitization agreement or otherwise? Yes X No        If answer is "Yes," Type of Consolidation

Declaration of Unit dated May 6, 1964.

3. If the answer to question Two is "No," list all the owners and their respective interests below:

OWNER

LAND DESCRIPTION



## SECTION B.

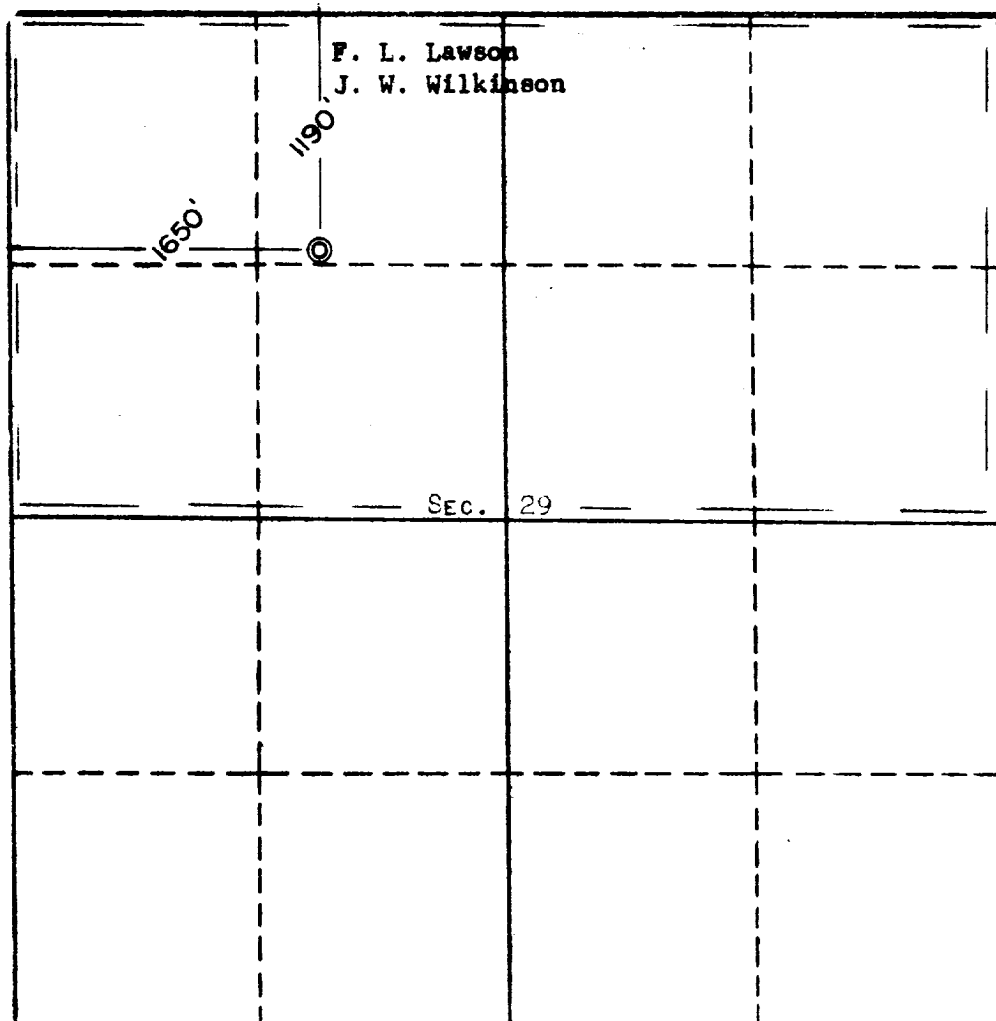

This is to certify that the information in Section A above is true and complete to the best of my knowledge and belief.

PAN AMERICAN PETROLEUM CORP.

(OPERATOR)

*F. H. Hollingsworth*

F. H. Hollingsworth

(REPRESENTATIVE)

P. O. Box 480

Farmington, New Mexico

(ADDRESS)

This is to certify that the well location shown on the plat in Section B was plotted from field notes of actual surveys made by me or under my supervision and that the same is true and correct to the best of my knowledge and belief.

Date Surveyed APRIL 16, 1964

Four States Engineering Co.

FARMINGTON, NEW MEXICO

*Edward S. Edwards*REGISTERED ENGINEER OR  
LAND SURVEYORCertificate No. 3602