

NO. OF COPIES RECEIVED	
DISTRIBUTION	
SANTA FE	
FILE	
U.S.G.S.	
LAND OFFICE	
OPERATOR	

NEW MEXICO OIL CONSERVATION COMMISSION

Form C-103
Supersedes Old
C-102 and C-103
Effective 1-1-65

SUNDRY NOTICES AND REPORTS ON WELLS

(DO NOT USE THIS FORM FOR PROPOSALS TO DRILL OR TO DEEPEN OR PLUG BACK TO A DIFFERENT RESERVOIR.
USE "APPLICATION FOR PERMIT -" (FORM C-101) FOR SUCH PROPOSALS.)

1. <input type="checkbox"/> OIL WELL <input checked="" type="checkbox"/> GAS WELL <input type="checkbox"/> OTHER		5a. Indicate Type of Lease State <input type="checkbox"/> Fee <input checked="" type="checkbox"/>
2. Name of Operator Tenneco Oil Company		5. State Oil & Gas Lease No.
3. Address of Operator 720 So. Colorado Blvd., Denver, Colorado 80222		7. Unit Agreement Name
4. Location of Well UNIT LETTER <u>B</u> <u>1020</u> FEET FROM THE <u>North</u> LINE AND <u>1450</u> FEET FROM <u>East</u> LINE, SECTION <u>25</u> TOWNSHIP <u>29N</u> RANGE <u>11W</u> NMPM.		8. Farm or Lease Name Marquis G. Eaton Gas Unit <u>A</u>
		9. Well No. 1E
		10. Field and Pool, or Wildcat Basin Undes. Bloomfield Dakota M.V. Chacra
15. Elevation (Show whether DF, RT, GR, etc.) 5458 GR		12. County San Juan

16. Check Appropriate Box To Indicate Nature of Notice, Report or Other Data

NOTICE OF INTENTION TO:

SUBSEQUENT REPORT OF:

PERFORM REMEDIAL WORK <input type="checkbox"/>	PLUG AND ABANDON <input type="checkbox"/>	REMEDIAL WORK <input type="checkbox"/>	ALTERING CASING <input type="checkbox"/>
TEMPORARILY ABANDON <input type="checkbox"/>		COMMENCE DRILLING OPNS. <input type="checkbox"/>	PLUG AND ABANDONMENT <input type="checkbox"/>
PULL OR ALTER CASING <input type="checkbox"/>	CHANGE PLANS <input type="checkbox"/>	CASING TEST AND CEMENT JOB <input type="checkbox"/>	
OTHER <u>move location</u> <input type="checkbox"/>		OTHER <input type="checkbox"/>	

17. Describe Proposed or Completed Operations (Clearly state all pertinent details, and give pertinent dates, including estimated date of starting any proposed work) SEE RULE 1103.

Request permission to move location from 990 FEL to above referenced location.



18. I hereby certify that the information above is true and complete to the best of my knowledge and belief.

SIGNED M.L. Freeman M.L. Freeman TITLE Staff Production Analyst DATE July 25, 1980

APPROVED BY Original Signed by FRANK T. CHAVEZ TITLE SUPERVISOR DISTRICT #3 DATE JUL 26 1980

CONDITIONS OF APPROVAL, IF ANY:

OIL CONSERVATION DIVISION

P. O. BOX 2088

SANTA FE, NEW MEXICO 87501

Form C-107
Revised 10-1-78

STATE OF NEW MEXICO

ENERGY AND MINERALS DEPARTMENT

All distances must be from the outer boundaries of the Section.

Operator TENNECO OIL COMPANY			Lease MARQUIS G. EATON GAS UNIT "A"		Well No. 1E
Unit Letter B	Section 25	Township 29N	Range 11W	County San Juan	
Actual Footage Location of Well:					
1020 feet from the North line and		1450 feet from the East line			
Ground Level Elev: 5458	Producing Formation Dakota/M.V./Chacra	Pool Basin Dakota	Undes. M.V.	Bloomfield Chacra	Dedicated Acreage: 320/160/160 Acres
<p>1. Outline the acreage dedicated to the subject well by colored pencil or hatchure marks on the plat below.</p> <p>2. If more than one lease is dedicated to the well, outline each and identify the ownership thereof (both as to working interest and royalty).</p> <p>3. If more than one lease of different ownership is dedicated to the well, have the interests of all owners been consolidated by communitization, unitization, force-pooling, etc?</p> <p><input checked="" type="checkbox"/> Yes <input type="checkbox"/> No If answer is "yes," type of consolidation <u>communitization in progress</u></p> <p>If answer is "no," list the owners and tract descriptions which have actually been consolidated. (Use reverse side of this form if necessary.) _____</p> <p>No allowable will be assigned to the well until all interests have been consolidated (by communitization, unitization, forced-pooling, or otherwise) or until a non-standard unit, eliminating such interests, has been approved by the Commission.</p>					

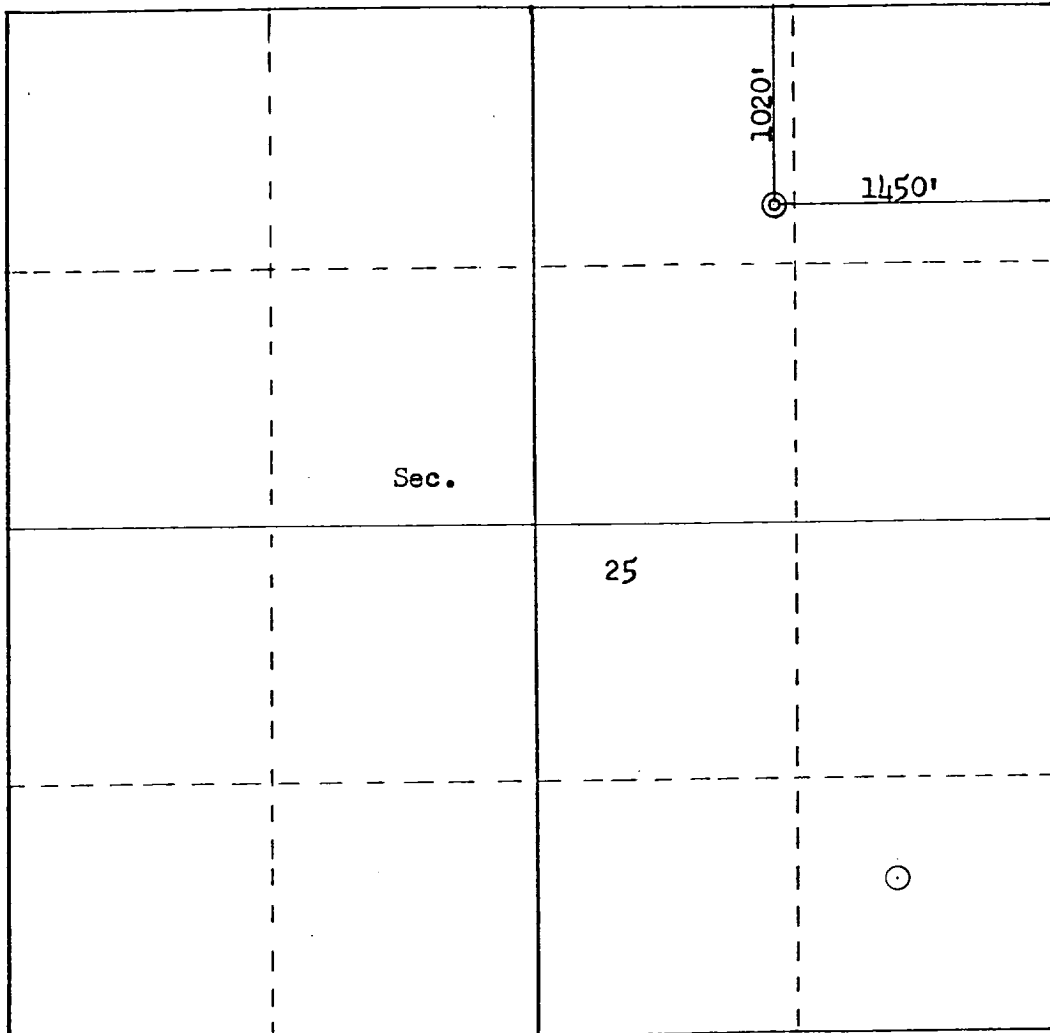

Scale: 1"=1000'

CERTIFICATION	
I hereby certify that the information contained herein is true and complete to the best of my knowledge and belief.	
Name	<i>M. L. Freeman</i> M. L. Freeman
Position	Staff Production Analyst
Company	Tenneco Oil Company
Date	July 25, 1980
<p>I hereby certify that the well location shown on this plat was plotted from field notes of actual surveys made by me or under my supervision, and that the same is true and correct to the best of my knowledge and belief.</p>	
Date Surveyed	July 22, 1980
Registered Professional Engineer and Land Surveyor <i>Fred B. Kerr Jr.</i> Fred B. Kerr Jr.	
Certificate No.	3950