

STATE OF NEW MEXICO  
OIL CONSERVATION  
COMMISSION  
DISTRICT NO. 3  
Phone 99 P. O. Box 697  
AZTEC, NEW MEXICO

(SUBMIT IN TRIPLICATE)  
UNITED STATES  
DEPARTMENT OF THE INTERIOR  
GEOLOGICAL SURVEY

SANTA FE  
Land Office 657028-6  
Lease SW 1/4 Sec. 27  
Unit T-29-N., R-11-W., S-11-N.



SUNDRY NOTICES AND REPORTS ON WELLS

NOTICE OF INTENTION TO DRILL	SUBSEQUENT REPORT OF WATER SHUT-OFF
NOTICE OF INTENTION TO CHANGE PLANS	SUBSEQUENT REPORT OF SHOOTING OR ACIDIZING
NOTICE OF INTENTION TO TEST WATER SHUT-OFF	SUBSEQUENT REPORT OF ALTERING CASING
NOTICE OF INTENTION TO RE-DRILL OR REPAIR WELL	SUBSEQUENT REPORT OF REDRILLING OR REPAIR
NOTICE OF INTENTION TO SHOOT OR ACIDIZE	SUBSEQUENT REPORT OF ABANDONMENT
NOTICE OF INTENTION TO PULL OR ALTER CASING	SUPPLEMENTARY WELL HISTORY
NOTICE OF INTENTION TO ABANDON WELL	

(INDICATE ABOVE BY CHECK MARK NATURE OF REPORT, NOTICE, OR OTHER DATA)

November 2

21

19

Well No. 1 Garland is located 990 ft. from NE line and 990 ft. from EW line of sec. 27  
SW 1/4 Sec. 27 T-29-N., R-11-W N.M.P.M.  
Palmer (Field) San Juan County (County or Subdivision) New Mexico (State or Territory)

- To be furnished

The elevation of the derrick floor above sea level is \_\_\_\_\_ ft.

DETAILS OF WORK

(State names of and expected depths to objective sands; show sizes, weights, and lengths of proposed casings; indicate mudding jobs, cementing points, and all other important proposed work)

The objective sand is the Pictured Cliffs. The top is expected at about 1700'.  
The producing string will be 5 1/2" O.D. casing which will be cemented.

Approximate Casing Program:

160' of 8-5/8" O.D. cemented

1700' of 5 1/2" O. D. cemented with about 100 sacks

Well will be drilled with rotary tools to top of Pictured Cliffs sand, 5 1/2" O.D. casing set and well drilled into pay zone with cable tools. The well will then be shot with approximately 170 quarts of nitro glycerine.

I understand that this plan of work must receive approval in writing by the Geological Survey before operations may be commenced.

COMMONS OIL COMPANY

Company \_\_\_\_\_

Address 1104 Bart Building

Dallas 1, Texas

By Van Thompson  
Manager, Exploration Dept.  
Title \_\_\_\_\_

UNITED STATES  
DEPARTMENT OF THE INTERIOR  
GEOLOGICAL SURVEY

1941 5 NOV 2  
MCP 400 JIO

	SUBSEQUENT REPORT OF ABANDON WELL	
	INTENTION TO PULL OR ALTER CASING	
	INTENTION TO SHOOT OR ACIDIZE	
	INTENTION TO RE-DRILL OR REPAIR WELL	
	INTENTION TO TEST WATER SHUT-OFF	
	INTENTION TO CHANGE PLAN	
	NOTICE OF INTENTION TO DRILL	
	SUPPLEMENTARY WELL HISTORY	
	SUBSEQUENT REPORT OF A FINDMENT	
	SUBSEQUENT REPORT OF PROBLEMS IN REPAIR	
	SUBSEQUENT REPORT OF ALTHOUGH OPERATING	
	SUBSEQUENT REPORT ON SAVING UP ADDITIONAL	
	SUBSEQUENT REPORT OF WATER SHORTAGE	

DIST 3

INDICATE ABOVE BY CHECKING THE NATURE OF REPORT: ( )

01

is located at \_\_\_\_\_ from \_\_\_\_\_ line and \_\_\_\_\_

(1960)

The elevation of the derrick floor above sea level is \_\_\_\_\_.

## HOW TO ENJOY

1. The first of these is the fact that the Commission has not yet received any information from the Government of the United States regarding the activities of the Committee for the Liberation of the Americas (CLA) in the United States. The Commission is therefore unable to determine whether the CLA is a legitimate organization or a subversive one.

2. The second of these is the fact that the Commission has not yet received any information from the Government of the United States regarding the activities of the Committee for the Liberation of the Americas (CLA) in the United States. The Commission is therefore unable to determine whether the CLA is a legitimate organization or a subversive one.

3. The third of these is the fact that the Commission has not yet received any information from the Government of the United States regarding the activities of the Committee for the Liberation of the Americas (CLA) in the United States. The Commission is therefore unable to determine whether the CLA is a legitimate organization or a subversive one.

4. The fourth of these is the fact that the Commission has not yet received any information from the Government of the United States regarding the activities of the Committee for the Liberation of the Americas (CLA) in the United States. The Commission is therefore unable to determine whether the CLA is a legitimate organization or a subversive one.

5. The fifth of these is the fact that the Commission has not yet received any information from the Government of the United States regarding the activities of the Committee for the Liberation of the Americas (CLA) in the United States. The Commission is therefore unable to determine whether the CLA is a legitimate organization or a subversive one.

6. The sixth of these is the fact that the Commission has not yet received any information from the Government of the United States regarding the activities of the Committee for the Liberation of the Americas (CLA) in the United States. The Commission is therefore unable to determine whether the CLA is a legitimate organization or a subversive one.

7. The seventh of these is the fact that the Commission has not yet received any information from the Government of the United States regarding the activities of the Committee for the Liberation of the Americas (CLA) in the United States. The Commission is therefore unable to determine whether the CLA is a legitimate organization or a subversive one.

8. The eighth of these is the fact that the Commission has not yet received any information from the Government of the United States regarding the activities of the Committee for the Liberation of the Americas (CLA) in the United States. The Commission is therefore unable to determine whether the CLA is a legitimate organization or a subversive one.

9. The ninth of these is the fact that the Commission has not yet received any information from the Government of the United States regarding the activities of the Committee for the Liberation of the Americas (CLA) in the United States. The Commission is therefore unable to determine whether the CLA is a legitimate organization or a subversive one.

10. The tenth of these is the fact that the Commission has not yet received any information from the Government of the United States regarding the activities of the Committee for the Liberation of the Americas (CLA) in the United States. The Commission is therefore unable to determine whether the CLA is a legitimate organization or a subversive one.

I understood that this plan of work would receive a

30295

Asqur

100-443887-100



Company **CONGRESS OIL COMPANY**  
Lease **Garland** Well No. **1**  
Sec. **27** T. **29 N.**, R. **11 W.**, N.M.P.M.  
Location **990' from the South line and 990' from the West line.**

San Juan County

New Mexico

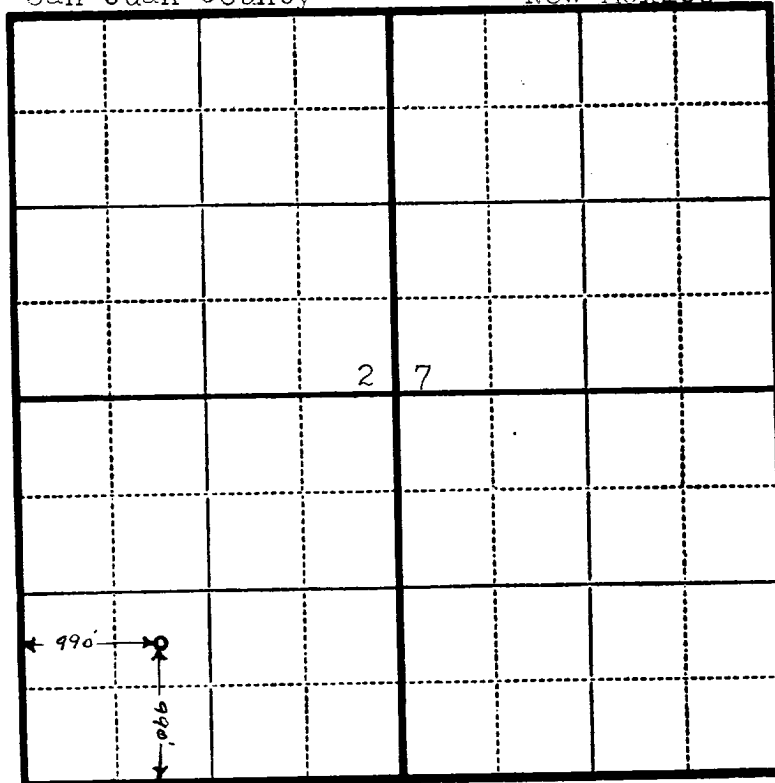

Scale—4 inches equals 1 mile.

This is to certify that the above plat was prepared from field notes of actual surveys made by me or under my supervision and that the same are true and correct to the best of my knowledge and belief.

*Charles J. Finkler*

Seal:

Registered Professional Charles J. Finkler  
Engineer and Land Surveyor. N. Mex. Reg. No. 1302

Surveyed October 29, 1951