

NEW MEXICO OIL CONSERVATION COMMISSION  
Santa Fe, New Mexico

Form C-101  
Revised (12/1/55)

# NOTICE OF INTENTION TO DRILL

Notice must be given to the District Office of the Oil Conservation Commission and approval obtained before drilling or recompletion begins. If changes in the proposed plan are considered advisable, a copy of this notice showing such changes will be returned to the sender. Submit this notice in **QUINTUPPLICATE**. One copy will be returned following approval. See additional instructions in Rules and Regulations of the Commission. If State Land submit 6 Copies Attach Form C-128 in triplicate to first 3 copies of form C-101

**Farmington, New Mexico**

(Place)

**October 11, 1957**

(Date)

OIL CONSERVATION COMMISSION  
SANTA FE, NEW MEXICO

**VERBAL APPROVAL RECEIVED FROM EMERY C. ARNOLD, N.M.O.C.C.  
10/11/57.**

Gentlemen:

You are hereby notified that it is our intention to commence the Drilling of a well to be known as

**Pan American Petroleum Corporation**

(Company or Operator)

**Sanchez Gas Unit**

(Lease)

Well No. **1**

in **B**

(Unit)

located **790** feet from the **North** line and **1490** feet from the **East** line of Section **28**, T **29N**, R **10W**, NMPM.

(GIVE LOCATION FROM SECTION LINE)

**Astee-Pictured Cliffs** Pool, **San Juan** County

D	C	B	A
E	F	G	H
L	K	J	I
M	N	O	P

**Section 28**

If State Land the Oil and Gas Lease is No.

If patented land the owner is **Polita Sanchez**

Address **Blanco New Mexico**

We propose to drill well with drilling equipment as follows: **Rotary tools to total depth.**

The status of plugging bond is.

Drilling Contractor **Brannon & Marray Drilling Company**  
**Box 672, Coleman, Texas**

We intend to complete this well in the **Pictured Cliffs** formation at an approximate depth of **2100'**

## CASING PROGRAM

We propose to use the following strings of Casing and to cement them as indicated:

Size of Hole	Size of Casing	Weight per Foot	New or Second Hand	Depth	Sacks Cement
<b>11"</b>	<b>8-5/8"</b>	<b>22.7#</b>	<b>New</b>	<b>250'</b>	<b>125</b>
<b>7-7/8"</b>	<b>5-1/2"</b>	<b>14#</b>	<b>New</b>	<b>2100'</b>	<b>100</b>

If changes in the above plans become advisable we will notify you immediately.

ADDITIONAL INFORMATION (If recompletion give full details of proposed plan of work.)

We propose to drill the above well to approximately **2100'** and complete the **Pictured Cliffs** zone. Stimulation will be indicated upon reaching this depth. Copies of location plat are attached. Copies of electrical logs will be forwarded upon completion of well.

Approved  
Except as follows:

Sincerely yours,

**Pan American Petroleum Corporation**

ORIGINAL SIGNED BY (Company or Operator)

By **L. O. Speer, Jr.**

Position **Field Superintendent**

Send Communications regarding well to

Name **Pan American Petroleum Corporation**

Address **Box 487, Farmington, New Mexico**

OIL CONSERVATION COMMISSION

By **A. R. Landrick**

## NEW MEXICO OIL CONSERVATION COMMISSION

## Well Location and Acreage Dedication Plat

Section A.

Date October 11, 1957

Operator PAN AMERICAN PETROLEUM CORPORATION Lease  
 Well No. 1 Unit Letter B Section 28  
 Located 790 Feet From the NORTH Line, 1490  
 County SAN JUAN G. L. Elevation \*  
 Name of Producing Formation Pictured Cliffs

SANCHEZ GAS UNIT  
 Township 29 NORTH Range 10 WEST, NMPM  
 Feet From the EAST Line  
 Dedicated Acreage 160 Acres  
 Pool Aztec-Pictured Cliffs

1. Is the Operator the only owner in the dedicated acreage outlined on the plat below?  
 Yes ☒ No ☐
2. If the answer to question one is "no", have the interests of all the owners been consolidated by communitization agreement or otherwise? Yes ☐ No ☐ If answer is "yes", Type of Consolidation.

3. If the answer to question two is "no", list all the owners and their respective interests below:

Owner

Land Description

\*To be reported later.



Section B.

This is to certify that the information in Section A above is true and complete to the best of my knowledge and belief.

PAN AMERICAN PETROLEUM CORPORATION  
 (Operator)  
R. M. Bauer, Jr., Field Engineer  
 (Representative)  
Box 487, Farmington, New Mexico  
 (Address)

*RMBauer Jr.*

Note: All distances must be from outer boundaries of section.

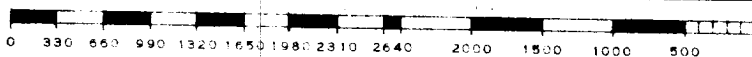
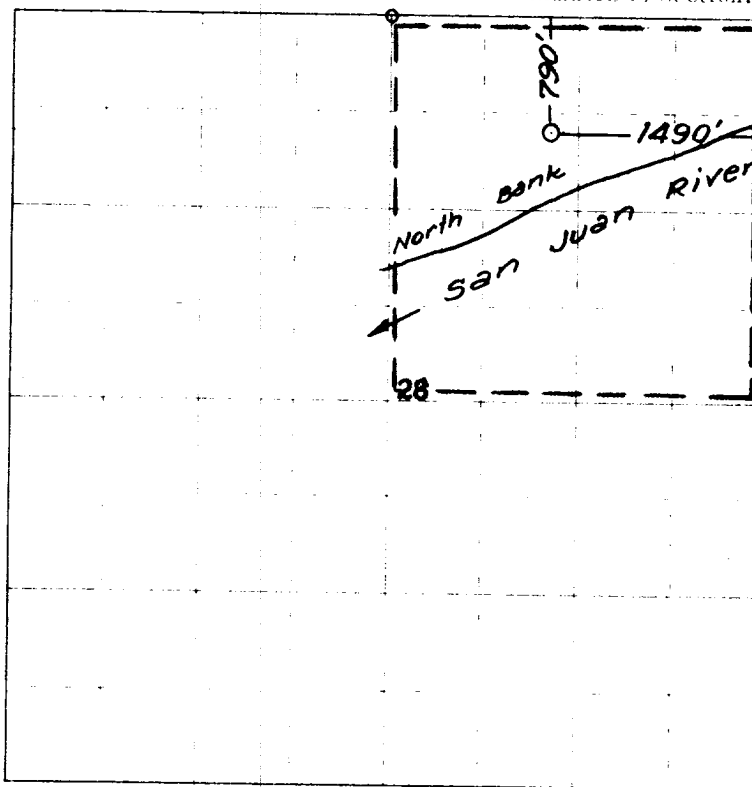

Scale 4 inches equal 1 mile

This is to certify that the above plat was prepared from field notes of actual surveys made by me or under my supervision and that the same are true and correct to the best of my knowledge and belief.

Date Surveyed 2 OCTOBER 1957

*James P. Leese*  
 Registered Professional Engineer and/or Land Surveyor  
JAMES P. LEESE N. MEY. REG. NO. 2442



**OIL CONSERVATION COMMISSION**

**AZTEC DISTRICT OFFICE**

No. Copies Received 5

**DISTRIBUTION**

	No. Copies	Remarks
Operator	1	
Santa Fe	1	
Peroration Office		
State Land Office		
U. S. G. S.	2	
Transporter		
File	1	✓