

## NEW MEXICO OIL CONSERVATION COMMISSION

## Well Location and Acreage Dedication Plat

## SECTION A.

Date January 16, 1961

Operator Astec Oil and Gas Company Lease Hagood  
 Well No. 17-0 Unit Letter C Section 29 Township 29N Range 13W NMPM  
 Located 880 Feet From North Line, 2300 Feet From West Line  
 County San Juan G. L. Elevation 5734 Dedicated Acreage 40 Acres  
 Name of Producing Formation  Gallup  Pool  Totah

1. Is the Operator the only owner\* in the dedicated acreage outlined on the plat below? Yes xxx No \_\_\_\_\_
2. If the answer to question One is "No," have the interests of all the owners been consolidated by communitization agreement or otherwise? Yes \_\_\_\_\_ No \_\_\_\_\_. If answer is "Yes," Type of Consolidation \_\_\_\_\_
3. If the answer to question Two is "No," list all the owners and their respective interests below:

OWNER

LAND DESCRIPTION

## SECTION B.

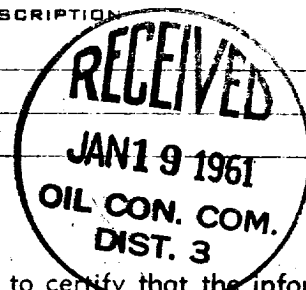
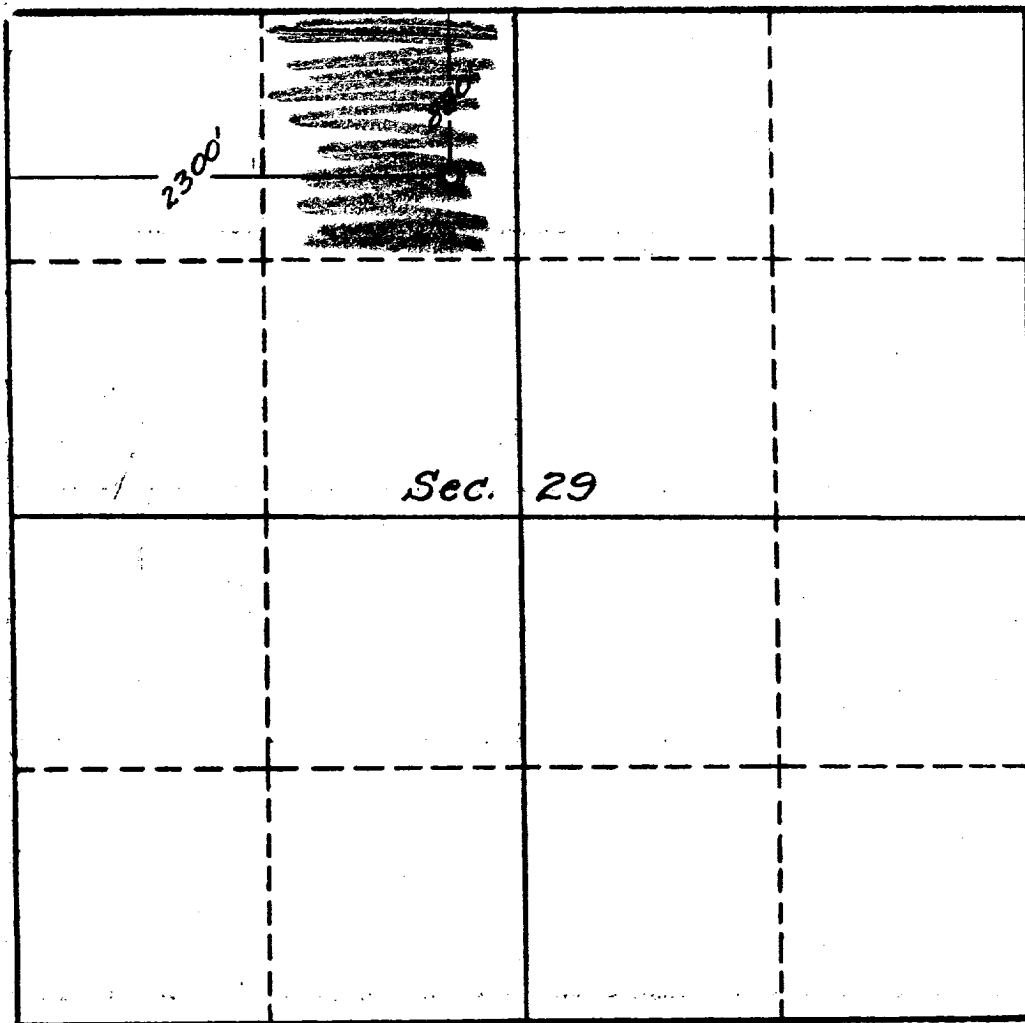

This is to certify that the information in Section A above is true and complete to the best of my knowledge and belief.

Astec Oil and Gas Company  
 (OPERATOR)

ORIGINAL SIGNED BY JOE C. SALMON  
 (REPRESENTATIVE)

Drawer 570, Farmington, N.M.  
 (ADDRESS)

This is to certify that the well location shown on the plat in Section B was plotted from field notes of actual surveys made by me or under my supervision and that the same is true and correct to the best of my knowledge and belief.

Date Surveyed 1-13-61

Four States Engineering Co.  
 FARMINGTON, NEW MEXICO

E. N. Edwards  
 REGISTERED ENGINEER OR  
 LAND SURVEYOR

Certificate No. 1545

