

NEW MEXICO OIL CONSERVATION COMMISSION

Santa Fe, New Mexico

NOTICE OF INTENTION TO DRILL OR RECOMPLETE

Notice must be given to the District Office of the Oil Conservation Commission and approval obtained before drilling or recompletion begins. If changes in the proposed plan are considered advisable, a copy of this notice showing such changes will be returned to the sender. Submit this notice in QUINTUPPLICATE. One copy will be returned following approval. See additional instructions in Rules and Regulations of the Commission. If State Land submit 6 Copies

Farmington, New Mexico

(Place)

5/1

March 29, 1957

(Date)

OIL CONSERVATION COMMISSION
SANTA FE, NEW MEXICO

TOP OF OJO
795 - 935'

Gentlemen:

You are hereby notified that it is our intention to commence the (Drilling) (~~Recompletion~~) of a well to be known as

PAN AMERICAN PETROLEUM CORPORATION

(Company or Operator)

Leftovitz Gas Unit

(Lease)

Well No. **1**, in **A** (Unit) The well is

located **790'** feet from the **North** line and **790'** feet from the

East

line of Section **25**, T. **29N**, R. **10W**, NMPM.

(GIVE LOCATION FROM SECTION LINE) **Antee-Pictured Cliffs** Pool, **San Juan** County

If State Land the Oil and Gas Lease is No.

If patented land the owner is **Gladys Leftovitz**

Address **891 East Blanchard, El Paso, Texas**

We propose to drill well with drilling equipment as follows:

Rotary tools to total depth

The status of plugging bond is

Drilling Contractor **Sage Drilling Company**

Box 788

San Angelo, Texas

We intend to complete this well in the **Pictured Cliffs**

formation at an approximate depth of **2020** feet.

CASING PROGRAM

We propose to use the following strings of Casing and to cement them as indicated:

Size of Hole	Size of Casing	Weight per Foot	New or Second Hand	Depth	Sacks Cement
12-1/4	9-5/8"	36#	New	200	150
7-7/8	5-1/2"	14#	"	2020	100

If changes in the above plans become advisable we will notify you immediately.

ADDITIONAL INFORMATION (If recompletion give full details of proposed plan of work.)

Plan to perforate opposite well developed sand in Pictured Cliffs and stimulate by sand-water fracking with 20,000 gallons water and 30,000 pounds sand.

Approved 4-1, 1957
Except as follows:

Sincerely yours,

PAN AMERICAN PETROLEUM CORPORATION

(Company or Operator)

By Shall

Position **Field Clerk**

Send Communications regarding well to

Name **L. O. Speer, Jr.**

Address **Box 467 Farmington, New Mexico**

OIL CONSERVATION COMMISSION

By Emery C. [Signature]

OIL CONSERVATION COMMISSION

WELL LOCATION AND/OR GAS PRORATION PLAT

DATE March 29, 1957OPERATOR STANOLIND OIL AND GAS CO. LEASE LEFKOVITZ GAS UNITWELL NO. 1 SECTION 25 TOWNSHIP 29 NORTH RANGE 10 WEST NMPNLOCATED 790 FEET FROM THE NORTH LINE 790 FEET FROM THE EAST LINESAN JUAN COUNTY, NEW MEXICO ELEVATION to be reported laterNAME OF PROPERTY OR PLAT Pictured Cliffs Astee-Pictured
CLIFFS DEDICATED ACREAGE 160

Note: All distances must be from outer boundaries of section.

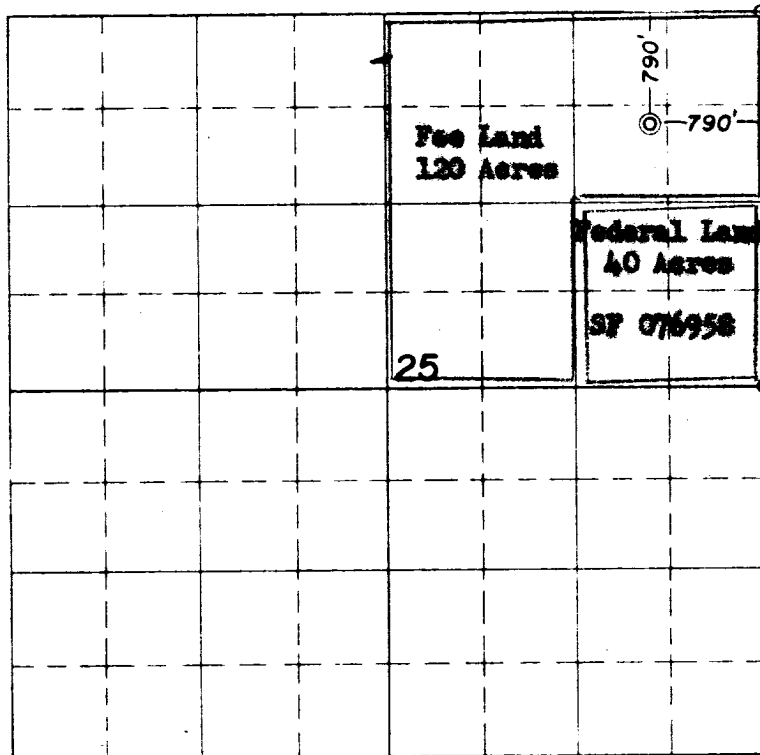
Section Corner
Brasscap 1953

Acres

Gladys Lefkovits - 40
Geo. F. Bruington - 53
David J. McDaniel - 27
120



NOTE

This section of
form is to be used
for gas wells only

Scale 1 inch equals 1 mile

This is to certify that the above plat was prepared from
field notes of actual surveys made by me or under my
supervision and that the same are true and correct to the
best of my knowledge and belief.

Date Surveyed 21 NOVEMBER 1956.

James C. Leese
Registered Professional Engineer and/or Land Surveyor

1. Is this well a Dual Comp.

Yes _____ No X

2. If the answer to Question 1

is yes, are there any other dually
completed wells within the
dedicated acreage.

Yes _____ No X
R. M. Bauer, Jr.

Name R. M. Bauer, Jr.Position Field Engineer

Pan American Petroleum Corporation
Representing _____

Box 487, Farmington, New Mexico
Address _____

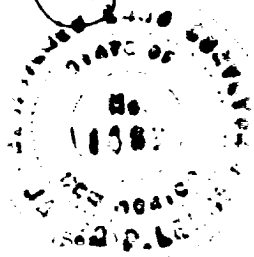

OIL CONSERVATION COMMISSION		
AZTEC DISTRICT OFFICE		
No. Copies Received <u>2</u>		
DISTRIBUTION		
	NO. FURNISHED	
Operator	<u>1</u>	
Santa Fe	<u>1</u>	
Proration Office		
State Land Office		
U. S. G. S.	<u>2</u>	
Transporter		
File	<u>1</u>	<input checked="" type="checkbox"/>