

(SUBMIT IN TRIPLICATE)

Indian Agency Navajo Tribal

UNITED STATES
DEPARTMENT OF THE INTERIOR
GEOLOGICAL SURVEY

Allottee _____
Lease No. 14-20-603-2168

X		

SUNDRY NOTICES AND REPORTS ON WELLS

NOTICE OF INTENTION TO DRILL	X	SUBSEQUENT REPORT OF WATER SHUT-OFF	RECEIVED
NOTICE OF INTENTION TO CHANGE PLANS		SUBSEQUENT REPORT OF SHOOTING OR ACIDIZING	
NOTICE OF INTENTION TO TEST WATER SHUT-OFF		SUBSEQUENT REPORT OF ALTERING CASING	
NOTICE OF INTENTION TO REDRILL OR REPAIR WELL		SUBSEQUENT REPORT OF REDRILLING OR REPAIR	MAY 1 1960
NOTICE OF INTENTION TO SHOOT OR ACIDIZE		SUBSEQUENT REPORT OF ABANDONMENT	
NOTICE OF INTENTION TO PULL OR ALTER CASING		SUPPLEMENTARY WELL HISTORY	U. S. GEOLOGICAL SURVEY WASHINGTON, NEW MEXICO
NOTICE OF INTENTION TO ABANDON WELL			

(INDICATE ABOVE BY CHECK MARK NATURE OF REPORT, NOTICE, OR OTHER DATA)

VERBAL APPROVAL RECEIVED MAY 14, 1960

May 16, 1960

Ojo Amarillo
Well No. 2 is located 660 ft. from N line and 1980 ft. from W line of sec. 27
NE/4 NW/4 Section 27 29N 14W NMPM
(1/4 Sec. and Sec. No.) (Twp.) (Range) (Meridian)
Undesignated San Juan New Mexico
(Field) (County or Subdivision) (State or Territory)

The elevation of the derrick floor above sea level is 5675 ft.

DETAILS OF WORK

(State names of and expected depths to objective sands; show sizes, weights, and lengths of proposed casings; indicate mudding jobs, cementing points, and all other important proposed work)

It is intended to drill a well through the Lower-Gallup Formation using rotary tools and mud circulation. Possible productive intervals will be perforated and sandoil fractured. Estimated Total Depth 5400'.

Casing Program:

9-5/8" at 160' with 125 sacks cement circulated to surface
5-1/2" at 5400' with 200 sacks cement.

The NE/4 NW/4 of Section 27 is dedicated to this well.

NE/4 NW/4 Section 27 Navajo Tribal 14-20-603-2168

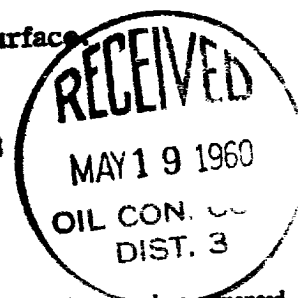

I understand that this plan of work must receive approval in writing by the Geological Survey before operations may be commenced.

Company El Paso Natural Gas Products Company

Address Post Office Box 1565
Farmington, New Mexico

By EWELL N. WALSH

Title Petroleum Engineer

6-10-10-10



WASH. D.C.

NEW MEXICO OIL CONSERVATION COMMISSION

Well Location and Acreage Dedication Plat

Section A.

Date May 15, 1960
Navajo Tribal
14-20-603-2168

Operator El Paso Natural Gas Products Company Lease Ojo Amarillo
Well No. 2 Unit Letter C Section 27 Township 29 North Range 14 West NMPM
Located 660 Feet From North Line, 1980 Feet From West Line
County San Juan G. L. Elevation 5664 Dedicated Acreage 40 Acres
Name of Producing Formation Lower Gila Pool Undesignated

1. Is the Operator the only owner* in the dedicated acreage outlined on the plat below?
Yes X No .
2. If the answer to question one is "no," have the interests of all the owners been consolidated by communitization agreement or otherwise? Yes No . If answer is "yes,"
Type of Consolidation
3. If the answer to question two is "no," list all the owners and their respective interests below:

Owner

Land Description

Section. B

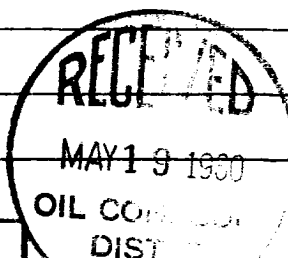
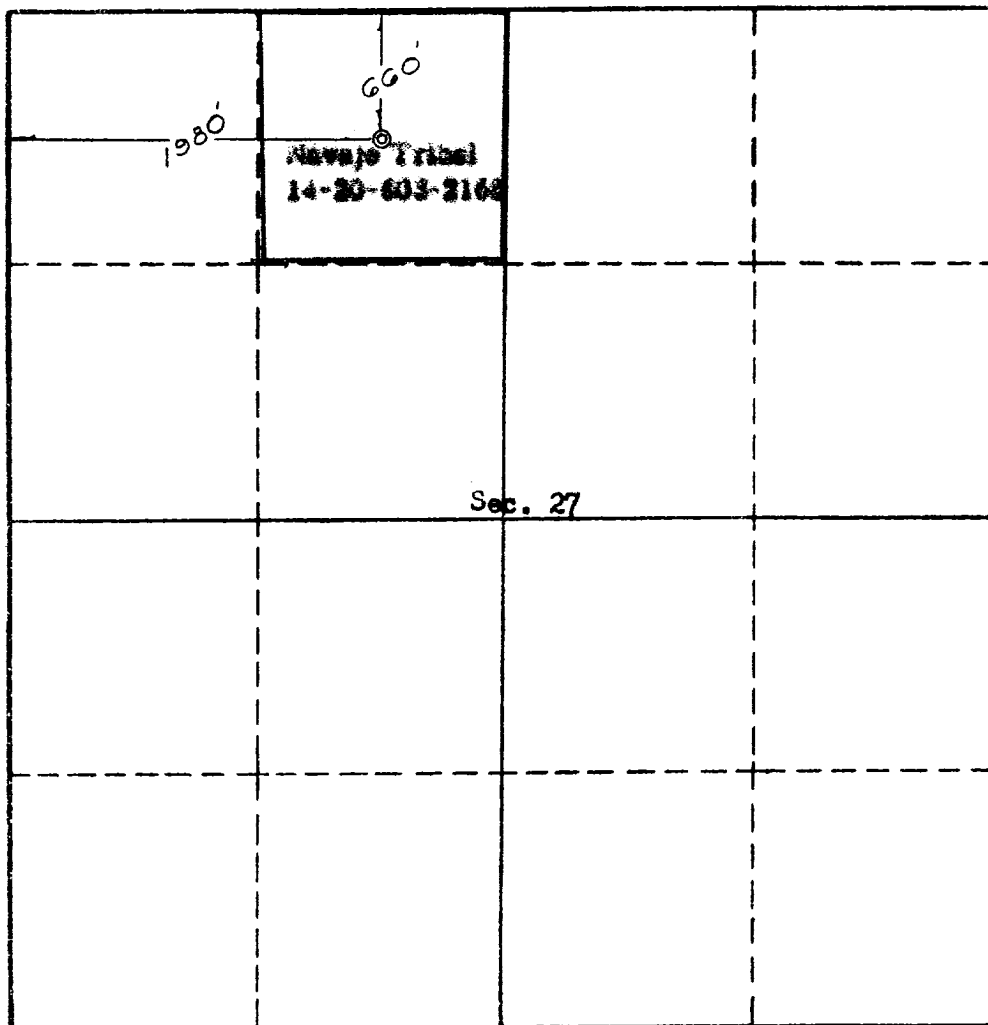

This is to certify that the information in Section A above is true and complete to the best of my knowledge and belief.

El Paso Natural Gas Products Co.

(Operator)

Original Signed EWELL N. WALSH

(Representative)

Box 1345, Farmington, New Mexico

Address

This is to certify that the well location shown on the plat in Section B was located from first hand actual surveys made by me or under my supervision and that the same is true and correct to the best of my knowledge and belief.

Date Surveyed May 13, 1960

Ernest V. Echohawk
Registered Land Surveyor.

Certificate No. 1545

