

**EL PASO FIELD SERVICES
PRODUCTION PIT CLOSURE**

Dehx
**Crawford Gas Com B#1
Meter/Line ID – 73778**

Risk outside
RECEIVED
DEC 2 1994
OIL CON. DIV.
DIST. 3

SITE DETAILS

Legals - Twn: 29N	Rng: 12W	Sec: 24	Unit: L
NMOCD Hazard Ranking: 0		Land Type: BLM	
Operator: Amoco		Pit Closure Date: 4/15/94	

RATIONALE FOR RISK-BASED CLOSURE

The pit noted above was assessed and ranked according to the criteria in the New Mexico Oil Conservation Division's (NMOCD) Unlined Surface Impoundment Closure Guidelines.

A test pit was excavated to 12' and a soil sample was collected for field headspace analysis and laboratory analysis for TPH and BTEX. Groundwater was not encountered in the test pit. The pit was backfilled and graded in a manner to direct surface runoff away from the pit area. Headspace analysis indicated an organic vapor content of 513 ppm; laboratory analysis indicated a TPH concentration of 1600 mg/kg and total BTEX concentration of 104 mg/kg.

El Paso Field Services Company (EPFS) requests closure of the above mentioned production pit location for the following reasons:

- The primary source, discharge to the pit, has been removed for over five years.
- The test pit was backfilled with clean soil and the former pit area graded to direct surface runoff away from the former pit.
- Source material has been removed from the ground surface, eliminating potential direct contact with livestock and the public.
- Groundwater was not encountered in the test excavation. In addition, the estimated depth to groundwater is greater than 100 feet; therefore, impact to groundwater is unlikely.
- There are no water supply wells or potential surface water receptors within 1,000 feet of the site.
- Residual hydrocarbons in the soil will degrade by natural attenuation with minimal risk to the environment.

ATTACHMENT

Revised Field Pit Assessment Form
Field Pit Remediation/Closure Form

Field Pit Assessment Form
Laboratory Analytical Results

✓

REVISED
FIELD PIT SITE ASSESSMENT FORM

GENERAL	Meter: <u>73778</u> Location: <u>Crawford Gas Com B#1</u> Operator #: _____ Operator Name: _____ P/L District: _____ Coordinates: Letter: <u>L</u> Section <u>24</u> Township: <u>29</u> Range: <u>12</u> Or Latitude _____ Longitude _____ Pit Type: Dehydrator _____ Location Drip: _____ Line Drip: _____ Other: _____ Site Assessment Date: <u>4/13/98</u> Area: _____ Run: _____
SITE ASSESSMENT	<div style="display: flex; justify-content: space-between;"> <div style="width: 45%;"> NMOCD Zone: (From NMOCD Maps) </div> <div style="width: 45%;"> Land Type: <div style="display: flex; justify-content: space-between;"> <div style="width: 45%;"> <input type="checkbox"/> Inside (1) <input checked="" type="checkbox"/> Outside (2) </div> <div style="width: 45%;"> BLM <input checked="" type="checkbox"/> (1) State <input type="checkbox"/> (2) Fee <input type="checkbox"/> (3) Indian _____ </div> </div> </div> </div> <div style="margin-top: 10px;"> Depth to Groundwater <div style="display: flex; justify-content: space-between;"> <div style="width: 45%;"> Less Than 50 Feet (20 points) 50 Ft to 99 Ft (10 points) Greater Than 100 Ft (0 points) </div> <div style="width: 45%;"> <input type="checkbox"/> (1) <input type="checkbox"/> (2) <input checked="" type="checkbox"/> (3) </div> </div> </div> <div style="margin-top: 10px;"> Wellhead Protection Area Is it less than 1000 ft from wells, springs or other sources of fresh water extraction?, or; Is it less than 200 ft from a private domestic water source? <div style="display: flex; justify-content: space-around; margin-top: 5px;"> <input type="checkbox"/> (1) YES (20 points) <input checked="" type="checkbox"/> (2) NO (0 points) </div> </div> <div style="margin-top: 10px;"> Horizontal Distance to Surface Water Body <div style="display: flex; justify-content: space-between;"> <div style="width: 45%;"> Less Than 200 Ft (20 points) 200 Ft to 1000 Ft (10 points) Greater Than 1000 Ft (0 points) </div> <div style="width: 45%;"> <input type="checkbox"/> (1) <input type="checkbox"/> (2) <input checked="" type="checkbox"/> (3) </div> </div> </div> <div style="margin-top: 10px;"> Name of Surface Water Body _____ (Surface Water Body: Perennial Rivers, Streams, Creeks, Irrigation Canals, Ditches, Lakes, Ponds) Distance to Nearest Ephemeral Stream <div style="display: flex; justify-content: space-between; margin-top: 5px;"> <input type="checkbox"/> (1) < 100' (Navajo Pits Only) <input type="checkbox"/> (2) > 100' </div> </div> <div style="margin-top: 10px;"> TOTAL HAZARD RANKING SCORE: <u>0</u> POINTS </div>
REMARKS	Remarks : <u>Site has been re-assessed, due to initial assessment including washes as a Surface Water Body. Site is >100' vertical to center of San Juan R. & >1000' horizontal to San Juan R.</u>

FIELD PIT SITE ASSESSMENT FORM

GENERAL	<p>Meter: <u>73778</u> Location: <u>CRAWFORD GAS COM B #1</u></p> <p>Operator #: <u>0203</u> Operator Name: <u>Amoco</u> P/L District: <u>Kurtz</u></p> <p>Coordinates: Letter: <u>L</u> Section <u>24</u> Township: <u>29</u> Range: <u>12</u></p> <p>Or Latitude _____ Longitude _____</p> <p>Pit Type: Dehydrator <input checked="" type="checkbox"/> Location Drip: _____ Line Drip: _____ Other: _____</p> <p>Site Visit Date: <u>3-18-94</u> Run: <u>02</u> <u>02</u></p>
	<p>NMOCD Zone: Inside _____ Land Type: BLM <input checked="" type="checkbox"/> (From NMOCD Vulnerable _____ State <input type="checkbox"/> Maps) Zone <input checked="" type="checkbox"/> Fee <input type="checkbox"/> Outside <input type="checkbox"/> Indian _____</p> <p>Depth to Groundwater</p> <p>Less Than 50 Feet (20 points) <input type="checkbox"/> 50 Ft to 99 Ft (10 points) <input type="checkbox"/> Greater Than 100 Ft (0 points) <input checked="" type="checkbox"/></p> <p>Wellhead Protection Area :</p> <p>Is it less than 1000 ft from wells, springs, or other sources of fresh water extraction? , or ; Is it less than 200 ft from a private domestic water source? <input type="checkbox"/> YES (20 points) <input checked="" type="checkbox"/> NO (0 points)</p> <p>Horizontal Distance to Surface Water Body</p> <p>Less Than 200 Ft (20 points) <input type="checkbox"/> 200 Ft to 1000 Ft (10 points) <input type="checkbox"/> Greater Than 1000 Ft (0 points) <input checked="" type="checkbox"/></p> <p>Name of Surface Water Body _____</p> <p>(Surface Water Body : Perennial Rivers, Major Wash Streams, Creeks, Irrigation Canals, Ditches, Lakes, Ponds)</p> <p>TOTAL HAZARD RANKING SCORE: <u>0</u> POINTS</p>
REMARKS	<p>Remarks : <u>2 PITS ON LOCATION. WILL CLOSE ONLY 1 OF THE PIT TO CLOSE AND METER HOUSE ARE DOWN A HILL FROM THE REST OF THE LOCATION. PIT DRY.</u></p>

ORIGINAL PIT LOCATION

ORIGINAL PIT LOCATION

Original Pit : a) Degrees from North 103° Footage to Wellhead 193'
b) Degrees from North _____ Footage to Dogleg _____
Dogleg Name _____
c) Length : 15' Width : 14' Depth : 1'

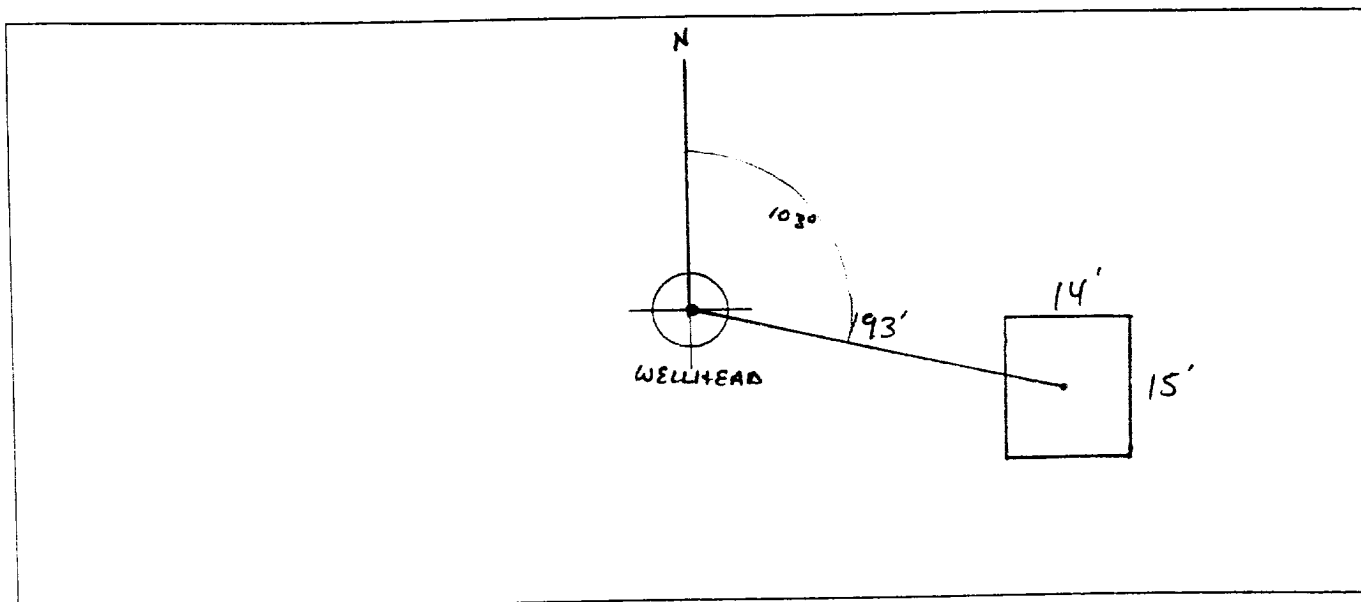

REMARKS

Remarks :

STARTED TAKING PICTURES AT 10:43 A.M.
BOBTAIL - DUMP TRUCK

Completed By:

Robert Thompson
Signature

3.18.94
Date

4-22-94
ET

FIELD PIT SITE ASSESSMENT FORM

GENERAL	
SITE ASSESSMENT	<p>Meter: <u>73778</u> Location: <u>CRAWFORD GAS COM B#1</u> Operator #: _____ Operator Name: _____ P/L District: _____ Coordinates: Letter: _____ Section _____ Township: _____ Range: _____ Or Latitude _____ Longitude _____ Pit Type: Dehydrator _____ Location Drip: _____ Line Drip: _____ Other: _____ Site Assessment Date: _____ Area: <u>02</u> Run: <u>02</u></p> <p>NMOCD Zone: (From NMOCD Maps) Inside <input type="checkbox"/> (1) Outside <input checked="" type="checkbox"/> (2)</p> <p>Land Type: BLM <input type="checkbox"/> (1) State <input type="checkbox"/> (2) Fee <input type="checkbox"/> (3) Indian _____</p> <p>Depth to Groundwater Less Than 50 Feet (20 points) <input type="checkbox"/> (1) 50 Ft to 99 Ft (10 points) <input checked="" type="checkbox"/> (2) Greater Than 100 Ft (0 points) <input type="checkbox"/> (3)</p> <p>Wellhead Protection Area : Is it less than 1000 ft from wells, springs, or other sources of fresh water extraction? , or ; Is it less than 200 ft from a private domestic water source? <input type="checkbox"/> (1) YES (20 points) <input type="checkbox"/> (2) NO (0 points)</p> <p>Horizontal Distance to Surface Water Body Less Than 200 Ft (20 points) <input type="checkbox"/> (1) 200 Ft to 1000 Ft (10 points) <input checked="" type="checkbox"/> (2) Greater Than 1000 Ft (0 points) <input type="checkbox"/> (3)</p> <p>Name of Surface Water Body <u>SAN JUAN RIVER</u> (Surface Water Body : Perennial Rivers, Major Wash, Streams, Creeks, Irrigation Canals, Ditches, Lakes, Ponds) Distance to Nearest Ephemeral Stream <input type="checkbox"/> (1) < 100' (Navajo Pits Only) <input type="checkbox"/> (2) > 100'</p> <p>TOTAL HAZARD RANKING SCORE: <u>20</u> POINTS</p>
	REMARKS

FIELD PIT REMEDIATION/CLOSURE FORM

GENERAL	Meter: <u>73178</u> Location: <u>Crawford Gas Com B #1</u> Coordinates: Letter: <u>L</u> Section <u>24</u> Township: <u>29</u> Range: <u>12</u> Or Latitude _____ Longitude _____ Date Started : <u>4-15-94</u> Area: <u>02</u> Run: <u>02</u>		
FIELD OBSERVATIONS	Sample Number(s): ⁹⁴⁰⁶⁹⁷ <u>KD1</u> ⁹⁴⁰⁶⁹⁸ <u>KD2</u> ⁹⁴⁰⁶⁹⁹ <u>KD3</u> Sample Depth: <u>12'</u> Feet Final PID Reading <u>513 ppm</u> PID Reading Depth <u>12'</u> Feet Yes No Groundwater Encountered <input type="checkbox"/> (1) <input checked="" type="checkbox"/> (2) Approximate Depth _____ Feet		
CLOSURE	Remediation Method : Excavation <input checked="" type="checkbox"/> (1) Approx. Cubic Yards ^{70 4-} <u>65 yds</u> <u>43.3</u> Onsite Bioremediation <input type="checkbox"/> (2) Backfill Pit Without Excavation <input type="checkbox"/> (3) Soil Disposition: Envirotech <input type="checkbox"/> (1) <input checked="" type="checkbox"/> (3) Tierra Other Facility <input type="checkbox"/> (2) Name: _____ Pit Closure Date: <u>4-15-94</u> Pit Closed By: <u>BEI</u>		
REMARKS	Remarks : <u>Soil Sampled was extremely soft red with</u> <u>CH</u>		
Signature of Specialist: <u>Kenny Deacon</u>			



FIELD SERVICES LABORATORY
ANALYTICAL REPORT
PIT CLOSURE PROJECT - Soil

changed to
outside
w02

SAMPLE IDENTIFICATION

	Field ID	Lab ID
SAMPLE NUMBER:	KD1	940697
MTR CODE SITE NAME:	73778	N/A
SAMPLE DATE TIME (Hrs):	4/15/94	1315
SAMPLED BY:	N/A	
DATE OF TPH EXT. ANAL.:	4-21-94	4-21-94
DATE OF BTEX EXT. ANAL.:	4/25/94	4/25/94
TYPE DESCRIPTION:	VC	Coarse sand

REMARKS:

RESULTS

PARAMETER	RESULT	UNITS	QUALIFIERS			
			DF	Q	M(g)	V(ml)
BENZENE	2.15	MG/KG	20			
TOLUENE	44.9	MG/KG	20	B		
ETHYL BENZENE	3.79	MG/KG	20			
TOTAL XYLENES	53.0	MG/KG	20			
TOTAL BTEX	104	MG/KG	0.0377		0.53	20
TPH (418.1)	1600	MG/KG			2.07	28
HEADSPACE PID	513	PPM				
PERCENT SOLIDS	95	%				

-- TPH is by EPA Method 418.1 and BTEX is by EPA Method 8020 --

The Surrogate Recovery was at 100.4 % for this sample All QA/QC was acceptable.
Narrative:

DF = Dilution Factor Used

Approved By:

John L. Smith

Date:

5/17/94