

State of New Mexico
ENERGY, MINERALS and NATURAL RESOURCES DEPARTMENT
Santa Fe, New Mexico 87505



January 3, 1995

Amoco Production Company
Southern Rockies Business Unit
P. O. Box 800
Denver, Colorado 80201

Attention: J. W. Hawkins

Administrative Order NSL-3446

Dear Mr. Hawkins:

Reference is made to your application dated August 12, 1994 for a non-standard gas well location for your Garcia Gas Com "B" Well No. 1 (API No. 30-045-07996) located 1805 feet from the South line and 2350 feet from the East line (Unit J) of Section 21, Township 29 North, Range 10 West, NMPM, Blanco Mesaverde Pool, San Juan County, New Mexico. The S/2 of said Section 21 shall be dedicated to the well forming a standard 320-acre gas spacing and proration unit for said pool.

By the authority granted me under the provisions of Rule 2(c) of the General Rules for the Prorated Gas Pools of New Mexico/Special Rules and Regulations for the Blanco-Mesaverde Pool, as promulgated by Division Order No. R-8170, as amended, the above-described unorthodox well gas well location is hereby approved.

Sincerely,

Michael E. Stogner
Acting Director

MES/kv

cc: Oil Conservation Division - Aztec

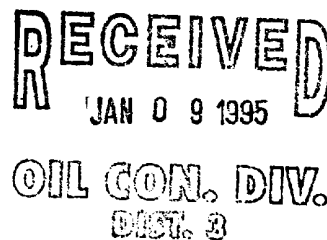

VILLAGRA BUILDING - 408 Galisteo
Forestry and Resources Conservation Division
P.O. Box 1948 87504-1948
827-5830
Park and Recreation Division
P.O. Box 1147 87504-1147
827-7465

2040 South Pacheco
Office of the Secretary
827-5950
Administrative Services
827-5925
Energy Conservation & Management
827-5900
Mining and Minerals
827-5970
Oil Conservation
827-7131

DISTRICT I
Box 1980, Hobbs, NM 88240
DISTRICT II
P.O. Drawer DD, Artesia, NM 88210
DISTRICT III
1000 Rio Brazos Rd., Aztec, NM 87410

State of New Mexico
Energy, Minerals and Natural Resources Department
OIL CONSERVATION DIVISION
P.O. Box 2088
Santa Fe, New Mexico 87504-2088

OPERATOR INFORMATION
Form C-115 - Revised 10/80
See Distribution and Code
Information Bottom of Page

Company P&M Petroleum Management Address 1600 Broadway, Denver, CO Zip 80202 For Month APRIL 1991 Page 1 of 1
Operator

POOL NAME (Underline) *Lease Name WELL NO. UNIT SEC. TWP RING	WELL STATUS	INJECTION			PRODUCTION			DISPOSITION OF GAS				DISPOSITION OF OIL						
		VOLUME	PRESS.	BARRELS OIL/COND. PRODUCED	BARRELS OF WATER PRODUCED	GAS PRODUCED (MCF)	DAYS PROD.	SOLD	TRANS-PORTER	OTHER	C O D E	OIL ON HAND AT BEG. OF MONTH	BARRELS TO TRANS-PORTER	TRANS-PORTER	OTHER	C O D E	OIL ON HAND AT END OF MONTH	
<u>BLANCO</u> State Bancos #1 (LG898) Unit D 32-T32N-R5W	F					3462	30	3462	420									

RECEIVED
MAR 19 1992
OIL CON. DIV.
DIST. 2

DISTRIBUTION	STATUS CODE	OTHER GAS DISPOSITION CODE	OTHER OIL DISPOSITION CODE	I HEREBY CERTIFY THAT THE INFORMATION GIVEN IS TRUE AND COMPLETE TO THE BEST OF MY KNOWLEDGE	
Original OCD Santa Fe One Copy OCD Dist. Office in which lease is located One Copy to Transporter (s) DATE DUE To be postmarked by 24th day of next succeeding month.	F..... FLOWING P..... PUMPING G..... GAS LIFT S..... SHUT IN T..... TEMP ABANDONED I..... INJECTION D..... DISCONTINUED	X..... USED OFF LEASE D..... USED FOR DRILLING G..... GAS LIFT L..... LOST (NOT ESTIMATED) E..... EXPLANATION ATTACHED R..... REPRESSURING OR PRESSURE MAINTENANCE V..... VENTED U..... USED ON LEASE	C..... CIRCULATING OIL L..... LOST S..... SEDIMENTATION (B.S.A.W.) E..... EXPLANATION ATTACHED T..... TIE-OUT	Typed Name Patricia A. Sands 303-861-2470 PHONE NUMBER	POSITION Lease Accountant 3/17/92 DATE

Ernie Busch

From: Ernie Busch
To: Mike Stogner
Subject: AMOCO (NSL)
Date: Thursday, September 15, 1994 7:58AM
Priority: High

GARCIA GAS COM B#1
1805' FNL; 2350" FEL
J-21-29N-10W
RECOMMEND: APPROVAL



Southern

Rockies

Business

Unit

August 12, 1994

Mr. William J. LeMay, Director
New Mexico Oil Conservation Division
P.O. Box 2088
Santa Fe, New Mexico 87504

RECEIVED
AUG 15 1994

OIL CON. DIV.
DIST. 3

Application for Unorthodox Location
Garcia Gas Com B#1 Well
SE/4 Section 21-T29N-R10W
Blanco Mesaverde Pool
San Juan County, New Mexico

Amoco Production Company hereby requests administrative approval for an unorthodox location in the Blanco Mesaverde Pool. The Garcia Gas Com B #1 Well was drilled in 1965 at a location 1805' FNL and 2350' FEL of Section 21. The well has produced from the Basin Dakota formation since 1965. Amoco now wishes to abandon the Basin Dakota and recomplete to the Blanco Mesaverde. There is no record of an unorthodox location order for this well. Since this well is located 500' toward the interior of the spacing unit, no offset owners will be adversely affected. This spacing unit is in the S/2 Section 21-T29N-R10W. The offset operators will receive a copy of the application by certified mail with a request that they furnish your Santa Fe office with a waiver of objection and return one copy to Amoco.

Sincerely,

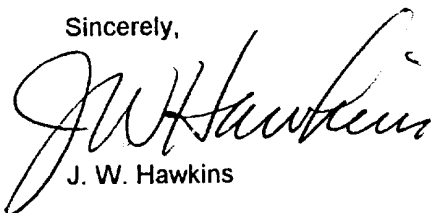
J. W. Hawkins

JWH/ewb

cc: Mr. Frank Chavez, Supervisor
NMOCD District III
1000 Rio Brazos Rd.
Aztec, NM 87410

Meridian Oil Inc.
P.O. Box 4289
Farmington, NM 87499

Arco Oil and Gas
P.O. Box 1610
Midland, TX 79710

WAIVER

_____ hereby waives objection to Amoco's application for unorthodox well location for the Garcia Gas Com B #1 Well in the Blanco Mesaverde Pool as proposed above.

By: _____

Date: _____

VERIFICATION AND AFFIDAVIT

STATE OF COLORADO)
CITY AND COUNTY : SS
OF DENVER)

J. W. Hawkins, of lawful age, being first duly sworn on his oath, deposes and says:

That he is employed in an engineering capacity by Amoco Production Company in its Denver, Colorado office; that he has been qualified as an expert engineering witness by the New Mexico Oil Conservation Division and his qualifications have been made of record; that Amoco's application for administrative approval for unorthodox location for the Garcia Gas Com B #1 Well in the Blanco Mesaverde Pool, San Juan County, New Mexico was prepared under his direction and supervision; that the matter and things therein set forth are true and correct to the best of his knowledge and beliefs. Copies of the application have been mailed by certified mail to the affected operators.



J. W. Hawkins

Subscribed and sworn to before me this 12th day of August, 1994.

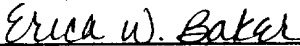

Erica W. Baker

My Commission Expires
AUGUST 20, 1997

13,342,003.02 FT. N
36° 43' 57" N

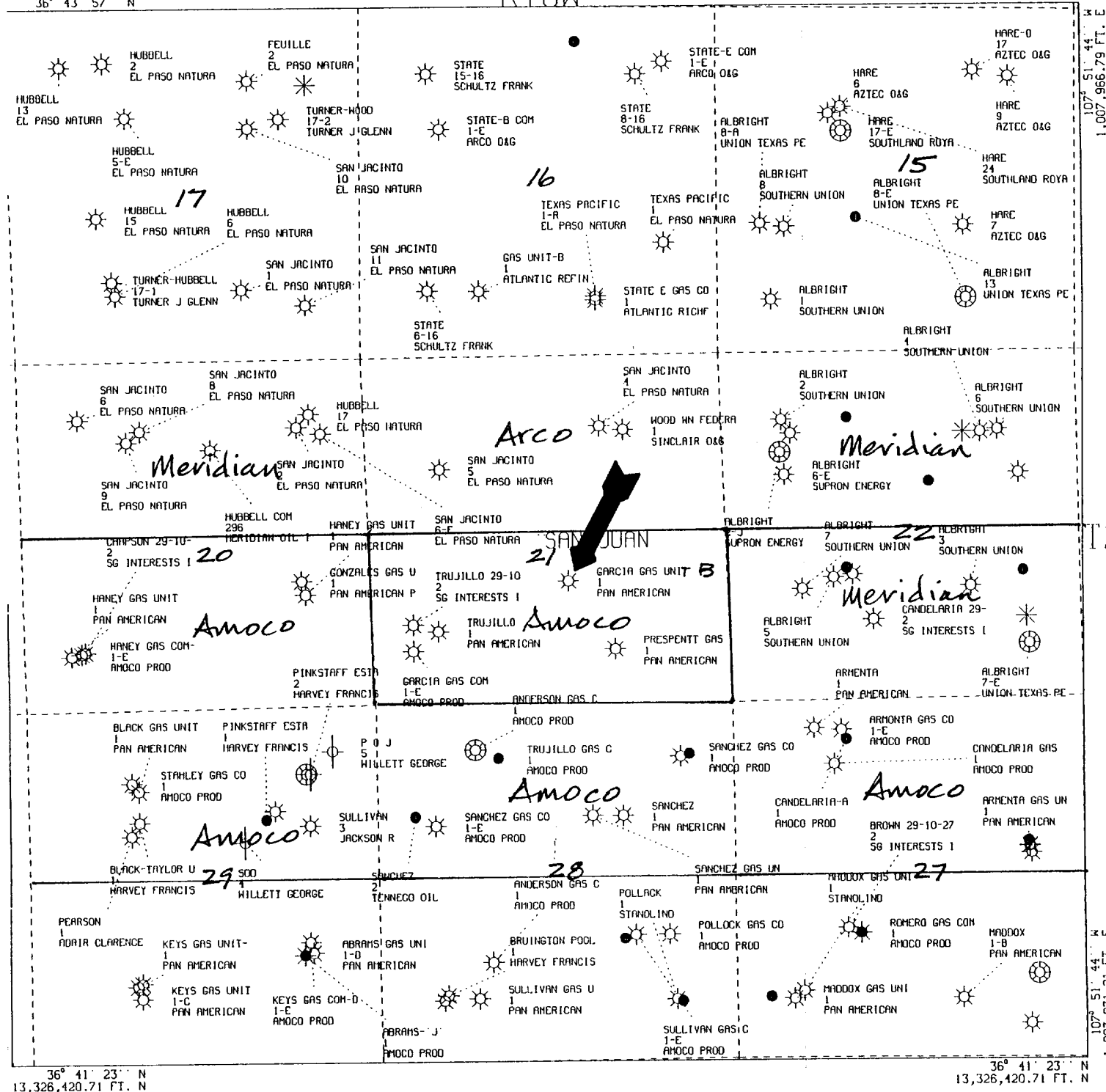

All geological and geophysical data, including the interpretation thereof, appearing on this map is the private and confidential property of Amoco Production Company. The publication or reproduction thereof without the written permission of said Company is strictly prohibited.



AMOCO PRODUCTION COMPANY
GARCIA GAS COM B 1
SEC. J21-T29N-R10W
ALL OFFSET WELLS

SCALE 1 IN. = ~~2,000~~⁷⁵⁰ FT. MAY 2, 1994

POLYCONIC CENTRAL MERIDIAN - 107° 53' 22" W LONG
SPHEROID - 6

94122091350

NO. OF COPIES RECEIVED	
DISTRIBUTION	
SANTA FE	1
FILE	1
U.S.G.S.	2
LAND OFFICE	
OPERATOR	1

NEW MEXICO OIL CONSERVATION COMMISSION



Form C-101
Revised 1-1-65

5A. Indicate Type of Lease STATE <input type="checkbox"/> FEE <input checked="" type="checkbox"/>
5. State Oil & Gas Lease No.
7. Unit Agreement Name
8. Farm or Lease Name Garcia Gas Unit "B"
9. Well No. 1
10. Field and Pool, or Wildcat Basin Dakota
12. County San Juan
19. Proposed Depth 6350
19A. Formation Dakota
20. Rotary or C.T. Rotary
21. Elevations (Show whether DF, RT, etc.) Will report later.
21A. Kind & Status Plug. Bond Statewide
21B. Drilling Contractor JCM Drilling Company
22. Approx. Date Work will start May 21, 1965

APPLICATION FOR PERMIT TO DRILL, DEEPEN, OR PLUG BACK			
1a. Type of Work DRILL <input checked="" type="checkbox"/> DEEPEN <input type="checkbox"/> PLUG BACK <input type="checkbox"/>			
b. Type of Well OIL WELL <input type="checkbox"/> GAS WELL <input checked="" type="checkbox"/> OTHER <input type="checkbox"/> SINGLE ZONE <input checked="" type="checkbox"/> MULTIPLE ZONE <input type="checkbox"/>			
2. Name of Operator PAN AMERICAN PETROLEUM CORPORATION			
3. Address of Operator P. O. Box 480, Farmington, New Mexico			
4. Location of Well UNIT LETTER J LOCATED 1805 FEET FROM THE South LINE AND 2350 FEET FROM THE East LINE OF SEC. 21 TWP. 29-N RGE. 10-W NMMPM			
23. PROPOSED CASING AND CEMENT PROGRAM			

SIZE OF HOLE	SIZE OF CASING	WEIGHT PER FOOT	SETTING DEPTH	SACKS OF CEMENT	EST. TOP
12-1/4"	8-5/8"	24.5	350	225	Surface
7-7/8"	4-1/2"	10.5#	6350	1400*	Surface

*2 Stage tool to be set 100' below base of Mesaverde.

Copies of Location Plat are attached.

Copies of any logs run will be furnished upon completion of well.



Verbal approval received May 13, 1965, E. C. Arnold to J. C. Glover.

IN ABOVE SPACE DESCRIBE PROPOSED PROGRAM: IF PROPOSAL IS TO DEEPEN OR PLUG BACK, GIVE DATA ON PRODUCTION ZONE AND PROPOSED NEW PRODUCTION ZONE. GIVE BLOWOUT PREVENTER PROGRAM, IF ANY.

I hereby certify that the information above is true and complete to the best of my knowledge and belief.

F. L. Nabors, District Engineer

Signed ORIGINAL SIGNED BY Title

F. H. HOLLINGSWORTH
(This space for State Use)

APPROVED BY *Emory Glover* TITLE

CONDITIONS OF APPROVAL, IF ANY:

FARMINGTON DISTRICT	
DS	
DE	
DGS	
AS	
AC	
EE	
OE	
RE	
1. <i>Bill Miller</i>	
2. <i>Bill Miller</i>	

Date **May 13, 1965**

DATE

Well Location and Acreage Dedication Plat

Section A.

Date May 12, 1965

Operator PAN AMERICAN PETROLEUM CORPORATION Lease GARCIA GAS UNIT "B"
 Well No. 1 Unit Letter J Section 21 Township 29 NORTH Range 10 WEST NMPM
 Located 1805 Feet From SOUTH Line, 2350 Feet From EAST Line
 County SAN JUAN G. L. Elevation REPORT LATER Dedicated Acreage 320 Acres
 Name of Producing Formation DAKOTA Pool BASIN DAKOTA

1. Is the Operator the only owner in the dedicated acreage outlined on the plat below?

Yes No X2. If the answer to question one is "no", have the interests of all the owners been consolidated by communitization agreement or otherwise? Yes X No . If answer is "yes", Type of Consolidation.

Declaration of Unit completed.

3. If the answer to question two is "no", list all the owners and their respective interests below:

Owner

Land Description

Section B.

This is to certify that the information in Section A above is true and complete to the best of my knowledge and belief.

PAN AMERICAN PETROLEUM CORP.F. H. Hollingsworth (Operator)(Representative)P. O. Box 480(Address)Farmington, New Mexico

Note: All distances must be from outer boundaries of section.

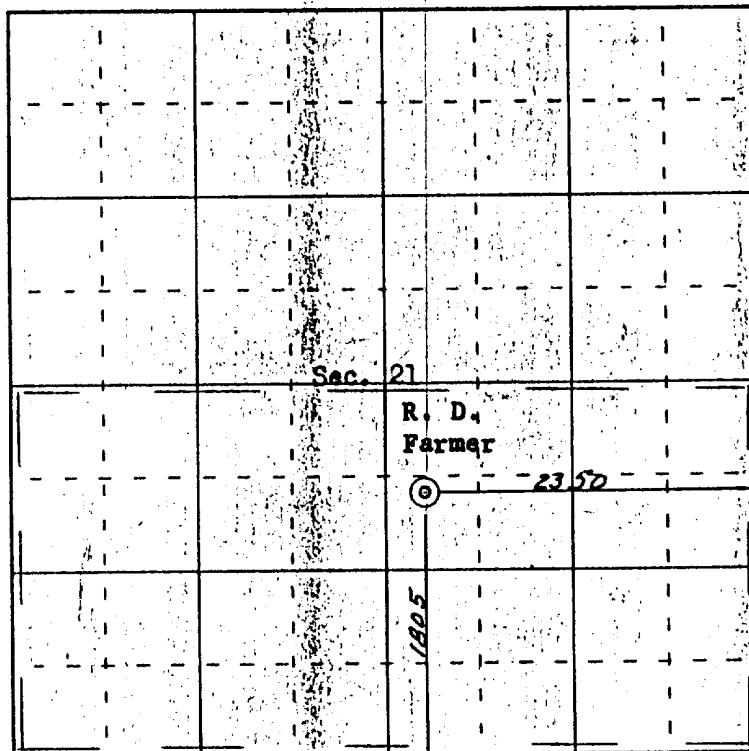

0 320 640 960 1280 1600 1920 2240 2560 2880 3200 3520 3840 4160 4480 4800 5120 5440 5760 6080 6400

Scale 4 inches equal 1 mile

Ref: GLO plat dated 19 April 1881



(Seal)

Farmington, New Mexico

This is to certify that the above plat was prepared from field notes of actual surveys made by me or under my supervision and that the same are true and correct to the best of my knowledge and belief.

Date Surveyed November 4, 1964

James P. Leese
 Registered Professional Engineer and/or Land Surveyor
 James P. Leese, N. Mex. Reg. No. 1463
 San Juan Engineering Company

NO. OF COPIES RECEIVED		
DISTRIBUTION		
SANITABLE		
FILE		
U.S.G.S.		
LAND OFFICE		
OPERATOR		

NEW MEXICO OIL CONSERVATION COMMISSION

Form C-103
Supersedes Old
C-102 and C-103
Effective 1-1-65

<p align="center">SUNDRY NOTICES AND REPORTS ON WELLS (DO NOT USE THIS FORM FOR PROPOSALS TO DRILL OR TO DEEPEN OR PLUG BACK TO A DIFFERENT RESERVOIR. USE "APPLICATION FOR PERMIT -" (FORM C-101) FOR SUCH PROPOSALS.)</p>		<p>5a. Indicate Type of Lease State <input type="checkbox"/> Fee <input checked="" type="checkbox"/></p> <p>5. State Oil & Gas Lease No.</p>
<p>1. OIL WELL <input type="checkbox"/> GAS WELL <input checked="" type="checkbox"/> OTHER <input type="checkbox"/></p> <p>2. Name of Operator Pan American Petroleum Corporation</p> <p>3. Address of Operator Security Life Building, Denver, Colorado 80202</p> <p>4. Location of Well UNIT LETTER <u>J</u> <u>1805</u> FEET FROM THE <u>South</u> LINE AND <u>2350</u> FEET FROM THE <u>East</u> LINE, SECTION <u>21</u> TOWNSHIP <u>29-N</u> RANGE <u>10-W</u> NMPM.</p>	<p>7. Unit Agreement Name</p> <p>8. Farm or Lease Name Garcia Gas Unit B</p> <p>9. Well No. 1</p> <p>10. Field and Pool, or Wildcat Basin Dakota</p>	<p>15. Elevation (Show whether DF, RT, GR, etc.) 5609 (RDB)</p> <p>12. County San Juan</p>

16. Check Appropriate Box To Indicate Nature of Notice, Report or Other Data

NOTICE OF INTENTION TO:		SUBSEQUENT REPORT OF:	
PERFORM REMEDIAL WORK <input type="checkbox"/>	PLUG AND ABANDON <input type="checkbox"/>	REMEDIAL WORK <input type="checkbox"/>	ALTERING CASING <input type="checkbox"/>
TEMPORARILY ABANDON <input type="checkbox"/>	CHANGE PLANS <input type="checkbox"/>	COMMENCE DRILLING OPNS. <input type="checkbox"/>	PLUG AND ABANDONMENT <input type="checkbox"/>
PULL OR ALTER CASING <input type="checkbox"/>	OTHER <input type="checkbox"/>	CASING TEST AND CEMENT JOB <input type="checkbox"/>	Well History <input checked="" type="checkbox"/>

17. Describe Proposed or Completed Operations (Clearly state all pertinent details, and give pertinent dates, including estimated date of starting any proposed work) SEE RULE 1703.

The above well was spudded on 6-23-65 and drilled to a depth of 932'. 8 5/8" casing was set at that depth with 750 sacks cement containing 2 pounds Tuf Plug per sack, 1/2 pound Celo-Flake per sack followed by 50 sacks neat cement. Cement circulated to surface. After waiting on cement tested casing with 800 psi. Test O.K. Reduced hole size to 7 7/8" and resumed drilling.

Well was drilled to a total depth of 6518'. 4 1/2" casing was set at that depth with stage collar set at 4558. Cemented first stage with 400 sacks cement containing 6% gel, 2 pounds Tuf Plug per sack followed by 100 sacks neat. Cemented second stage with 1100 sacks cement containing 6% gel, 2 pounds Tuf Plug per sack and followed by 25 sacks neat cement. After waiting on cement tested casing with 3500 psi. Test O.K.

Cemented the 4 1/2" - 8 5/8" casing annulus with 400 sacks cement containing 6% gel, 1 pound Tuf Plug and 1/2 pound Flo Ceal per sack.

Perforated 6360-82 with 3 shots per foot. Fracked these perforations with 45,108 gallons water containing 0.8% potassium chloride, 2 1/2 pounds J-100 per 1000 gallons and 40,000 pounds sand. Breakdown pressure 3400 psi. Average treating pressure 3200 psi. Average injection rate 45 BPM. Flowed well to clean up. (over)

18. I hereby certify that the information above is true and complete to the best of my knowledge and belief.

SIGNED R. H. Beers R. H. Beers TITLE Administrative Assistant DATE 8-26-65

APPROVED BY _____ TITLE _____ DATE _____
CONDITIONS OF APPROVAL, IF ANY:

2 3/8" tubing landed at 6367 and well completed 7-22-65 as shut in Basin Dakota field development well. Potential Test 3-3-65. Flowed 5058 MCFPD through 3/4" choke after 3 hours flow. Absolute open flow potential 5957 MCFPD. Shut in casing pressure after 12 days 2063 psig.