

(SUBMIT IN TRIPLICATE)

Indian Agency Navajo

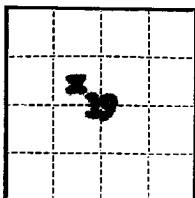

UNITED STATES
DEPARTMENT OF THE INTERIOR
GEOLOGICAL SURVEY

Allottee _____

Lease No. 14-20-0603-7106

CONFIDENTIAL
SUNDRY NOTICES AND REPORTS ON WELLS

NOV 12 1963

NOTICE OF INTENTION TO DRILL	<input checked="" type="checkbox"/>	SUBSEQUENT REPORT OF WATER SHUT-OFF	
NOTICE OF INTENTION TO CHANGE PLANS		SUBSEQUENT REPORT OF SHOOTING OR ACIDIZING	
NOTICE OF INTENTION TO TEST WATER SHUT-OFF		SUBSEQUENT REPORT OF ALTERING CASING	
NOTICE OF INTENTION TO REDRILL OR REPAIR WELL		SUBSEQUENT REPORT OF REDRILLING OR REPAIR	
NOTICE OF INTENTION TO SHOOT OR ACIDIZE		SUBSEQUENT REPORT OF ABANDONMENT	
NOTICE OF INTENTION TO PULL OR ALTER CASING		SUPPLEMENTARY WELL HISTORY	
NOTICE OF INTENTION TO ABANDON WELL			

(INDICATE ABOVE BY CHECK MARK NATURE OF REPORT, NOTICE, OR OTHER DATA)

November 11, 1963

Navajo Tract 12
Well No. 3 is located 1900 ft. from N line and 1900 ft. from W line of sec. 19
SE NW Section 19 29N 10W NEPM
(1/4 Sec. and Sec. No.) (Twp.) (Range) (Meridian)
South Water Flow San Juan New Mexico
(Field) (County or Subdivision) (State or Territory)

The elevation of the derrick floor above sea level is 5391.5 ft. **Ungraded**

DETAILS OF WORK

(State names of and expected depths to objective sands; show sizes, weights, and lengths of proposed casings; indicate mudding jobs, cementing points, and all other important proposed work)

Rotary drilling equipment will be used to drill to approximately 4300', a Sarnotest test. Casing Program: 200' of 8-5/8" cemented to surface. Required amount of 1 1/2" production casing will be run and cemented with sufficient volume of cement to cover the highest potentially productive zone. Mud program will consist of native muds from surface to 3000' and a low solids gel with 5 to 7 cc loss to total depth. Electric logs, etc. will be run prior to setting productive casing or abandonment of well. Stimulation treatments such as acidizing or fracturing may be employed in completion.

I understand that this plan of work must receive approval in writing by the Geological Survey before operations may be commenced.

Company Humble Oil & Refining Company

Address P. O. Box 3082

Durango, Colorado

By **COPY (ORIGINAL SIGNED) B. M. BRADLEY**

Title Dist. Supt.

NEW MEXICO OIL CONSERVATION COMMISSION

Well Location and Acreage Dedication Plat

Section A.

Date _____

Operator HUMBLE OIL & REFINING COMPANY Lease _____
 Well No. 3 Unit Letter F Section 19 Township 29 NORTH Range 15 WEST NMPM
 Located 1980 Feet From the NORTH Line, 1980 Feet From the WEST Line
 County SAN JUAN G. L. Elevation 5391.5 Dedicated Acreage 40 Acres
 Name of Producing Formation Gallup Pool _____

1. Is the Operator the only owner in the dedicated acreage outlined on the plat below?

Yes ✓ No _____

2. If the answer to question one is "no", have the interests of all the owners been consolidated by communitization agreement or otherwise? Yes _____ No _____. If answer is "yes", Type of Consolidation.

3. If the answer to question two is "no", list all the owners and their respective interests below:

OwnerLand Description

RECEIVED

NOV 12 1963

U. S. GEOLOGICAL SURVEY
FARMINGTON, NEW MEXICO

Section B.

Note: All distances must be from outer boundaries of section.

This is to certify that the information
 in Section A above is true and complete
 to the best of my knowledge and belief.

Humble Oil & Ref Co
 (Operator)

B. B. Bradley
 (Representative)

Box 3082
 (Address)

Durango Colo

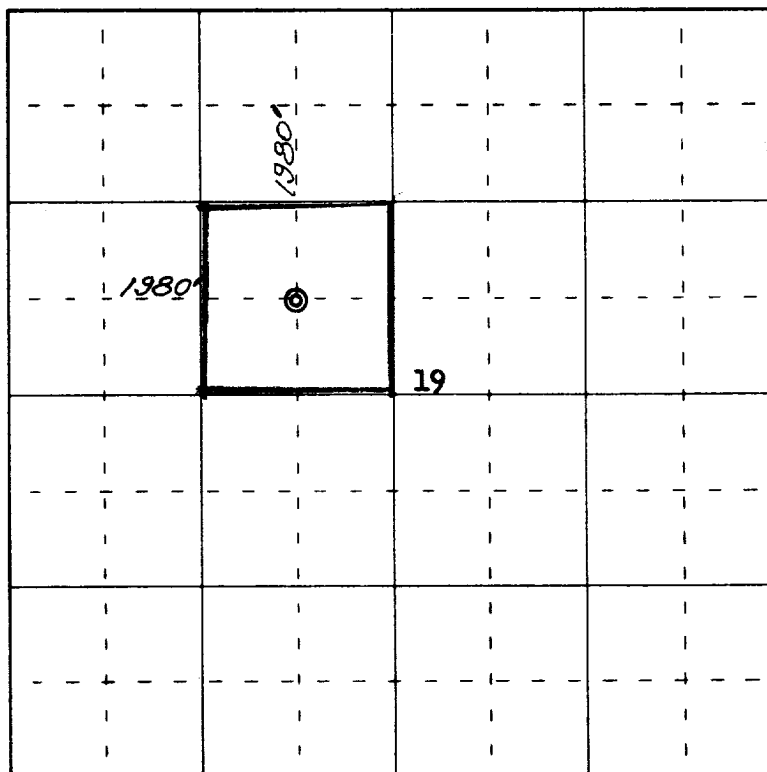

0 330 660 990 1320 1650 1980 2310 2640 2000 1500 1000 500 0

Scale 4 inches equal 1 mile

This is to certify that the above plat was prepared from field notes of actual surveys made by me or under my supervision and that the same are true and correct to the best of my knowledge and belief.

Date Surveyed 11 November 1963

James P. Leese
 Registered Professional Engineer and/or Land Surveyor
James P. Leese, N. Mex. Reg. No. 1463
 San Juan Engineering Company