

NEW MEXICO OIL CONSERVATION COMMISSION
Santa Fe, New Mexico

Form G-101
Revised (12/1/55)

NOTICE OF INTENTION TO DRILL

Notice must be given to the District Office of the Oil Conservation Commission and approval obtained before drilling or recompletion begins. If changes in the proposed plan are considered advisable, a copy of this notice showing such changes will be returned to the sender. Submit this notice in QUINTUPLICATE. One copy will be returned following approval. See additional instructions in Rules and Regulations of the Commission.

If State Land submit 6 Copies Attach Form G-128 in triplicate to first 3 copies of form G-101

Farmington, New Mexico

(Place)

May 7, 1962

(Date)

OIL CONSERVATION COMMISSION
SANTA FE, NEW MEXICO

Gentlemen:

You are hereby notified that it is our intention to commence the Drilling of a well to be known as

PAN AMERICAN PETROLEUM CORPORATION

(Company or Operator)

Gallegos Canyon Unit

(Lease)

Well No. 94

F

(Unit)

located 1850 feet from the North line and 1850 feet from the West

line of Section 23, T. -29-N, R. -13-W, NMPM.

(GIVE LOCATION FROM SECTION LINE)

Basin Dakota

Pool,

San Juan

County

If State Land the Oil and Gas Lease is No.

If patented land the owner is W. S. Allen

Address Farmington, New Mexico

We propose to drill well with drilling equipment as follows: Rotary tools to total depth

The status of plugging bond is Statewide

Drilling Contractor Brannon & Murray Drilling Company

Box 672

Coleman, Texas

We intend to complete this well in the Dakota

formation at an approximate depth of 6,000

CASING PROGRAM

We propose to use the following strings of Casing and to cement them as indicated:

Size of Hole	Size of Casing	Weight per Foot	New or Second Hand	Depth	Sacks Cement
12-1/4"	8-5/8"	22.7#	New	500'	300
7-7/8"	4-1/2"	9.5#	New	6000	660

If changes in the above plans become advisable we will notify you immediately.

ADDITIONAL INFORMATION (If recompletion give full details of proposed plan of work.) Oil string casing to be cemented by two stage method. First stage - 310 sacks 4% gel with 1-1/2 lb. Tuf Plug per sack and 100 sacks neat on bottom. Second stage - 350 sacks 4% gel. All cement to be Incor. Stimulation will be determined upon reaching total depth. Copies of location plat are attached. Copies of any log taken will be submitted upon completion of well.

NOTE: Verbal approval received 5/4/62

Approved: 5-4, 1962
Except as follows:

Sincerely yours,

PAN AMERICAN PETROLEUM CORPORATION

(Company or Operator)

Original signed by

By: R. M. BAUER, JR.

Position: Senior Petroleum Engineer

Send Communications regarding well to

Name: L. O. Speer, Jr.

Address: Box 480, Farmington, New Mexico

OIL CONSERVATION COMMISSION

By:

[Signature]

Well Location and Acreage Indemnity Plat

Section A.

Date **May 3, 1962**

Operator **PAN AMERICAN PETROLEUM CORPORATION** Lease **GALLEGOS CANYON UNIT**
 Well No. **94** Unit Letter **F** Section **23** Township **29 NORTH** Range **13 WEST**, NMPM
 Located **1850** Feet From **the NORTH** Line, **1850** Feet From **the WEST** Line
 County **SAN JUAN** G. L. Elevation **Report later** Homestead Acreage **320** Acres
 Name of Producing Formation **Dakota** Pool **Basin Dakota**

1. Is the Operator the only owner in the dedicated acreage outlined on this plat below?
 Yes ☐ No ☒ **X**
2. If the answer to question one is "No", have the interests of all the owners been consolidated by communitization agreement or otherwise? Yes ☒ **X** No ☐ If so, what is the type of consolidation?

Declaration of Unitization and Gallegos Canyon Unit Agreement.

3. If the answer to question two is "No", list all the owners and their interests below:

Owner

Local Description

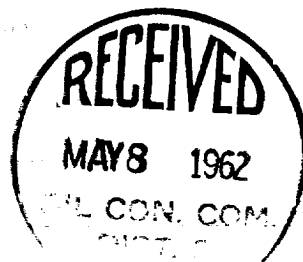

Section B.

Water Acreage and Acreage Summary of section

This is to certify that the information in Section A above is true and complete to the best of my knowledge and belief.

Pan American Petroleum Corp.

(Operator)

R. M. Bauer, Jr. *R. M. Bauer, Jr.*

(Representative)

Box 480, Farmington, New Mex.

(Address)

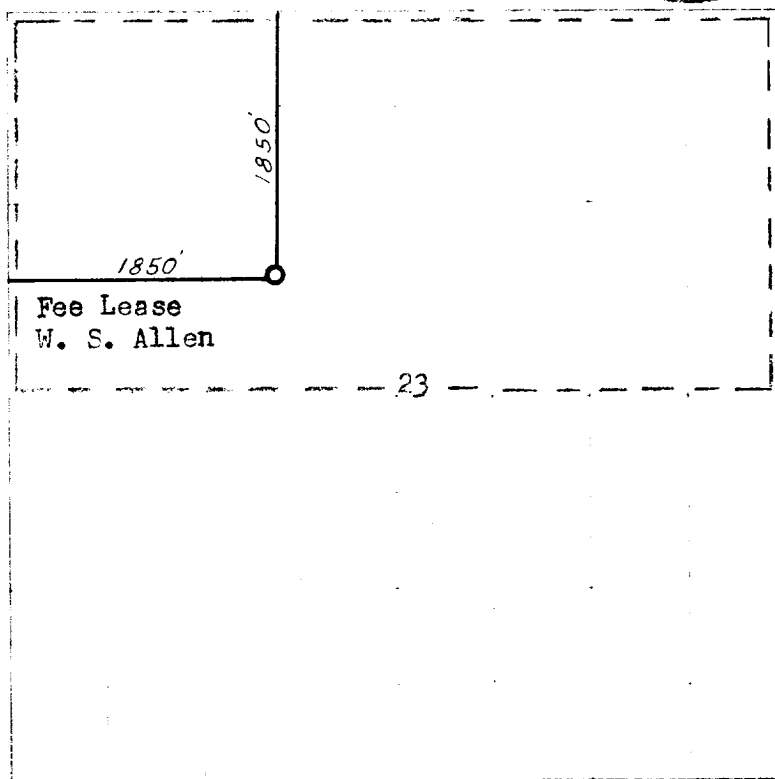

Ref: GLO plat dated 19 April 1881

0 300 600 900 1200 1500 1800 2100 2400 2700 3000 3300 3600 3900 4200 4500 4800 5100 5400 5700 6000 6300 6600 6900 7200 7500 7800 8100 8400 8700 9000 9300 9600 9900 10200 10500 10800 11100 11400 11700 12000

Scale 1 inch equals 1 mile

This is to certify that the above plat was prepared from field notes of actual surveys made by me or under my supervision and that the same are true and correct to the best of my knowledge and belief.

Date surveyed **17 April 1962**

James P. Leese
 Registered Professional Engineer and/or Land Surveyor
 James P. Leese N. Mex. Reg. No. 1463

