

(SUBMIT IN TRIPLICATE)

UNITED STATES
DEPARTMENT OF THE INTERIOR
GEOLOGICAL SURVEY

Indian Agency _____

Navajo Tribal

Allottee _____

Lease No. 11-20-603-2199

Navajo Tribal "E"

	X	

SUNDRY NOTICES AND REPORTS ON WELLS

NOTICE OF INTENTION TO DRILL	<input checked="" type="checkbox"/>	SUBSEQUENT REPORT OF WATER SHUT-OFF	
NOTICE OF INTENTION TO CHANGE PLANS		SUBSEQUENT REPORT OF SHOOTING OR ACIDIZING	
NOTICE OF INTENTION TO TEST WATER SHUT-OFF		SUBSEQUENT REPORT OF ALTERING CASING	
NOTICE OF INTENTION TO REDRILL OR REPAIR WELL		SUBSEQUENT REPORT OF REDRILLING OR REPAIR	
NOTICE OF INTENTION TO SHOOT OR ACIDIZE		SUBSEQUENT REPORT OF ABANDONMENT	
NOTICE OF INTENTION TO PULL OR ALTER CASING		SUPPLEMENTARY WELL HISTORY	
NOTICE OF INTENTION TO ABANDON WELL			

(INDICATE ABOVE BY CHECK MARK NATURE OF REPORT, NOTICE, OR OTHER DATA)

Navajo Tribal "E"

Farmington, New Mexico February 1, 1961

Well No. 9 is located 1830 ft. from N line and 1830 ft. from E line of sec. 22

SW 1/4 NE 1/4 of Section 22 T-29N R-11W N. 1. P. M.
(1/4 Sec. and Sec. No.) (Twp.) (Range) (Meridian)

Cha Cha Gallup San Juan New Mexico
(Field) (County or Subdivision) (State or Territory)

The elevation of the derrick floor above sea level is _____ ft. (To be reported later)

DETAILS OF WORK

(State names of and expected depths to objective sands; show sizes, weights, and lengths of proposed casings; indicate mudding jobs, cementing points, and all other important proposed work)

We propose to drill the above well to approximately 4950' to test and develop productive Gallup zones. Stimulation will be as indicated upon penetration of Gallup pay. Rotary tools will be used to total depth. Casing program as follows:

SIZE	DEPTH	CEMENT	REMARKS
8-5/8"	200'	110-160 sz	Test - circulate.
4-1/2"	4950'	125 sz	6% gel with 1 1/2 pounds Taf Plug per sz.
		75 sz	Test.

Copies of location plate attached. A copy of any survey taken will be submitted upon completion of well.

I understand that this plan of work must receive approval in writing by the Geological Survey before operations may be commenced.

Company Pan American Petroleum Corporation

Address Box 480

Farmington, New Mexico

Attn: L. O. Spear, Jr.

ORIGINAL SIGNED BY

R. M. Bauer, Jr.

By _____

Title Senior Petroleum Engineer

NEW MEXICO OIL CONSERVATION COMMISSION

Well Location and Acreage Dedication Plat

SECTION A.

Date **January 31, 1961**Operator **PAN AMERICAN PETROLEUM CORPORATION**Lease **Navajo Tribal "E"**Well No. **9** Unit Letter **G** Section **22**Township **29-N.** Range **14-W.** NMPMLocated **1830** Feet From **North**Line **1830**Feet From **East**

NMPM

County **San Juan**

G. L. Elevation

To be reported laterDedicated Acreage **80**

Acres

Name of Producing Formation **Gallup**Pool **Cha Cha Gallup**

1. Is the Operator the only owner* in the dedicated acreage outlined on the plat below? Yes ☒ No
2. If the answer to question One is "No," have the interests of all the owners been consolidated by communitization agreement or otherwise? Yes No If answer is "Yes," Type of Consolidation
3. If the answer to question Two is "No," list all the owners and their respective interests below:

OWNER

LAND DESCRIPTION

SECTION B.

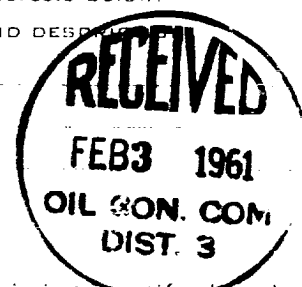
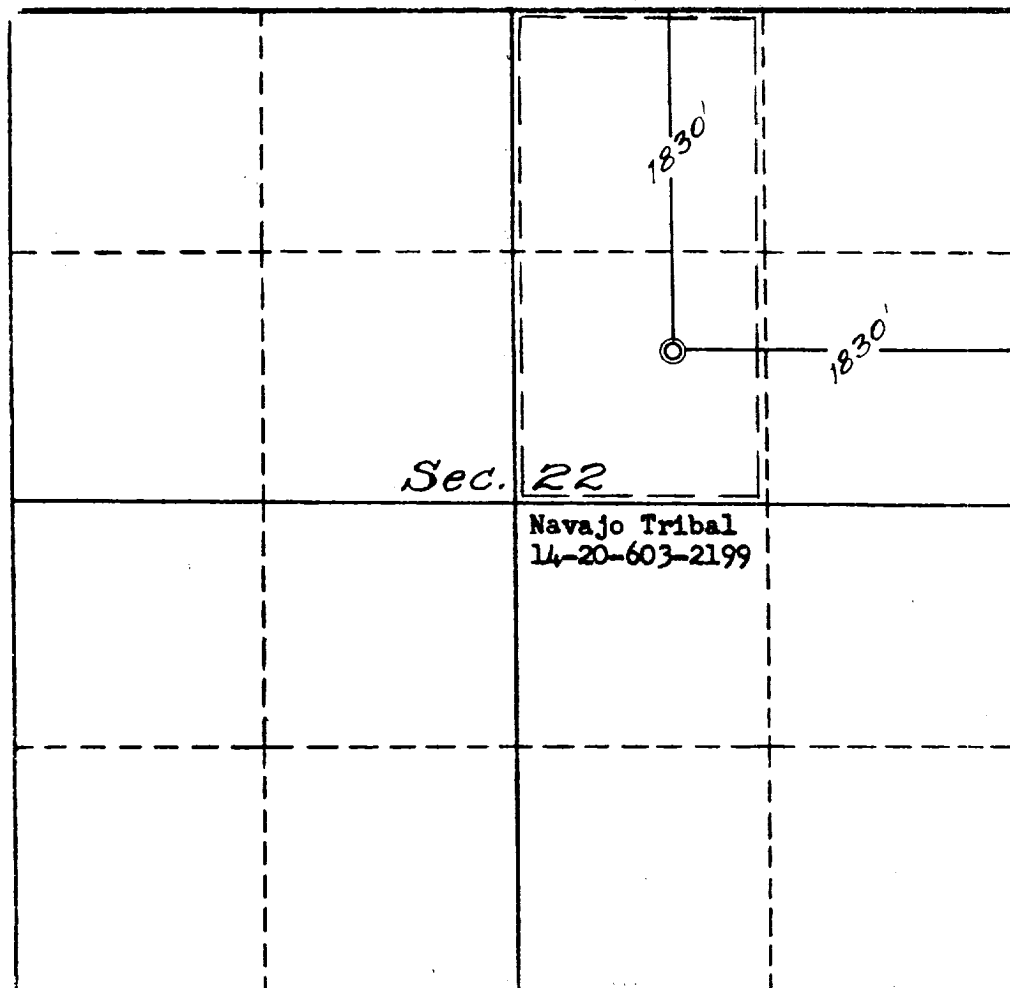

This is to certify that the information in Section A above is true and complete to the best of my knowledge and belief.

Pan American Petroleum Corp.

(OPERATOR)

R. M. Bauer, Jr. *RMBauer Jr.*

(REPRESENTATIVE)

Box 480, Farmington, N. Mex.

(ADDRESS)

This is to certify that the well location shown on the plat in Section B was plotted from field notes of actual surveys made by me or under my supervision and that the same is true and correct to the best of my knowledge and belief.

Date Surveyed **1-31-61**
Four States Engineering Co.
 FARMINGTON, NEW MEXICO

E. V. E. Barker
 REGISTERED ENGINEER OR
 LAND SURVEYOR
Certificate No. **1545**