

NEW MEXICO OIL CONSERVATION COMMISSION
Santa Fe, New Mexico

Form C-101
Revised (12/1/55)

NOTICE OF INTENTION TO DRILL

Notice must be given to the District Office of the Oil Conservation Commission and approval obtained before drilling or recompletion begins. If changes in the proposed plan are considered advisable, a copy of this notice showing such changes will be returned to the sender. Submit this notice in QUINTUPLICATE. One copy will be returned following approval. See additional instructions in Rules and Regulations of the Commission. If State Land submit 6 Copies Attach Form C- 128 in triplicate to first 3 copies of form C-101

142 Truman, N.E. Albuquerque, N.M. 5/17/60
(Place) (Date)

OIL CONSERVATION COMMISSION
SANTA FE, NEW MEXICO

Gentlemen:

You are hereby notified that it is our intention to commence the Drilling of a well to be known as

Basin Company

(Company or Operator)

Ted M. White
(Lease)

Well No. 77, in F (Unit) The well is

located 1850 feet from the West line and 1450 feet from the North

(GIVE LOCATION FROM SECTION LINE)

Line of Section 20, T. 29N, R. 13W, NMPM.

West Kutz Pool, San Juan County

D	C	B	A
E	F	G	H
L	K	J	I
M	N	O	P

If State Land the Oil and Gas Lease is No

If patented land the owner is Agnes C. Eaton & Siddy C. Smith

Address 801 E. Garcia, Santa Fe, New Mexico

We propose to drill well with drilling equipment as follows:

Cable Tools

The status of plugging bond is State Wide Bond on file

Drilling Contractor E. E. Barrett Drilling Co.
Farmington, New Mexico

We intend to complete this well in the Pictured Cliffs formation at an approximate depth of 1100 feet.

CASING PROGRAM

We propose to use the following strings of Casing and to cement them as indicated:

Size of Hole	Size of Casing	Weight per Foot	New or Second Hand	Depth	Sacks Cement
12"	8 5/8	24		110	45
8"	5 1/2	15 1/2		1100	50

If changes in the above plans become advisable we will notify you immediately.

ADDITIONAL INFORMATION (If recompletion give full details of proposed plan of work.)

Approved 5-18, 1960
Except as follows:

Sincerely yours,

Basin Company
(Company or Operator)

By C. E. Stewart

Position Agent
Send Communications regarding well to

Name Ted M. White

Address 142 Truman, N.E. Albuquerque, N.M.

OIL CONSERVATION COMMISSION

By

NEW MEXICO OIL CONSERVATION COMMISSION
WELL LOCATION AND ACREAGE DEDICATION PLAT

FORM C-128
Revised 5/1/57

SEE INSTRUCTIONS FOR COMPLETING THIS FORM ON THE REVERSE SIDE

SECTION A

Operator Basin Company		Lease Ted M. White		Well No. 77
Unit Letter F	Section 20	Township 29 NORTH	Range 13 WEST	County SAN JUAN
Actual Footage Location of Well: 1450 feet from the NORTH line and 1850 feet from the WEST line				
Ground Level Elev. 5331.0	Producing Formation Pictured Cliffs		Pool West Kutz	Dedicated Acreage: 160 Acres

1. Is the Operator the only owner in the dedicated acreage outlined on the plat below? YES ☒ NO ____ . ("Owner" means the person who has the right to drill into and to produce from any pool and to appropriate the production either for himself or for himself and another. (65-3-29 (e) NMSA 1935 Comp.)
2. If the answer to question one is "no," have the interests of all the owners been consolidated by communitization agreement or otherwise? YES ____ NO ____ . If answer is "yes," Type of Consolidation ____
3. If the answer to question two is "no," list all the owners and their respective interests below:

Owner	Land Description

SECTION B

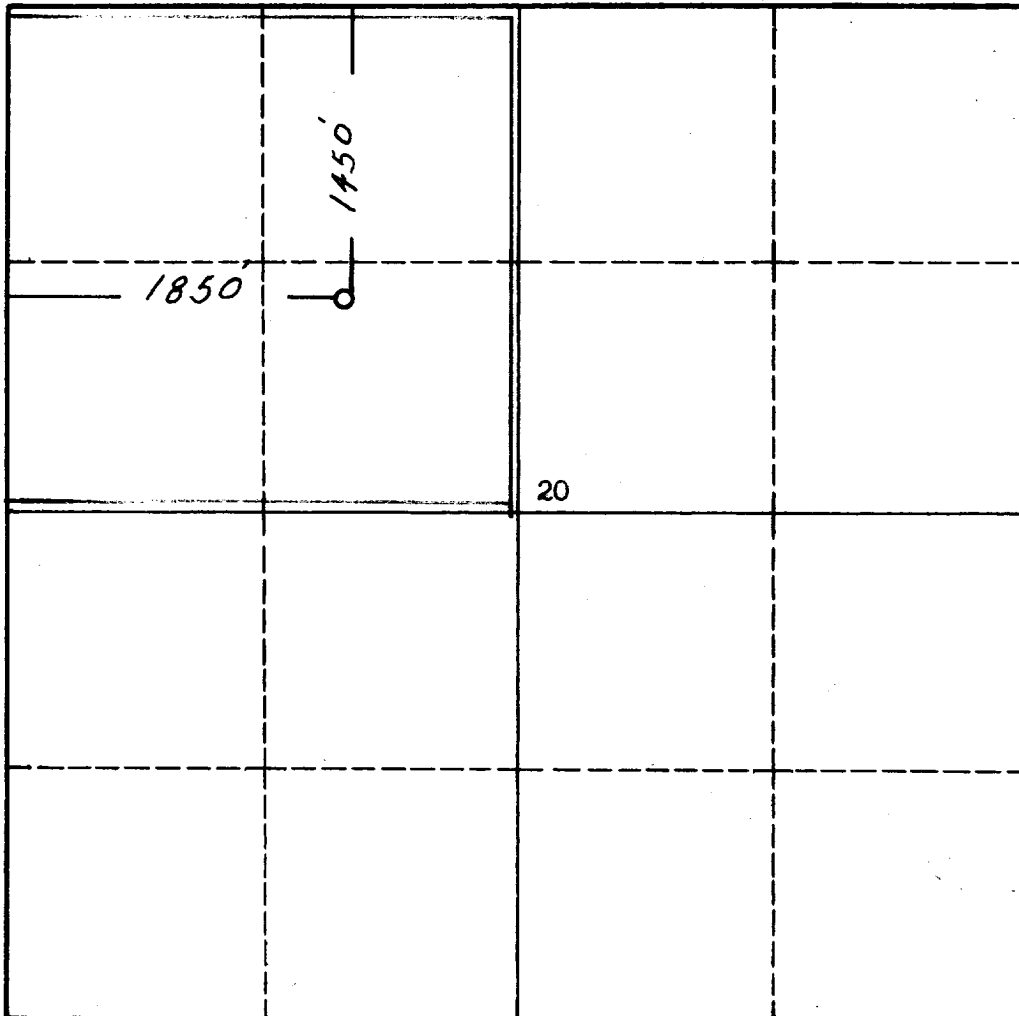

CERTIFICATION

I hereby certify that the information in SECTION A above is true and complete to the best of my knowledge and belief.

Name **C. E. Stewart**

Position **Agent**

Company **Basin Co.**

Date **5/17/60**

REF. GLO PLAT DATED 19 APRIL 1881

I hereby certify that the well location shown on the plat in SECTION B was plotted from field notes of actual surveys made by me or under my supervision, and that the same is true and correct to the best of my knowledge and belief.

Date Surveyed
4 FEBRUARY 1959

Registered Professional Engineer
and/or Land Surveyor
James P. Lease

Certificate No. **1463**

0 330 660 990 1320 1650 1980 2310 2640 2000 1500 1000 500 0

INSTRUCTIONS FOR COMPLETION OF FORM C-128

1. Operator shall furnish and certify to the information called for in Section A.
2. Operator shall outline the dedicated acreage for *both* oil and gas wells on the plat in Section B.
3. A registered professional engineer or land surveyor registered in the State of New Mexico or approved by the Commission shall show on the plat the location of the well and certify this information in the space provided.
4. All distances shown on the plat must be from the outer boundaries of the Section.
5. If additional space is needed for listing owners and their respective interests as required in question 3 of Section A, please use space below.

STATE OF NEW MEXICO	
OIL CONSERVATION COMMISSION	
AZUL DISTRICT OFFICE	
NUMBER OF COPIES RECEIVED	3
SANTA FE	
FILE	
D.S.T.S.	1
LAND RECORDS	2
TRANS. OIL R.	
PRODUCTION OFFICE	
OPERATOR	1