

Form 9-331a
(Feb. 1961)

(SUBMIT IN TRIPLICATE)

UNITED STATES
DEPARTMENT OF THE INTERIOR
GEOLOGICAL SURVEY

Land Office Santa Fe
Lease No. 82-077096
Unit Industrial

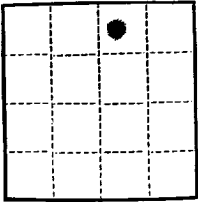

SUNDRY NOTICES AND REPORTS ON WELLS

NOTICE OF INTENTION TO DRILL	<input checked="" type="checkbox"/>	SUBSEQUENT REPORT OF WATER SHUT-OFF	<div style="border: 2px solid black; padding: 5px; text-align: center;"> RECEIVED OCT 9 1961 </div>
NOTICE OF INTENTION TO CHANGE PLANS	<input type="checkbox"/>	SUBSEQUENT REPORT OF SHOOTING OR ACIDIZING	
NOTICE OF INTENTION TO TEST WATER SHUT-OFF	<input type="checkbox"/>	SUBSEQUENT REPORT OF ALTERING	
NOTICE OF INTENTION TO RE-DRILL OR REPAIR WELL	<input type="checkbox"/>	SUBSEQUENT REPORT OF RE-DRILLING OR REPAIR	
NOTICE OF INTENTION TO SHOOT OR ACIDIZE	<input type="checkbox"/>	SUBSEQUENT REPORT OF ABANDONMENT	
NOTICE OF INTENTION TO PULL OR ALTER CASING	<input type="checkbox"/>	SUPPLEMENTARY WELL HISTORY	
NOTICE OF INTENTION TO ABANDON WELL	<input type="checkbox"/>		

(INDICATE ABOVE BY CHECK MARK NATURE OF REPORT, NOTICE, OR OTHER DATA)

U.S. GEOLOGICAL SURVEY
FARMINGTON, NEW MEXICO

October 6, 1961

Well No. Industrial 6-1 is located 990 ft. from N line and 1930 ft. from E line of sec. 19

SW 1/4, Section 19 (1/4 Sec. and Sec. No.)
SW 1/4 (Twp.) 11N (Range) R. 14 E. 11 N. (Meridian)
Santa Fe (Field) San Juan (County or Subdivision) New Mexico (State or Territory)

The elevation of the derrick floor above sea level is 5207 ft. Ungraded Ground Elevation

DETAILS OF WORK

(State names of and expected depths to objective sands; show sizes, weights, and lengths of proposed casings; indicate mudding jobs, cementing points, and all other important proposed work)

Propose to: Set 300 ft. of 8 1/8" surface casing and cement to surface. Drill with rotary tools to approximate total depth of 630 ft. or through Dakota formation. Set 4 1/2" casing at total depth and cement with 200 cu. Set IV Seal approximately 100 ft. below the Dakota formation and cement with 300 cu.

Perforate Dakota formation. Sand-water flow with 20,000 gal. and 20,000 gal. water. Run 2 1/8" tubing.

North one-half, 317.35 acres, Section 19 dedicated to well.

I understand that this plan of work must receive approval in writing by the Geological Survey before operations may be commenced.

Company Apache Oil and Gas Company

Address P. O. Boxer 775
Farmington, New Mexico

By Joe C. Salinas
Title District Superintendent

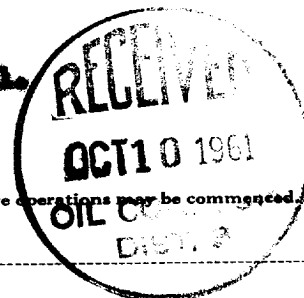

NEW MEXICO OIL CONSERVATION COMMISSION
Well Location and Acreage Dedication Plat

SECTION A.

Date **May 1, 1961**

Operator **Artec Oil and Gas Company** Lease **McDaniel**
Well No. **c-1** Unit Letter **B** Section **19** Township **29** Range **11** NMPM
Located **990** Feet From **North** Line, **1550** Feet From **East** Line
County **San Juan** G. L. Elevation **5587** Dedicated Acreage **300 317.55** Acres
Name of Producing Formation **Dakota** Pool **Basin**

1. Is the Operator the only owner* in the dedicated acreage outlined on the plat below? Yes **XX** No
2. If the answer to question One is "No," have the interests of all the owners been consolidated by communization agreement or otherwise? Yes No If answer is "Yes," Type of Consolidation
3. If the answer to question Two is "No," list all the owners and their respective interests below

OWNER

LAND DESCRIPTION

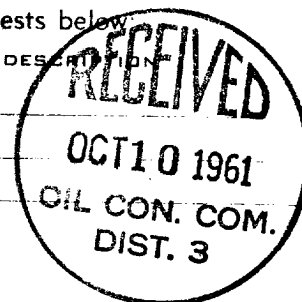

SECTION B.

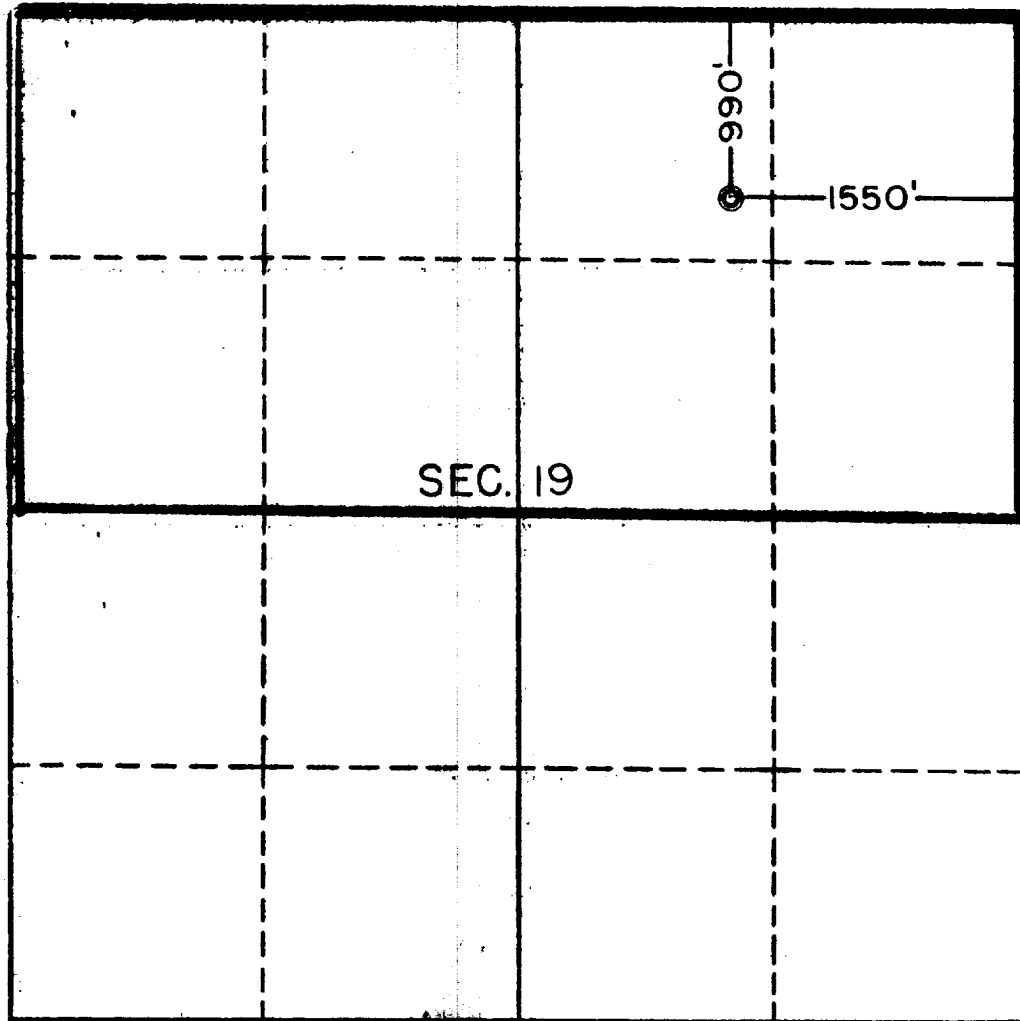

This is to certify that the information in Section A above is true and complete to the best of my knowledge and belief.

Artec Oil and Gas Company
(OPERATOR)

ORIGINAL SIGNED BY **JOE C. SALMON**
(REPRESENTATIVE)

Joe C. Salmon
District Superintendent
Drawer 570, Farmington, N.M.

This is to certify that the well location shown on the plat in Section B was plotted from field notes of actual surveys made by me or under my supervision and that the same is true and correct to the best of my knowledge and belief.

Date Surveyed **April 26, 1961**
Four States Engineering Co.
FARMINGTON, NEW MEXICO

Charles H. Cookshaw
REGISTERED ENGINEER OR
LAND SURVEYOR

Certificate No **2090**

