

(SUBMIT IN TRIPLICATE)

UNITED STATES  
DEPARTMENT OF THE INTERIOR  
GEOLOGICAL SURVEY

Land Office Santa Fe  
Lease No. 078266  
Unit San Jacinto

SUNDRY NOTICES AND REPORTS ON WELLS

NOTICE OF INTENTION TO DRILL	<input checked="" type="checkbox"/>	SUBSEQUENT REPORT OF WATER SHUT-OFF	
NOTICE OF INTENTION TO CHANGE PLANS		SUBSEQUENT REPORT OF SHOOTING OR ACIDIZING	
NOTICE OF INTENTION TO TEST WATER SHUT-OFF		SUBSEQUENT REPORT OF ALTERING CASING	
NOTICE OF INTENTION TO RE-DRILL OR REPAIR WELL		SUBSEQUENT REPORT OF RE-DRILLING OR REPAIR	
NOTICE OF INTENTION TO SHOOT OR ACIDIZE		SUBSEQUENT REPORT OF ABANDONMENT	
NOTICE OF INTENTION TO PULL OR ALTER CASING		SUPPLEMENTARY WELL HISTORY	
NOTICE OF INTENTION TO ABANDON WELL			

(INDICATE ABOVE BY CHECK MARK NATURE OF REPORT, NOTICE, OR OTHER DATA)

October 2, 19 57

Well No. 3 is located 890 ft. from N line and 890 ft. from EX line of sec. 24  
SW Sec. 24 29N 10W N.M.P.M.  
( $\frac{1}{4}$  Sec. and Sec. No.) (Twp.) (Range) (Meridian)  
Aztec P. Co. San Juan New Mexico  
(Field) (County or Subdivision) (State or Territory)

The elevation of the derrick floor above sea level is 5767 ft.

DETAILS OF WORK

(State names of and expected depths to objective sands; show sizes, weights, and lengths of proposed casings; indicate mudding jobs, cementing points, and all other important proposed work)

It is intended to drill a well thru the Pictured Cliff formation using rotary tools and to perforate and water fracture possible producing zones. Estimated Total Depth 2230'.

Casing Program:

9 5/8" at 120' with 125 sacks regular cement circulated to surface.  
5 1/2" at 2230' with 75 sacks regular cement, 75 sacks Borehole

The NW/4 of Section 24 is dedicated to this well

(SP 078266 1/2 NW/4; SEMW)  
NW/4 (Fee Pan American Pet. SEMW)

I understand that this plan of work must receive approval in writing by the Geological Survey before operations may be commenced.

Company El Paso Natural Gas Company

Address Box 997

Farmington, New Mexico

Original Signed D. C. Johnston

By \_\_\_\_\_

Title Petroleum Engineer

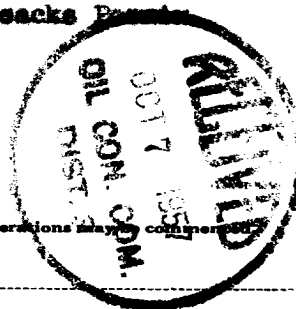

## NEW MEXICO OIL CONSERVATION COMMISSION

## Well Location and Acreage Dedication Plat

Section A.

Date **AUGUST 6, 1957**

Operator **EL PASO NATURAL GAS COMPANY** Lease **SAN JACINTO** SF **078266**  
 Well No. **3** Unit Letter **D** Section **24** Township **29-N** Range **10-W** NMPM  
 Located **890** Feet From **NORTH** Line **890** Foot From **WEST** Line  
 County **SAN JUAN** G. L. Elevation **5757** Dedicated Acreage **160** Acre  
 Name of Producing Formation **PICTURED CLIFF** Pool **AZTEC**

1. Is the Operator the only owner in the dedicated acreage outlined on this plat below?  
 Yes ☐ No ☒
2. If the answer to question one is "no", have the interests of all the owners been consolidated by communitization agreement or otherwise? Yes ☒ No ☐ If answer is "yes", Type of Consolidation:

**Communitization Agreement**

3. If the answer to question two is "no", list all the owners and their respective interests below:
- | Owner | Interest |
|-------|----------|
|-------|----------|

Section B.

This is to certify that the information in Section A above is true and complete to the best of my knowledge and belief.

**El Paso Natural Gas Company**  
 (Operator)

**Original Signed D. C. Johnston**  
 (Representative)

**Box 997**  
 (Address)  
**Farmington, New Mexico**

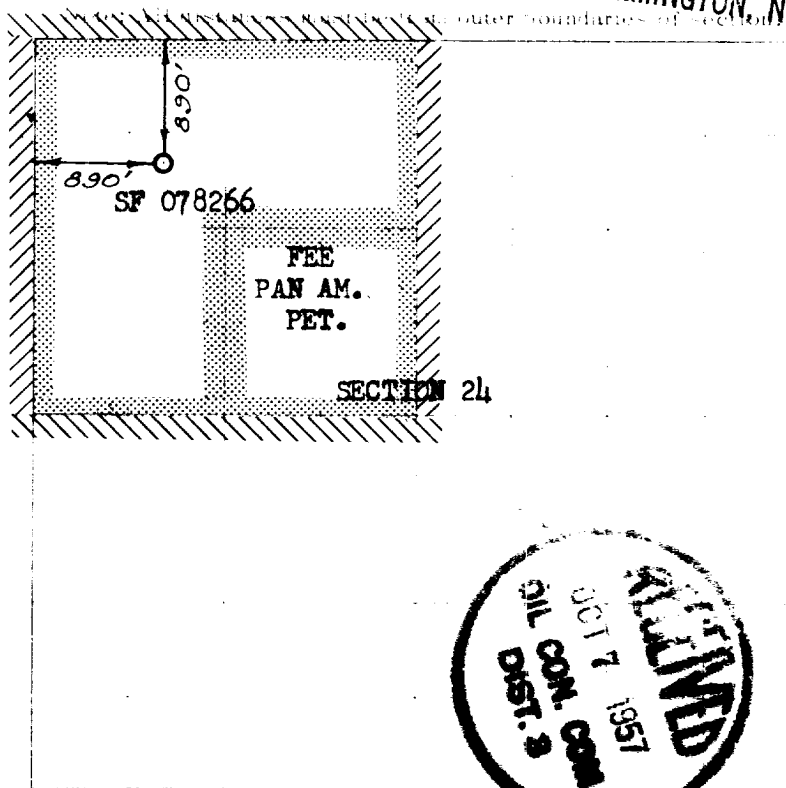

Scale 1 inch equals 1 mile

This is to certify that the above plat was prepared from field notes of actual surveys made by me or under my supervision and that the same are true and correct to the best of my knowledge and belief.

(Seal)

Date Surveyed **AUGUST 14 1957**

**C. O. Walker**  
 Registered Professional Engineer and/or Land Surveyor

Farmington, New Mexico