

NEW MEXICO OIL CONSERVATION COMMISSION

Santa Fe, New Mexico

NOTICE OF INTENTION TO DRILL OR RECOMPLETE

Notice must be given to the District Office of the Oil Conservation Commission and approval obtained before drilling or recompletion begins. If changes in the proposed plan are considered advisable, a copy of this notice showing such changes will be returned to the sender. Submit this notice in **QUINTUPLICATE**. One copy will be returned following approval. See additional instructions in Rules and Regulations of the Commission. **If State Land submit 6 Copies**

(Place)

(Date)

OIL CONSERVATION COMMISSION
SANTA FE, NEW MEXICO

Gentlemen:

You are hereby notified that in **MELBORNE PETROLEUM CORPORATION** (Recompletion) of a well to be known as

(Company or Operator)

M. T. Finch
(1) 790 (Lease) **NORTH**, Well No. **22-28-11W**, in **790** (Unit). The well is located **EAST** feet from the **BLOOMFIELD PICTURE CLIFF AND FRUITLAND** line and **SAN JUAN** feet from the **SAN JUAN**, NMPM.

(GIVE LOCATION FROM SECTION LINE)

D	C	B	A
E	F	G	H
L	K	J	I
M	N	O	P

Pool, **BLOOMFIELD**
If State Land the Oil and Gas Lease is No. **BLOOMFIELD**

If patented land the owner is **CARDWELL #60**
Address **ROTARY**

We propose to drill well with drilling equipment as follows:
BLANKET

The status of plugging bond is **JACK BELL**

Drilling Contractor **PICTURE CLIFF AND FRUITLAND**
1600

We intend to complete this well in the **1600** feet.
formation at an approximate depth of **1600** feet.

CASING PROGRAM

We propose to use the following strings of Casing and to cement them as indicated:

Size of Hole	Size of Casing	Weight per Foot	New or Second Hand	Depth	Sacks Cement
8" PROG STRING	SURFACE 7"	22 LBS	NEW	100 FT	250
	4 1/2"	11	NEW	1600	200

If changes in the above plans become advisable we will notify you immediately.

ADDITIONAL INFORMATION (If recompletion give full details of proposed plan of work.)

*intend to test both Fruitland & Pictured Cliffs Formations
& complete in whichever zone production is indicated*

Melborne Petroleum Corporation,

Approved *5-10-57*, 1957
Except as follows:

Sincerely yours,

(Company or Operator)
By *Harry D. Dredford*
710 S. W. Lead
Position **Albuquerque, N. M. President**
Send Communications regarding well to

OIL CONSERVATION COMMISSION

By *A. R. Reed*

Name
Address

NEW MEXICO
OIL CONSERVATION COMMISSION

Form C-128

Well Location and/or Gas Proration Plat

Date APRIL 20th, 57.

Operator MELBORNE PETROLEUM CORP Lease BOBY FINCH

Well No. 2 Section 22 Township 29 NORTH Range 11 WEST NMPM

Located 790 Feet From the NORTH Line, 790 Feet From the EAST Line,

SAN JUAN County, New Mexico. G. L. Elevation 5482.0 UNGRADED

Name of Producing Formation Frutland-- Pool Picture-Cliff Dedicated Acreage 160

(Note: All distances must be from outer boundaries of Section)

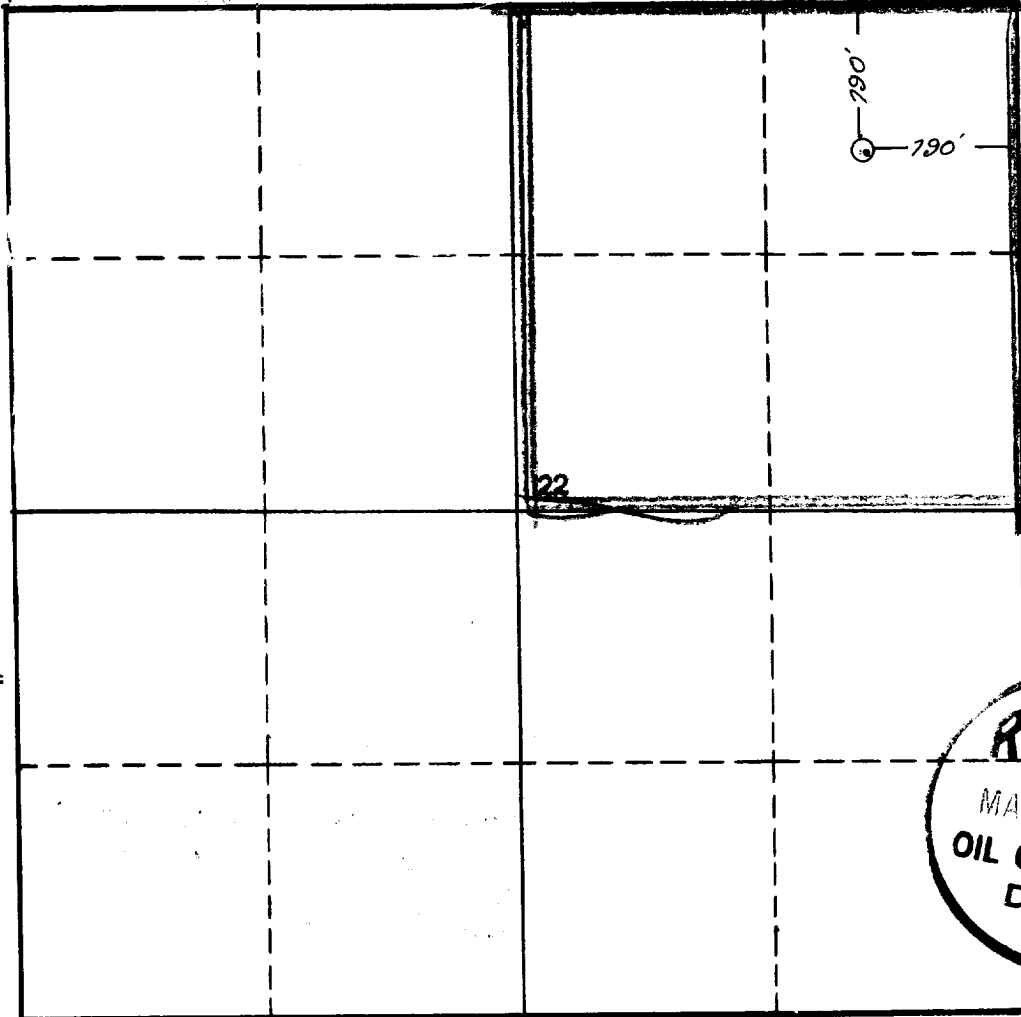

NOTE

This section of
form is to be
used for gas
wells only.



SCALE: 1"=1000'

1. Is this Well a Dual Comp.? Yes No .
2. If the answer to Question 1 is yes, are there any other dually completed wells within the dedicated acreage? Yes No .

Name Melborne Petroleum Corp
Position President
Representing
Address 710 S.W. Lead, Albuq, N.M.

This is to certify that the above plat was prepared from field notes of actual surveys made by me or under my supervision and that the same are true and correct to the best of my knowledge and belief.

Date Surveyed 11 APRIL 1957
James P. Leese
Registered Professional Engineer and/or
Land Surveyor James P. Leese
N. Mex. Reg. No. 1463

(1) 186

OIL CONSERVATION COMMISSION		
AZTEC DISTRICT OFFICE		
No. Copies Received	5	
DISTRIBUTION		
Operator	1	
Santa Fe	1	
Proration Office		
State Land Office		
U. S. G. S.	2	
Transporter		
File	1	✓