

NEW MEXICO OIL CONSERVATION COMMISSION  
Santa Fe, New Mexico

Form C-101  
Revised (12/1/55)

NOTICE OF INTENTION TO DRILL

Notice must be given to the District Office of the Oil Conservation Commission and approval obtained before drilling or recompletion begins. If changes in the proposed plan are considered advisable, a copy of this notice showing such changes will be returned to the sender. Submit this notice in QUINTUPPLICATE. One copy will be returned following approval. See additional instructions in Rules and Regulations of the Commission. If State Land submit 6 Copies Attach Form C- 128 in triplicate to first 3 copies of form C-101

Farmington, New Mexico

(Place)

August 14, 1961

(Date)

OIL CONSERVATION COMMISSION  
SANTA FE, NEW MEXICO

Gentlemen:

You are hereby notified that it is our intention to commence the Drilling of a well to be known as

Pan American Petroleum Corporation

(Company or Operator)

Gallegos Canyon Unit

(Lease)

Well No. 106

A

The well is

located 790 feet from the

North

line and

(Unit)

990

feet from the

East

line of Section 24

T. 29N

R. 13W

NMPM.

(GIVE LOCATION FROM SECTION LINE)

Basin Dakota

Pool, San Juan

County

If State Land the Oil and Gas Lease is No.

If patented land the owner is Anthony J. Michel & John J. Michel

Address

We propose to drill well with drilling equipment as follows: Rotary tools to total depth.

The status of plugging bond is State wide

Drilling Contractor Brannon and Murray Drilling Company

Box 672

Coleman, Texas

We intend to complete this well in the Dakota

formation at an approximate depth of 6250'

CASING PROGRAM

We propose to use the following strings of Casing and to cement them as indicated:

Size of Hole	Size of Casing	Weight per Foot	New or Second Hand	Depth	Sacks Cement
12-1/4"	8-5/8"	22.7	New	350	250
7-7/8"	4-1/2"	9.5	New	6250	525*

If changes in the above plans become advisable we will notify you immediately.

ADDITIONAL INFORMATION (If recompletion give full details of proposed plan of work.) 4-1/2" casing will be cemented by 2-stage method with stage tool set about 100' below base of Pictured Cliffs. First stage will consist of sufficient cement to fill 500' above top of Gallup. Second stage will consist of sufficient cement to fill 300' above top of Pictured Cliffs.

Copies of location plat are attached. Copies of any logs run will be forwarded upon completion of well.

Approved  
Except as follows:

Sincerely yours,

Pan American Petroleum Corporation

(Company or Operator)  
ORIGINAL SIGNED BY

By L. O. Speer, Jr.

Position Area Superintendent

Send Communications regarding well to

Name Pan American Petroleum Corporation

Address Box 480, Farmington, New Mexico

Attn: L. O. Speer, Jr.

OIL CONSERVATION COMMISSION

By [Signature]  
Verbal approval August 14, 1961 Kendrick to Glover.

## NEW MEXICO OIL CONSERVATION COMMISSION

## Well Location and Acreage Dedication Plat

Section A.

Date August 11, 1961

Operator PAN AMERICAN PETROLEUM CORPORATION Lease Gallegos Canyon Unit  
 Well No. 106 Unit Letter A Section 24 Township 29 NORTH Range 13 WEST NMPM  
 Located 790 Feet From THE NORTH Line, 990 Feet From THE EAST Line  
 County SAN JUAN G. L. Elevation To Report Later Dedicated Acreage 320 Acres  
 Name of Producing Formation Dakota Pool Basin Dakota

1. Is the Operator the only owner in the dedicated acreage outlined on the plat below?

Yes    No   2. If the answer to question one is "no", have the interests of all the owners been consolidated by communitization agreement or otherwise? Yes    No   . If answer is "yes", Type of Consolidation, Gallegos Canyon Unit acreage

3. If the answer to question two is "no", list all the owners and their respective interests below:

Owner

Land Description

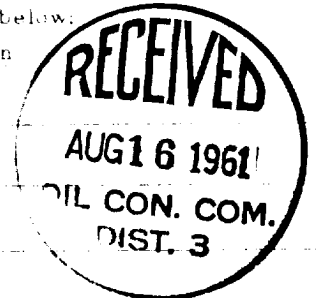

Section B.

Note: All distances must be from outer boundaries of section.

This is to certify that the information  
 in Section A above is true and complete  
 to the best of my knowledge and belief.

Pan American Petroleum Corporation

(Operator)

R. M. Bauer, Jr. *RMBauer, Jr.*

(Representative)

Box 480, Farmington, New Mexico  
(Address)

Fee Lease

Anthony J. Michel  
John A. Michel

Ref. GLO Plat dated: 19 April 1881

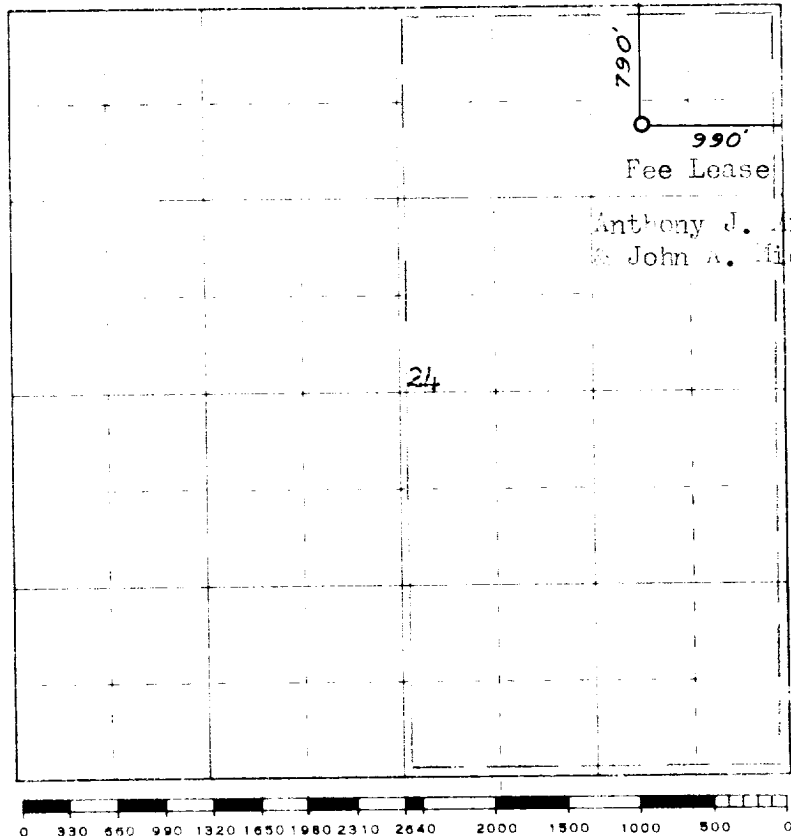

Scale 4 inches equal 1 mile



This is to certify that the above plat was prepared from field notes of actual surveys  
 made by me or under my supervision and that the same are true and correct to the best  
 of my knowledge and belief.

Date Surveyed August 4, 1961

*James P. Lease*  
 Registered Professional Engineer and/or Land Surveyor  
 James P. Lease N. Mex. Reg. No. 1463