

FORM 430 3-48

ROUTE TICKET

TO Mr. E. C. Arnold

LOCATION NMOCC - Aztec

FLOOR NO.

REMARKS:

FROM L. O. Speer, Jr.

DATE

PAN AMERICAN PETROLEUM CORPORATION

Box 480, Farmington, New Mexico
December 23, 1960

File: B-2429-400.1

Subject: Request for Approval of
Non-Standard Well Location
Navajo Tribal "Q" No. 5
Cha Cha Gallup Field

Mr. A. L. Porter (2)
New Mexico Oil Conservation Commission
Box 871
Santa Fe, New Mexico

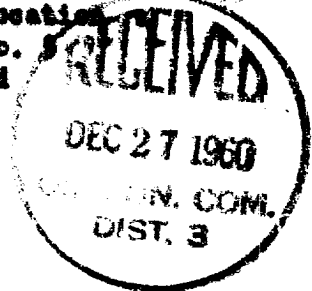

Dear Sir:

Pan American Petroleum Corporation has staked the Navajo Tribal "Q" No. 5 in the Cha Cha Gallup Field at a footage distance of 1830 feet from the south line and 885 feet from the east line of Section 18, T-29-N, R-14-W, San Juan County, New Mexico. The standard location in the NE 1/4 NW 1/4 of Section 18 falls in a beaver pond in a slough along the San Juan river which necessitated moving the site to the river bank at the unorthodox location. *SE 1/4*

It is respectfully requested that Pan American be granted administrative exception to Cha Cha Gallup Field oil well location requirements and approval of the non-standard location for Navajo Tribal "Q" No. 5 due to the topographical situation described. These conditions are also illustrated on the attached copy of the location plat for the well. The ownership and royalty interest of all oil and gas leases within a 660-foot radius is common to that of the proposed location.

The drilling of Navajo Tribal "Q" No. 5 in the NE 1/4 NW 1/4 of Section 18 is planned to permit orderly development of these properties. We would appreciate being notified of your decision on our request for approval of the non-standard location by collect wire in order to minimize rig delay. *SE 1/4*

Yours very truly,

PAN AMERICAN PETROLEUM CORPORATION

L. O. Speer, Jr.
L. O. Speer, Jr.
Area Superintendent

RMB:hh
Attach.

cc: Mr. E. C. Arnold ✓
NMOCC - Aztec, N. M.

Mr. P. T. McGrath
USGS - Farmington, N. M.

COPY

FALL AMERICAN RE-FOOTING INFORMATION

Box 480, Farmington, New Mexico
December 28, 1950

11111 11111

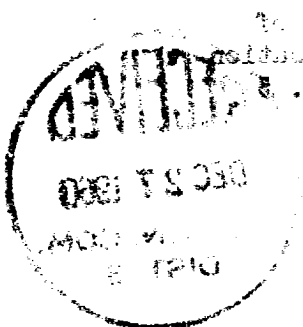

Subject: New York University
New York University
New York University
New York University

Mr. A. B. Brown (Mr.)
New Mexico State University
Box 27
Santa Fe, New Mexico

Dear Sir:

The American Petroleum Corporation has asked the State of New Mexico to issue a license to the company to drill a well in the area of the Santa Fe River. The company has been drilling in the area of the Santa Fe River for some time and has been successful in finding oil. The company has been drilling in the area of the Santa Fe River for some time and has been successful in finding oil. The company has been drilling in the area of the Santa Fe River for some time and has been successful in finding oil.

It is respectfully requested that you issue a license to the company to drill a well in the area of the Santa Fe River. The company has been drilling in the area of the Santa Fe River for some time and has been successful in finding oil. The company has been drilling in the area of the Santa Fe River for some time and has been successful in finding oil. The company has been drilling in the area of the Santa Fe River for some time and has been successful in finding oil.

The American Petroleum Corporation has asked the State of New Mexico to issue a license to the company to drill a well in the area of the Santa Fe River. The company has been drilling in the area of the Santa Fe River for some time and has been successful in finding oil. The company has been drilling in the area of the Santa Fe River for some time and has been successful in finding oil. The company has been drilling in the area of the Santa Fe River for some time and has been successful in finding oil.

Yours very truly,

Mr. A. B. Brown (Mr.)

Mr. A. B. Brown (Mr.)

Mr. A. B. Brown (Mr.)

Mr. A. B. Brown (Mr.)

Mr. A. B. Brown (Mr.)

Mr. A. B. Brown (Mr.)

COPY

NEW MEXICO OIL CONSERVATION COMMISSION

Well Location and Acreage Dedication Plot

SECTION A.

Date 12-21-60

Operator PAN AMERICAN PETROLEUM CORPORATION Lease Range 24 North
 Well No. 5 Unit Lease X Section 18 Township 33 North Range 24 North NADEN
 Latitud 3430 Feet From the North Line, 235 Feet From the East Line
 County Salt Lake G. L. Elevation _____ Dedicated Acreage _____
 Name of Producing Formation Salt Lake Pool the Salt Lake

1. Is the Operator the only owner* in the dedicated acreage outlined on the plot below? Yes X No _____
2. If the answer to question One is "No," have the interests of all the owners been consolidated by communization agreement or otherwise? Yes _____ No _____ If answer is "Yes," Type of Consolidation _____
3. If the answer to question Two is "No," list all the owners and their respective interests below:

OWNER

LAND DESCRIPTION

SECTION B.

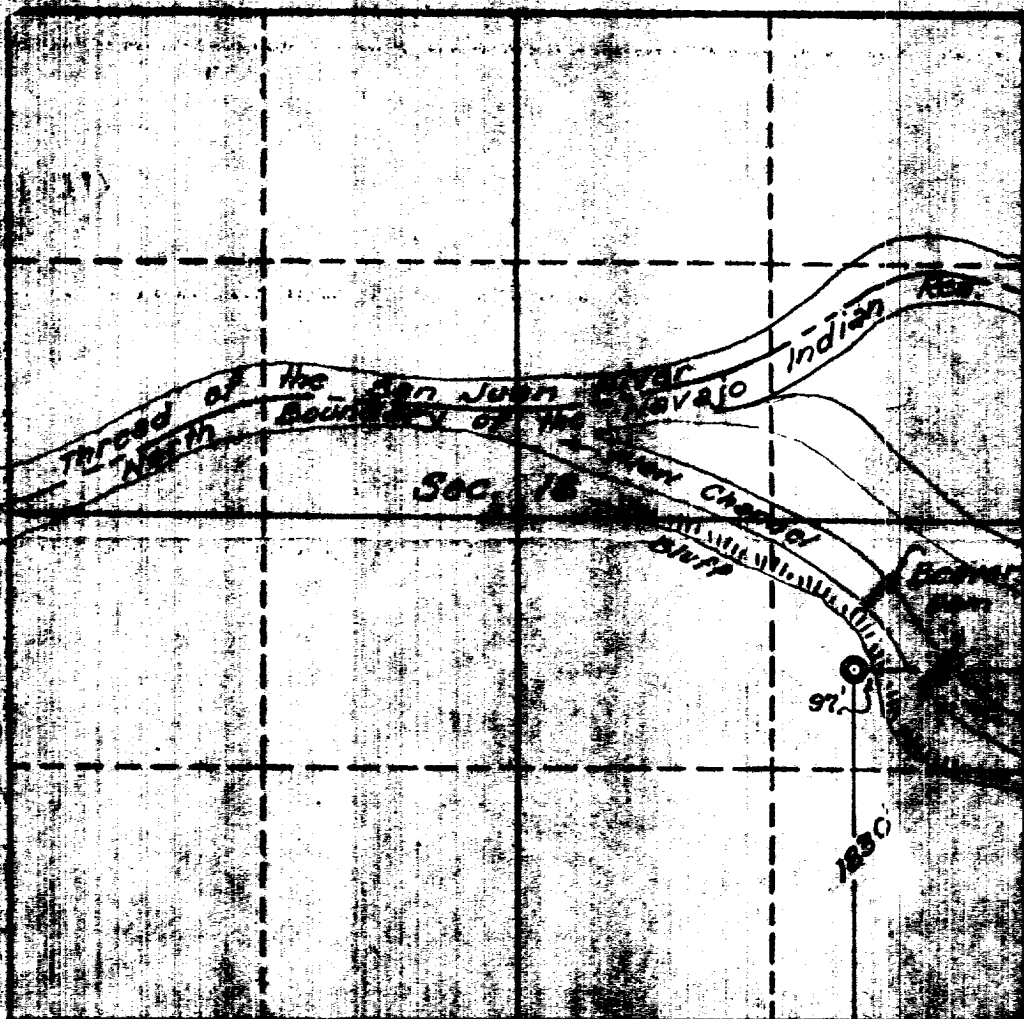

This is to certify that the information in Section A above is true and complete to the best of my knowledge and belief.

(OPERATOR)

(REPRESENTATIVE)

This is to certify that the location shown on the map in Section B was placed there and is not actual or under any other name or form of knowledge and belief.

Date Surveyed 12-21-60

For Notes Engineering Co.
 PHOENIX, NEW MEXICO

[Signature]
 REPRESENTATIVE OF OPERATOR

Well No. 5

