

(SUBMIT IN TRIPLICATE)

UNITED STATES
DEPARTMENT OF THE INTERIOR
GEOLOGICAL SURVEY

Land Office Santa Fe

Lease No. 87-80600

Unit Gallegos Canyon Unit

13

X			

SUNDRY NOTICES AND REPORTS ON WELLS

NOTICE OF INTENTION TO DRILL	X	SUBSEQUENT REPORT OF WATER SHUT-OFF	
NOTICE OF INTENTION TO CHANGE PLANS		SUBSEQUENT REPORT OF SHOOTING OR ACIDIZING	
NOTICE OF INTENTION TO TEST WATER SHUT-OFF		SUBSEQUENT REPORT OF ALTERING CASING	
NOTICE OF INTENTION TO RE-DRILL OR REPAIR WELL		SUBSEQUENT REPORT OF RE-DRILLING OR REPAIR	
NOTICE OF INTENTION TO SHOOT OR ACIDIZE		SUBSEQUENT REPORT OF ABANDONMENT	
NOTICE OF INTENTION TO PULL OR ALTER CASING		SUPPLEMENTARY WELL HISTORY	
NOTICE OF INTENTION TO ABANDON WELL			

(INDICATE ABOVE BY CHECK MARK NATURE OF REPORT, NOTICE, OR OTHER DATA)

Gallegos Canyon Unit

Farmington, New Mexico May 22, 1963

Well No. 134 is located 875 ft. from N line and 845 ft. from W line of sec. 17

34/4, 34/4 Section 17
(1/4 Sec. and Sec. No.)

T-29N
(Twp.)

R-12W
(Range)

N.M.P.M.
(Meridian)

Basin Dakota
(Field)

San Juan
(County or Subdivision)

New Mexico
(State or Territory)

The elevation of the derrick floor above sea level is _____ ft. (To be reported later)

DETAILS OF WORK

(State names of and expected depths to objective sands; show sizes, weights, and lengths of proposed casings; indicate mudding jobs, cementing points, and all other important proposed work)

We propose to drill the above well to approximately 6400' with rotary tools to evaluate the Dakota zone. Stimulation and completion will be as indicated upon reaching total depth. The following casing program is proposed:

SIZE	DEPTH	CEMENT	REMARKS
8-5/8"	350'	250 sz.	Circulate to surface.
4-1/2"	6400'	First Stage	300 sacks 4% Gel with 1-1/2" Tur Plug per sack, 100 sacks neat on bottom.
		Second Stage	500 sacks 4% Gel cement.

Two stage tool to be set at about 100' below Pictured Cliffs. A copy of any survey taken will be submitted upon completion of well. Copies of location plat are attached.

I understand that this plan of work must receive approval in writing by the Geological Survey before operations may be commenced.

Company Pan American Petroleum Corporation

Address P. O. Box 480

Farmington, New Mexico

Attn: L. O. Speer, Jr.

Verbal permission received May 22, 1963
Krahl to Clover.

By

Title Petroleum Engineer

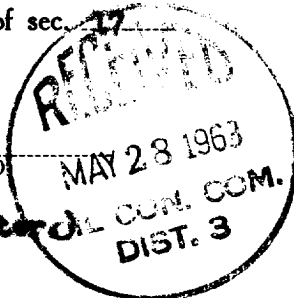

ORIGINAL FILED BY
E. H. [illegible]

NEW MEXICO OIL CONSERVATION COMMISSION

Well Location and Acreage Dedication Plat

Section A.

Date May 20, 1963

Operator PAN AMERICAN PETROLEUM CORPORATION Lease GALLEGOS CANYON UNIT
 Well No. 134 Unit Letter M Section 17 Township 29 NORTH Range 12 WEST NMPM
 Located 875 Feet From the SOUTH Line, 845 Feet From the WEST Line
 County SAN JUAN G. L. Elevation Report Later Dedicated Acreage 320 Acres
 Name of Producing Formation Dakota Pool Basin Dakota

1. Is the Operator the only owner in the dedicated acreage outlined on the plat below?
 Yes _____ No X
2. If the answer to question one is "no", have the interests of all the owners been consolidated by communitization agreement or otherwise? Yes X No _____. If answer is "yes", Type of Consolidation.
Gallegos Canyon Unit

3. If the answer to question two is "no", list all the owners and their respective interests below:

Owner

Land Description

RECEIVED

MAY 28 1963

OIL CON. COM.
DIST. 3

Section B.

Note: All distances must be from outer boundaries of section.

This is to certify that the information in Section A above is true and complete to the best of my knowledge and belief.

Pan American Petroleum Corp.F. H. Hollingsworth (Operator)

F. H. Hollingsworth
Petroleum (Representative) Engineer
Box 480

(Address)

Farmington, New Mexico

Ref: GLO plat dated 7 April 1881

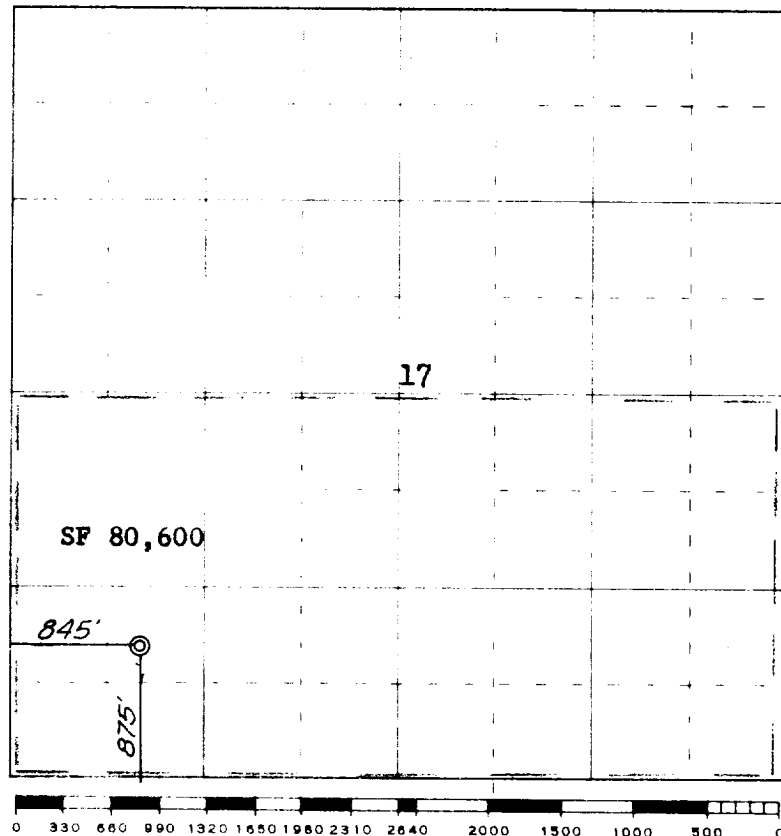

Scale 4 inches equal 1 mile

This is to certify that the above plat was prepared from field notes of actual surveys made by me or under my supervision and that the same are true and correct to the best of my knowledge and belief.

(Seal)

Farmington, New Mexico

Date Surveyed 14 May 1963

James P. Leese
 Registered Professional Engineer and/or Land Surveyor
James P. Leese, N. Mex. Reg. No. 1463