

NEW MEXICO OIL CONSERVATION COMMISSION

Santa Fe, New Mexico

NOTICE OF INTENTION TO DRILL OR RECOMPLETE

Notice must be given to the District Office of the Oil Conservation Commission and approval obtained before drilling or recompletion begins. If changes in the proposed plan are considered advisable, a copy of this notice showing such changes will be returned to the sender. Submit this notice in QUINTUPPLICATE. One copy will be returned following approval. See additional instructions in Rules and Regulations of the Commission.

Astec, New Mexico

(Place)

June 3, 1955

(Date)

OIL CONSERVATION COMMISSION
SANTA FE, NEW MEXICO

Gentlemen:

You are hereby notified that it is our intention to commence the (Drilling) (Recompletion) of a well to be known as

Basin Natural Gas Corporation

(Company or Operator)

Gale

(Lease)

Well No. 1K

(Unit)

The well is

located 1065' feet from the South line and 1045' feet from the West line of Section 13, T. 29-N, R. 11-W, NMPM.

(GIVE LOCATION FROM SECTION LINE)

Astee-Fruitland

Pool,

San Juan

County

If State Land the Oil and Gas Lease is No.

If patented land the owner is Frank Gale, et uxAddress Bloomfield, N.M.We propose to drill well with drilling equipment as follows: Rotary and Cable ToolsThe status of plugging bond is U.S. Cas. Bond #38793, approved by letter of April 25, 1955, by W. B. Macey of Santa Fe

Drilling Contractor

F. B. UmbargerPicture Cliff

We intend to complete this well in the

formation at an approximate depth of 1600' feet.

CASING PROGRAM

We propose to use the following strings of Casing and to cement them as indicated:

Size of Hole	Size of Casing	Weight per Foot	New or Second Hand	Depth	Sacks Cement
<u>12 1/2"</u>	<u>10 3/4"</u>	<u>32 lb</u>	<u>used</u>	<u>80</u>	<u>20-25</u>
<u>8 3/4"</u>	<u>8 1/2"</u>	<u>18 lb</u>	<u>new</u>	<u>1600'</u>	<u>250</u>

If changes in the above plans become advisable we will notify you immediately.

ADDITIONAL INFORMATION (If recompletion give full details of proposed plan of work.)

If production is indicated we will Sand Oil Frac by the Halliburton Oil Well Cementing Company and complete as gas well, running 1" tubing to the bottom. We will run a Geoelectric Log and may test the Fruitland Sand if indicated by the log.

Approved AUG 30 1955, 19

Except as follows:

Sincerely yours,

Basin Natural Gas Corporation

(Company or Operator)

By M. KrasovichPosition Asst. Treas.

Send Communications regarding well to

Name Basin Natural Gas CorporationAddress 109 W. Chase St.Astec, New Mexico

OIL CONSERVATION COMMISSION

By Ernest C. CanaleTitle Oil and Gas Inspector Dist. #3.

Subject To Commissions Findings
in case # 736

Company **BASIN NATURAL GAS CORPORATION**

Lease **Gale** Well No. **1**

Sec. **13**, T. **29 N**, R. **11 W, N.M.P.M.**

Location **1065' from the South line and 1045' from the West line.**

Elevation **5563 Ungraded ground.**

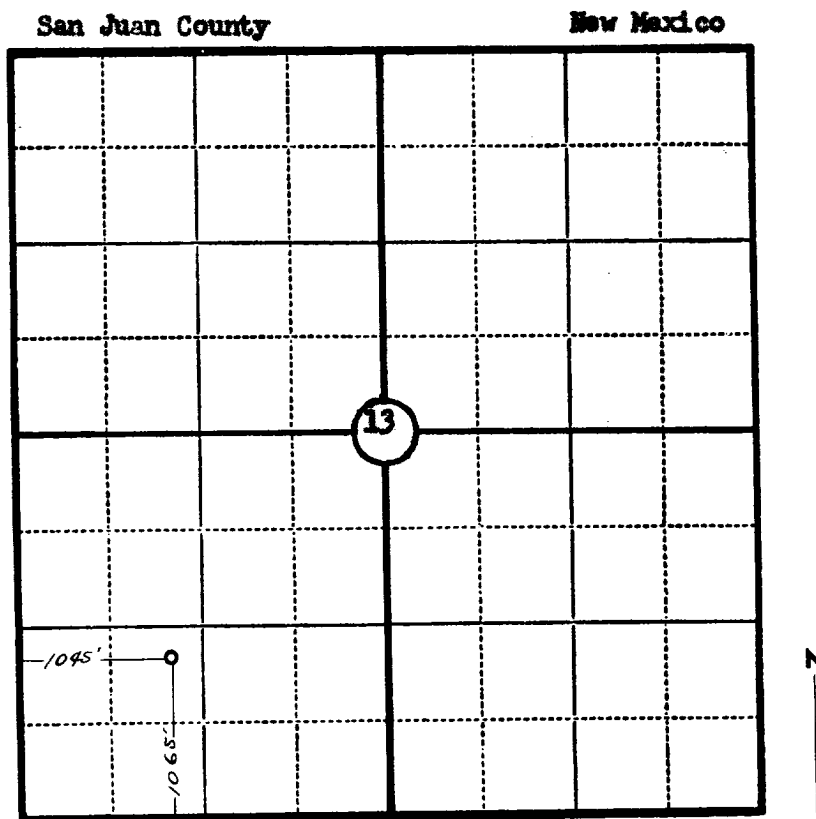

Scale—4 inches equal 1 mile.

This is to certify that the above plat was prepared from field notes of actual surveys made by me or under my supervision and that the same are true and correct to the best of my knowledge and belief.

Seal:

James P. Leese
Registered ~~Professional~~
~~Surveyor~~ Land Surveyor.

James P. Leese
N. Mex. Reg. No. 1463

Surveyed **26 April**, 19**55**

OIL CONSERVATION COMMISSION		
AZTEC DISTRICT OFFICE		
No. Copies Received <u>5</u>		
DISTRIBUTION		
	NO. FURNISHED	
Operator	<u>1</u>	
Santa Fe	<u>1</u>	
Proration Office		
State Land Office		
U. S. G. S.	<u>1</u>	
Transporter		
File	<u>1</u>	<input checked="" type="checkbox"/>