

(SUBMIT IN TRIPLICATE)

UNITED STATES  
DEPARTMENT OF THE INTERIOR  
GEOLOGICAL SURVEY

Land Office Santa Fe  
Lease No. 077710  
Unit Hardie

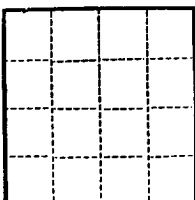

SUNDRY NOTICES AND REPORTS ON WELLS

NOTICE OF INTENTION TO DRILL	<input checked="" type="checkbox"/>	SUBSEQUENT REPORT OF WATER SHUT-OFF	
NOTICE OF INTENTION TO CHANGE PLANS		SUBSEQUENT REPORT OF SHOOTING OR ACIDIZING	
NOTICE OF INTENTION TO TEST WATER SHUT-OFF		SUBSEQUENT REPORT OF ALTERING CASING	
NOTICE OF INTENTION TO RE-DRILL OR REPAIR WELL		SUBSEQUENT REPORT OF RE-DRILLING OR REPAIR	
NOTICE OF INTENTION TO SHOOT OR ACIDIZE		SUBSEQUENT REPORT OF ABANDONMENT	
NOTICE OF INTENTION TO PULL OR ALTER CASING		SUPPLEMENTARY WELL HISTORY	
NOTICE OF INTENTION TO ABANDON WELL			

(INDICATE ABOVE BY CHECK MARK NATURE OF REPORT, NOTICE, OR OTHER DATA)

April 14, 1961

Well No. 1 is located 1180 ft. from S line and 1840 ft. from W line of sec. 14

S.W. Section 14 (1/4 Sec. and Sec. No.) 23-N (Twp.) 12-W (Range) N.M.P.M. (Meridian)  
Basin Dakota (Field) San Juan (County or Subdivision) New Mexico (State or Territory)

The elevation of the derrick floor above sea level is 5633 ft.

DETAILS OF WORK

(State names of and expected depths to objective sands; show sizes, weights, and lengths of proposed casings; indicate mudlogging jobs, cementing points, and all other important proposed work)

It is intended to drill a well thru the Dakota formation using rotary tools and to perforate & water fracture possible producing zones. Est. T.D. 6368'.

Casing Program:

- 9 5/8" @ 280' with 320 sacks cement circulated to surface.
- 4 1/2" @ 6368' with two stage tool at 4235'.
  - 1st stage w/280 sks - 150% to cover 100' above Gallup top.
  - 2nd stage w/710 sks - 150% to cover Fruitland top.

The S/2 of Section 14 is dedicated to this well.

I understand that this plan of work must receive approval in writing by the Geological Survey before operations may be commenced.

Company El Paso Natural Gas Company

Address Box 990

Farmington, New Mexico

By Original Signed D. W. Meehan

Title Petroleum Engineer

## NEW MEXICO OIL CONSERVATION COMMISSION

## Well Location and Acreage Dedication Plat

Section A.

Date April 7, 1961

Operator **EL PASO NATURAL GAS COMPANY** Lease **HARDIE "F"** SF **077710**  
 Well No. **1** Unit Letter **N** Section **14** Township **29-N** Range **12-N** NMPM  
 Located **1180** Foot From **SOUTH** Line, **1840** Foot From **WEST** Line  
 County **SAN JUAN** G. L. Elevation **5623** Dedication Acres **320** Acres  
 Name of Producing Formation **DAKOTA** Pool **BASIN DAKOTA**

1. Is the Operator the only owner in the dedicated acreage outlined on the plat below?

Yes ☐ No ☒2. If the answer to question one is "no", have the interests of all the owners been consolidated by communitization agreement or otherwise? Yes ☒ No ☐ If answer is "yes", Type of Consolidation,**Operating Agreement**

3. If the answer to question two is "no", list all the owners and their respective interests below:

Owner

Land Description

Section B.

This is to certify that the information  
 in Section A above is true and complete  
 to the best of my knowledge and belief.

**El Paso Natural Gas Company**  
 (Operator)

Original Signed **D. W. Meehan**  
 (Representative)

Box 990

(Address)

Farmington, New Mexico

Note: All distances must be from outer boundaries of section.

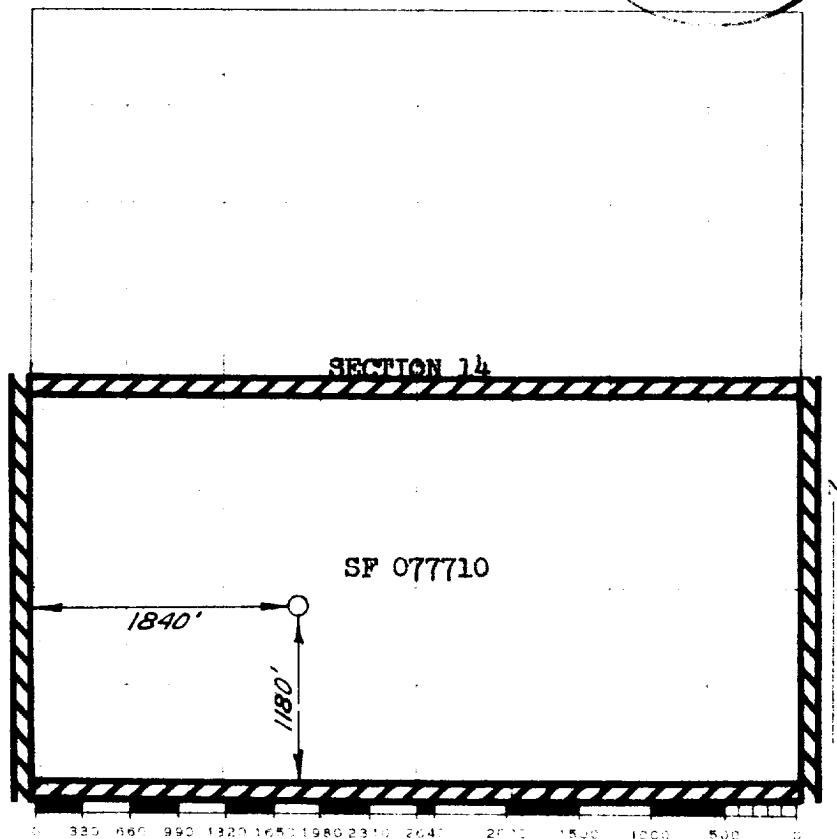

Scale 4 inches equal 1 mile

This is to certify that the above plat was prepared from field notes of actual surveys  
 made by me or under my supervision and that the same are true and correct to the best  
 of my knowledge and belief.

(Seal)

Date Surveyed

January 24, 1961

Farmington, New Mexico

*David O. Kilmer*  
 Registered Professional Engineer and/or Land Surveyor