

NUMBER OF COPIES RECEIVED		6
DISTRIBUTION		
SANTA FE		
FILE		
U.S.G.S.		
LAND OFFICE		
TRANSPORTER	OIL	
	GAS	
PRODUCTION OFFICE		
OPERATOR		3

NEW MEXICO OIL CONSERVATION COMMISSION
WELL LOCATION AND ACREAGE DEDICATION PLAT
 SEE INSTRUCTIONS FOR COMPLETING THIS FORM ON THE REVERSE SIDE

FORM C-128
 Revised 5/1/57

SECTION A

Operator Humble Oil & Refining Company			Lease Navajo Tract 2		Well No. 1
Unit Letter M	Section 18	Township 29N	Range 15W	County San Juan	
Actual Footage Location of Well: 990 feet from the South line and 983 feet from the West line					
Ground Level Elev. 5334' ungraded	Producing Formation Dakota or Devonian Oursay		Pool South Water Flow		Dedicated Acreage: 160 Acres

1. Is the Operator the only owner in the dedicated acreage outlined on the plat below? YES ☒ NO _____. ("Owner" means the person who has the right to drill into and to produce from any pool and to appropriate the production either for himself or for himself and another. (65-3-29 (e) NMSA 1935 Comp.)
2. If the answer to question one is "no," have the interests of all the owners been consolidated by communitization agreement or otherwise? YES _____. If answer is "yes," Type of Consolidation **Unit Agreement**
3. If the answer to question two is "no," list all the owners and their respective interests below:

Owner	Land Description

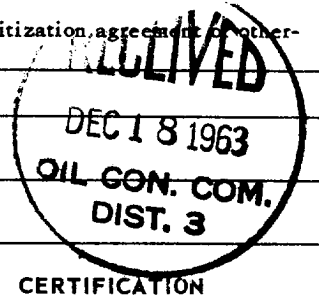

SECTION B

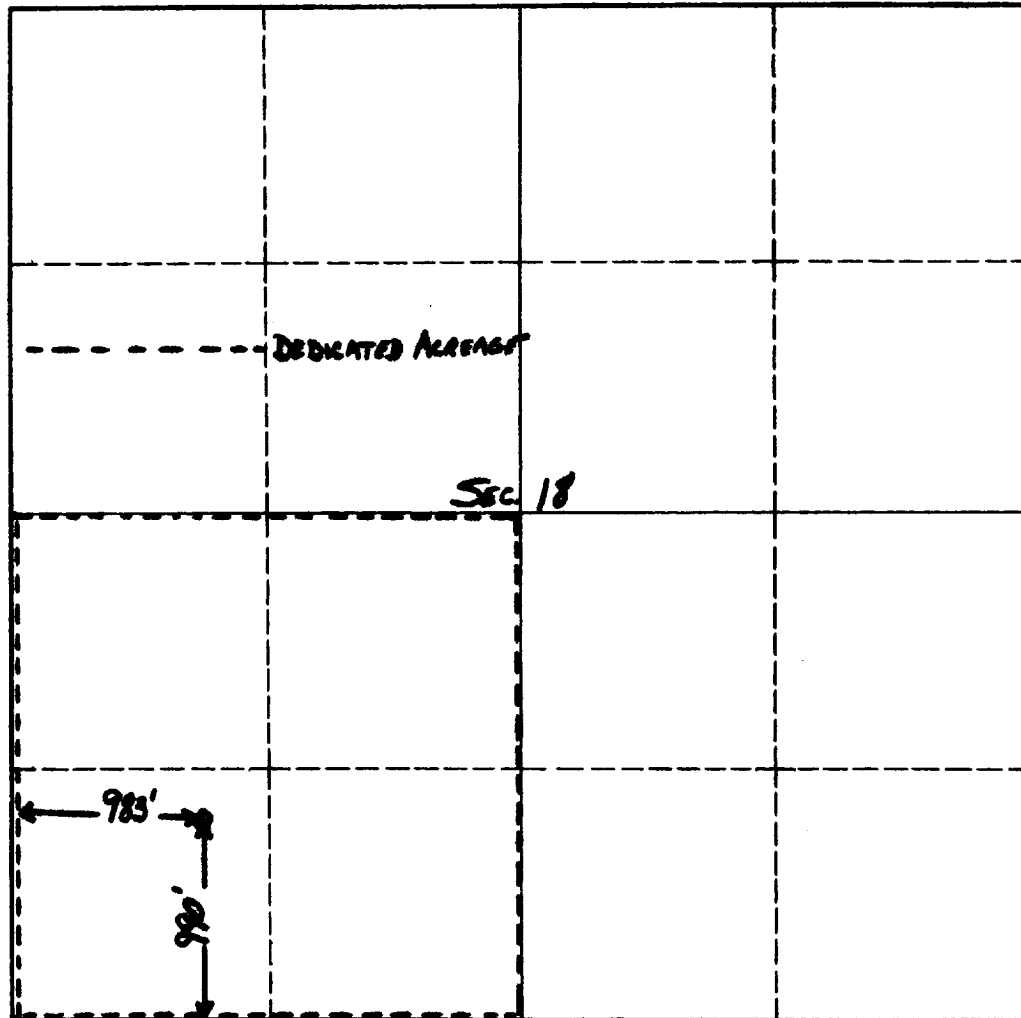

CERTIFICATION

I hereby certify that the information in SECTION A above is true and complete to the best of my knowledge and belief.

COPY (ORIGINAL SIGNED) B. M. BRADLEY

Name B. M. Bradley
Position Dist. Supt.
Company Humble Oil & Refining Co.
Date 12-18-63

I hereby certify that the well location shown on the plat in SECTION B was plotted from field notes of actual surveys made by me or under my supervision, and that the same is true and correct to the best of my knowledge and belief.

Date Surveyed 6-13-63
Registered Professional Engineer and/or Land Surveyor Robert H. Ernst San Juan Engr. Co.
Certificate No. No. Mex. PE & LS 2463