

(SUBMIT IN TRIPLICATE)

UNITED STATES
DEPARTMENT OF THE INTERIOR
GEOLOGICAL SURVEY

Indian Agency Navajo
Window Rock, Ariz
Allottee Shelli
Lease No. 14-20-603-5036

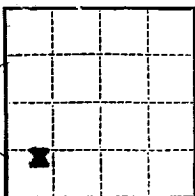

SUNDRY NOTICES AND REPORTS ON WELLS

NOTICE OF INTENTION TO DRILL	<input checked="" type="checkbox"/>	SUBSEQUENT REPORT OF WATER SHUT-OFF
NOTICE OF INTENTION TO CHANGE PLANS	<input type="checkbox"/>	SUBSEQUENT REPORT OF SHOOTING OR ACIDIZING
NOTICE OF INTENTION TO TEST WATER SHUT-OFF	<input type="checkbox"/>	SUBSEQUENT REPORT OF ALTERING CASING
NOTICE OF INTENTION TO REDRILL OR REPAIR WELL	<input type="checkbox"/>	SUBSEQUENT REPORT OF REDRILLING OR REPAIR
NOTICE OF INTENTION TO SHOOT OR ACIDIZE	<input type="checkbox"/>	SUBSEQUENT REPORT OF ABANDONMENT
NOTICE OF INTENTION TO PULL OR ALTER CASING	<input type="checkbox"/>	SUPPLEMENTARY WELL HISTORY
NOTICE OF INTENTION TO ABANDON WELL	<input type="checkbox"/>	

(INDICATE ABOVE BY CHECK MARK NATURE OF REPORT, NOTICE, OR OTHER DATA)

March 8, 1961, 19__

Well No. Shiprock 16-1-4 is located 1690 ft. from N line and 990 ft. from E line of sec. 16

SE
SW 1/4 Sec 16 (No.) 294 184 294

Undesignated San Juan New Mexico
(Field) (County or Subdivision) (State or Territory)

The elevation of the 9193 above sea level is 5193 ft.

DETAILS OF WORK

(State names of and expected depths to objective sands; show sizes, weights, and lengths of proposed casings; indicate mudding jobs, cementing points, and all other important proposed work)

To drill 4-3/4" hole w/ Rotary Air Drilling Method to test -
Upper Gallup Sand estimated at 140' approx.
In case of production show - ream hole to 7" - set 5 1/2" csg.
at approx. 135' on shoulder above production, and cement to
surface. Complete open hole.

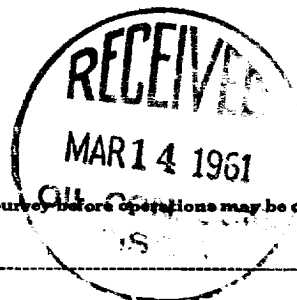

I understand that this plan of work must receive approval in writing by the Geological Survey before operations may be commenced.

Company Royal Development Co.

Address P. O. Box 1299

Albuquerque, New Mexico

By [Signature]

Title Superintendent

NEW MEXICO OIL CONSERVATION COMMISSION
Well Location and Acreage Dedication Plat

Section A.

Date March 7, 1961

Operator Royal Development Co. Lease Shiprock - Navejo 14-29-603-5036
Well No. 16-L-4 Unit Letter L Section 16 Township 29N Range 18W NMPM
Located 990 Feet From West Line, 16 Feet From South Line
County San Juan G. L. Elevation 5193.57 Dedicated Acreage 10 Acres
Name of Producing Formation Mancos Pool Undesignated

1. Is the Operator the only owner in the dedicated acreage outlined on the plat below?
Yes X No .
2. If the answer to question one is "no," have the interests of all the owners been consolidated by communitization agreement or otherwise? Yes No . If answer is "yes," Type of Consolidation
3. If the answer to question two is "no," list all the owners and their respective interests below:

Owner

Land Description

<u>Owner</u>	<u>Land Description</u>

Section B

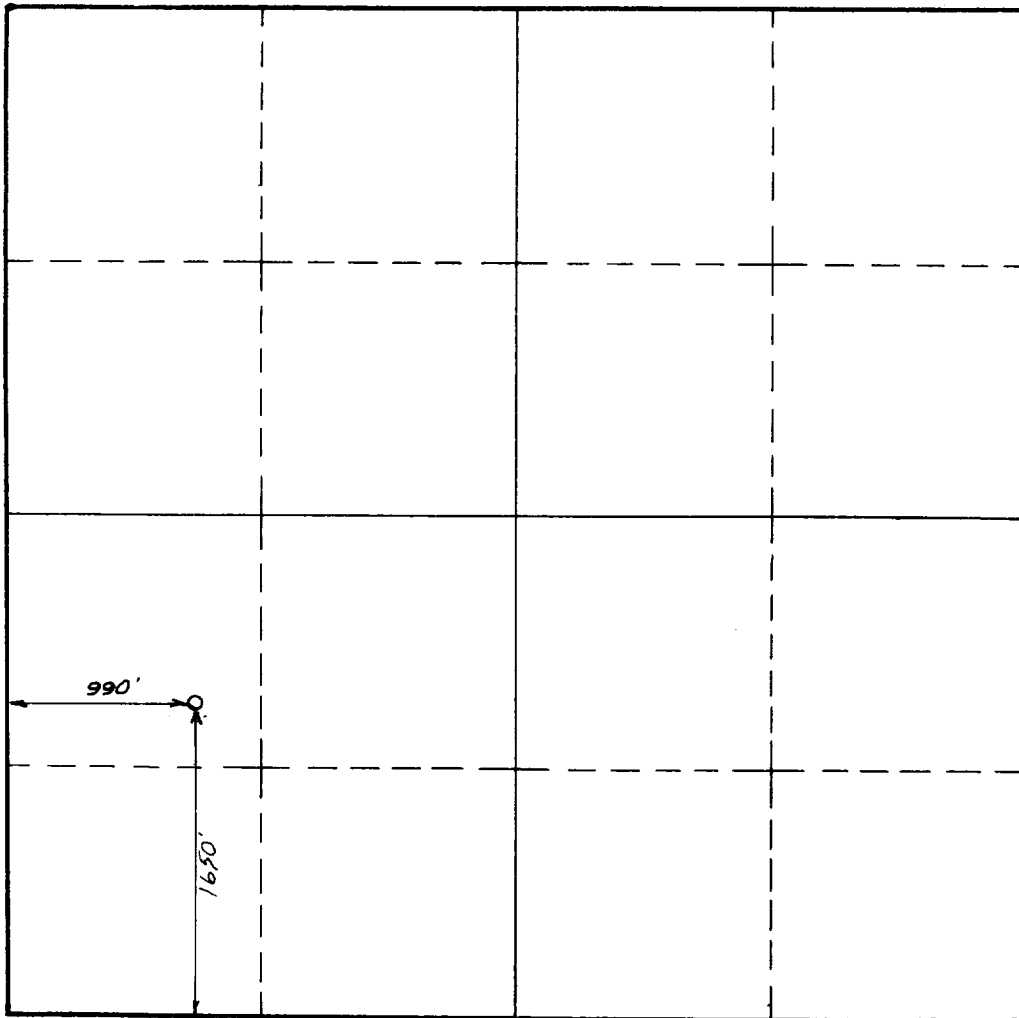

This is to certify that the information in Section A above is true and complete to the best of my knowledge and belief.

Royal Development Co.
(Operator)

[Signature]
(Representative)

Box 1299 Albuquerque, N.M.
Address

This is to certify that the well location shown on the plat in Section B was plotted from field notes of actual surveys made by me or under my supervision and that the same is true and correct to the best of my knowledge and belief.

Date Surveyed March 7, 1961

[Signature]
Registered Professional
Engineer and/or Land Surveyor.

Certificate No. 11457

(See instructions for completing this form on the reverse side)

INSTRUCTIONS FOR COMPLETION:

1. Operator shall furnish and certify to the information called for in Section A.
2. Operator shall outline the dedicated acreage for both oil and gas wells on the plat in Section B.
3. A registered professional engineer or land surveyor registered in the State of New Mexico or approved by the Commission shall show on the plat the location of the well and certify this information in the space provided.
4. All distances shown on the plat must be from the outer boundaries of Section.
5. If additional space is needed for listing owners and their respective interests as required in question 3, Section A, please use space below

* "Owner" means the person who has the right to drill into and to produce from any pool and to appropriate the production either for himself or for himself and another. (65-3-29 (e) NMSA 1953 Comp.)