

(SUBMIT IN TRIPLICATE)

UNITED STATES  
DEPARTMENT OF THE INTERIOR  
GEOLOGICAL SURVEY

Indian Agency Navajo

Window Rock, Ariz

Allottee Shell

Lease No. 14-20-603-5036

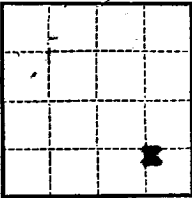

SUNDRY NOTICES AND REPORTS ON WELLS

NOTICE OF INTENTION TO DRILL	<input checked="" type="checkbox"/>	SUBSEQUENT REPORT OF WATER SHUT-OFF	
NOTICE OF INTENTION TO CHANGE PLANS		SUBSEQUENT REPORT OF SHOOTING OR ACIDIZING	
NOTICE OF INTENTION TO TEST WATER SHUT-OFF		SUBSEQUENT REPORT OF ALTERING CASING	
NOTICE OF INTENTION TO REDRILL OR REPAIR WELL		SUBSEQUENT REPORT OF REDRILLING OR REPAIR	
NOTICE OF INTENTION TO SHOOT OR ACIDIZE		SUBSEQUENT REPORT OF ABANDONMENT	
NOTICE OF INTENTION TO PULL OR ALTER CASING		SUPPLEMENTARY WELL HISTORY	
NOTICE OF INTENTION TO ABANDON WELL			

(INDICATE ABOVE BY CHECK MARK NATURE OF REPORT, NOTICE, OR OTHER DATA)

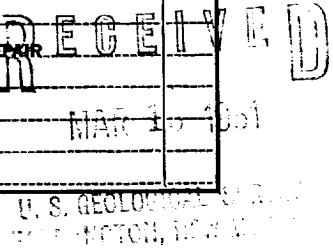

March 8, 1961, 1961

Well No. Shiprock 17-1-3 is located 1650 ft. from NE line and 990 ft. from E line of sec. 17

SW 1/4 (Section No.) 29E (Twp.) 18N (Range) NM (Section)  
Undesignated (Field) San Juan (County or Subdivision) New Mexico (State or Territory)

The elevation of the 6.1 ~~XXXXX~~ above sea level is 5198.67

DETAILS OF WORK

(State names of and expected depths to objective sands; show sizes, weights, and lengths of proposed casings; indicate mudding jobs, cementing points, and all other important proposed work)

To drill 4-3/4" hole w/ Rotary Air Drilling Method to test -  
Upper Gallup Sand estimated at 90' approx.  
In case of production show - run hole to 7" - set 5 1/2" csg.  
at approx. 85' on shoulder above production, and cement to  
surface. Complete open hole.

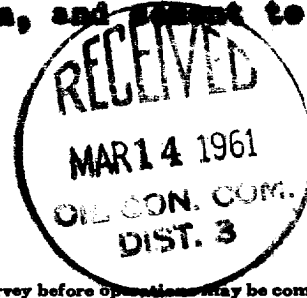

I understand that this plan of work must receive approval in writing by the Geological Survey before operations may be commenced.

Company Royal Development Co.

Address P. O. Box 1299

Albuquerque, N. M.

By [Signature]

Title Superintendent

NEW MEXICO OIL CONSERVATION COMMISSION  
Well Location and Acreage Dedication Plat

Section A.

Date March 7, 1961

Operator Royal Development Co Lease Shiprock - Navajo 14-20-603-5036  
Well No. 17-1-3 Unit Letter I Section 17 Township 29N Range 18W NMPM  
Located 17-1-3 Feet From I Line, 17 Feet From South Line  
County 990 G. L. Elevation 1650 Dedicated Acreage 10 Acres  
Name of Producing Formation San Juan Pool Undesignated

1. Is the Operator the only owner\* in the dedicated acreage outlined on the plat below?  
Yes        No       .
2. If the answer to question one is "no," have the interests of all the owners been consolidated by communitization agreement or otherwise? Yes        No       . If answer is "yes," Type of Consolidation
3. If the answer to question two is "no," list all the owners and their respective interests below:

Owner

Land Description

<u>Owner</u>	<u>Land Description</u>

Section B

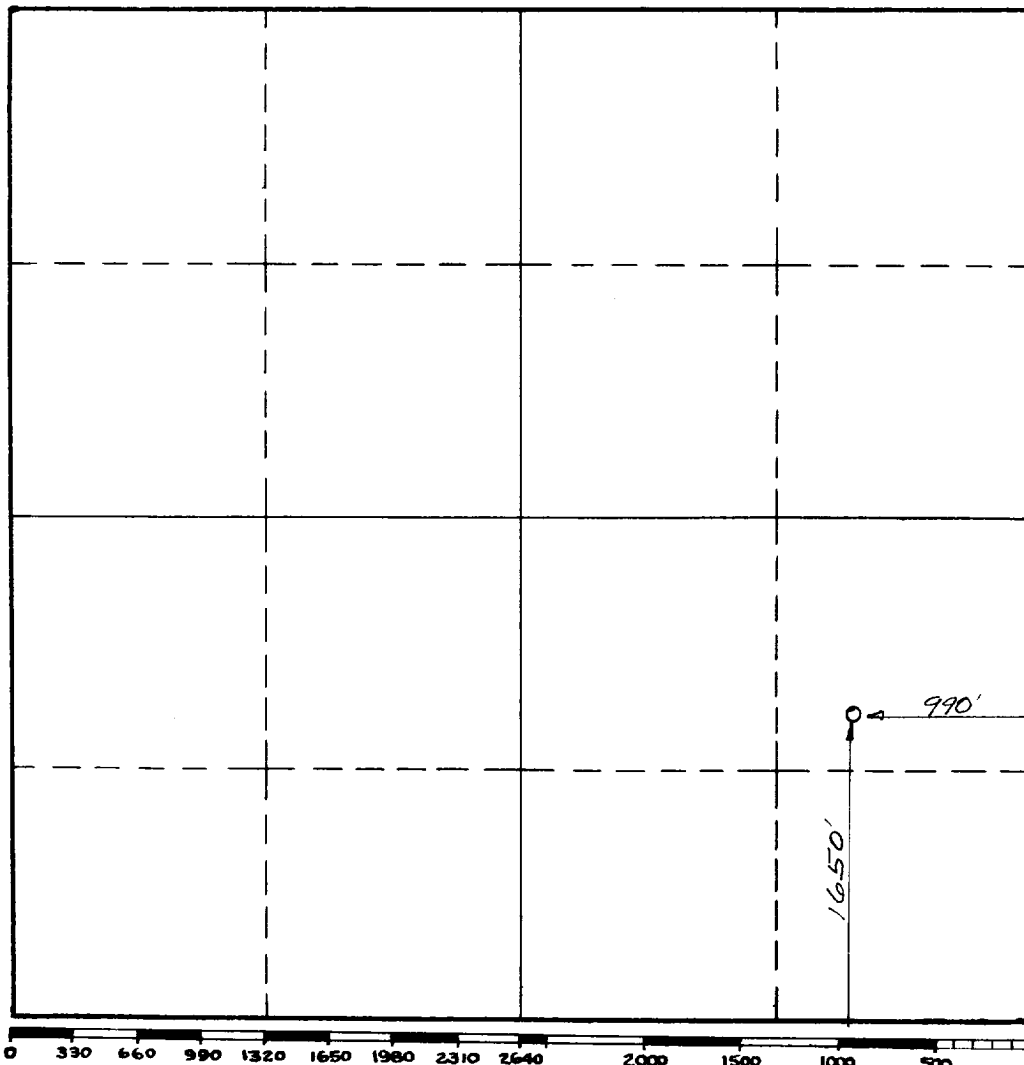

This is to certify that the information in Section A above is true and complete to the best of my knowledge and belief.

Royal Development Co.  
(Operator)

        
(Representative)

Box 1299 Albuquerque, N.M.  
Address

This is to certify that the well location shown on the plat in Section B was plotted from field notes of actual surveys made by me or under my supervision and that the same is true and correct to the best of my knowledge and belief.

Date Surveyed March 7, 1961

R. J. Scanlon  
Registered Professional  
Engineer and/or Land Surveyor.

Certificate No. 1457

(See instructions for completing this form on the reverse side)

INSTRUCTIONS FOR COMPLETION:

1. Operator shall furnish and certify to the information called for in Section A.
2. Operator shall outline the dedicated acreage for both oil and gas wells on the plat in Section B.
3. A registered professional engineer or land surveyor registered in the State of New Mexico or approved by the Commission shall show on the plat the location of the well and certify this information in the space provided.
4. All distances shown on the plat must be from the outer boundaries of Section.
5. If additional space is needed for listing owners and their respective interests as required in question 3, Section A, please use space below

\* "Owner" means the person who has the right to drill into and to produce from any pool and to appropriate the production either for himself or for himself and another. (65-3-29 (e) NMSA 1953 Comp.)