

(SUBMIT IN TRIPLICATE)

UNITED STATES
DEPARTMENT OF THE INTERIOR
GEOLOGICAL SURVEY

Indian Agency Navajo

Allettee Shell

Lease No. 14-20-603-5036

SUNDRY NOTICES AND REPORTS ON WELLS

NOTICE OF INTENTION TO DRILL	<input checked="" type="checkbox"/>	SUBSEQUENT REPORT OF WATER SHUT-OFF	
NOTICE OF INTENTION TO CHANGE PLANS		SUBSEQUENT REPORT OF SHOOTING OR ACIDIZING	
NOTICE OF INTENTION TO TEST WATER SHUT-OFF		SUBSEQUENT REPORT OF ALTERING CASING	
NOTICE OF INTENTION TO REDRILL OR REPAIR WELL		SUBSEQUENT REPORT OF REDRILLING OR REPAIR	
NOTICE OF INTENTION TO SHOOT OR ACIDIZE		SUBSEQUENT REPORT OF ABANDONMENT	
NOTICE OF INTENTION TO PULL OR ALTER CASING		SUPPLEMENTARY WELL HISTORY	
NOTICE OF INTENTION TO ABANDON WELL			

(INDICATE ABOVE BY CHECK MARK NATURE OF REPORT, NOTICE, OR OTHER DATA)

RECEIVED
OCT 17 1961
U. S. GEOLOGICAL SURVEY
WASHINGTON, D. C.

Well No. Shiprock 17 is located 1980 ft. from N line and 1485 ft. from E line of sec. 17
42 17 (1/4 Sec. and Sec. No.) 29N (Twp.) 10W (Range) SEPM (Meridian)
Shiprock-Callup (Field) Sa n Juan (County or Subdivision) New Mexico (State)

The elevation of the derrick floor above sea level is 5200 ft.

DETAILS OF WORK

(State names of and expected depths to objective sands; show sizes, weights, and lengths of proposed casings; indicate mudding jobs, cementing points, and all other important proposed work)

RECEIVED
OCT 18 1961
OIL CON. COM.
DIST. 3

Drill 7" hole to 81' w/ rotary air drilling.
Set 5 1/2" OD Casing to 81' & cement to surface, neat cement w/ 2% Cal. Cl.
W.O.C. at least 24 hrs.
Drill out 4-3/4" hole to 181' w/ air & complete open hole.
Run 81' approx. of 2-3/8" OD Tubing, 2" x 1" RWT Insert pump, 3/8" Rods.

Expected Tops:

74' Kg
83' - 89' Oil Production

I understand that this plan of work must receive approval in writing by the Geological Survey before operations may be commenced.

Company Royal Development Co.

Address P. O. Box 1299

Albuquerque, New Mexico

By C. F. Stringer

Title C. F. Stringer, Prod. Supt.

NUMBER OF COPIES RECEIVED	
DISTRIBUTION	
SANTA FE	
FILE	
U.S.G.T	
LAND OFFICE	
TRANSPORTER	OIL GAS
PRORATION OFFICE	
OPERATOR	

NEW MEXICO OIL CONSERVATION COMMISSION
WELL LOCATION AND ACREAGE DEDICATION PLAT
SEE INSTRUCTIONS FOR COMPLETING THIS FORM ON THE REVERSE SIDE

FORM C-128
Revised 5/1/57

SECTION A

Operator Royal Development Co.		Lease Shiprock-Nava jo-14-20-603-5030		Well No. J-5
Unit Letter J	Section 17	Township 29 N	Range 10 W	County San Juan
Actual Footage Location of Well: 1485 feet from the East line and 1980 feet from the South line				
Ground Level Elev. 9208	Producing Formation Upper Gallup	Pool Shiprock-Gallup	Dedicated Acreage: 40 Joint Acres	

1. Is the Operator the only owner in the dedicated acreage outlined on the plat below? YES ☒ NO ____ . ("Owner" means the person who has the right to drill into and to produce from any pool and to appropriate the production either for himself or for himself and another. (65-3-29 (e) NMSA 1935 Comp.)
2. If the answer to question one is "no," have the interests of all the owners been consolidated by communitization agreement or otherwise? YES ____ NO ____ . If answer is "yes," Type of Consolidation _____
3. If the answer to question two is "no," list all the owners and their respective interests below:

Owner	Land Description

RECEIVED
OCT 17 1961

SECTION B

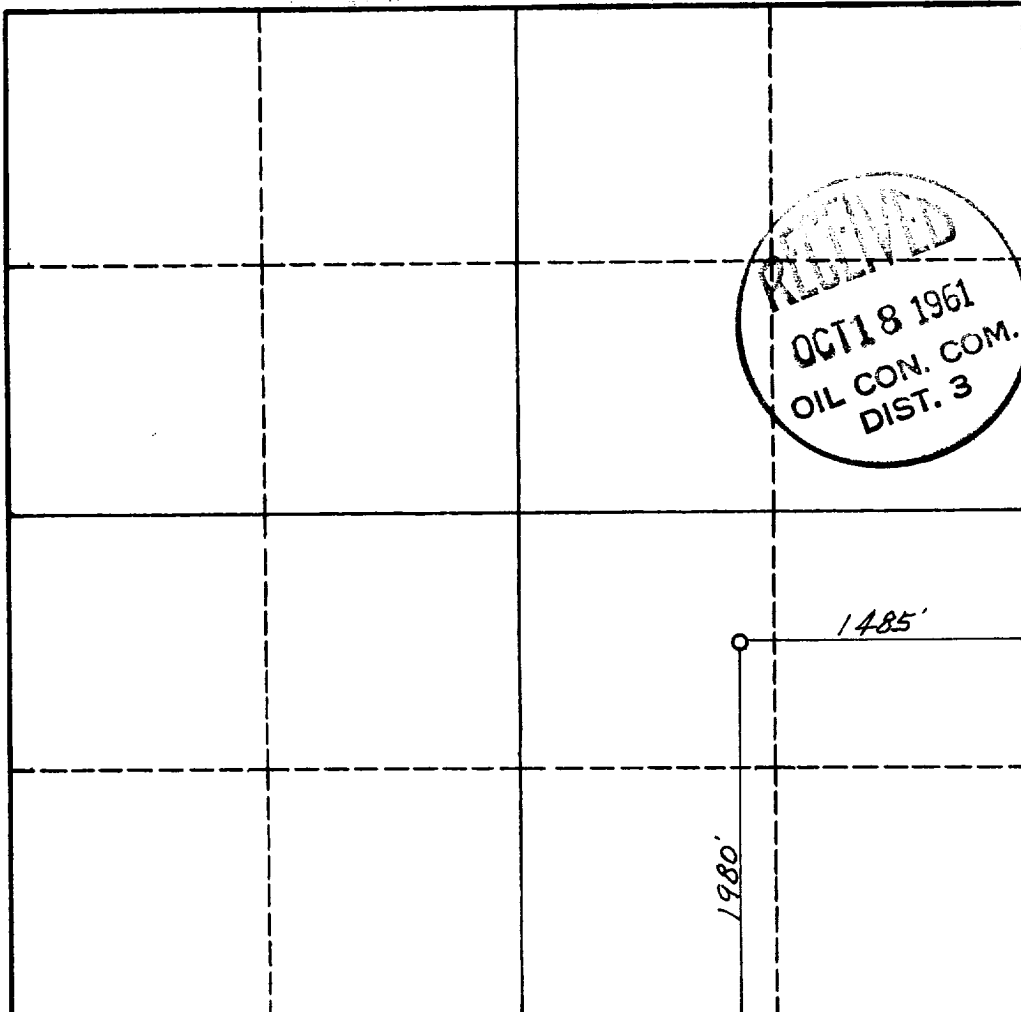

CERTIFICATION
U. S. GEOLOGICAL SURVEY

I hereby certify that the information in SECTION A above is true and complete to the best of my knowledge and belief.

Name <i>[Signature]</i>
Position Superintendent
Company Royal Development Co.
Date March 21, 1961

I hereby certify that the well location shown on the plat in SECTION B was plotted from field notes of actual surveys made by me or under my supervision, and that the same is true and correct to the best of my knowledge and belief.

Date Surveyed March 23, 1961
Registered Professional Engineer and/or Land Surveyor <i>[Signature]</i>
Certificate No. 11457

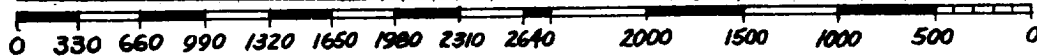

INSTRUCTIONS FOR COMPLETION OF FORM C-128

1. Operator shall furnish and certify to the information called for in Section A.
2. Operator shall outline the dedicated acreage for *both* oil and gas wells on the plat in Section B.
3. A registered professional engineer or land surveyor registered in the State of New Mexico or approved by the Commission shall show on the plat the location of the well and certify this information in the space provided.
4. All distances shown on the plat must be from the outer boundaries of the Section.
5. If additional space is needed for listing owners and their respective interests as required in question 3 of Section A, please use space below.