

(SUBMIT IN TRIPLICATE)

Indian Agency **Window Rock**

Contract No. **14-20-603-1049**

UNITED STATES  
DEPARTMENT OF THE INTERIOR  
GEOLOGICAL SURVEY

Allottee .....

Lease No. ....

**SUNDRY NOTICES AND REPORTS ON WELLS**

NOTICE OF INTENTION TO DRILL.....	<input checked="" type="checkbox"/>	SUBSEQUENT REPORT OF WATER SHUT-OFF.....	
NOTICE OF INTENTION TO CHANGE PLANS.....		SUBSEQUENT REPORT OF SHOOTING OR ACIDIZING.....	
NOTICE OF INTENTION TO TEST WATER SHUT-OFF.....		SUBSEQUENT REPORT OF ALTERING CASING.....	
NOTICE OF INTENTION TO REDRILL OR REPAIR WELL.....		SUBSEQUENT REPORT OF REDRILLING OR REPAIR.....	
NOTICE OF INTENTION TO SHOOT OR ACIDIZE.....		SUBSEQUENT REPORT OF ABANDONMENT.....	
NOTICE OF INTENTION TO PULL OR ALTER CASING.....		SUPPLEMENTARY WELL HISTORY.....	JUN 4 1959
NOTICE OF INTENTION TO ABANDON WELL.....			

(INDICATE ABOVE BY CHECK MARK NATURE OF REPORT, NOTICE, OR OTHER DATA)

June 3

19 59

Well No. **Navajo 1A** is located **2310** ft. from **N** line and **330** ft. from **E** line of sec. **16**

**NW/4 Sec. 16**

**20N**

**18W**

**NMPM**

(1/4 Sec. and Sec. No.)

(Twp.)

(Range)

(Meridian)

**Wildcat**

**San Juan County**

**New Mexico**

(Field)

(County or Subdivision)

(State or Territory)

The elevation of the derrick floor above sea level is **5168** ft.

**DETAILS OF WORK**

(State names of and expected depths to objective sands; show sizes, weights, and lengths of proposed casings; indicate mudding jobs, cementing points, and all other important proposed work)

**Plan to drill 7 7/8" hole to top of first oil show at approximately 20 feet. Will set and cement 7" casing and drill to approximately 150' with air and complete if oil shows warrant.**

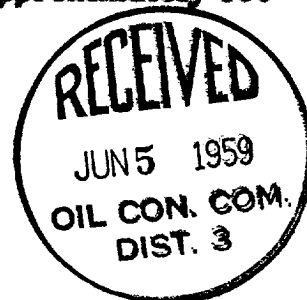

I understand that this plan of work must receive approval in writing by the Geological Survey before operations may be commenced.

Company **Universal Oil Corporation**

Address **Box 516**

**Farmington, New Mexico**

By **Harrell Budd**

Title **President**

NEW MEXICO OIL CONSERVATION COMMISSION  
WELL LOCATION AND ACREAGE DEDICATION PLAT

FORM C-128  
Revised 5/1/57

SEE INSTRUCTIONS FOR COMPLETING THIS FORM ON THE REVERSE SIDE

SECTION A

Operator <b>UNIVERSAL OIL CORPORATION</b>		Lease <b>NAVAJO</b>		Well No. <b>1A</b>
Unit Letter <b>E</b>	Section <b>16</b>	Township <b>29 NORTH</b>	Range <b>18 WEST</b>	County <b>SAN JUAN</b>
Actual Footage Location of Well: <b>2310</b> feet from the <b>NORTH</b> line and <b>330</b> feet from the <b>WEST</b> line				
Ground Level Elev. <b>5168.26</b>	Producing Formation	Pool	Dedicated Acreage: <b>40</b> Acres	

1. Is the Operator the only owner in the dedicated acreage outlined on the plat below? YES ☒ NO ☐ . ("Owner" means the person who has the right to drill into and to produce from any pool and to appropriate the production either for himself or for himself and another. (65-3-29 (e) NMSA 1935 Comp.)
2. If the answer to question one is "no," have the interests of all the owners been consolidated by communitization agreement or otherwise? YES ☐ NO ☐ . If answer is "yes," Type of Consolidation \_\_\_\_\_
3. If the answer to question two is "no," list all the owners and their respective interests below.

Owner	Land Description

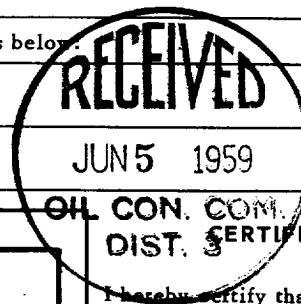

SECTION B

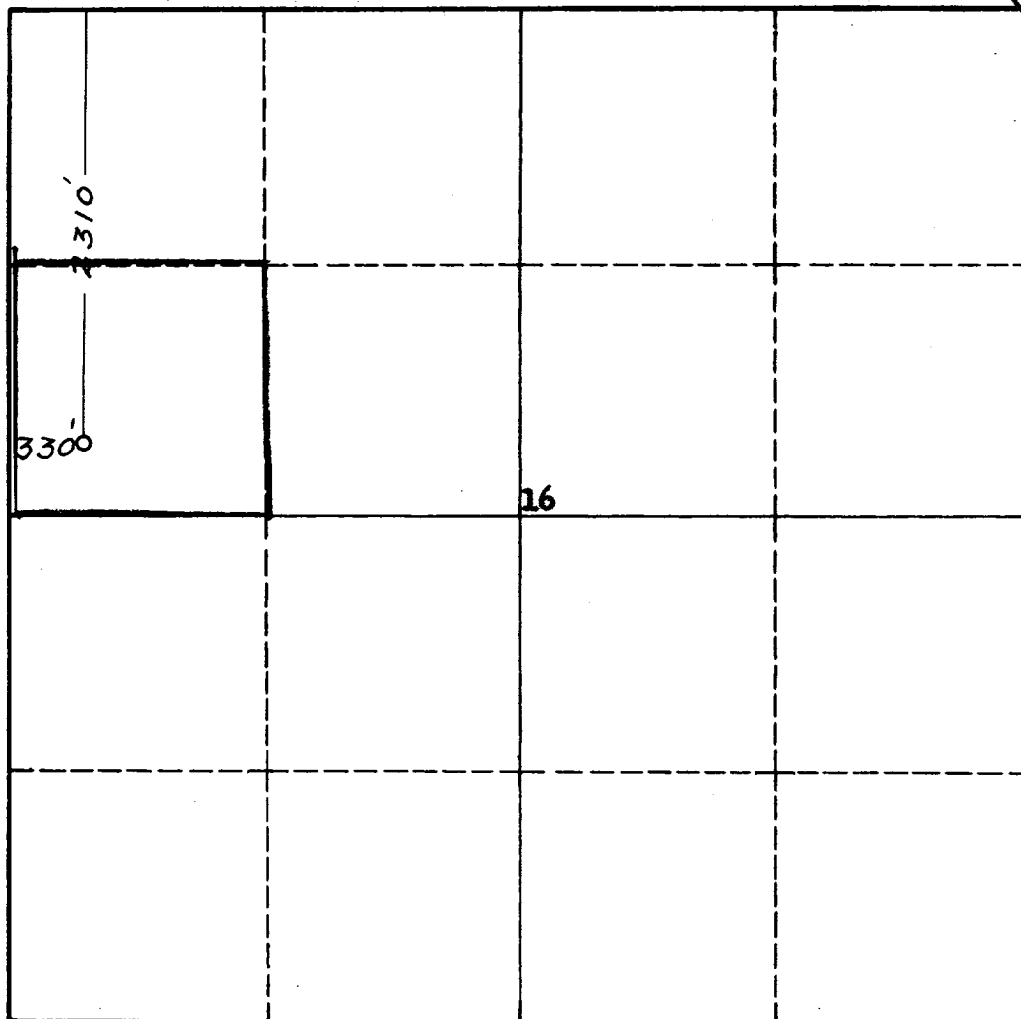

I hereby certify that the information in SECTION A above is true and complete to the best of my knowledge and belief.

Name Harrell Budd  
Position President  
Company Universal Oil Corp  
Date 6/3/59

I hereby certify that the well location shown on the plat in SECTION B was plotted from field notes of actual surveys made by me or under my supervision, and that the same is true and correct to the best of my knowledge and belief.

Date Surveyed  
**22 May 1959**  
Registered Professional Engineer  
and/or Land Surveyor

James P. Leese  
**James P. Leese**

Certificate No. **1463**

0 330 660 990 1320 1650 1980 2310 2640 2000 1500 1000 500 0

### INSTRUCTIONS FOR COMPLETION OF FORM C-128

1. Operator shall furnish and certify to the information called for in Section A.
2. Operator shall outline the dedicated acreage for *both* oil and gas wells on the plat in Section B.
3. A registered professional engineer or land surveyor registered in the State of New Mexico or approved by the Commission shall show on the plat the location of the well and certify this information in the space provided.
4. All distances shown on the plat must be from the outer boundaries of the Section.
5. If additional space is needed for listing owners and their respective interests as required in question 3 of Section A, please use space below.

(SUBMIT IN TRIPLICATE)

Indian Agency \_\_\_\_\_

UNITED STATES  
DEPARTMENT OF THE INTERIOR  
GEOLOGICAL SURVEY

Allottee \_\_\_\_\_

Lease No. \_\_\_\_\_

**Navajo Tribal Contract No. 14-20-603-1049**

X			

**SUNDRY NOTICES AND REPORTS ON WELLS**

NOTICE OF INTENTION TO DRILL _____	SUBSEQUENT REPORT OF WATER SHUT-OFF _____
NOTICE OF INTENTION TO CHANGE PLANS _____	SUBSEQUENT REPORT OF SHOOTING OR ACIDIZING _____
NOTICE OF INTENTION TO TEST WATER SHUT-OFF _____	SUBSEQUENT REPORT OF ALTERING CASING _____
NOTICE OF INTENTION TO REDRILL OR REPAIR WELL _____	SUBSEQUENT REPORT OF REDRILLING OR REPAIR _____
NOTICE OF INTENTION TO SHOOT OR ACIDIZE _____	SUBSEQUENT REPORT OF ABANDONMENT _____
NOTICE OF INTENTION TO PULL OR ALTER CASING _____	SUPPLEMENTARY WELL HISTORY _____
NOTICE OF INTENTION TO ABANDON WELL _____	

RECEIVED  
NOV 15 1959  
U. S. GEOLOGICAL SURVEY  
FARMINGTON, NEW MEXICO

(INDICATE ABOVE BY CHECK MARK NATURE OF REPORT, NOTICE, OR OTHER DATA)

**November 11, 59**

Well No. **1A Navajo** is located **2310** ft. from **N** line and **330** ft. from **E** line of sec. **16**  
**NW/4 16 29N 15W NMPM**  
(Field) (County or Subdivision) (State or Territory)  
**Shiprock-Gallup San Juan Co. New Mexico**  
**8168**

The elevation of the derrick floor above sea level is \_\_\_\_\_ ft.

**DETAILS OF WORK**

(State names of and expected depths to objective sands; show sizes, weights, and lengths of proposed casings; indicate mudlogging jobs, cementing points, and all other important proposed work)

**Drilled from 0 to 150' with air. Slight show of oil at 107'. Well shut-in pending clarifications of new State regulations regarding completion practices in Shiprock-Gallup field.**

I understand that this plan of work must receive approval in writing by the Geological Survey before operations may be commenced.

**UNIVERSAL OIL CORPORATION**

Company \_\_\_\_\_

**Box 516**

Address \_\_\_\_\_

**1 Farmington, New Mexico**

By *Harold Budd*

**President**

Title \_\_\_\_\_

(SUBMIT IN TRIPLICATE)

Indian Agency **Window Rock**

UNITED STATES  
DEPARTMENT OF THE INTERIOR  
GEOLOGICAL SURVEY

Allottee **Navajo Tribal**

Lease No. \_\_\_\_\_

**Contract 14-20-893-1049**

603

**SUNDRY NOTICES AND REPORTS ON WELLS**

NOTICE OF INTENTION TO DRILL		SUBSEQUENT REPORT OF WATER SHUT-OFF	
NOTICE OF INTENTION TO CHANGE PLANS		SUBSEQUENT REPORT OF SHOOTING OR ACIDIZING	
NOTICE OF INTENTION TO TEST WATER SHUT-OFF		SUBSEQUENT REPORT OF ALTERING CASINGS	
NOTICE OF INTENTION TO REDRILL OR REPAIR WELL		SUBSEQUENT REPORT OF REDRILLING OR REPAIR	
NOTICE OF INTENTION TO SHOOT OR ACIDIZE		SUBSEQUENT REPORT OF ABANDONMENT	
NOTICE OF INTENTION TO PULL OR ALTER CASING		SUPPLEMENTARY WELL HISTORY	
NOTICE OF INTENTION TO ABANDON WELL	<input checked="" type="checkbox"/>		

**RECEIVED**  
SEP 14 1962  
U. S. GEOLOGICAL SURVEY  
FARMINGTON, NEW MEXICO

(INDICATE ABOVE BY CHECK MARK NATURE OF REPORT, NOTICE, OR OTHER DATA)

**September 13**, 19 **62**

Well No. **1-A Navajo** is located **2310** ft. from **[N]** line and **330** ft. from **[E]** line of sec. **16**  
**NW/4 Section 16** **29N** **18W** **N.M.P.M.**  
(1/4 Sec. and Sec. No.) (Twp.) (Range) (Meridian)  
**Shiprock-Gallup** **San Juan** **New Mex 100**  
(Field) (County or Subdivision) (State or Territory)

The elevation of the derrick floor above sea level is **5168** ft.

**DETAILS OF WORK**

(State names of and expected depths to objective sands; show sizes, weights, and lengths of proposed casings; indicate mudding jobs, cementing points, and all other important proposed work)

**TD 150' in 6-3/4" hole. It is proposed to plug hole from top to bottom with cement. Dry hole marker will be erected in accordance with regulations.**



I understand that this plan of work must receive approval in writing by the Geological Survey before operations may be commenced.

Company **UNIVERSAL OIL CORPORATION**

Address **158 Petroleum Center Bldg.**

**Farmington, New Mexico**

By   
Title **President**

SECRET

CONFIDENTIAL

CONFIDENTIAL

CONFIDENTIAL

CONFIDENTIAL

CONFIDENTIAL

CONFIDENTIAL

CONFIDENTIAL

CONFIDENTIAL

CONFIDENTIAL

CONFIDENTIAL

CONFIDENTIAL

CONFIDENTIAL

CONFIDENTIAL

CONFIDENTIAL

CONFIDENTIAL

CONFIDENTIAL

CONFIDENTIAL

CONFIDENTIAL

CONFIDENTIAL

CONFIDENTIAL

CONFIDENTIAL

CONFIDENTIAL

CONFIDENTIAL