

(SUBMIT IN TRIPLICATE)

Indian Agency **Window Rock**

UNITED STATES
DEPARTMENT OF THE INTERIOR
GEOLOGICAL SURVEY

Allottee **Tribal**
Lease No. _____

Navajo Tribal Contract 14-20-603-1049

SUNDRY NOTICES AND REPORTS ON WELLS

NOTICE OF INTENTION TO DRILL	<input checked="" type="checkbox"/>	SUBSEQUENT REPORT OF WATER SHUT-OFF	
NOTICE OF INTENTION TO CHANGE PLANS		SUBSEQUENT REPORT OF SHOOTING OR ACIDIZING	
NOTICE OF INTENTION TO TEST WATER SHUT-OFF		SUBSEQUENT REPORT OF ALTERING CASING	
NOTICE OF INTENTION TO REDRILL OR REPAIR WELL		SUBSEQUENT REPORT OF REDRILLING OR REPAIR	
NOTICE OF INTENTION TO SHOOT OR ACIDIZE		SUBSEQUENT REPORT OF ABANDONMENT	
NOTICE OF INTENTION TO PULL OR ALTER CASING		SUPPLEMENTARY WELL HISTORY	
NOTICE OF INTENTION TO ABANDON WELL			

RECEIVED
FEB 27 1962
U. S. GEOLOGICAL SURVEY
FARMINGTON, NEW MEXICO

(INDICATE ABOVE BY CHECK MARK NATURE OF REPORT, NOTICE, OR OTHER DATA)

February 26, 19 **62**

Well No. **8-A** is located **2145** ft. from **N** line and **1815** ft. from **E** line of sec. **17**
SW/4 NE/4 Sec. 17 **29N** **18W** **N.M.P.M.**
(1/4 Sec. and Sec. No.) (Twp.) (Range) (Meridian)
Shiprock-Gallup **San Juan** **New Mexico;**
(Field) (County or Subdivision) (State or Territory)

The elevation of the derrick floor above sea level is **5192** ft. **ground level**

DETAILS OF WORK

(State names of and expected depths to objective sands; show sizes, weights, and lengths of proposed casings; indicate mudding jobs, cementing points, and all other important proposed work)

Gallup Sand test. It is proposed to drill 8-3/4" hole from surface to 10'. 7" casing will be set at 10' and cemented with 10 sacks. Estimated total depth 110' with 6-1/4" hole. If commercial production is indicated, will set 2" tubing and complete.



I understand that this plan of work must receive approval in writing by the Geological Survey before operations may be commenced.

Company **UNIVERSAL OIL CORPORATION**

Address **158 Petroleum Center Building**

Farmington, New Mexico

By

Virgil L. Stwab

Title

President

RECEIVED

RECEIVED

RECEIVED

RECEIVED

RECEIVED

RECEIVED

RECEIVED

RECEIVED

RECEIVED

RECEIVED

RECEIVED

RECEIVED

RECEIVED

RECEIVED

RECEIVED

RECEIVED

RECEIVED

RECEIVED

RECEIVED

RECEIVED

RECEIVED

RECEIVED

RECEIVED

RECEIVED

RECEIVED

RECEIVED

RECEIVED

RECEIVED

Well Location and Acreage Dedication Plat

Section A.

Date **February 26, 1962**Operator **UNIVERSAL OIL CORPORATION**Well No. **8-A** Unit Letter **G** Section **17** Township **29 NORTH** Range **18 WEST** NMPMLocated **2145** Feet From **the NORTH** Line, **1815** Feet From **the EAST** LineCounty **SAN JUAN** G. L. Elevation **5192.0** Dedicated Acreage **40** AcresName of Producing Formation **Gallup** Pool **Shiprock-Gallup**

1. Is the Operator the only owner in the dedicated acreage outlined on the plat below?
Yes ☒ No ☐
2. If the answer to question one is "no", have the interests of all the owners been consolidated by communitization agreement or otherwise? Yes ☐ No ☐ If answer is "yes", Type of Consolidation.

3. If the answer to question two is "no", list all the owners and their respective interests below:

Owner

Land Description

Section B.

Note: All distances must be from outer boundaries of section.

This is to certify that the information in Section A above is true and complete to the best of my knowledge and belief.

UNIVERSAL OIL CORPORATION

(Operator)

Virgil L. Sloab

(Representative)

158 Petroleum Center Bldg.

(Address)

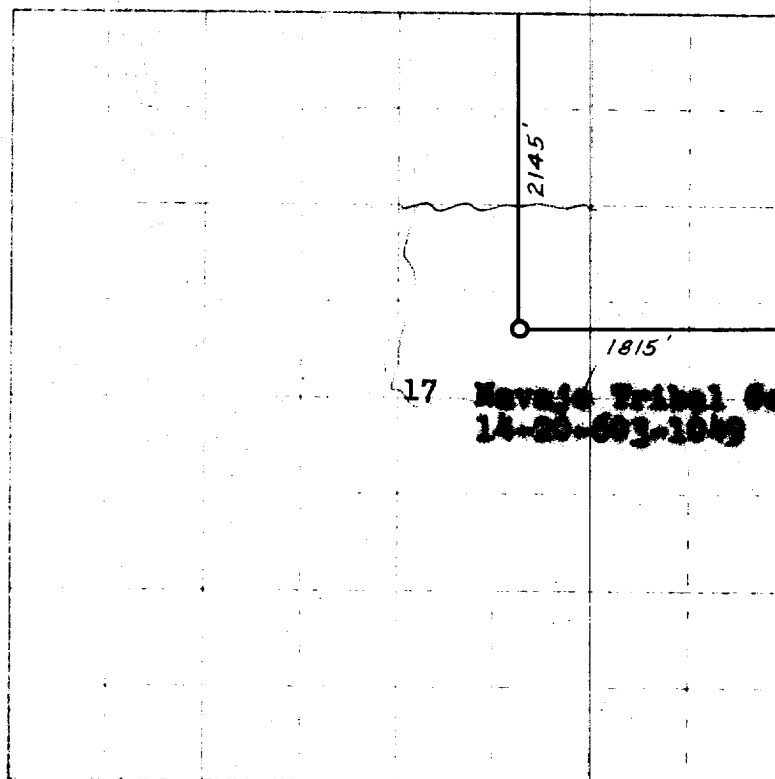
Farmington, New Mexico

0 350 500 990 1320 1650 1980 2310 2640 2000 1500 1000 500 0

Scale 4 inches equal 1 mile



This is to certify that the above plat was prepared from field notes of actual surveys made by me or under my supervision and that the same are true and correct to the best of my knowledge and belief.

Date Surveyed **February 23, 1962**

James P. Leese
Registered Professional Engineer and/or Land Surveyor
James P. Leese N. Mex. Reg. No. 1463
San Juan Engineering Co.

Farmington, New Mexico