

NMOCC

(SUBMIT IN TRIPLICATE)

Indian Agency _____

Navajo Tribal

UNITED STATES
DEPARTMENT OF THE INTERIOR
GEOLOGICAL SURVEY

Allottee _____

Lease No. **1-89-IND-58**

	X	

SUNDRY NOTICES AND REPORTS ON WELLS

NOTICE OF INTENTION TO DRILL	X	SUBSEQUENT REPORT OF WATER SHUT-OFF	
NOTICE OF INTENTION TO CHANGE PLANS		SUBSEQUENT REPORT OF SHOOTING OR ACIDIZING	
NOTICE OF INTENTION TO TEST WATER SHUT-OFF		SUBSEQUENT REPORT OF ALTERING CASING	
NOTICE OF INTENTION TO REDRILL OR REPAIR WELL		SUBSEQUENT REPORT OF REDRILLING OR REPAIR	
NOTICE OF INTENTION TO SHOOT OR ACIDIZE		SUBSEQUENT REPORT OF ABANDONMENT	
NOTICE OF INTENTION TO PULL OR ALTER CASING		SUPPLEMENTARY WELL HISTORY	
NOTICE OF INTENTION TO ABANDON WELL			

(INDICATE ABOVE BY CHECK MARK NATURE OF REPORT, NOTICE, OR OTHER DATA)

USG Section 18

Farmington, New Mexico October 29 19 57

Well No. **18** is located **1980** ft. from **N** line and **1980** ft. from **W** line of sec.

NW/4 of Section 18
(1/4 Sec. and Sec. No.)

T-29-N

R-16-W

N.M.P.M.

Wildest

San Juan

New Mexico

(Field)

(County or Subdivision)

(State or Territory)

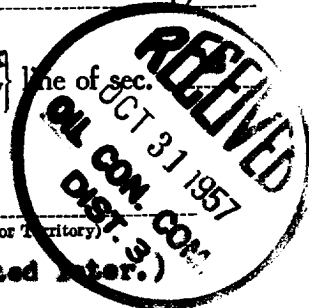

The elevation of the derrick floor above sea level is _____ ft. (To be reported later.)

DETAILS OF WORK

(State names of and expected depths to objective sands; show sizes, weights, and lengths of proposed casings; indicate mudding jobs, cementing points, and all other important proposed work)

We propose to drill the above well as follows: Rotary tools to a total depth of approximately 850'. Anticipate production from Dakota Formation.

Casing program:

SIZE	DEPTH	CEMENT	REMARKS
7"	60'	35 sacks	200% amount to circulate to surface.
3-1/2"	850'		150% of amount to circulate to surface.

Copies of location plat are attached. A copy of any survey will be submitted upon completion of well.

I understand that this plan of work must receive approval in writing by the Geological Survey before operations may be commenced.

Company **Pan American Petroleum Corporation**

Address **Box 487**
Farmington, New Mexico

ORIGINAL SIGNED BY

D. J. SCOTT

By

Title **Field Clerk**

NEW MEXICO OIL CONSERVATION COMMISSION

Well Location and Acreage Dedication Plat

Section A.

Date September 2, 1957

Operator Pan American Petroleum Corporation Lease USG Section 18
Well No. 18 Unit Letter 1 Section 18 Township 29 North Range 16 West NMPM
Located 1980 Feet From North Line, 1980 Feet From West Line
County San Juan G. L. Elevation 3100 Dedicated Acreage 80 Acres
Name of Producing Formation Sabine Pool Wilson

1. Is the Operator the only owner* in the dedicated acreage outlined on the plat below?
Yes X No
2. If the answer to question one is "no," have the interests of all the owners been consolidated by communitization agreement or otherwise? Yes No . If answer is "yes,"
Type of Consolidation
3. If the answer to question two is "no," list all the owners and their respective interests below:
to be reported later

Owner

Land Description

Section B

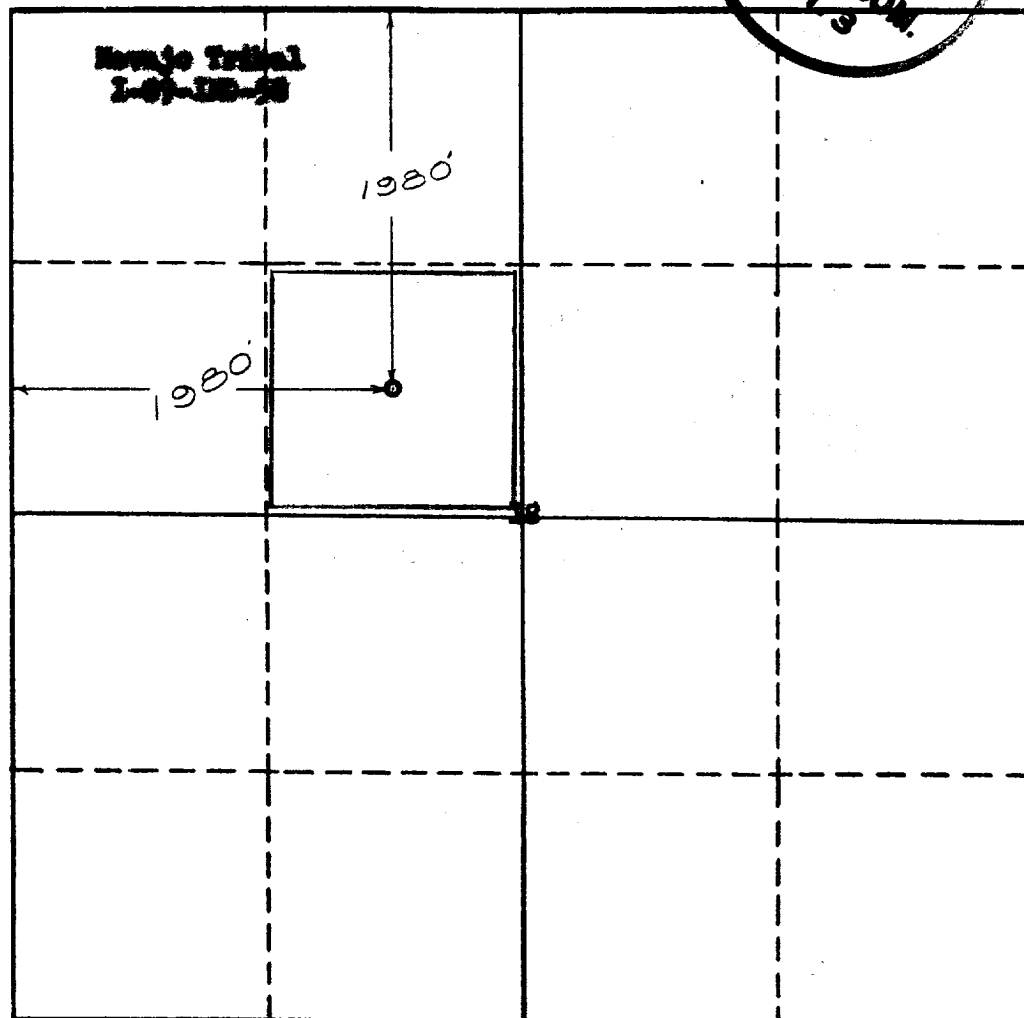

This is to certify that the information in Section A above is true and complete to the best of my knowledge and belief.

PAN AMERICAN PETROLEUM CORP.

(Operator)

R. M. Bauer, Jr. *RMBauer, Jr.*

(Representative)

Box 487, Farmington, New Mexico

Address

This is to certify that the well location shown on the plat in Section B was plotted from field notes of actual surveys made by me under my supervision and that the same is true to the best of my knowledge and belief.

Date Surveyed August 30, 1957

Ernest V. Echohawk
Registered Land Surveyor.

Certificate No. 1545