

NEW MEXICO OIL CONSERVATION COMMISSION

Santa Fe, New Mexico

Form C-101
Revised (12/1/55)

NOTICE OF INTENTION TO DRILL

Notice must be given to the District Office of the Oil Conservation Commission and approval obtained before drilling or recompletion begins. If changes in the proposed plan are considered advisable, a copy of this notice showing such changes will be returned to the sender. Submit this notice in QUINTUPLICATE. One copy will be returned following approval. See additional instructions in Rules and Regulations of the Commission.

If State Land submit 6 Copies Attach Form C-128 in triplicate to first 3 copies of form C-101

Farmington, New Mexico

(Place)

April 10, 1962

(Date)

OIL CONSERVATION COMMISSION
SANTA FE, NEW MEXICO

Gentlemen:

You are hereby notified that it is our intention to commence the Drilling of a well to be known as

Pan American Petroleum Corporation

(Company or Operator)

Cooper Gas Unit

(Lease)

Well No. 1, in 13. The well is

(Unit)

located 1190 feet from the North line and 1650 feet from the

East

Line of Section 15, T. 29N, R. 11W, NMPM.

(GIVE LOCATION FROM SECTION LINE) Basin Dakota Pool, San Juan County

If State Land the Oil and Gas Lease is No.

If patented land the owner is Ruth M. Cooper

Address.

We propose to drill well with drilling equipment as follows: Rotary tools to total depth.

The status of plugging bond is State wide

Drilling Contractor Brinkerhoff Drilling Company

870 Denver Club Building

Denver 2, Colorado

We intend to complete this well in the Dakota

formation at an approximate depth of 6600 feet.

CASING PROGRAM

We propose to use the following strings of Casing and to cement them as indicated:

Size of Hole	Size of Casing	Weight per Foot	New or Second Hand	Depth	Sacks Cement
12-1/4"	8-5/8"	22.7	New	500'	315
7-7/8"	4-1/2"	10.5	New	6600'	See Below

If changes in the above plans become advisable we will notify you immediately.

ADDITIONAL INFORMATION (If recompletion give full details of proposed plan of work.) Oil string casing to be cemented by the stage method. First stage cemented with 285 sacks of 6% gel with 1-1/2 lbs. Tuf Plug per sack with 100 sacks neat Incor cement on bottom. Second stage to be cemented with 520 sacks Incor cement 4% gel. Second stage collar to be set approx. 100' below base of Pictured Cliffs. Copies of location plat are attached and copies of any logs taken will be submitted upon completion of well.

Approved: 4-17, 1962
Except as follows: Subject to approval of
communitization agreements by all working
interests in the unit, prior to production.

Sincerely yours,

Pan American Petroleum Corporation

(Company or Operator)

R. M. Bauer, Jr.

By

Position Senior Petroleum Engineer

and Communications regarding well to

Name L. O. Speer, Jr.

Address Box 120, Farmington, New Mexico

OIL CONSERVATION COMMISSION

By

Well Location and Acreage Dedication Plat

Section A.

Date April 10, 1962

Operator PAN AMERICAN PETROLEUM CORPORATION Lease COOPER GAS UNIT
 Well No. 1 Unit Letter B Section 15 Township 29 NORTH Range 11 WEST, NMPM
 Located 1190 Feet From the NORTH Line. 1650 Feet From the EAST Line
 County SAN JUAN G. L. Elevation To report later Dedicated Acreage 320 Acres
 Name of Producing Formation Dakota Pool Basin Dakota

1. Is the Operator the only owner in the dedicated acreage outlined on the plat below?
 Yes ☐ No ☒ X
2. If the answer to question one is "no", have the interests of all the owners been consolidated by communitization agreement or otherwise? Yes ☒ X No ☐ If answer is "yes" Type of Consolidation COMMUNITIZATION
3. If the answer to question two is "no", list all the owners and their respective interests below:

Owner

Land Description

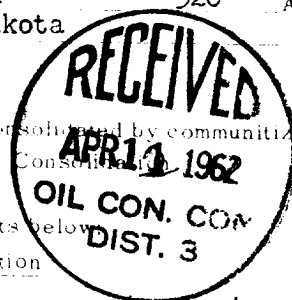

NOTE: Pan American Petroleum Corporation holds leases on NE/4 and 55 acres out of W/2 SE/4, Skelly Oil Company E/2 SE/4, and R. N. Usher the remaining 25 acres out of W/2 SE/4. The partners have agreed to join in an E/2 Dakota unit as well as furnishing written approvals to drill the well on a lease basis pending execution of declaration of unitization and operating agreement.

Section B.

Note: All distances must be from outer boundaries of section.

This is to certify that the information in Section A above is true and complete to the best of my knowledge and belief.

Pan American Petroleum Corp.

(Operator)

R. M. Bauer, Jr. *RMB*

(Representative)

Box 480, Farmington, New Mexico

(Address)

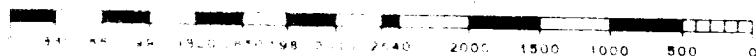
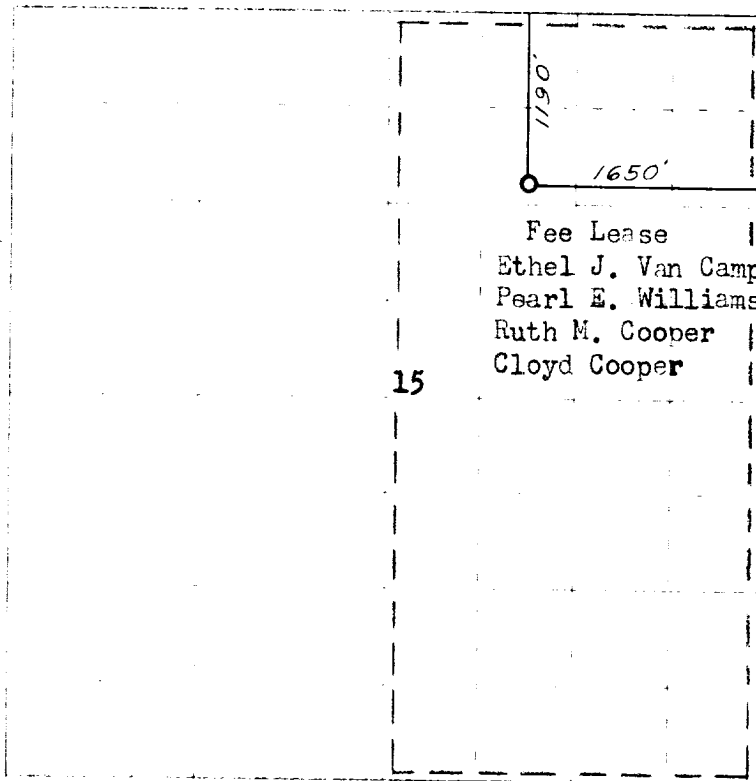

Scale: 1 inch equals 1 mile

Ref: GLO plat dated 25 June 1910

This is to certify that the above plat was prepared from field notes of actual surveys made by me or under my supervision and that the same are true and correct to the best of my knowledge and belief.

(Seal)

Date Surveyed 12 February 1962

Farmington, New Mexico

James P. Lease
 Registered Professional Engineer and/or Land Surveyor
 James P. Lease N. Mex. Reg. No. 1463
 San Juan, Farmington, N.M.