

OK-RISK BTEX

District I _____	State Of New Mexico	SUBMIT 1 COPY TO
P.O. Box 1980, Hobbs, NM	Energy, Minerals and Natural Resources Department	APPROPRIATE
District II _____	OIL CONSERVATION DIVISION	DISTRICT OFFICE
P.O. Drawer, Artesia, NM 88211	P.O. Box 2088	AND 1 COPY TO
District III _____	Santa Fe, New Mexico 87504-2088	SANTA FE OFFICE
1000 Rio Brazos Rd. Aztec, NM 87410		(Revised 3/9/94)

RECEIVED
JUL - 9 1999
OIL CON. DIV.
DIST. 3

PIT REMEDIATION AND CLOSURE REPORT

Operator: <u>Conoco Inc.</u>	Telephone: <u>505-324-5813</u>
Address: <u>3315 Bloomfield Hwy - Farmington, NM 87401</u>	
Facility Or: <u>Cooper #1</u>	
Well Name _____	
Location: Unit or Qtr/Qtr Sec	<u> </u> N Sec <u>7</u> T <u>29N</u> R <u>11W</u> County <u>San Juan</u>
Pit Type: Separator <u> </u>	Dehydrator <u> </u> Other <u>TDP</u>
Land Type: BLM <u> X </u> State <u> </u>	Fee <u> </u> Other <u> </u>
Pit Location: (Attach diagram)	Pit dimension: length <u>15'</u> width <u>15'</u> depth <u>3'</u>
	Reference: wellhead <u> X </u> other <u> </u>
	Footage from reference: <u>195'</u>
	Direction from reference: <u>312</u> Degrees <u> </u> East of <u> X </u> North
	<u> X </u> West <u> </u> South

Depth To Ground Water: (Vertical distance from contaminants to seasonal high water elevation of ground water)	Less than 50 feet (20 points)	50 feet to 9 feet (10 points)	Greater than 100 feet (0 points)	
	Total			<u>0</u>
Wellhead Protection Area: (Less than 200 feet from a private domestic water source, or; less than 1000 feet from all other water sources)	Yes (20 points)	No (0 points)		
	Total			<u>0</u>
Distance To Surface Water: (Horizontal distance to perennial lakes, ponds, rivers, streams, creeks, irrigation canals and ditches)	Less than 200 feet (20 points)	200 feet to 1000 feet (10 points)	Greater than 1000 feet (0 points)	
	Total			<u>0</u>
	RANKING SCORE (TOTAL POINTS):			<u>0</u>

Date Remediation Started: _____ Date Completed: _____

Remediation Method: Excavation: _____ Approx. cubic yards _____

(Check all appropriate sections)

Landfarm _____ Insitu Bioremediation _____

Other _____

Remediation Location: Onsite _____ Offsite _____

(ie. landfarmed onsite,
name and location of
offsite facility)

General Description Of Remedial Action: _____

One sample was taken at 3' below bottom of pit center. No PID reading was conducted on location. Sample

was transported to laboratory for TPH analysis per EPA Method 8015 and for BTEX analysis per EPA Method 8020A

OVM sample = 658 ppm

Ground Water Encountered: No ☒ Yes _____ Depth _____

Final Pit: Sample location Center of pit below bottom of pit

Closure Sampling: _____

(if multiple samples Sample depth 3'

attach sample results

and diagram of sample Sample date 2/5/99 Sample time 1153

locations and depths)

Sample Results

Benzene (ppm) ND

Total BTEX (ppm) 306

Field headspace (ppm) 658

TPH 3250

Ground Water Sample: Yes _____ No ☒ (If yes, attach sample results)

I HEREBY CERTIFY THAT THE INFORMATION ABOVE IS TRUE AND COMPLETE TO THE BEST
OF MY KNOWLEDGE AND BELIEF

DATE 6-28-99 PRINTED NAME _____

SIGNATURE [Signature] AND TITLE P.I.

Lease Name: Cooper 1 Operator: J. Miller Date: 2-5-99

Site Security
(Indicate North)

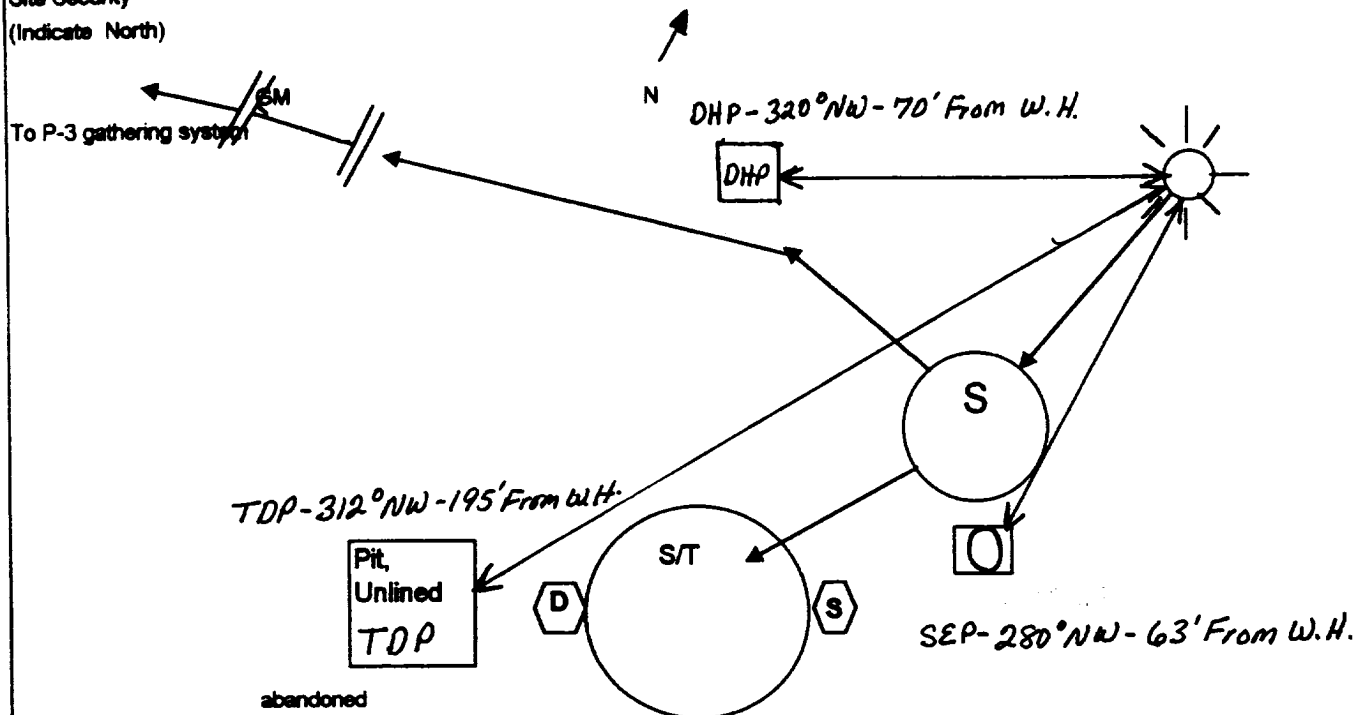

Lease Name: Cooper 1

Federal/ Indian Lease No: SP 077317

CA No.: _____

Unit : N

Legal Description: Sec: 7 T: 29N R: 11W

County: San Juan, NM

Load line valves :
Sealed during Production

Drain line valves :
Sealed during Production

Production Line valve:
Sealed during sales

This lease is subject to the site security plan for
San Juan Basin Operations. The plan is located at:
Conoco Inc.
3315 Bloomfield Hwy
Farmington, NM



COOPER #1
D.H.P.

320° NW

70' From W.H.
15' X 15' X 1.0

	Time	PPM
Center	1245	4
North	1250	4
East	1254	4
West	1258	4
South	1302	4

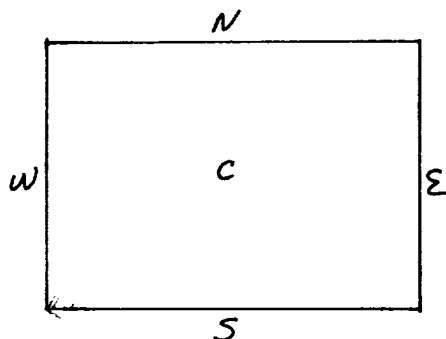

COOPER #1 SEP. PIT 280° NW. 63' From Well Head.

	Time	PPM
Center	1220	6
North	1225	5
East	1228	6
West	1233	7
South	1239	5

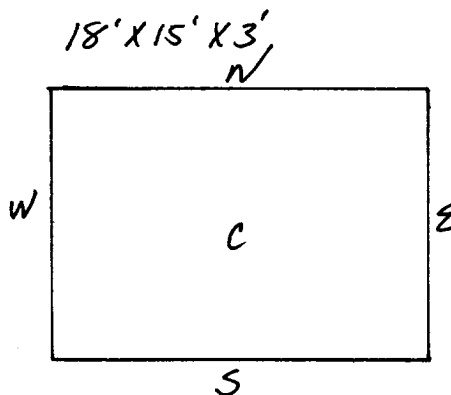

COOPER #1 TOP 312 ~~280~~° NW 195' From Well Head

	Time	PPM
Center	1153	658
North	1204	29
East	1209	9
West	1212	13
South	1215	9

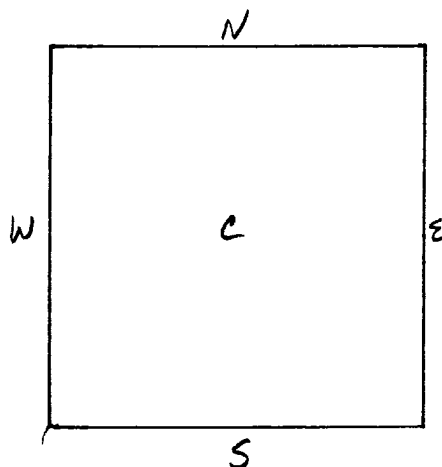

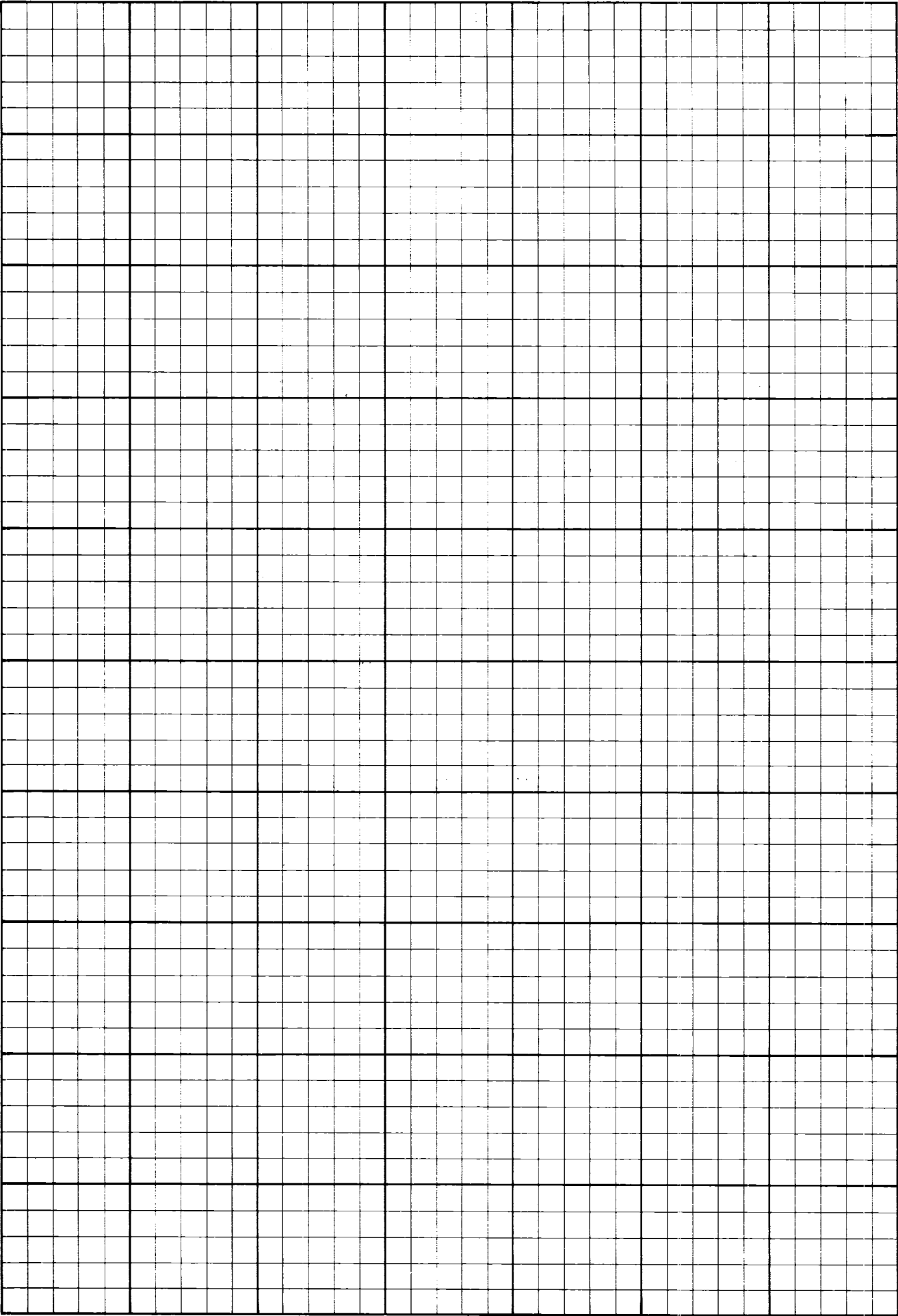



CHAIN OF CUSTODY RECORD

B 1180

Date: 2-5-99

Page 1 of 1

612 E. Murray Dr. • P. O. Box 2606 • Farmington NM 87499
(505) 327-1072 • FAX: (505) 327-1496

Purchase Order No.:		Job No.		Name		Title	
SEND INVOICE TO		Name		Company		Mailing Address	
Address		City, State, Zip		Telephone No.		Telefax No.	
3315 Bloomfield Hwy		Farmington N.Mex		87401			
Sampling Location: Cooper 1				ANALYSIS REQUESTED			
TDP							
Sampler: Judson Valdez							
SAMPLE IDENTIFICATION		SAMPLE DATE		MATRIX		PRES.	
Center of Pit.		2-5-99 1153		Soil		NONE	
North Wall		2-5-99 1204		Soil		NONE	
East Wall		2-5-99 1209		Soil		NONE	
West Wall		2-5-99 1212		Soil		NONE	
South Wall		2-5-99 1215		Soil		NONE	
4 Pt Composite		2-5-99 1335		Soil		NONE	
Relinquished by: Judson Valdez		Date/Time 2-5-99 1401		Received by: Harold Reese		Date/Time 2-5-99 1400	
Relinquished by:		Date/Time		Received by:		Date/Time	
Relinquished by:		Date/Time		Received by:		Date/Time	
Method of Shipment:		Rush		24-48 Hours		10 Working Days	
Authorized by:		(Client Signature Must Accompany Request)		Special Instructions:			

viná bá

(for life's sake)

612 E. Murray Dr. • P. O. Box 2606 • Farmington NM 87499
(505) 327-1072 • FAX: (505) 327-1496

Date: 2-5-99

Page 1 of 1

CHAIN OF CUSTODY RECORD

B 1180

Purchase Order No.:

Job No.

SEND INVOICE TO

Name

Company

Dept.

Address

City, State, Zip

Sampling Location:

Sampler:

SAMPLE IDENTIFICATION

SAMPLE DATE TIME MATRIX PRES.

Number of Containers

REPORT RESULTS TO

Name

Title

Company

Mailing Address

City, State, Zip

Telephone No.

Telefax No.

ANALYSIS REQUESTED

LAB ID

Reinquished by: Paul Valley

Date/Time 2-5-99 1401

Received by: Paul Valley

Date/Time 2-5-99 1401

Special Instructions:

Method of Shipment:

Rush

24-48 Hours

10 Working Days

Special Instructions:

Authorized by:

Date

(Client Signature Must Accompany Request)

Distribution: Write - On Site

Yellow - LAB

Pink - Sampler

Goldendrod - Client

OFF: (505) 325-5667



LAB: (505) 325-1556

February 25, 1999

Shirley Ebert
Conoco, Inc.
3315 Bloomfield Hwy
Farmington, NM 87401
TEL: (505) 324-5813
FAX (505) 324-5825

RE: Cooper 1 TDP

Order No.: 9902035

Dear Shirley Ebert,

On Site Technologies, LTD. received 2 samples on 2/5/99 for the analyses presented in the following report.

The Samples were analyzed for the following tests:

BTEX (SW8021B)
Diesel Range Organics (SW8015)
Gasoline Range Organics (SW8015)

There were no problems with the analyses and all data for associated QC met EPA or laboratory specifications except where noted in the Case Narrative.

If you have any questions regarding these tests results, please feel free to call.

Sincerely,

A handwritten signature in black ink, appearing to read 'David Cox'.

David Cox

OFF: (505) 325-5667



LAB: (505) 325-1556

On Site Technologies, LTD.

Date: 25-Feb-99

CLIENT: Conoco, Inc.
Project: Cooper 1 TDP
Lab Order: 9902035

CASE NARRATIVE

Samples were analyzed using the methods outlined in the following references:

Test Methods for Evaluating Solid Waste, Physical/Chemical Methods, SW846, 3rd Edition

All method blanks, laboratory spikes, and/or matrix spikes met quality assurance objectives.

OFF: (505) 325-5667



LAB: (505) 325-1556

ANALYTICAL REPORT

Date: 25-Feb-99

Client:	Conoco, Inc.	Client Sample Info:	Cooper 1 TDP
Work Order:	9902035	Client Sample ID:	Center of Pit
Lab ID:	9902035-01A	Matrix:	SOIL
Project:	Cooper 1 TDP	Collection Date:	2/5/99 11:53:00 AM
		COC Record:	B1180

Parameter	Result	PQL	Qual	Units	DF	Date Analyzed
DIESEL RANGE ORGANICS		SW8015				Analyst: DC
T/R Hydrocarbons: C10-C28	950	25		mg/Kg	1	2/24/99
GASOLINE RANGE ORGANICS		SW8015				Analyst: HR
T/R Hydrocarbons: C6-C10	2300	180		mg/Kg	1000	2/14/99
BTEX		SW8021B				Analyst: HR
Benzene	ND	2500		µg/Kg	2500	2/11/99
Toluene	21000	5000		µg/Kg	2500	2/11/99
Ethylbenzene	20000	2500		µg/Kg	2500	2/11/99
m,p-Xylene	210000	5000		µg/Kg	2500	2/11/99
o-Xylene	55000	2500		µg/Kg	2500	2/11/99

Qualifiers:	PQL - Practical Quantitation Limit	S - Spike Recovery outside accepted recovery limits
	ND - Not Detected at Practical Quantitation Limit	R - RPD outside accepted recovery limits
	J - Analyte detected below Practical Quantitation Limit	E - Value above quantitation range
	B - Analyte detected in the associated Method Blank	Surr: - Surrogate

P.O. BOX 2606 • FARMINGTON, NM 87499

1 of 1

OFF: (505) 325-5667



LAB: (505) 325-1556

ANALYTICAL REPORT

Date: 25-Feb-99

Client:	Conoco, Inc.	Client Sample Info:	Cooper 1 TDP
Work Order:	9902035	Client Sample ID:	4pt. Composite
Lab ID:	9902035-02A	Matrix:	SOIL
Project:	Cooper 1 TDP	Collection Date:	2/5/99 1:35:00 PM
		COC Record:	B1180

Parameter	Result	PQL	Qual	Units	DF	Date Analyzed
DIESEL RANGE ORGANICS		SW8015				Analyst: DC
T/R Hydrocarbons: C10-C28	ND	25		mg/Kg	1	2/24/99
GASOLINE RANGE ORGANICS		SW8015				Analyst: HR
T/R Hydrocarbons: C6-C10	ND	0.18		mg/Kg	1	2/12/99

Qualifiers:

PQL - Practical Quantitation Limit

ND - Not Detected at Practical Quantitation Limit

J - Analyte detected below Practical Quantitation Limit

B - Analyte detected in the associated Method Blank

S - Spike Recovery outside accepted recovery limits

R - RPD outside accepted recovery limits

E - Value above quantitation range

Surr: - Surrogate

1 of 1

P.O. BOX 2606 • FARMINGTON, NM 87499

On Site Technologies, Inc. is an Equal Opportunity Employer. Minorities and women are encouraged to apply.