

EL PASO FIELD SERVICES PRODUCTION PIT CLOSURE

04

Garrett Com #1
Meter/Line ID – 70105

SITE DETAILS

Legals - Twn: 29N	Rng: 11W	Sec: 12	Unit: J
NMOCD Hazard Ranking: 10		Land Type: FEE	
Operator: Parker Parsley		Pit Closure Date: 07/15/94	

RATIONALE FOR RISK-BASED CLOSURE

The pit noted above was assessed and ranked according to the criteria in the New Mexico Oil Conservation Division's (NMOCD) Unlined Surface Impoundment Closure Guidelines.

A test pit was excavated to 7 feet and a soil sample was collected for field headspace analysis and laboratory analysis for TPH. Groundwater was not encountered in the test pit and bedrock was encountered at 7 feet below ground surface. The pit was backfilled and graded in a manner to direct surface runoff away from the pit area. Headspace analysis indicated an organic vapor content of 26 ppm; laboratory analysis indicated a TPH concentration of <10 mg/kg.

El Paso Field Services Company (EPFS) requests closure of the above mentioned production pit location for the following reasons:

- The primary source, discharge to the pit, has been removed for almost six years.
- The test pit was backfilled and the former pit area graded to direct surface runoff away from the former pit.
- Groundwater was not encountered in the test excavation. In addition, the estimated depth to groundwater is greater than 50 feet.
- Bedrock was encountered at 7 feet below ground surface; therefore, impact to groundwater is unlikely.
- There are no water supply wells or other sources of fresh water extraction within 1,000 feet of the site.
- Residual hydrocarbons in the soil will degrade naturally with minimal risk to the environment.
- Based on the Hazard Ranking Score, TPH concentrations were below required remediation levels.

ATTACHMENT

Field Pit Assessment Form
Field Pit Remediation/Closure Form



Laboratory Analytical Results

FIELD PIT SITE ASSESSMENT FORM

GENERAL	<p>Meter: <u>70105</u> Location: <u>GARRETT COM #1</u></p> <p>Operator #: _____ Operator Name: ^{PARKER}<u>PARSEY</u> P/L District: <u>BLOOMFIELD</u></p> <p>Coordinates: Letter: <u>J</u> Section <u>12</u> Township: <u>29</u> Range: <u>11</u></p> <p>Or Latitude _____ Longitude _____</p> <p>Pit Type: Dehydrator _____ Location Drip: <input checked="" type="checkbox"/> Line Drip: _____ Other: _____</p> <p>Site Assessment Date: <u>5-18-94</u> Area: <u>10</u> Run: <u>93</u></p>								
SITE ASSESSMENT	<p>NMOCD Zone: (From NMOCD Maps)</p> <p style="margin-left: 40px;">Inside <input type="checkbox"/> (1) Outside <input checked="" type="checkbox"/> (2)</p> <p>Land Type:</p> <table style="margin-left: 40px;"> <tr> <td>BLM</td> <td><input type="checkbox"/> (1)</td> </tr> <tr> <td>State</td> <td><input type="checkbox"/> (2)</td> </tr> <tr> <td>Fee</td> <td><input checked="" type="checkbox"/> (3)</td> </tr> <tr> <td>Indian</td> <td>_____</td> </tr> </table> <p>Depth to Groundwater</p> <p>Less Than 50 Feet (20 points) <input type="checkbox"/> (1) 50 Ft to 99 Ft (10 points) <input checked="" type="checkbox"/> (2) Greater Than 100 Ft (0 points) <input type="checkbox"/> (3)</p> <p>Wellhead Protection Area : Is it less than 1000 ft from wells, springs, or other sources of fresh water extraction? , or ; Is it less than 200 ft from a private domestic water source? <input type="checkbox"/> (1) YES (20 points) <input checked="" type="checkbox"/> (2) NO (0 points)</p> <p>Horizontal Distance to Surface Water Body</p> <p>Less Than 200 Ft (20 points) <input type="checkbox"/> (1) 200 Ft to 1000 Ft (10 points) <input type="checkbox"/> (2) Greater Than 1000 Ft (0 points) <input checked="" type="checkbox"/> (3)</p> <p>Name of Surface Water Body _____</p> <p>(Surface Water Body : Perennial Rivers, Major Wash, Streams, Creeks, Irrigation Canals, Ditches, Lakes, Ponds)</p> <p>Distance to Nearest Ephemeral Stream <input type="checkbox"/> (1) < 100' (Navajo Pits Only) <input type="checkbox"/> (2) > 100'</p> <p>TOTAL HAZARD RANKING SCORE: <u>10</u> POINTS</p>	BLM	<input type="checkbox"/> (1)	State	<input type="checkbox"/> (2)	Fee	<input checked="" type="checkbox"/> (3)	Indian	_____
BLM	<input type="checkbox"/> (1)								
State	<input type="checkbox"/> (2)								
Fee	<input checked="" type="checkbox"/> (3)								
Indian	_____								
REMARKS	<p>Remarks : <u>TWO PITS ON LOCATION. WILL CLOSE ONLY ONE PIT IS DRY.</u> <u>LOCATION IS JUST EAST OF HARE CANYON. REOLINE SHOWS LOCATION</u> <u>INSIDE V.Z. BUT TOPO SHOWS IT IS OUTSIDE V.Z.</u></p> <p style="text-align: right;"><u>DUSH INC</u></p>								

ORIGINAL PIT LOCATION

Original Pit : a) Degrees from North 256° Footage from Wellhead 104'
b) Length : 13' Width : 13' Depth : 2'

ORIGINAL PIT LOCATION

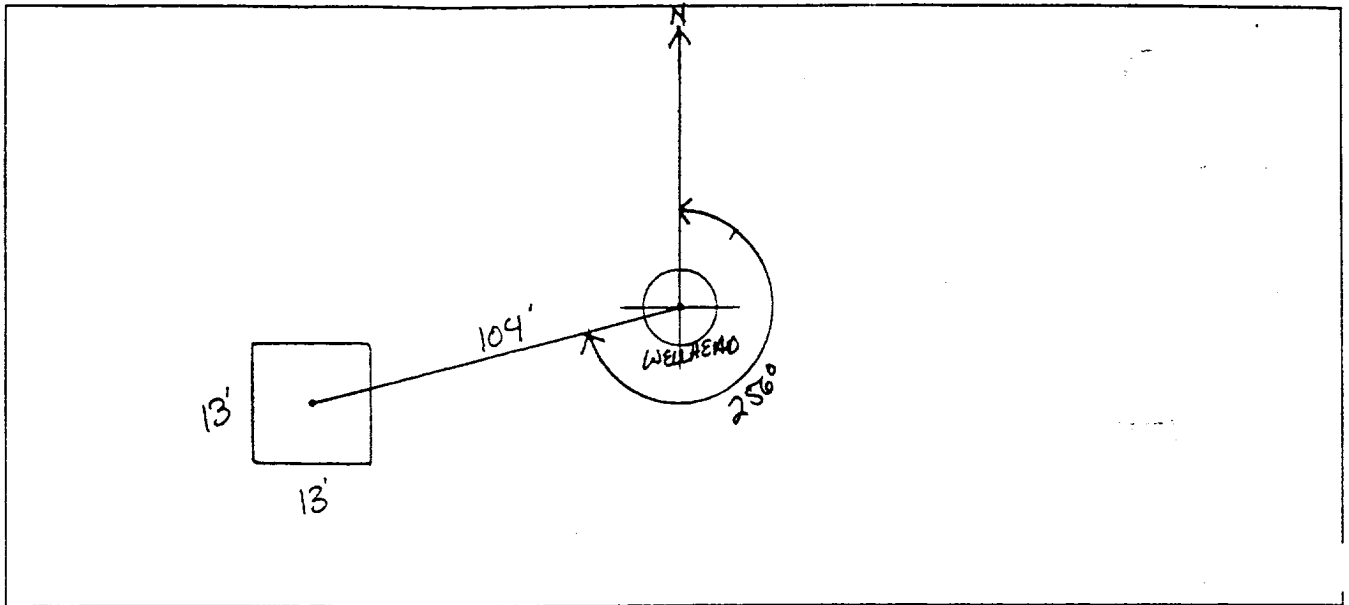

REMARKS :

TOOK PICTURES AT 3:14 P.M.

END DUMP

REMARKS

Completed By:

Robert Thompson

Signature

5.18.94

Date

FIELD PIT REMEDIATION/CLOSURE FORM

GENERAL	Meter: <u>70105</u> Location: <u>GARRETT Com #1</u> Coordinates: Letter: <u>I</u> Section <u>12</u> Township: <u>29</u> Range: <u>11</u> Or Latitude _____ Longitude _____ Date Started : <u>7-15-94</u> Run: <u>10</u> <u>93</u>
FIELD OBSERVATIONS	Sample Number(s): <u>MK141</u> Sample Depth: <u>7'</u> Feet Final PID Reading <u>26</u> PID Reading Depth <u>2'</u> Feet Yes No Groundwater Encountered <input type="checkbox"/> <input checked="" type="checkbox"/> Approximate Depth _____ Feet
CLOSURE	Remediation Method : Excavation <input type="checkbox"/> Approx. Cubic Yards _____ Onsite Bioremediation <input type="checkbox"/> Backfill Pit Without Excavation <input checked="" type="checkbox"/> Soil Disposition: Envirotech <input type="checkbox"/> Tierra <input type="checkbox"/> Other Facility <input type="checkbox"/> Name: _____ Pit Closure Date: <u>7-15-94</u> Pit Closed By: <u>BEI</u>
REMARKS	Remarks : <u>EPUG lines marked soil brown NO Hydrocarbo.</u> <u>odor Hit sandstone 7'</u>
	Signature of Specialist: <u>Morgan Lillian</u>



**FIELD SERVICES LABORATORY
ANALYTICAL REPORT
PIT CLOSURE PROJECT - Soil**

SAMPLE IDENTIFICATION

	Field ID	Lab ID
SAMPLE NUMBER:	mk 141	945691
MTR CODE SITE NAME:	70105	N/A
SAMPLE DATE TIME (Hrs):	7-15-94	13 27
SAMPLED BY:	N/A	
DATE OF TPH EXT. ANAL.:	7/19/94	7/19/94
DATE OF BTEX EXT. ANAL.:	N/A	N/A
TYPE DESCRIPTION:	VG	Brown Fine Sand

REMARKS:

RESULTS

PARAMETER	RESULT	UNITS	QUALIFIERS			
			DF	Q	M(g)	V(ml)
BENZENE		MG/KG				
TOLUENE		MG/KG				
ETHYL BENZENE		MG/KG				
TOTAL XYLENES		MG/KG				
TOTAL BTEX		MG/KG				
TPH (418.1)	<10	MG/KG			2.09	28
HEADSPACE PID	26	PPM				
PERCENT SOLIDS	95.88 95.9	skt/col %				

- TPH is by EPA Method 418.1 and BTEX is by EPA Method 8020 -

The Surrogate Recovery was at N/A % for this sample. All QA/QC was acceptable.
 rative:

DF = Dilution Factor Used

Approved By: J.F.

Date: 8/8/94