



TIDEWATER OIL COMPANY
B O X 1 2 3 1 , M I D L A N D , T E X A S

May 31, 1961

U. S. Department of the Interior
Geological Survey
P.O. Box 965
Farmington, New Mexico

Gentlemen:

We are enclosing Form 9-331a in Quintuplicate, together with Certified Plat, being application for permit to drill #1, New Mexico Federal Deep Unit 12E at the following location.

2120' feet North of the South line
990' feet West of the East line.
Section 12, T-29-N, R-11-W
San Juan County, New Mexico

Very truly yours,

TIDEWATER OIL COMPANY

Original Signed by
J. M. AMIS

J. M. Amis
Civil Engineer

JMA/sjk..

Attachment

cc: New Mexico Oil Conservation Commission ✓
1000 Rio Brazos Road
Astec, New Mexico
Mr. D. H. Connell - Houston
Mr. H. E. Berg - Houston
Mr. T. E. Weaver - Hobbs
Mr. R. H. Coe - Office
Mr. James Divelbiss - Durango
File



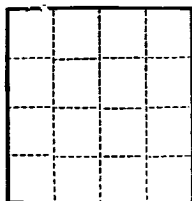

(SUBMIT IN TRIPLICATE)
UNITED STATES
DEPARTMENT OF THE INTERIOR
GEOLOGICAL SURVEY

30-045-08524

Budget Bureau No. 42-R358.4
Approval expires 12-31-60.

Land Office Las Cruces, N.M.

Lease No. NM 03717 B

Unit New Mexico Federal Deep
Unit 12E

SUNDRY NOTICES AND REPORTS ON WELLS

NOTICE OF INTENTION TO DRILL	<input checked="" type="checkbox"/>	SUBSEQUENT REPORT OF WATER SHUT-OFF	
NOTICE OF INTENTION TO CHANGE PLANS		SUBSEQUENT REPORT OF SHOOTING OR ACIDIZING	
NOTICE OF INTENTION TO TEST WATER SHUT-OFF		SUBSEQUENT REPORT OF ALTERING CASING	
NOTICE OF INTENTION TO RE-DRILL OR REPAIR WELL		SUBSEQUENT REPORT OF RE-DRILLING OR REPAIR	
NOTICE OF INTENTION TO SHOOT OR ACIDIZE		SUBSEQUENT REPORT OF ABANDONMENT	
NOTICE OF INTENTION TO PULL OR ALTER CASING		SUPPLEMENTARY WELL HISTORY	
NOTICE OF INTENTION TO ABANDON WELL			

(INDICATE ABOVE BY CHECK MARK NATURE OF REPORT, NOTICE, OR OTHER DATA)

May 31, 1961

Well No. 1 is located 2120 ft. from N line and 990 ft. from E line of sec. 12

NE 1/4, SE 1/4, Sec. 12 29N 11W NMPM
(1/4 Sec. and Sec. No.) (Twp.) (Range) (Meridian)

Undesignated (Dakota) San Juan New Mexico
(Field) (County or Subdivision) (State or Territory)

The elevation of the derrick floor above sea level is _____ ft. Ground Elev. 5788

DETAILS OF WORK

(State names of and expected depths to objective sands; show sizes, weights, and lengths of proposed casings; indicate mudding jobs, cementing points, and all other important proposed work)

13-3/8" 36# New Casing to be set at approximately 120' and cemented to surface. 4-1/2" 11.6# new casing to be set at approximately 6750'.
2 stage collar @ 2100' and cemented with sufficient volume to circulate back to 13-3/8". Section below 2100' cemented with sufficient volume to protect all pay zones.

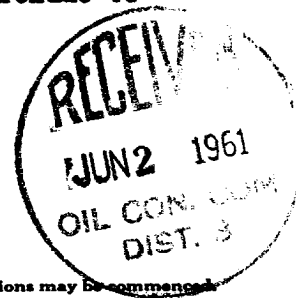

I understand that this plan of work must receive approval in writing by the Geological Survey before operations may be commenced.

Company TIDEWATER OIL COMPANY

Address Area Office - Box 547, Hobbs, New Mexico

Dist. Office - Box 1231, Midland, Tex.

Division Office, Box 1404, Houston, Texas Title Authorized Employee

NEW MEXICO OIL CONSERVATION COMMISSION
Well Location and Acreage Dedication Plat

Section A.

Date _____

Operator Tidewater Oil Co. Lease New Mexico Federal Deep Unit 12E
Well No. 1 Unit Letter I Section 12 Township 29N Range 11W NMPN
Located 2120 Feet From south Line, 990 Feet From east Line
County San Juan G. L. Elevation 5788 Dedicated Acreage (East 1/2) 320 Acres
Name of Producing Formation Dakota Pool Undesignated (Dakota)

1. Is the Operator the only owner* in the dedicated acreage outlined on the plat below?
Yes Yes No _____.
2. If the answer to question one is "no," have the interests of all the owners been consolidated by communitization agreement or otherwise? Yes _____ No _____. If answer is "yes," Type of Consolidation _____
3. If the answer to question two is "no," list all the owners and their respective interests below:

Owner

Land Description

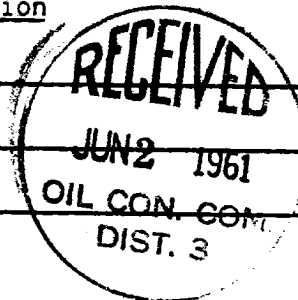

Section B

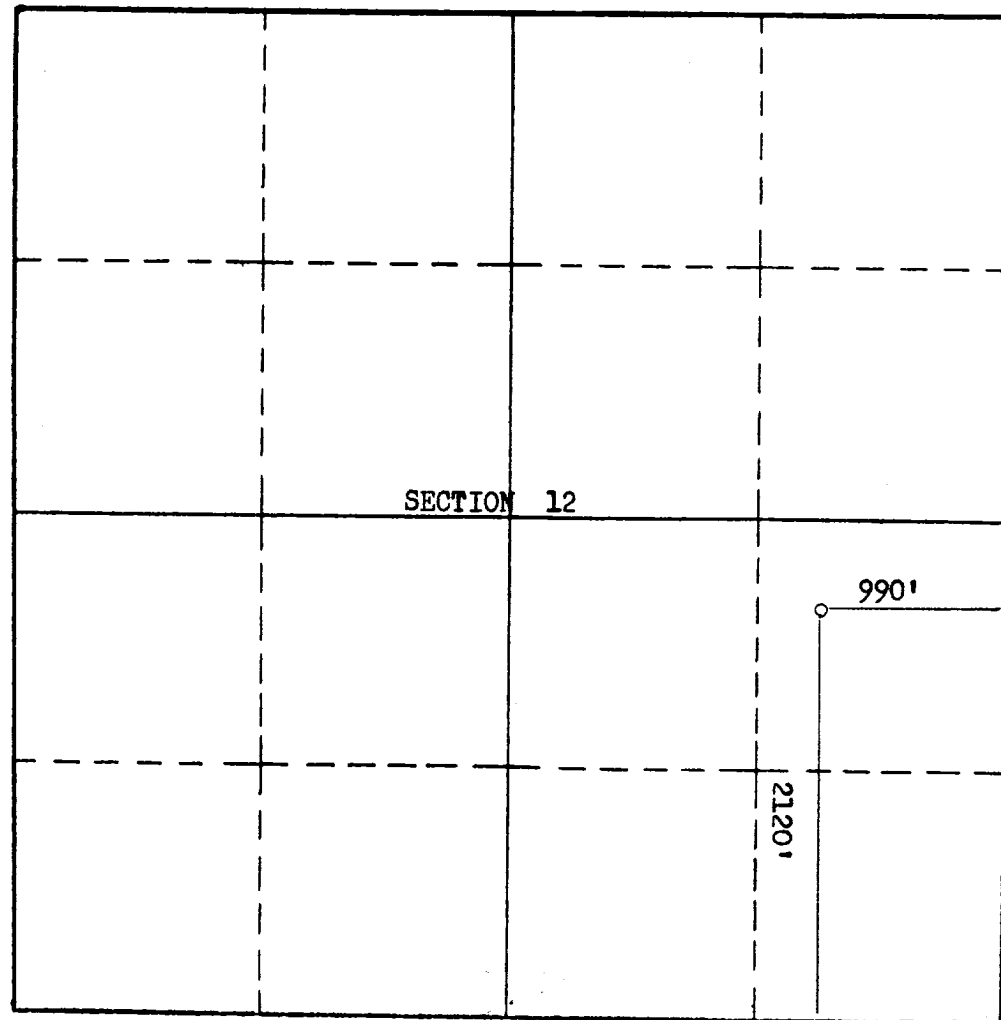

This is to certify that the information in Section A above is true and complete to the best of my knowledge and belief.

(Operator)

(Representative)

Address

This is to certify that the well location shown on the plat in Section B was plotted from field notes of actual surveys made by me or under my supervision and that the same is true and correct to the best of my knowledge and belief.

Date Surveyed May 26, 1961
Stephen H. Kinney
STEPHEN H. KINNEY,

Registered Professional
Engineer and/or Land Surveyor.

Certificate No. 803

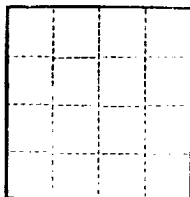

(SUBMIT IN TRIPLICATE)

UNITED STATES
DEPARTMENT OF THE INTERIOR
GEOLOGICAL SURVEY

Land Office Las Cruces, N.M.

Lease No. NM 03717 B

Unit New Mexico Federal Deep
Unit 12E

SUNDRY NOTICES AND REPORTS ON WELLS

NOTICE OF INTENTION TO DRILL	<input checked="" type="checkbox"/>	SUBSEQUENT REPORT OF WATER SHUT-OFF
NOTICE OF INTENTION TO CHANGE PLANS	<input type="checkbox"/>	SUBSEQUENT REPORT OF SHOOTING OR ACIDIZING
NOTICE OF INTENTION TO TEST WATER SHUT-OFF	<input type="checkbox"/>	SUBSEQUENT REPORT OF ALTERING CASING
NOTICE OF INTENTION TO RE-DRILL OR REPAIR WELL	<input type="checkbox"/>	SUBSEQUENT REPORT OF RE-DRILLING OR REPAIR
NOTICE OF INTENTION TO SHOOT OR ACIDIZE	<input type="checkbox"/>	SUBSEQUENT REPORT OF ABANDONMENT
NOTICE OF INTENTION TO PULL OR ALTER CASING	<input type="checkbox"/>	SUPPLEMENTARY WELL HISTORY
NOTICE OF INTENTION TO ABANDON WELL	<input type="checkbox"/>	

(INDICATE ABOVE BY CHECK MARK NATURE OF REPORT, NOTICE, OR OTHER DATA)

May 31, 1961

Well No. 1 is located 2120 ft. from NE line and 990 ft. from E line of sec. 12
NE 1/4, SE 1/4, Sec. 12 29N 11W NMPM
(1/4 Sec. and Sec. No.) (Twp.) (Range) (Meridian)
Undesignated (Dakota) San Juan New Mexico
(Field) (County or Subdivision) (State or Territory)

The elevation of the derrick floor above sea level is _____ ft. Ground Elev. 5788

DETAILS OF WORK

(State names of and expected depths to objective sands; show sizes, weights, and lengths of proposed casings; indicate mudding jobs, cementing points, and all other important proposed work)

13-3/8" 36# New Casing to be set at approximately 120' and cemented to surface. 4-1/2" 11.6# new casing to be set at approximately 6750'. 2 stage collar @ 2100' and cemented with sufficient volume to circulate back to 13-3/8". Section below 2100' cemented with sufficient volume to protect all pay zones.

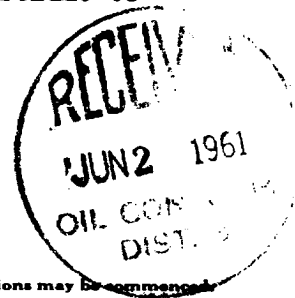

I understand that this plan of work must receive approval in writing by the Geological Survey before operations may be commenced.

Company TIDEWATER OIL COMPANY

Address Area Office - Box 547, Hobbs, New Mexico

Dist. Office - Box 1231, Midland, Tex.

Division Office, Box 1404, Houston, Texas Title Authorized Employee

NEW MEXICO OIL CONSERVATION COMMISSION

Well Location and Acreage Dedication Plat

Section A.

Date _____

Operator Tidewater Oil Co. Lease New Mexico Federal Deep Unit 12E
Well No. 1 Unit Letter I Section 12 Township 29N Range 11W NMPM
Located 2120 Feet From south Line, 990 Feet From east Line
County San Juan G. L. Elevation 5788 Dedicated Acreage (East 1/2) 320 Acres
Name of Producing Formation Dakota Pool Undesignated (Dakota)

1. Is the Operator the only owner* in the dedicated acreage outlined on the plat below?
Yes Yes No _____.
2. If the answer to question one is "no," have the interests of all the owners been consolidated by communitization agreement or otherwise? Yes _____ No _____. If answer is "yes," Type of Consolidation _____
3. If the answer to question two is "no," list all the owners and their respective interests below:

Owner

Land Description

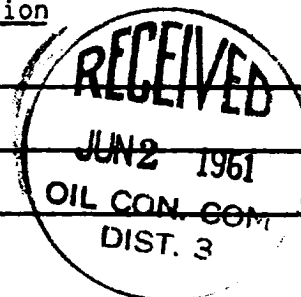

Section B

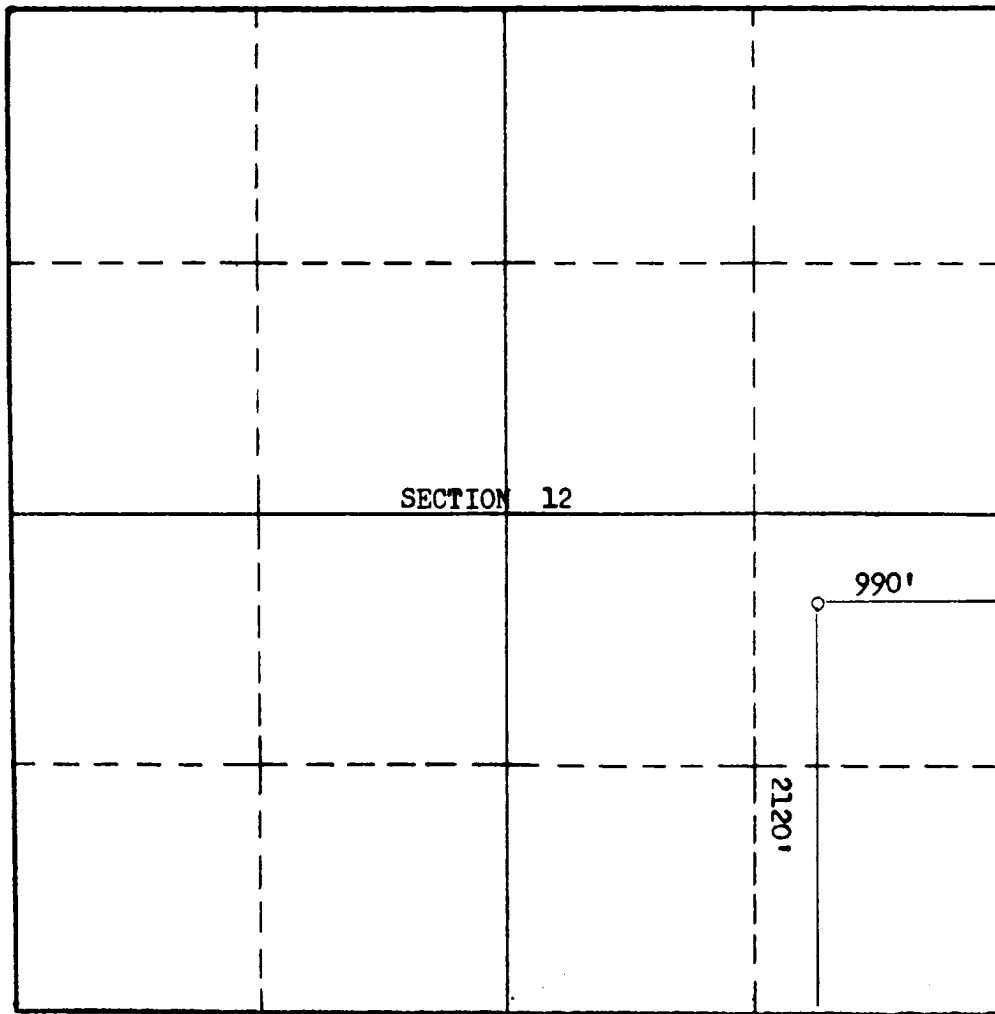

This is to certify that the information in Section A above is true and complete to the best of my knowledge and belief.

(Operator)

(Representative)

Address

This is to certify that the well location shown on the plat in Section B was plotted from field notes of actual surveys made by me or under my supervision and that the same is true and correct to the best of my knowledge and belief.

Date Surveyed May 26, 1961

Stephen H. Kinsley
STEPHEN H. KINSLEY

Registered Professional
Engineer and/or Land Surveyor.

Certificate No. 803

