

(SUBMIT IN TRIPLICATE)

UNITED STATES
DEPARTMENT OF THE INTERIOR
GEOLOGICAL SURVEY

Land Office Santa Fe
Lease No. N.M. 03486-1
Unit _____

SUNDRY NOTICES AND REPORTS ON WELLS

| | | | |
|---|-------------------------------------|---|--------------------|
| NOTICE OF INTENTION TO DRILL..... | <input checked="" type="checkbox"/> | SUBSEQUENT REPORT OF WATER SHUT-OFF..... | |
| NOTICE OF INTENTION TO CHANGE PLANS..... | | SUBSEQUENT REPORT OF SHOOTING OR ACIDIZING..... | |
| NOTICE OF INTENTION TO TEST WATER SHUT-OFF..... | | SUBSEQUENT REPORT OF ALTERING CASING..... | |
| NOTICE OF INTENTION TO RE-DRILL OR REPAIR WELL..... | | SUBSEQUENT REPORT OF RE-DRILLING OR REPAIR..... | |
| NOTICE OF INTENTION TO SHOOT OR ACIDIZE..... | | SUBSEQUENT REPORT OF ABANDONMENT..... | |
| NOTICE OF INTENTION TO PULL OR ALTER CASING..... | | SUPPLEMENTARY WELL HISTORY..... | <u>JAN 6, 1961</u> |
| NOTICE OF INTENTION TO ABANDON WELL..... | | | |

(INDICATE ABOVE BY CHECK MARK NATURE OF REPORT, NOTICE, OR OTHER DATA)

Jan. 4, 1961

Fogelson
Well No. 1-9 is located 1850 ft. from N line and 1850 ft. from E line of sec. 9
28 1/4 NW 1/4 sec 9 T29N 11W N.M.P.M.
(1/4 Sec. and Sec. No.) (Twp.) (Range) (Meridian)
Basin Dakota San Juan New Mexico
(Field) (County or Subdivision) (State or Territory)

The elevation of the ground ~~water~~ above sea level is 5096.5 ft.

DETAILS OF WORK

(State names of and expected depths to objective sands; show sizes, weights, and lengths of proposed casings; indicate mudding jobs, cementing points, and all other important proposed work)

Propose: Drill 12 1/2" hole to 250', set 8 5/8" O.D. 24# csg. and cement w/ 150 sx.

Drill 7 7/8" hole to 6700', set 5 1/2" O.D. 15.5# csg., cement first stage with 200 sx. and cement second stage to cover Pictured Cliff fm. with 100sx.

Perforate and frac Dakota fm. selectively w/ 100,000 gal. and 100,000 gal. water, cleanout well and run tbg.

I understand that this plan of work must receive approval in writing by the Geological Survey before operations may be commenced.

Company International Oil Corp.

Address 2010 Republic Bank Bldg.

Dallas, Texas

By [Signature]
Title Consulting Engineer

NEW MEXICO OIL CONSERVATION COMMISSION

Well Location and Acreage Dedication Plat

SECTION A.

Date Jan. 4, 1961

Operator INTERNATIONAL OIL CORPORATION Lease Pagelson
Well No. 1-9 Unit Letter F Section 9 Township 29 NORTH Range 11 WEST NMPM
Located 1850 Feet From THE NORTH Line, 1850 Feet From THE WEST Line
County SAN JUAN G. L. Elevation 5696.5 Dedicated Acreage 120 Acres
Name of Producing Formation Sakata Pool main

1. Is the Operator the only owner* in the dedicated acreage outlined on the plat below? Yes _____ No X
2. If the answer to question One is "No," have the interests of all the owners been consolidated by communitization agreement or otherwise? Yes X No _____. If answer is "Yes," Type of Consolidation _____
3. If the answer to question Two is "No," list all the owners and their respective interests below:

OWNER

LAND DESCRIPTION

SECTION B.

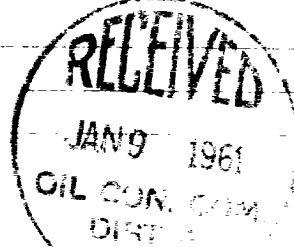
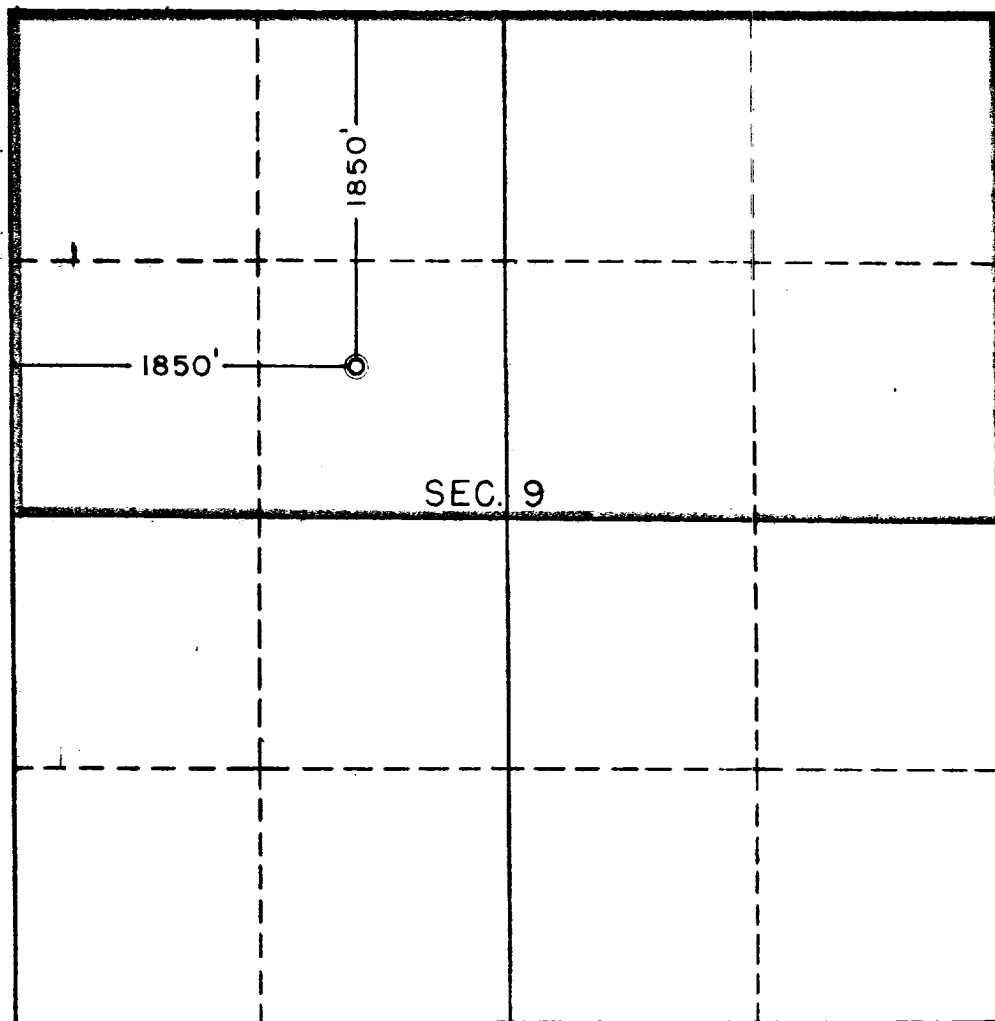

This is to certify that the information in Section A above is true and complete to the best of my knowledge and belief.

International Oil Corp.

(OPERATOR)

[Signature]
(REPRESENTATIVE)

1007 W. Dustin

(ADDRESS)

Farmington, New Mexico

This is to certify that the well location shown on the plat in Section B was plotted from field notes of actual surveys made by me or under my supervision and that the same is true and correct to the best of my knowledge and belief.

Date Surveyed **DEC. 21, 1960**

Four States Engineering Co.

FARMINGTON, NEW MEXICO

[Signature]

REGISTERED ENGINEER OR
LAND SURVEYOR

Certificate No. **1545 L.S.**

