

FIELD PIT SITE ASSESSMENT FORM



GENERAL

Meter: 73621 Location: FOGELSON #9-1
 Operator #: 0286 Operator Name: CONOCO P/L District: KUTZ
 Coordinates: Letter: E Section 9 Township: 29 Range: 11
 Or Latitude _____ Longitude _____
 Pit Type: Dehydrator Location Drip: _____ Line Drip: _____ Other: _____
 Site Visit Date: 3.21.94 Run: 02 41

SITE ASSESSMENT

NMOCD Zone: Inside Land Type: BLM
 (From NMOCD Vulnerable State
 Maps) Zone Fee
 Outside Indian _____

Depth to Groundwater
 Less Than 50 Feet (20 points)
 50 Ft to 99 Ft (10 points)
 Greater Than 100 Ft (0 points)

Denny E. Faust
 DEPUTY OIL & GAS INSPECTOR

SEP 10 1996

Approval

Wellhead Protection Area :

Is it less than 1000 ft from wells, springs, or other sources of fresh water extraction? , or ; Is it less than 200 ft from a private domestic water source? YES (20 points) NO (0 points)

Horizontal Distance to Surface Water Body

Less Than 200 Ft (20 points)
 200 Ft to 1000 Ft (10 points)
 Greater Than 1000 Ft (0 points)

RECEIVED
 APR - 4 1996

OIL CON. DIV.
 DIST. 3

Name of Surface Water Body _____

(Surface Water Body : Perennial Rivers, Major Wash, Streams, Creeks, Irrigation Canals, Ditches, Lakes, Ponds)

TOTAL HAZARD RANKING SCORE: 0 POINTS

REMARKS

Remarks : 2 PITS ON LOCATION. WILL CLOSE ONLY ONE OF THEM.

ORIGINAL PIT LOCATION

Original Pit : a) Degrees from North 58° Footage to Wellhead 107'
b) Degrees from North _____ Footage to Dogleg _____
Dogleg Name _____
c) Length : 16' Width : 13' Depth : 2'

ORIGINAL PIT LOCATION

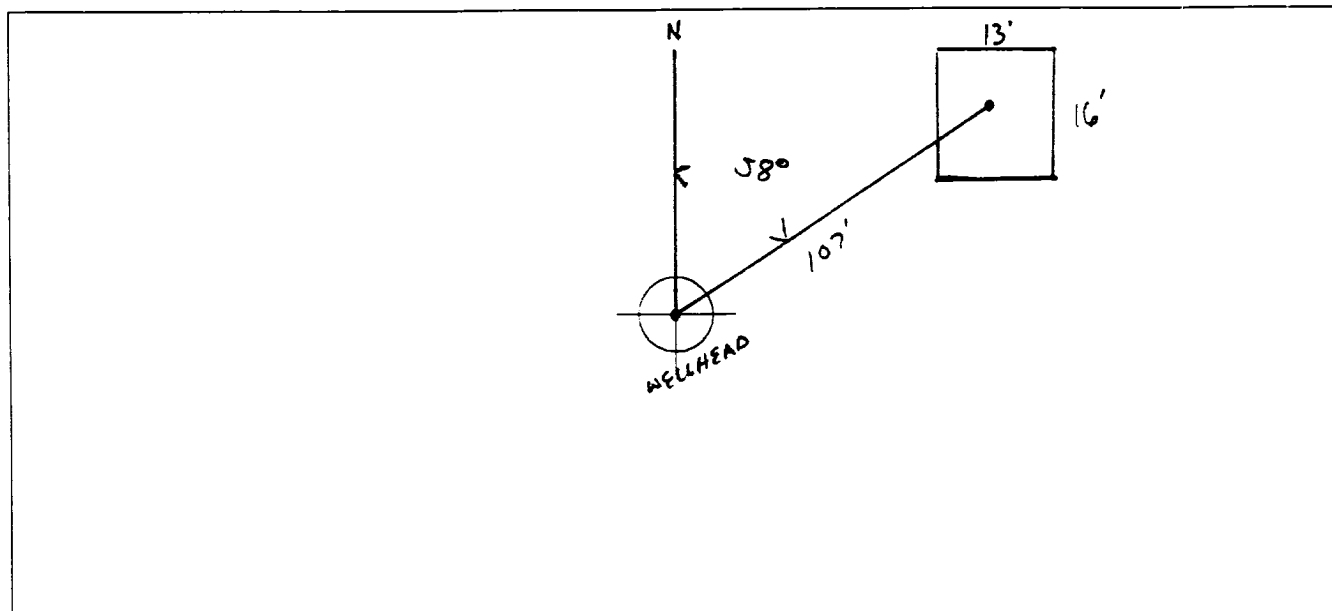

REMARKS :

STARTED TAKING PICTURES AT 10:39 A.M.
END DUMP

REMARKS

Completed By:

Robert Thompson
Signature

3.21.94
Date

GENERAL

Meter: 73621 Location: FOGELSON #9-1
 Operator #: _____ Operator Name: _____ P/L District: _____
 Coordinates: Letter: _____ Section _____ Township: _____ Range: _____
 Or Latitude _____ Longitude _____
 Pit Type: Dehydrator _____ Location Drip: _____ Line Drip: _____ Other: _____
 Site Assessment Date: _____ Area: 02 Run: 41

SITE ASSESSMENT

NMOCD Zone: (From NMOCD Maps) Inside (1) Outside (2)
Land Type: BLM (1) State (2) Fee (3) Indian _____

Depth to Groundwater
 Less Than 50 Feet (20 points) (1)
 50 Ft to 99 Ft (10 points) (2)
 Greater Than 100 Ft (0 points) (3)

Wellhead Protection Area :
 Is it less than 1000 ft from wells, springs, or other sources of fresh water extraction? , or ; Is it less than 200 ft from a private domestic water source? (1) YES (20 points) (2) NO (0 points)

Horizontal Distance to Surface Water Body
 Less Than 200 Ft (20 points) (1)
 200 Ft to 1000 Ft (10 points) (2)
 Greater Than 1000 Ft (0 points) (3)

Name of Surface Water Body GREEN CANYON
 (Surface Water Body : Perennial Rivers, Major Wash, Streams, Creeks, Irrigation Canals, Ditches, Lakes, Ponds)
 Distance to Nearest Ephemeral Stream (1) < 100' (Navajo Pits Only)
 (2) > 100'

TOTAL HAZARD RANKING SCORE: 40 POINTS

MARKS

Remarks : _____

FIELD PIT REMEDIATION/CLOSURE FORM

GENERAL

Meter: 73621 Location: Fogelson #9-1

Coordinates: Letter: F Section 9 Township: 29 Range: 11

Or Latitude _____ Longitude _____

Date Started : 4-26-94 Area: 02 Run: 41

FIELD OBSERVATIONS

Sample Number(s): ⁹⁴⁵⁰¹² KD 35

Sample Depth: 8' Feet

Final PID Reading 428 ppm PID Reading Depth 5' Feet

Yes No

Groundwater Encountered (1) (2) Approximate Depth _____ Feet

CLOSURE

Remediation Method :

Excavation (1) Approx. Cubic Yards 40

Onsite Bioremediation (2)

Backfill Pit Without Excavation (3)

Soil Disposition:

Envirotech (1) (3) Tierra

Other Facility (2) Name: _____

Pit Closure Date: 4-26-94 Pit Closed By: BEI

REMARKS

Remarks : Dug Pit to 8'; Hit Sandstone Layer; Took PID Reading, closed Pit

Signature of Specialist: Kenny Dearen



80

**FIELD SERVICES LABORATORY
ANALYTICAL REPORT
PIT CLOSURE PROJECT - Soil**

SAMPLE IDENTIFICATION

	Field ID	Lab ID
SAMPLE NUMBER:	KD.35	945012
MTR CODE SITE NAME:	736.21	N/A
SAMPLE DATE TIME (Hrs):	4/26/94	1710
SAMPLED BY:	N/A	
DATE OF TPH EXT. ANAL.:	4-28-94	4/28/94
DATE OF BTEX EXT. ANAL.:	5/9/94	5/10/94
TYPE DESCRIPTION:	VC	Brown/Grey Fine Sand

REMARKS:

RESULTS

PARAMETER	RESULT	UNITS	QUALIFIERS			
			DF	Q	M(g)	V(ml)
BENZENE	20.12	MG/KG		X10		
TOLUENE	20.12	MG/KG		X10		
ETHYL BENZENE	20.12	MG/KG		X10		
TOTAL XYLENES	2.0	MG/KG		X10		
TOTAL BTEX	2.36	MG/KG				
TPH (418.1)	<10	MG/KG			2.05	28
HEADSPACE PID	428	PPM				
PERCENT SOLIDS	92	%				

-- TPH is by EPA Method 418.1 and BTEX is by EPA Method 8020 --

The Surrogate Recovery was at 130 % for this sample All QA/QC was acceptable.

Narrative: ATI results attached - Surrogate recovery was outside ATI QC r limits due to matrix interference.

DF = Dilution Factor Used

Approved By: John Ford

Date: 5/21/94



Analytical **Technologies**, Inc.

2709-D Pan American Freeway, NE Albuquerque, NM 87107
Phone (505) 344-3777 FAX (505) 344-4413

ATI I.D. 405313

May 13, 1994

El Paso Natural Gas Company
P.O. Box 4990
Farmington, NM 87499

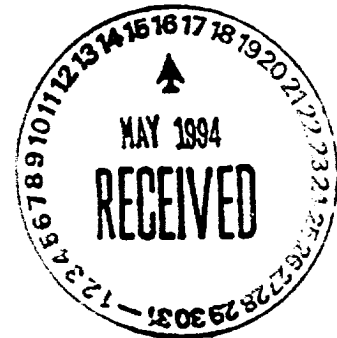

Project Name/Number: PIT CLOSURE 24324

Attention: John Lambdin

On **05/03/94**, Analytical Technologies, Inc., (ADHS License No. AZ0015), received a request to analyze **non-aqueous** samples. The samples were analyzed with EPA methodology or equivalent methods. The results of these analyses and the quality control data, which follow each set of analyses, are enclosed.

EPA Method 8015 analysis was added on 05/05/94 for sample 945008 per Stacy Sandler.

The matrix spike/spike duplicate data from the samples extracted on 05/05/94 is reported twice reflecting quantification using both the internal standard and external standard protocols. Both protocols were employed to quantify the samples submitted for this project.

If you have any questions or comments, please do not hesitate to contact us at (505) 344-3777.

Letitia Krakowski, Ph.D.
Project Manager

H. Mitchell Rubenstein, Ph.D.
Laboratory Manager

MR:jd

Enclosure

