

(SUBMIT IN TRIPLICATE)

UNITED STATES
DEPARTMENT OF THE INTERIOR
GEOLOGICAL SURVEY

Land Office Santa Fe
Lease No. 077317
Unit Cooper

SUNDRY NOTICES AND REPORTS ON WELLS

NOTICE OF INTENTION TO DRILL.....	<input checked="" type="checkbox"/>	SUBSEQUENT REPORT OF WATER SHUT-OFF.....	
NOTICE OF INTENTION TO CHANGE PLANS.....		SUBSEQUENT REPORT OF SHOOTING OR ACIDIZING.....	
NOTICE OF INTENTION TO TEST WATER SHUT-OFF.....		SUBSEQUENT REPORT OF ALTERING CASING.....	
NOTICE OF INTENTION TO RE-DRILL OR REPAIR WELL.....		SUBSEQUENT REPORT OF RE-DRILLING OR REPAIR.....	
NOTICE OF INTENTION TO SHOOT OR ACIDIZE.....		SUBSEQUENT REPORT OF ABANDONMENT.....	
NOTICE OF INTENTION TO PULL OR ALTER CASING.....		SUPPLEMENTARY WELL HISTORY.....	
NOTICE OF INTENTION TO ABANDON WELL.....			

(INDICATE ABOVE BY CHECK MARK NATURE OF REPORT, NOTICE, OR OTHER DATA)

February 13, 1961

Well No. B-1 is located 1850 ft. from N line and 790 ft. from E line of sec. 7

NE 1/4, Section 7
(1/4 Sec. and Sec. No.) 29N 11W N.M.P.M.
(Twp.) (Range) (Meridian)
Basin Dakota San Juan New Mexico
(Field) (County or Subdivision) (State or Territory)

The elevation of the derrick floor above sea level is 5736 ft. (Ground Elevation)

DETAILS OF WORK

(State names of and expected depths to objective sands; show sizes, weights, and lengths of proposed casings; indicate mudding jobs, cementing points, and all other important proposed work)

Propose To:

Set 300 feet of 8 5/8" surface casing and cement to surface.
Drill with rotary to approximate total depth of 6600 feet or through Dakota formation. Set 4 1/2" production casing at total depth and cement with 250 sx. Set two-stage cement collar approximately 100 feet below the Pictured Cliffs formation and cement with 175 sx.

Perforate Dakota formation. Sand-water frac with 100,000# sand and 100,000 gals. water. Run 2 3/8" tubing.

East one-half of Section 7, 320 acres, dedicated to well.

I understand that this plan of work must receive approval in writing by the Geological Survey before operations may be commenced.

Company Artec Oil and Gas Company

Address Drawer 570

Farmington, New Mexico

By ORIGINAL SIGNED BY JOE C. SALMON

Joe C. Salmon
Title District Superintendent

NEW MEXICO OIL CONSERVATION COMMISSION

Well Location and Acreage Dedication Plat

SECTION A.

Date **February 9, 1961**

Operator **Astec Oil and Gas Company** Lease **Cooper "B"**
Well No. **1** Unit Letter **H** Section **7** Township **29N** Range **11W** NMPM
Located **1850** Feet From **North** Line, **790** Feet From **East** Line
County **San Juan** G. L. Elevation **5736** Dedicated Acreage **320** Acres
Name of Producing Formation **Dakota** Pool **Basin**

1. Is the Operator the only owner* in the dedicated acreage outlined on the plat below? Yes **XXX** No
2. If the answer to question One is "No," have the interests of all the owners been consolidated by communization agreement or otherwise? Yes No If answer is "Yes," Type of Consolidation
3. If the answer to question Two is "No," list all the owners and their respective interests below:

OWNER

LAND DESCRIPTION

SECTION B.

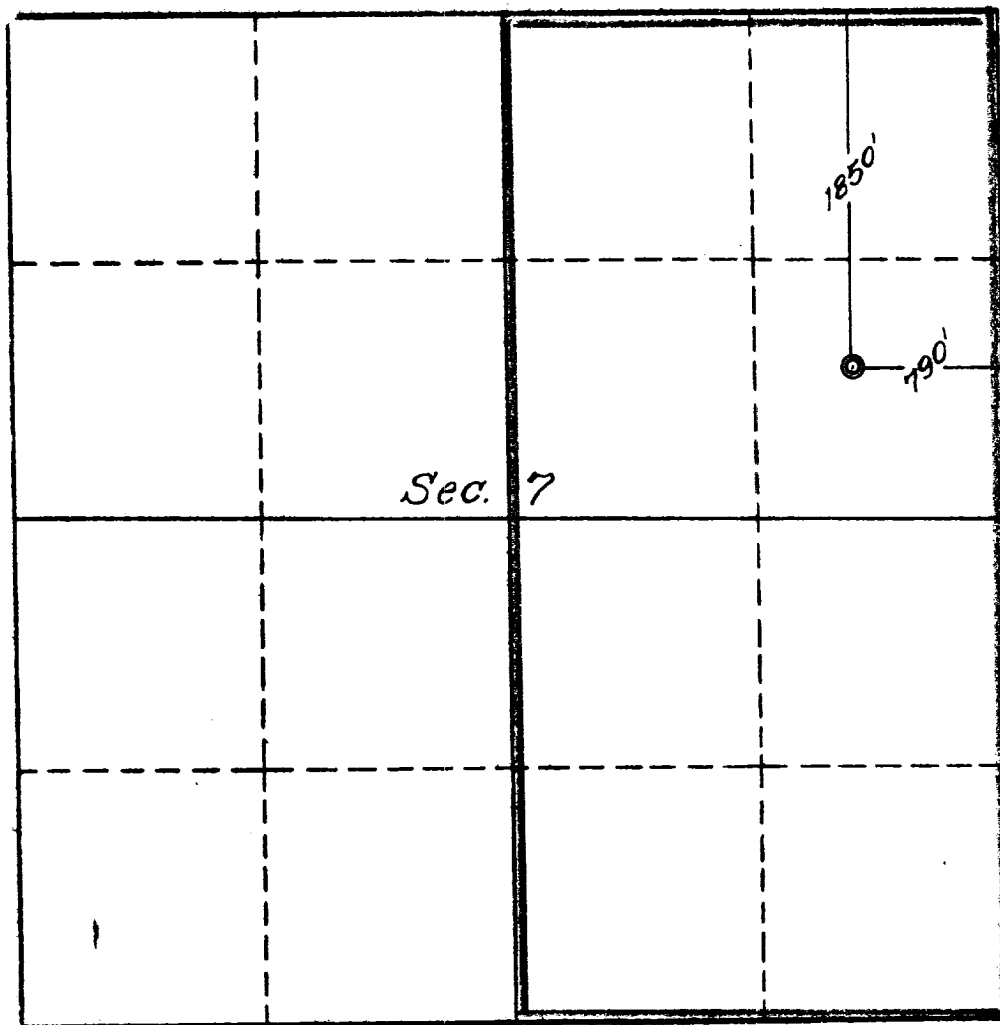

This is to certify that the information in Section A above is true and complete to the best of my knowledge and belief.

Astec Oil and Gas Company
(OPERATOR)

ORIGINAL SIGNED BY **JOE C. SALMON**
(REPRESENTATIVE)

Drawer 570, Farmington, N.M.
(ADDRESS)

This is to certify that the well location shown on the plat in Section B was plotted from field notes of actual surveys made by me or under my supervision and that the same is true and correct to the best of my knowledge and belief.

Date Surveyed **Feb 9, 1961**

Four States Engineering Co.
FARMINGTON, NEW MEXICO

E. V. Echols
REGISTERED ENGINEER OR
LAND SURVEYOR

Certificate No. **1545**

