

(SUBMIT IN TRIPLICATE)

Land Office Santa Fe  
Lease No. 65357-A  
Unit \_\_\_\_\_

UNITED STATES  
DEPARTMENT OF THE INTERIOR  
GEOLOGICAL SURVEY

2			

SUNDRY NOTICES AND REPORTS ON WELLS

NOTICE OF INTENTION TO DRILL	<input checked="" type="checkbox"/>	SUBSEQUENT REPORT OF WATER SHUT-OFF	
NOTICE OF INTENTION TO CHANGE PLANS		SUBSEQUENT REPORT OF SHOOTING OR ACIDIZING	
NOTICE OF INTENTION TO TEST WATER SHUT-OFF		SUBSEQUENT REPORT OF ALTERING CASING	
NOTICE OF INTENTION TO RE-DRILL OR REPAIR WELL		SUBSEQUENT REPORT OF RE-DRILLING OR REPAIR	
NOTICE OF INTENTION TO SHOOT OR ACIDIZE		SUBSEQUENT REPORT OF ABANDONMENT	
NOTICE OF INTENTION TO PULL OR ALTER CASING		SUPPLEMENTARY WELL HISTORY	
NOTICE OF INTENTION TO ABANDON WELL			

RECEIVED  
DEC 29 1960

(INDICATE ABOVE BY CHECK MARK NATURE OF REPORT, NOTICE, OR OTHER DATA)

U. S. GEOLOGICAL SURVEY  
FARMINGTON, NEW MEXICO

Well No. 1 is located 1135 ft. from EN line and 750 ft. from W line of sec. 10  
13 1/4 Section 10 29N 12W 26N  
(1/4 Sec. and Sec. No.) (Twp.) (Range) (Meridian)  
Indesignated San Juan New Mexico  
(Field) (County or Subdivision) (State or Territory)

The elevation of the derrick floor above sea level is 5670 ft.

DETAILS OF WORK

(State names of, and expected depths to objective sands; show sizes, weights, and lengths of proposed casings; indicate mudding jobs, cementing points, and all other important proposed work)

We propose to drill a well at the above location using rotary tools from surface to TD as follows:

1. Drill 12 1/4" hole to 250'.
2. Run & cement 250' 8 5/8" OD, 24 1/2" casing. Circ. cement to surface.
3. Run 24 hrs. Pressure test casing.
4. Drill 7 7/8" hole to TD (approx. 6200').

(over)

I understand that this plan of work must receive approval in writing by the Geological Survey before operations may be commenced.

Company Tennessee Gas Transmission Company

Address P. O. Box 1716

Durango, Colorado

By [Signature]

Title District Production Superintendent

NEW MEXICO OIL CONSERVATION COMMISSION  
WELL LOCATION AND ACREAGE DEDICATION PLAT

FORM C-128  
Revised 5/1/57

SEE INSTRUCTIONS FOR COMPLETING THIS FORM ON THE REVERSE SIDE

SECTION A

Operator Tennessee Gas Transmission Company		Lease Cornell Dakota Gas Unit "A"		Well No. 1
Unit Letter D	Section 10	Township 29 North	Range 12 West	County San Juan County
Actual Footage Location of Well: 1180 feet from the North line and 790 feet from the West line				
Ground Level Elev. 5679	Producing Formation Dakota		Pool Undesignated	Dedicated Acreage: 320 Acres

1. Is the Operator the only owner in the dedicated acreage outlined on the plat below? YES \_\_\_\_\_ NO X . ("Owner" means the person who has the right to drill into and to produce from any pool and to appropriate the production either for himself or for himself and another. (65-3-29 (e) NMSA 1935 Comp.)
2. If the answer to question one is "no," have the interests of all the owners been consolidated by communitization agreement or otherwise? YES X NO \_\_\_\_ . If answer is "yes," Type of Consolidation Communitization Agreement
3. If the answer to question two is "no," list all the owners and their respective interests below:

Owner	Land Description

SECTION B

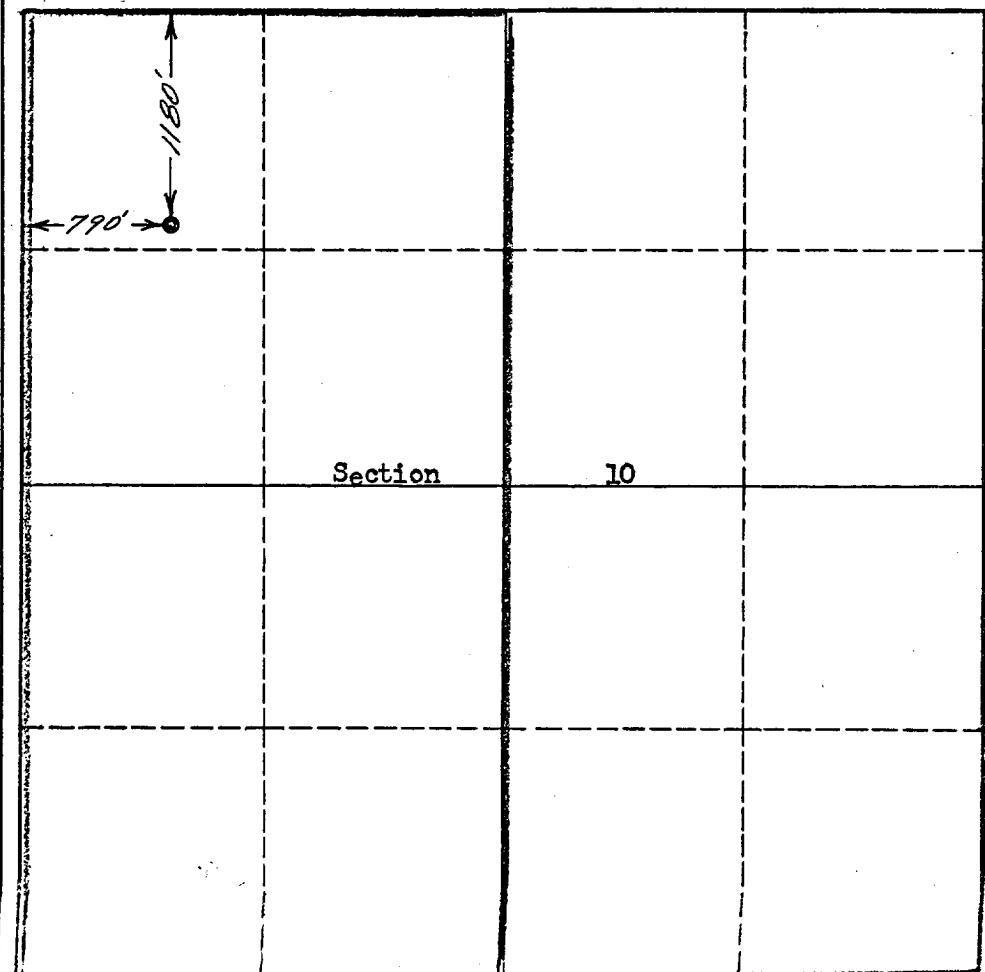

CERTIFICATION

I hereby certify that the information in SECTION A above is true and complete to the best of my knowledge and belief.

Name Robert H. Plumb  
Position District Production Supt.  
Company Tennessee Gas Trans. Co.  
Date December 27, 1960

I hereby certify that the well location shown on the plat in SECTION B was plotted from field notes of actual surveys made by me or under my supervision, and that the same is true and correct to the best of my knowledge and belief.

Date Surveyed  
21 December 1960  
Registered Professional Engineer  
and/or Land Surveyor

Robert H. Ernst  
Certificate No.  
P.E. & L.S. 2463

