

	X	

(SUBMIT IN TRIPLICATE)

UNITED STATES
DEPARTMENT OF THE INTERIOR
GEOLOGICAL SURVEY

Budget Bureau No. 42-R358.4.
Approval expires 12-31-60.
Land Office **New Mexico**
Lease No. **NM 02989**
Unit **Johnson Gas Unit "C"**

SUNDRY NOTICES AND REPORTS ON WELLS

NOTICE OF INTENTION TO DRILL.....	X	SUBSEQUENT REPORT OF WATER SHUT-OFF.....
NOTICE OF INTENTION TO CHANGE PLANS.....		SUBSEQUENT REPORT OF SHOOTING OR ACIDIZING.....
NOTICE OF INTENTION TO TEST WATER SHUT-OFF.....		SUBSEQUENT REPORT OF ALTERING CASING.....
NOTICE OF INTENTION TO RE-DRILL OR REPAIR WELL.....		SUBSEQUENT REPORT OF RE-DRILLING OR REPAIR.....
NOTICE OF INTENTION TO SHOOT OR ACIDIZE.....		SUBSEQUENT REPORT OF ABANDONMENT.....
NOTICE OF INTENTION TO PULL OR ALTER CASING.....		SUPPLEMENTARY WELL HISTORY.....
NOTICE OF INTENTION TO ABANDON WELL.....		

(INDICATE ABOVE BY CHECK MARK NATURE OF REPORT, NOTICE, OR OTHER DATA)

Johnson Gas Unit "C"

Farmington, New Mexico November 11, 1960

Well No. **1** is located **930** ft. from **[N]** line and **1700** ft. from **[W]** line of sec. **7**

NE/4 NW/4 of Section 7 **T-29-N** **R-12-W** **N.M.P.M.**
(1/4 Sec. and Sec. No.) (Twp.) (Range) (Meridian)

Undesignated Dakota **San Juan** **New Mexico**
(Field) (County or Subdivision) (State or Territory)

The elevation of the derrick floor above sea level is _____ ft. (To be reported later.)

DETAILS OF WORK

(State names of and expected depths to objective sands; show sizes, weights, and lengths of proposed casings; indicate mudding jobs, cementing points, and all other important proposed work)

We propose to drill Johnson Gas Unit "C" Well No. 1 to an approximate depth of 6300' with rotary tools to evaluate Dakota prospects. Stimulation and completion will be as indicated upon reaching total depth. The following casing program is proposed:

SIZE	DEPTH	CEMENT	REMARKS
8-5/8"	300'	250	Test - circulate.
4-1/2"	6500'	525	Casing will be cemented in 2 stages. First stage sufficient cement to bring top cement back to about 500' above top of Gallup. Second stage tool will be set 100' below base of Pictured Cliffs and cemented with sufficient cement to fill 200 - 300' above Pictured Cliffs.

A copy of any survey taken will be submitted upon completion of well. Copies of location plat attached.

I understand that this plan of work must receive approval in writing by the Geological Survey before operations may be commenced.

Company **Pan American Petroleum Corporation**

Address **Box 480**

Farmington, New Mexico

Attn: **L. O. Speer, Jr.**

By _____

Title **Area Engineer**

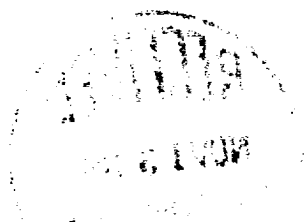

Well Location and Acreage Dedication Plat

Section A.

Date November 11, 1960

Operator PAN AMERICAN PETROLEUM CORPORATION Lease Johnson Gas Unit "C"
 Well No. 1 Unit Letter C Section 7 Township 29 NORTH Range 12 WEST, NMPM
 Located 930 Feet From NORTH Line, 1700 Feet From the WEST Line
 County SAN JUAN G. L. Elevation * Dedicated Acreage 316.84 Acres
 Name of Producing Formation DAKOTA Pool Undesignated Dakota

1. Is the Operator the only owner in the dedicated acreage outlined on the plat below?

Yes _____ No X

*To be reported later

2. If the answer to question one is "no", have the interests of all the owners been consolidated by communitization agreement or otherwise? Yes X No _____. If answer is "yes", Type of Consolidation.

Communitization instruments being circulated for signature.

3. If the answer to question two is "no", list all the owners and their respective interests below:

OwnerLand Description

Section B.

This is to certify that the information
 in Section A above is true and complete
 to the best of my knowledge and belief.

Pan American Petroleum Corporation

(Operator)

R. M. Bauer, Jr. RMBauer, Jr.

(Representative)

Box 480, Farmington, New Mexico

(Address)

Note: All distances must be from outer boundaries of section.

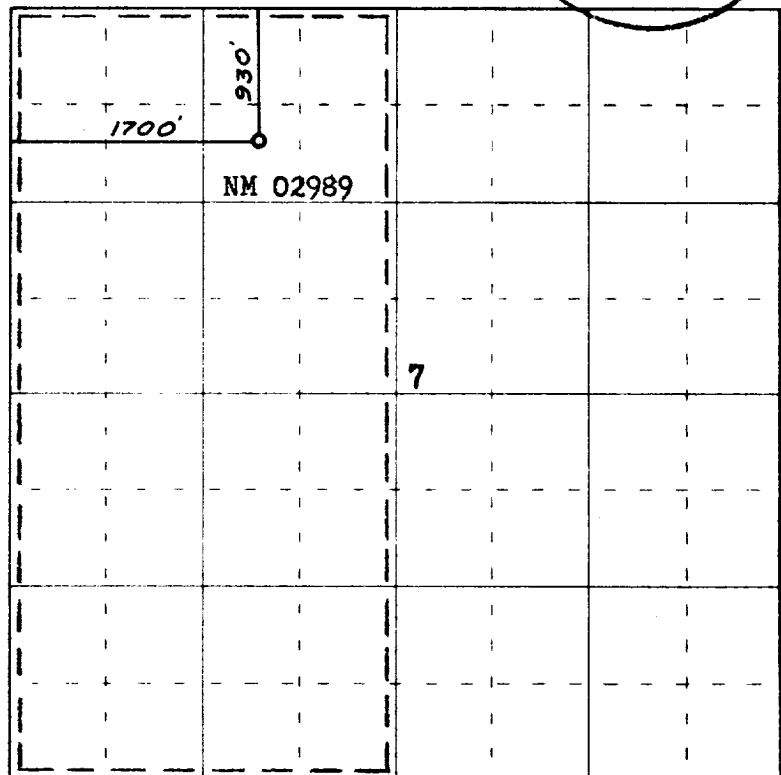

0 330 660 990 1320 1650 1980 2310 2640 2000 1500 1000 500 0

Scale 4 inches equal 1 mile

Ref: GLO plat dated 19 April 1881



(Seal)

Farmington, New Mexico

This is to certify that the above plat was prepared from field notes of actual surveys
 made by me or under my supervision and that the same are true and correct to the best
 of my knowledge and belief.

Date Surveyed 20 OCTOBER 1960

James P. Leese
 Registered Professional Engineer and/or Land Surveyor
 James P. Leese N. Max. Reg. No. 1463