

NEW MEXICO OIL CONSERVATION COMMISSION
Santa Fe, New Mexico

Form C-101
Revised (12/1/55)

NOTICE OF INTENTION TO DRILL

Notice must be given to the District Office of the Oil Conservation Commission and approval obtained before drilling or recompletion begins. If changes in the proposed plan are considered advisable, a copy of this notice showing such changes will be returned to the sender. Submit this notice in QUINTUPLICATE. One copy will be returned following approval. See additional instructions in Rules and Regulations of the Commission. If State Land submit 6 Copies Attach Form C- 128 in triplicate to first 3 copies of form C-101

Farmington, New Mexico
(Place)

August 2, 1961
(Date)

OIL CONSERVATION COMMISSION
SANTA FE, NEW MEXICO

Gentlemen:

You are hereby notified that it is our intention to commence the Drilling of a well to be known as

Grossman and Lockie

(Company, or Operator)

Oliver Stock

(Lease)

Well No. 1-A, in 0 The well is
(Unit)

located 870 feet from the South line and 1650 feet from the

East

line of Section 1, T. 29N, R. 16W, NMPM.

(GIVE LOCATION FROM SECTION LINE)

Wildcat

Pool,

San Juan

County

If State Land the Oil and Gas Lease is No.

If patented land the owner is Oliver Stock

Address Farmington, New Mexico

We propose to drill well with drilling equipment as follows: Cable tools to 210'.

Rotary rig to TD.

The status of plugging bond is Blanket Bond - R. L. Grossman and

Don M. Lockie

Drilling Contractor Grossman Drilling Company

We intend to complete this well in the Gallup

formation at an approximate depth of 3700 feet.

CASING PROGRAM

We propose to use the following strings of Casing and to cement them as indicated:

Size of Hole	Size of Casing	Weight per Foot	New or Second Hand	Depth	Sacks Cement
<u>12 1/4"</u>	<u>8 5/8</u>	<u>24</u>	<u>Used</u>	<u>200'</u>	<u>150</u>
<u>7 7/8"</u>	<u>4 1/2</u>	<u>9.5</u>	<u>New</u>	<u>3700'</u>	<u>200</u>

If changes in the above plans become advisable we will notify you immediately.

ADDITIONAL INFORMATION (If recompletion give full details of proposed plan of work.)

D. V. Tool at 1900'

Approved
Except as follows:

8-3, 19 61

Sincerely yours,

Grossman and Lockie

(Company or Operator)

By

Position Owner

Send Communications regarding well to

Name R. L. Grossman

Address 1400 Beckland Drive, Farmington, N.M.

OIL CONSERVATION COMMISSION

By

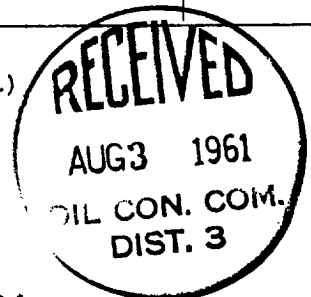

NUMBER OF COPIES RECEIVED	
DISTRIBUTION	
SANTA FE	
FILE	
U.S.G.S.	
LAND OFFICE	
TRANSPORTER	OIL GAS
PRODUCTION OFFICE	
OPERATOR	

NEW MEXICO OIL CONSERVATION COMMISSION
WELL LOCATION AND ACREAGE DEDICATION PLAT
 SEE INSTRUCTIONS FOR COMPLETING THIS FORM ON THE REVERSE SIDE

FORM C-128
 Revised 5/1/57

SECTION A

Operator Grossman and Lookie		Lease Oliver Steck		Well No. 1-A
Unit Letter 0	Section 1	Township 29N	Range 16W	County San Juan
Actual Footage Location of Well: 870 feet from the South line and 1650 feet from the East line				
Ground Level Elev. 5033.6	Producing Formation Gallup	Pool Wildcat	Dedicated Acreage: 40 Acres	

1. Is the Operator the only owner in the dedicated acreage outlined on the plat below? YES ☒ NO ____ . ("Owner" means the person who has the right to drill into and to produce from any pool and to appropriate the production either for himself or for himself and another. (65-3-29 (e) NMSA 1935 Comp.)
2. If the answer to question one is "no," have the interests of all the owners been consolidated by communitization agreement or otherwise? YES ____ NO ____ . If answer is "yes," Type of Consolidation _____
3. If the answer to question two is "no," list all the owners and their respective interests below:

Owner	Land Description

SECTION B

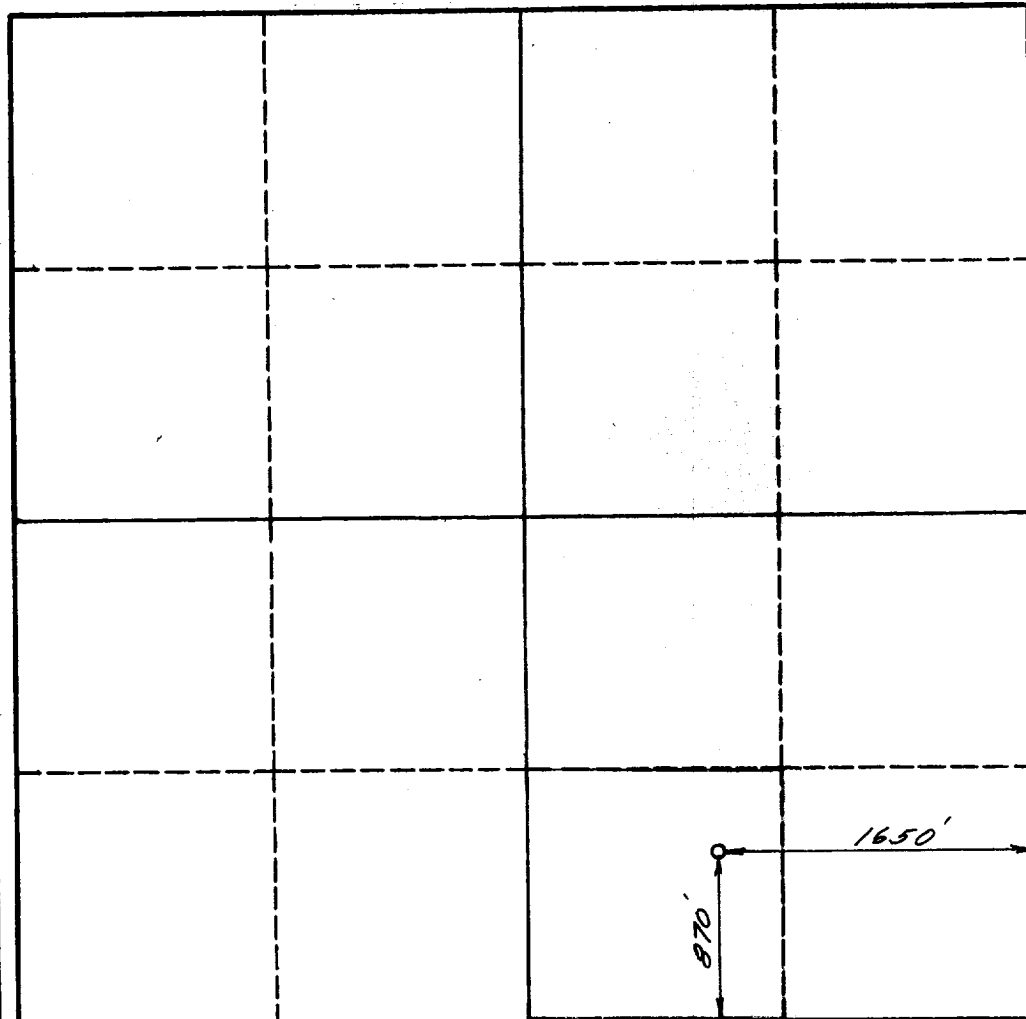

CERTIFICATION

I hereby certify that the information in SECTION A above is true and complete to the best of my knowledge and belief.

Name *[Signature]*
 Owner

Position
Grossman and Lookie

Company

Date **August 2, 1961**

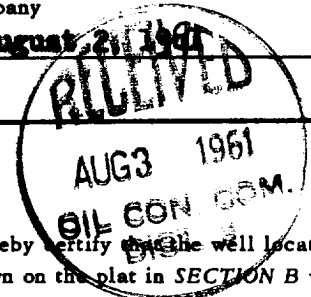

I hereby certify that the well location shown on the plat in SECTION B was plotted from field notes of actual surveys made by me or under my supervision, and that the same is true and correct to the best of my knowledge and belief.

Date Surveyed
August 1, 1961

Registered Professional Engineer
 and/or Land Surveyor

[Signature]

Certificate No. **1457**

