

NUMBER OF COPIES RECEIVED	
DISTRIBUTION	
SANTA FE	
FILE	
U.S.G.S.	
LAND OFFICE	
TRANSPORTER	OIL
	GAS
PRODUCTION OFFICE	
OPERATOR	

6-OCC, 2-EPNG, El Paso, Farm. 1-F  
**NEW MEXICO OIL CONSERVATION COMMISSION**  
**Santa Fe, New Mexico**

Form C-101  
 Revised (12/1/55)

## NOTICE OF INTENTION TO DRILL

Notice must be given to the District Office of the Oil Conservation Commission and approval obtained before drilling or recompletion begins. If changes in the proposed plan are considered advisable, a copy of this notice showing such changes will be returned to the sender. Submit this notice in QUINTUPLICATE. One copy will be returned following approval. See additional instructions in Rules and Regulations of the Commission. If State Land submit 6 Copies Attach Form C-128 in triplicate to first 3 copies of form C-101

**Farmington, New Mexico**

(Place)

**January 2, 1964**

(Date)

OIL CONSERVATION COMMISSION  
 SANTA FE, NEW MEXICO

Gentlemen:

You are hereby notified that it is our intention to commence the Drilling of a well to be known as

**Beta Development Co.**

(Company, or Operator)

**Martin "A"**

(Lease)

Well No. **1**, in **J** (Unit)

located **1775** feet from the **South** line and **1575** feet from the

**East** line of Section **3**, T. **29 N**, R. **11 W**, NMPM.

(GIVE LOCATION FROM SECTION LINE) **Basin Dakota** Pool, **San Juan** County

If State Land the Oil and Gas Lease is No.

If patented land the owner is **D. A. Martin**

Address **Route 3, Box 90, Bloomfield, New Mexico**

We propose to drill well with drilling equipment as follows:

**Rotary rig to total depth**

The status of plugging bond is **10,000 on file**

Drilling Contractor **Loffland Brothers Company**

We intend to complete this well in the **Dakota** formation at an approximate depth of **6650** feet.

### CASING PROGRAM

We propose to use the following strings of Casing and to cement them as indicated:

Size of Hole	Size of Casing	Weight per Foot	New or Second Hand	Depth	Sacks Cement
12 1/4"	8 5/8"	24#	New	300'	175 sx
7 7/8"	4 1/2"	10.5#	New	6650'	1st stage 150 sx 2nd stage 1000 cu. ft.

If changes in the above plans become advisable we will notify you immediately.

ADDITIONAL INFORMATION (If recompletion give full details of proposed plan of work.)

Approved.....  
 Except as follows:

Sincerely yours,

**Beta Development Co.**

Original signed (Company or Operator)

By **JOHN T. HAMPTON**

Position **Manager**

Send Communications regarding well to

Name **Beta Development Co.**

Address **234 Petr. Club Plaza, Farmington, N. M.**

OIL CONSERVATION COMMISSION

By **Edmund C. Hamlet**

## NEW MEXICO OIL CONSERVATION COMMISSION

## Well Location and Acreage Dedication Plat

January 2, 1964

Section A.

Date

Operator THE BETA DEVELOPMENT CORPORATION Lease Martin "A"  
 Well No. 1 Unit Letter J Section 3 Township 29 NORTH Range 11 WEST, NMPM  
 Located 1775 Feet From the SOUTH Line, 1575 Feet From the EAST Line  
 County SAN JUAN G. L. Elevation 5682.6 Dedicated Acreage Basin Dakota Acres  
 Name of Producing Formation \_\_\_\_\_ Pool \_\_\_\_\_

1. Is the Operator the only owner in the dedicated acreage outlined on the plat below?Yes ☒ No \_\_\_\_\_2. If the answer to question one is "no", have the interests of all the owners been consolidated by communitization agreement or otherwise? Yes \_\_\_\_\_ No X. If answer is "yes", Type of Consolidation.

Operator owns 100% working interest, royalty interest to be communitized. Royalty owners

3. If the answer to question two is "no", list all the owners and their respective interests below: listed below.

Owner	Land Description
D. A. Martin	N/2 SW/4, NW/4 SE/4, 120 acres
F. D. Mc Clure	SW/4 SE/4, 40 acres
Federal	S/2 SW/4, E/2 SE/4, 160 acres.

Section B.

Note: All distances must be from outer boundaries of section.

This is to certify that the information  
 in Section A above is true and complete  
 to the best of my knowledge and belief.

Beta Development Co.

Original signed (Operator)  
 JOHN T. HAMPTON Manager

(Representative)  
 234 Petr. Club Plaza,

(Address)  
 Farmington, New Mexico

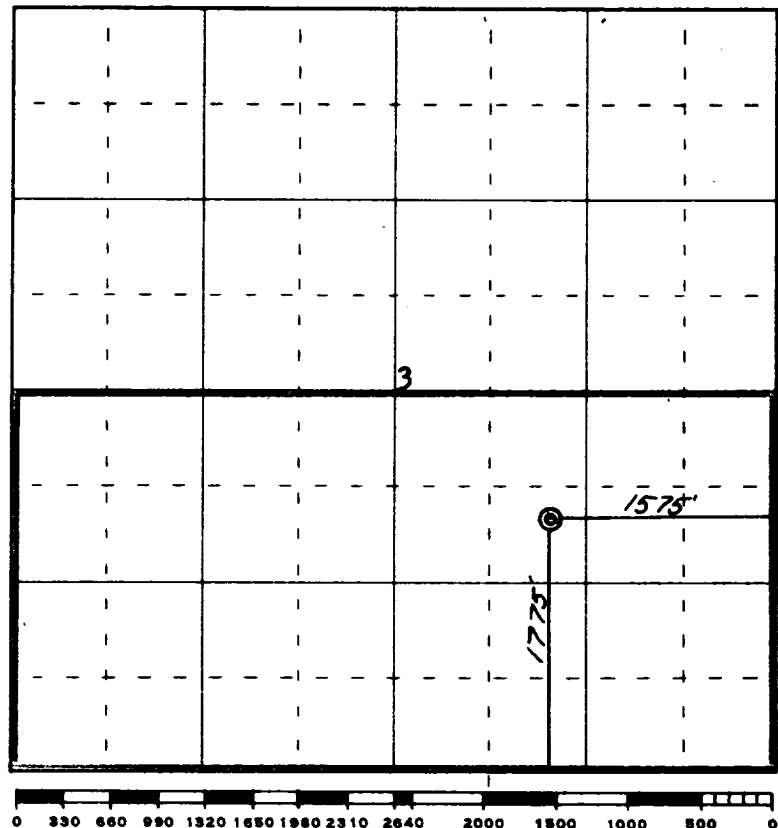

Scale 4 inches equal 1 mile



This is to certify that the above plat was prepared from field notes of actual surveys  
 made by me or under my supervision and that the same are true and correct to the best  
 of my knowledge and belief.

Date Surveyed 31 December 1963

James P. Leese  
 Registered Professional Engineer and/or Land Surveyor  
 James P. Leese N. Mex. Reg. No. 1162



Farmington, New Mexico