

NEW MEXICO OIL CONSERVATION COMMISSION
Santa Fe, New Mexico

Form C-101
 Revised (12/1/55)

NOTICE OF INTENTION TO DRILL

Notice must be given to the District Office of the Oil Conservation Commission and approval obtained before drilling or recompletion begins. If changes in the proposed plan are considered advisable, a copy of this notice showing such changes will be returned to the sender. Submit this notice in QUINTUPLICATE. One copy will be returned following approval. See additional instructions in Rules and Regulations of the Commission. If State Land submit 6 Copies Attach Form C-128 in triplicate to first 3 copies of form C-101

Astec, New Mex.

(Place)

3-23-61

(Date)

OIL CONSERVATION COMMISSION
 SANTA FE, NEW MEXICO

Gentlemen:

You are hereby notified that it is our intention to commence the Drilling of a well to be known as

Robert L. Grossman and John M. Pettus

(Company or Operator)

Hunt

(Lease)

Well No. 1

in K

(Unit)

The well is

located 1980 feet from the South line and 1980 feet from the

West

line of Section 3

T. 29N

R. 16W

NMPM.

(GIVE LOCATION FROM SECTION LINE)

Wildcat

Pool, San Jaun

County

If State Land the Oil and Gas Lease is No.

If patented land the owner is G. Hunt

Address Waterflow, N. M.

We propose to drill well with drilling equipment as follows:

Set surface pipe w/

cable tools, drill to T. D. w/rotary

The status of plugging bond is Blanket

Drilling Contractor Grossman Drilling Co.

We intend to complete this well in the Gallup

formation at an approximate depth of 3600 feet.

CASING PROGRAM

We propose to use the following strings of Casing and to cement them as indicated:

Size of Hole	Size of Casing	Weight per Foot	New or Second Hand	Depth	Sacks Cement
<u>12½</u>	<u>9 5/8</u>	<u>32</u>	<u>second hand</u>	<u>150'</u>	<u>100</u>
<u>7-7/8</u>	<u>5½</u>	<u>14</u>	<u>New</u>	<u>3600'</u>	<u>150</u>

If changes in the above plans become advisable we will notify you immediately.

ADDITIONAL INFORMATION (If recompletion give full details of proposed plan of work.)

* DV tool at base of Mesaverde to two stage cement



Approved..... 3-24, 1961
 Except as follows:

OIL CONSERVATION COMMISSION

By..... [Signature]

Sincerely yours,

Robert L. Grossman and John M. Pettus

(Company or Operator)

By [Signature]

Position [Signature]

Send Communications regarding well to

Name [Signature]

Address 320 Santa Fe Blvd, Santa Fe, N.M.

NEW MEXICO OIL CONSERVATION COMMISSION

Well Location and Acreage Dedication Plat

SECTION A.

Date **March 23, 1961**

Operator **Robert L. Grossman and John H. Pettus** Lease **Hunt**
 Well No. **1** Unit Letter **K** Section **3** Township **29 North** Range **16 West** NMPM
 Located **1980** Feet From **South** Line, **1980** Feet From **West** Line
 County **San Juan** G. L. Elevation _____ Dedicated Acreage _____ Acres
 Name of Producing Formation **Gallup** Pool **Wildcat**

1. Is the Operator the only owner* in the dedicated acreage outlined on the plat below? Yes _____ No _____
2. If the answer to question One is "No," have the interests of all the owners been consolidated by communitization agreement or otherwise? Yes _____ No _____ If answer is "Yes," Type of Consolidation _____
3. If the answer to question Two is "No," list all the owners and their respective interests below:

OWNER	LAND DESCRIPTION

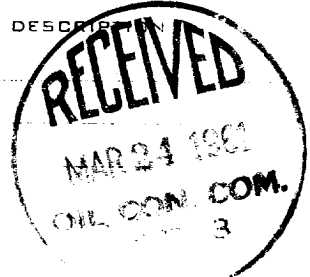

SECTION B.

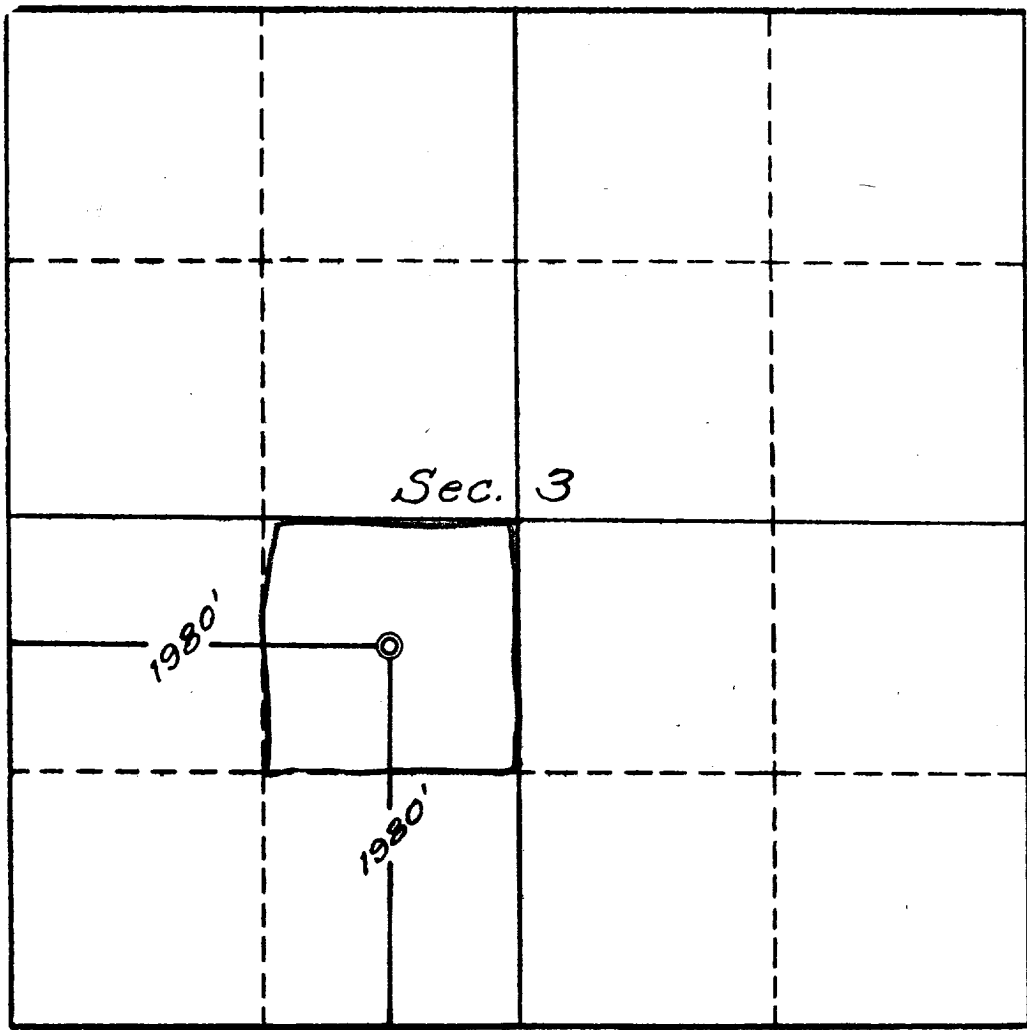

This is to certify that the information in Section A above is true and complete to the best of my knowledge and belief.

Robert L. Grossman and John H. Pettus
 (OPERATORS)
Robert L. Grossman
 (REPRESENTATIVE)

320 So. Mesa Verde Artes, N. M.
(ADDRESS)

This is to certify that the well location shown on the plat in Section B was plotted from field notes of actual surveys made by me or under my supervision and that the same is true and correct to the best of my knowledge and belief.

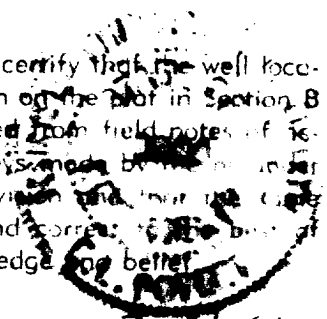

Date Surveyed **3-21-61**

Four States Engineering Co.
FARMINGTON, NEW MEXICO

C. L. Poter
 REGISTERED ENGINEER OR
 LAND SURVEYOR

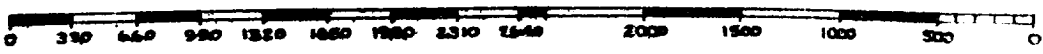

Certificate No. **3084**