

**NEW MEXICO OIL CONSERVATION COMMISSION**  
**Santa Fe, New Mexico**

Form G-101  
 Revised (12/1/55)

**NOTICE OF INTENTION TO DRILL**

Notice must be given to the District Office of the Oil Conservation Commission and approval obtained before drilling or recompletion begins. If changes in the proposed plan are considered advisable, a copy of this notice showing such changes will be returned to the sender. Submit this notice in QUINTUPLICATE. One copy will be returned following approval. See additional instructions in Rules and Regulations of the Commission. If State Land submit 6 Copies Attach Form G-128 in triplicate to first 3 copies of form G-101

Farmington, New Mexico

August 15, 1957

(Place)

(Date)

OIL CONSERVATION COMMISSION  
 SANTA FE, NEW MEXICO

Gentlemen:

You are hereby notified that it is our intention to commence the Drilling of a well to be known as  
**Pan American Petroleum Corporation**

(Company or Operator)

State Gas Unit "U"

(Lease)

Well No. 1, in H The well is

(Unit)

located 1695 feet from the North line and 1075 feet from the East line of Section 2, T. 29N, R. 10W, NMPM.

(GIVE LOCATION FROM SECTION LINE) Artes-Pictured Cliffs Pool, San Juan County

If State Land the Oil and Gas Lease is No. 79881 E-1686 ORIGINAL

If patented land the owner is.....

Address.....

We propose to drill well with drilling equipment as follows: Rotary tools to total depth.

The status of plugging bond is.....

Drilling Contractor Sage Drilling Company  
Box 788  
San Angelo, Texas

We intend to complete this well in the Pictured Cliffs formation at an approximate depth of 2000 feet.

**CASING PROGRAM**

We propose to use the following strings of Casing and to cement them as indicated:

Size of Hole	Size of Casing	Weight per Foot	New or Second Hand	Depth	Sacks Cement
11"	8-5/8"	24#	New	250'	125
7-7/8"	5-1/2"	16#	New	2000'	100

If changes in the above plans become advisable we will notify you immediately.

ADDITIONAL INFORMATION (If recompletion give full details of proposed plan of work.)

We propose to drill the above well to approximately 2000' and complete the Pictured Cliffs Zone. Stimulation will be indicated upon reaching this depth.

Approved..... 8-16, 1957

Except as follows:

Verbal app. given 8/16/57.  
K.D.

OIL CONSERVATION COMMISSION

By Emery C. [Signature]

Sincerely yours,

Pan American Petroleum Corporation  
 (Company or Operator)

By [Signature]

Position Field Clerk, Superintendent  
 Send Communications regarding well to

Name Pan American Petroleum Corporation

Address Box 487, Farmington, New Mexico

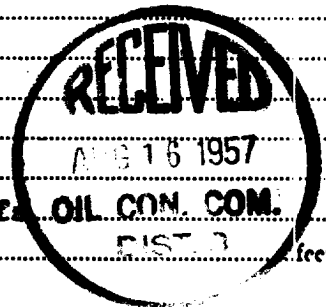

Well Location and Acreage Dedication Plat

Section A.

Date AUGUST 8, 1957

Operator PAN AMERICAN PETROLEUM CORPORATION Lease STATE GAS UNIT "U"  
 Well No. 1 Unit Letter H Section 2 Township 29 NORTH Range 10 WEST NMPM  
 Located 1695 Feet From the NORTH Line, 1075 Feet From the EAST Line  
 County SAN JUAN G. L. Elevation \* Dedicated Acreage 163.86 Acres  
 Name of Producing Formation Pictured Cliffs Pool Astos-Pictured Cliffs

1. Is the Operator the only owner in the dedicated acreage outlined on the plat below?  
 Yes \_\_\_\_\_ No
2. If the answer to question one is "no", have the interests of all the owners been consolidated by communitization agreement or otherwise? Yes  No \_\_\_\_\_ If answer is "yes", Type of Consolidation: \_\_\_\_\_
3. If the answer to question two is "no", list all the owners and their respective interests below:

Owner	Land Description
-------	------------------

**\* To be reported later**

Section B.

Note: All distances must be from outer boundaries of section.

This is to certify that the information in Section A above is true and complete to the best of my knowledge and belief.

PAN AMERICAN PETROLEUM CORPORATION

*(Signature)*  
 (Representative)

BOX 487, FARMINGTON, NEW MEXICO  
 (Address)

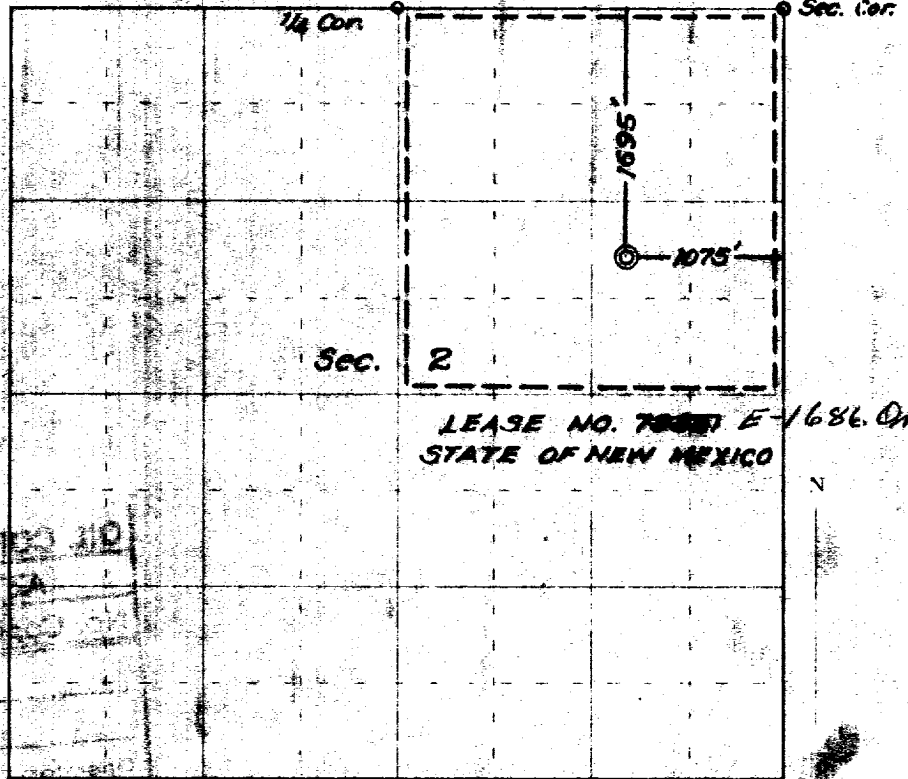

Scale 4 inches equal 1 mile

This is to certify that the above plat was prepared from field notes of actual surveys made by me or under my supervision and that the same are true and correct to the best of my knowledge and belief.

Date Surveyed 16 JUNE 1957

*(Signature)*  
 Registered Professional Engineer and/or Land Surveyor  
 James P. Lease N. Mex. Reg. No. 123

(Seal)  
 Farmington, New Mexico

**OIL CONSERVATION COMMISSION**  
**AZTEC DISTRICT OFFICE**

No. Copies Received 6

**DISTRIBUTION**

	NO. FURNISHED	
Operator	1	
Santa Fe	1	
Proration Office		
State Land Office	1	
U. S. G. S.	2	
Transporter		
File	1	<input checked="" type="checkbox"/>