

5-OCC

2-EPNG, El Paso, Farm.

1-F

NEW MEXICO OIL CONSERVATION COMMISSION

Santa Fe, New Mexico

Form C-101
Revised (12/1/55)

NOTICE OF INTENTION TO DRILL

Notice must be given to the District Office of the Oil Conservation Commission and approval obtained before drilling or recompletion begins. If changes in the proposed plan are considered advisable, a copy of this notice showing such changes will be returned to the sender. Submit this notice in QUINTUPLICATE. One copy will be returned following approval. See additional instructions in Rules and Regulations of the Commission. If State Land submit 6 Copies Attach Form C-128 in triplicate to first 3 copies of form C-101

Farmington, New Mexico

(Place)

March 17, 1964

(Date)

OIL CONSERVATION COMMISSION
SANTA FE, NEW MEXICO

Gentlemen:

You are hereby notified that it is our intention to commence the Drilling of a well to be known as
Beta Development Co.

(Company, or Operator)

Fifield Federal

(Lease)

Well No. 1, in G. The well is

(Unit)

located 1620 feet from the North line and 1475 feet from the

East

line of Section 5, T. 29 N, R. 11 W, NMPM.

(GIVE LOCATION FROM SECTION LINE)

Basin Dakota Pool, San Juan County

If State Land the Oil and Gas Lease is No.

If patented land the owner is E. F. Fifield

Address 213 Columbia Drive SE, Albuquerque, New Mexico

We propose to drill well with drilling equipment as follows:

Rotary to T. D.

The status of plugging bond is Bond on file

Drilling Contractor Loffland Brothers Co.

P. O. Box 688, Farmington, New Mexico

We intend to complete this well in the Dakota

formation at an approximate depth of 6650' feet.

CASING PROGRAM

We propose to use the following strings of Casing and to cement them as indicated:

| Size of Hole | Size of Casing | Weight per Foot | New or Second Hand | Depth | Sacks Cement |
|--------------|----------------|-----------------|--------------------|-------|------------------|
| 12 1/4" | 8 5/8" | 24# | New | 300' | 175 sx |
| 7 7/8" | 4 1/2" | 10.5# | New | 6650' | 1st stage 250 sx |
| | | | | | 2nd stage 1000 |
| | | | | | cu. ft. |

If changes in the above plans become advisable we will notify you immediately.

ADDITIONAL INFORMATION (If recompletion give full details of proposed plan of work.)

Propose to test the Dakota formation at an approximate total depth of 6650'. Will perforate and sand water frac the Dakota. Second stage will be cemented with a DV tool to protect the Pictured Cliffs, Kirtland and Farmington formations.

Approved.....
Except as follows:

Sincerely yours,

Original signed by

By JOHN T. HAMPTON

Position Manager

Send Communications regarding well to

Name Beta Development Co.

Address 234 Petr. Club Plaza, Farmington, N. M.

OIL CONSERVATION COMMISSION

By *Emory C. Ernest*

3-17, 1964
Subject to approval of New-Standard
Unit 7

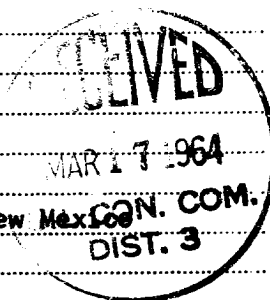

NEW MEXICO OIL CONSERVATION COMMISSION

Well Location and Acreage Dedication Plat

March 17, 1964

Section A.

Date

Fifield Federal

Operator BETA DEVELOPMENT COMPANY

Lease

Well No. _____ Unit Letter G Section 5 Township 29 NORTH Range 11 WEST, NMPMLocated 1620 Feet From the NORTH Line, 1475 Feet From the EAST LineCounty SAN JUAN G. L. Elevation 5786.0 Dedicated Acreage 293.68 AcresName of Producing Formation Dakota Pool Basin Dakota

1. Is the Operator the only owner in the dedicated acreage outlined on the plat below?

Yes X No _____2. If the answer to question one is "no", have the interests of all the owners been consolidated by communitization agreement or otherwise? Yes _____ No _____. If answer is "yes", Type of Consolidation. Operator owns 100% working interest. Royalty will be communitized.

3. If the answer to question two is "no", list all the owners and their respective interests below:

Owner

Land Description

Section B.

Note: All distances must be from outer boundaries of section.

This is to certify that the information in Section A above is true and complete to the best of my knowledge and belief.

Beta Development Co.

Original signed By: JOHN T. HAMPTON Manager(Representative)
234 Petr. Club Plaza(Address)
Farmington, New Mexico

Ref: GLO plat dated September 3, 1878

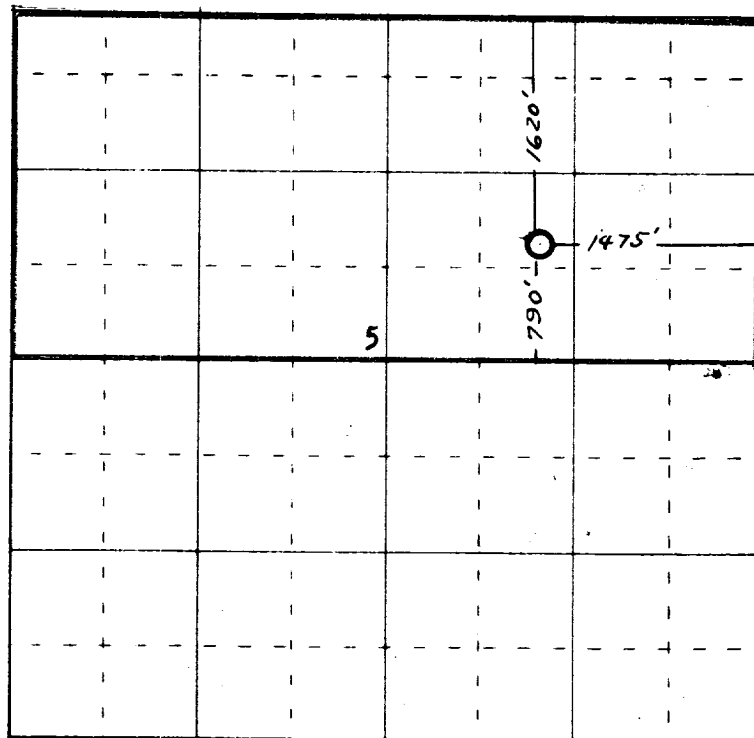

0 330 660 990 1320 1650 1980 2310 2640 2000 1500 1000 500 0

Scale 4 inches equal 1 mile

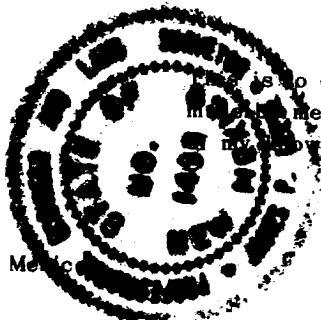

(Seal)

Farmington, New Mexico

I hereby certify that the above plat was prepared from field notes of actual surveys made by me or under my supervision and that the same are true and correct to the best of my knowledge and belief.

Date Surveyed 10 March 1964

James P. Leese
Registered Professional Engineer and/or Land Surveyor
James P. Leese
New Mexico Reg. No. 1463