

(SUBMIT IN TRIPLICATE)

UNITED STATES
DEPARTMENT OF THE INTERIOR
GEOLOGICAL SURVEY

Indian Agency _____
Allottee _____
Lease No. **11-42-403-3016**

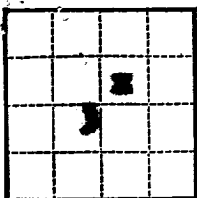

SUNDRY NOTICES AND REPORTS ON WELLS

| | | | |
|---|-------------------------------------|--|--|
| NOTICE OF INTENTION TO DRILL | <input checked="" type="checkbox"/> | SUBSEQUENT REPORT OF WATER SHUT-OFF | |
| NOTICE OF INTENTION TO CHANGE PLANS | | SUBSEQUENT REPORT OF SHOOTING OR ACIDIZING | |
| NOTICE OF INTENTION TO TEST WATER SHUT-OFF | | SUBSEQUENT REPORT OF ALTERING CASING | |
| NOTICE OF INTENTION TO REDRILL OR REPAIR WELL | | SUBSEQUENT REPORT OF REDRILLING OR REPAIR | |
| NOTICE OF INTENTION TO SHOOT OR ACIDIZE | | SUBSEQUENT REPORT OF ABANDONMENT | |
| NOTICE OF INTENTION TO PULL OR ALTER CASING | | SUPPLEMENTARY WELL HISTORY | |
| NOTICE OF INTENTION TO ABANDON WELL | | | |

(INDICATE ABOVE BY CHECK MARK NATURE OF REPORT, NOTICE, OR OTHER DATA)

U. S. GEOLOGICAL SURVEY
FARMINGTON, NEW MEXICO

October 9, 1961, 19

Cave Hole
Well No. **31** is located **2000** ft. from **N** line and **1900** ft. from **E** line of sec. **3**
SW NE Section 3 (1/4 Sec. and Sec. No.)
Wildcat (Field)
San Juan (County or Subdivision)
New Mexico (State or Territory)

The elevation of the derrick floor above sea level is **0** ft. **512' Ungraded Ground.**

DETAILS OF WORK

(State names of and expected depths to objective sands; show sizes, weights, and lengths of proposed casings; indicate mudding jobs, cementing points, and all other important proposed work)

Rotary drilling equipment will be used to drill to approximately 100' to the Sumner Formation. If production is found, casing will be set and cemented with required amount of cement. Nitrogen and air will be used in drilling. There will be testing and electric logs will be run prior to setting casing or abandonment. Stimulation treatments may be employed in completion.



I understand that this plan of work must receive approval in writing by the Geological Survey before operations may be commenced.

Company **Humble Oil & Refining Company**

Address **P. O. Box 1052**

Durango, Colorado

By **COPY (ORIGINAL SIGNED) B. M. BRADLEY**
B. M. Bradley
Title **Dist. Eng.**

| | |
|---------------------------|------------|
| NUMBER OF COPIES RECEIVED | |
| DISTRIBUTION | |
| SANTA FE | |
| FILE | |
| U.S.G.S. | |
| LAND OFFICE | |
| TRANSPORTER | OIL GAS |
| PROBATION OFFICE | |
| OPERATOR | |

NEW MEXICO OIL CONSERVATION COMMISSION
WELL LOCATION AND ACREAGE DEDICATION PLAT
 SEE INSTRUCTIONS FOR COMPLETING THIS FORM ON THE REVERSE SIDE

FORM C-128
 Revised 5/1/57

SECTION A

| | | | | | |
|--|---------------------------------|------------------------|---------------------------|---------------------------|--------------------------------------|
| Operator Humble Oil & Refining Company | | | Lease Cora Hole | | Well No. 31 |
| Unit Letter C | Section 3 | Township 29N | Range 19W | County San Juan | |
| Actual Footage Location of Well: 2051 feet from the North line and 1980 feet from the East line | | | | | |
| Ground Level Elev. 5142 | Producing Formation - | | Pool Wildcat | | Dedicated Acreage: - Acres |

1. Is the Operator the only owner in the dedicated acreage outlined on the plat below? YES ☒ NO ☐ . ("Owner" means the person who has the right to drill into and to produce from any pool and to appropriate the production either for himself or for himself and another. (65-3-29 (e) NMSA 1935 Comp.)
2. If the answer to question one is "no," have the interests of all the owners been consolidated by communitization agreement or otherwise? YES ☐ NO ☐ . If answer is "yes," Type of Consolidation _____
3. If the answer to question two is "no," list all the owners and their respective interests below:

| Owner | Land Description |
|-------|------------------|
| | |

SECTION B

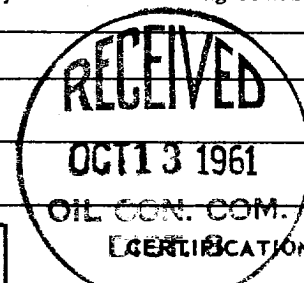
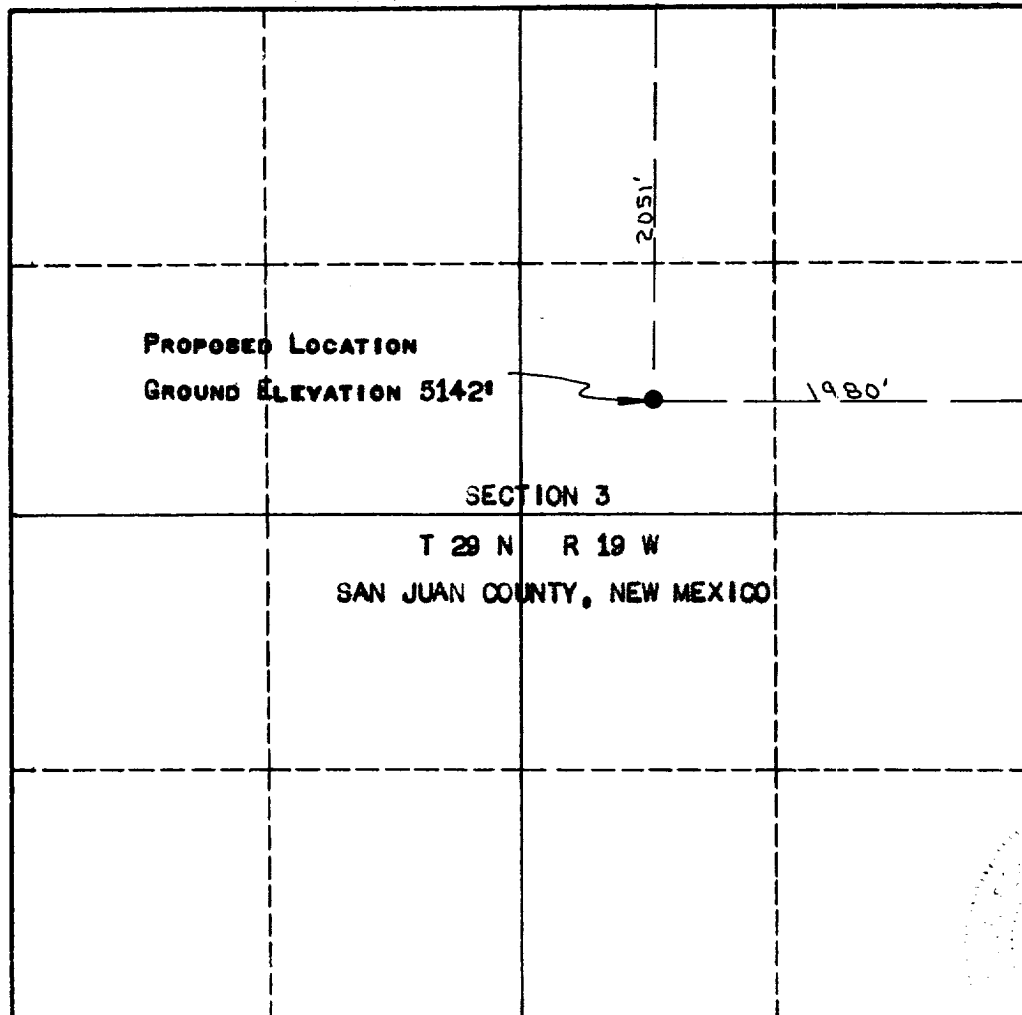

I hereby certify that the information in SECTION A above is true and complete to the best of my knowledge and belief.

B. M. Bradley

| |
|---|
| Name COPY (ORIGINAL SIGNED) B. M. BRADLEY |
| Position Dist. Supt. |
| Company Humble Oil & Refining Co. |
| Date 10-9-61 |

I hereby certify that the well location shown on the plat in SECTION B was plotted from field notes of actual surveys made by me or under my supervision, and that the same is true and correct to the best of my knowledge and belief.

| |
|---|
| Date Surveyed OCTOBER 7, 1961 |
| Registered Professional Engineer and/or Land Surveyor |

John M. Clark
 Certificate No.
NEW MEXICO #3189

0 330 660 990 1320 1650 1980 2310 2640 2000 1500 1000 500 0

INSTRUCTIONS FOR COMPLETION OF FORM C-128

1. Operator shall furnish and certify to the information called for in Section A.
2. Operator shall outline the dedicated acreage for *both* oil and gas wells on the plat in Section B.
3. A registered professional engineer or land surveyor registered in the State of New Mexico or approved by the Commission shall show on the plat the location of the well and certify this information in the space provided.
4. All distances shown on the plat must be from the outer boundaries of the Section.
5. If additional space is needed for listing owners and their respective interests as required in question 3 of Section A, please use space below.