

(SUBMIT IN TRIPLICATE)

UNITED STATES
DEPARTMENT OF THE INTERIOR
GEOLOGICAL SURVEYLand Office Santa Fe
Lease No. 57-07043
Unit 2

SUNDRY NOTICES AND REPORTS ON WELLS

RECEIVED

NOV 16 1959

NOTICE OF INTENTION TO DRILL	<input checked="" type="checkbox"/>	SUBSEQUENT REPORT OF WATER SHUT-OFF	
NOTICE OF INTENTION TO CHANGE PLANS		SUBSEQUENT REPORT OF SHOOTING OR ACIDIZING	
NOTICE OF INTENTION TO TEST WATER SHUT-OFF		SUBSEQUENT REPORT OF ALTERING CASING	
NOTICE OF INTENTION TO RE-DRILL OR REPAIR WELL		SUBSEQUENT REPORT OF RE-DRILLING OR REPAIR	
NOTICE OF INTENTION TO SHOOT OR ACIDIZE		SUBSEQUENT REPORT OF ABANDONMENT	
NOTICE OF INTENTION TO PULL OR ALTER CASING		SUPPLEMENTARY WELL HISTORY	
NOTICE OF INTENTION TO ABANDON WELL			

(INDICATE ABOVE BY CHECK MARK NATURE OF REPORT, NOTICE, OR OTHER DATA)

Well No. 1-B is located 99 ft. from N line and 150 ft. from E line of sec. 3
(1/4 Sec. and Sec. No.) (Twp.) (Range) (Meridian)
Unassigned San Juan New Mexico
(Field) (County or Subdivision) (State or Territory)

The elevation of the ground level above sea level is 5010 ft.

DETAILS OF WORK

(State names of and expected depths to objective sands; show sizes, weights, and lengths of proposed casings; indicate mudlogging jobs, cementing points, and all other important proposed work)

Approximately 300' of 9 5/8" 32 lb. surface casing will be set with sufficient cement to circulate back to the surface. 7/8" hole will be drilled underneath surface to an approximate total depth of 6400' to test the Dakota formation. 5 1/2" 14 lb. J-55 casing will be set to total depth and cemented with approximately 300' max. All cementing will be tested according to regulations.

I understand that this plan of work must receive approval in writing by the Geological Survey before operations may be commenced.

Company SUNSHINE ROYALTY COMPANYAddress Box 5069
Roswell, New MexicoBy [Signature]
Title Vice President

NEW MEXICO OIL CONSERVATION COMMISSION

Well Location and Acreage Dedication Plat

Section A.

Date November 11, 1959

Operator Sunshine Royalty Company Lease Southern Union
Well No. 1 Unit Letter B Section 3 Township 29 North Range 13 West NMPM
Located 990 Feet From North Line, 1500 Feet From East Line
County San Juan G. L. Elevation 5610 Dedicated Acreage 320 N. 321.08 Acres
Name of Producing Formation Dakota Pool Undesignated

1. Is the Operator the only owner* in the dedicated acreage outlined on the plat below?
Yes _____ No X
2. If the answer to question one is "no," have the interests of all the owners been consolidated by communitization agreement or otherwise? Yes X No _____. If answer is "yes,"
Type of Consolidation Communitization Agreement
3. If the answer to question two is "no," list all the owners and their respective interests below:

Owner

Land Description

Sunshine Royalty Company

NW 1/4, W 1/2 Sec. 3, T. 29N., R. 13W.,

Southern Union Gas Company

W 1/2 Sec. 3, T. 29N., R. 13W.

Section. B

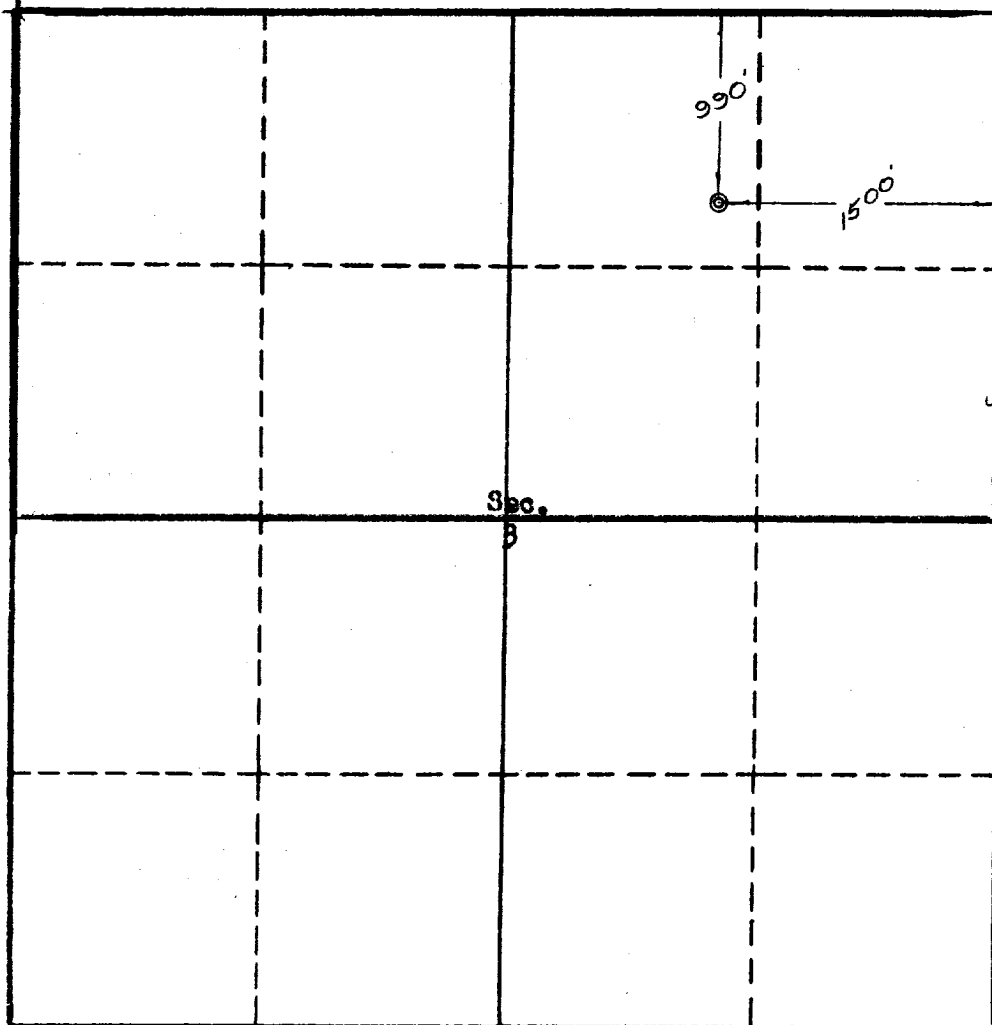

RECEIVED
NOV 18 1959
This is to certify that the information in Section A above is true and complete to the best of my knowledge and belief.

Sunshine Royalty Company

(Operator)

(Representative)

Box 5669, Roswell, N. M.

Address

This is to certify that the well location shown on the plat in Section B was obtained from field notes and actual surveys made by me or under my supervision and that the same is true to the best of my knowledge and belief.

Date Surveyed Oct. 7, 1959

Ernest V. Echohawk
Registered Land Surveyor.

Certificate No. 1545

