

(SUBMIT IN TRIPLICATE)

UNITED STATES
DEPARTMENT OF THE INTERIOR
GEOLOGICAL SURVEY

Land Office San Jose
Lease No. 07070
Unit NE 1/4 Sec. 22

SUNDRY NOTICES AND REPORTS ON WELLS

NOTICE OF INTENTION TO DRILL.....	SUBSEQUENT REPORT OF WATER SHUT-OFF.....
NOTICE OF INTENTION TO CHANGE PLANS.....	SUBSEQUENT REPORT OF SHOOTING OR ACIDIZING.....
NOTICE OF INTENTION TO TEST WATER SHUT-OFF.....	SUBSEQUENT REPORT OF ALTERING CASING.....
NOTICE OF INTENTION TO RE-DRILL OR REPAIR WELL.....	SUBSEQUENT REPORT OF RE-DRILLING OR REPAIR.....
NOTICE OF INTENTION TO SHOOT OR ACIDIZE.....	SUBSEQUENT REPORT OF ABANDONMENT.....
NOTICE OF INTENTION TO PULL OR ALTER CASING.....	SUPPLEMENTARY WELL HISTORY.....
NOTICE OF INTENTION TO ABANDON WELL.....	

(INDICATE ABOVE BY CHECK MARK NATURE OF REPORT, NOTICE, OR OTHER DATA)

Fluvio October 21, 1952
Well No. 245 is located 1500 ft. from N line and 2500 ft. from E line of sec. 22
NE 1/4 Sec. 22 30 E 8 W 119N
(1/4 Sec. and Sec. No.) (Twp.) (Range) (Meridian)
Illinois San Juan New Mexico
(Field) (County or Subdivision) (State or Territory)

Will be furnished later

The elevation of the derrick floor above sea level is _____ ft.

DETAILS OF WORK

(State names of and expected depths to objective sands; show sizes, weights, and lengths of proposed casings; indicate mudding jobs, cementing points, and all other important proposed work)

We propose to drill with rotary tools using sand to top of Cliffhouse sand, set pipe and drill with rotary using gas to base of Point Lookout sand, shoot with 200 and clean out for gas completion in entire San Juan section.

Proposed casing program:

- 200' - 2 1/2" 12.75' 8-10 SS Casing - Cemented to surface
- 1500' - 7" 20' 4-55 SS casing - Cemented with 200 gr.
- 1700' - 1 1/2" 2.75' 4-55 SS Tubing

I understand that this plan of work must receive approval in writing by the Geological Survey before operations may be commenced.

Company Shell Oil Corporation
Address Box 2115
Farmington, New Mexico
By J. A. Howell
Title Supt.

...the ... of ...
...the ... of ...
...the ... of ...

...the ... of ...
...the ... of ...
...the ... of ...

...the ... of ...
...the ... of ...
...the ... of ...

...the ... of ...
...the ... of ...
...the ... of ...

...the ... of ...
...the ... of ...
...the ... of ...

...the ... of ...
...the ... of ...
...the ... of ...

Company Delhi Oil Corporation

SF-078578

Lease Florance Well No. 2-45

Sec. 22, T. 30 N., R. 8 W., N.M.P.M.

Location 1550' from the North line and 1500' from the East line.

San Juan County

New Mexico

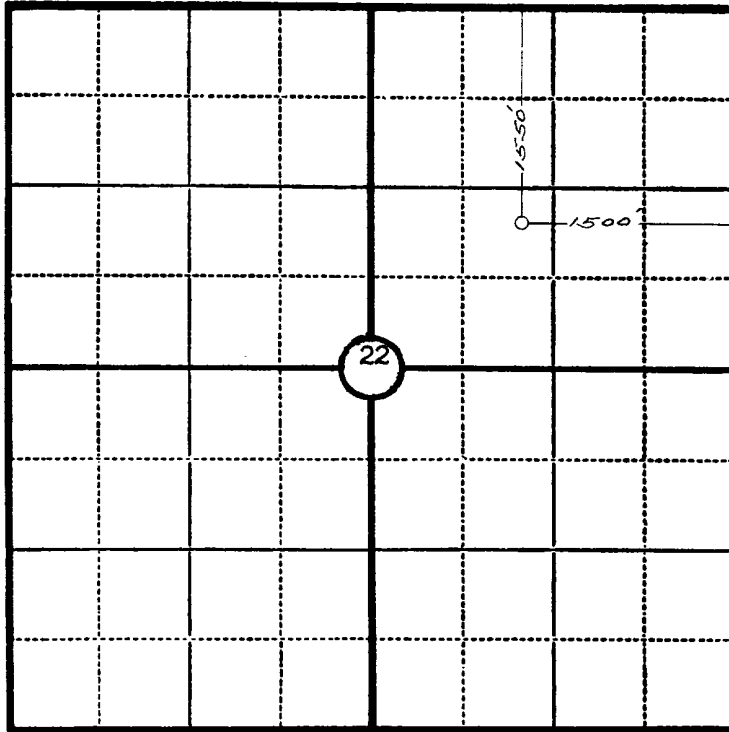

Scale—4 inches equal 1 mile.

This is to certify that the above plat was prepared from field notes of actual surveys made by me or under my supervision and that the same are true and correct to the best of my knowledge and belief

Ernest V. Echohawk

Seal:

Registered Professional
Engineer and Land Surveyor.

Ernest V. Echohawk
N. Mex. Reg. No. 1545

Surveyed October 8, 1953



U. S. LAND OFFICE **Santa Fe**

SERIAL NUMBER **078578**

LEASE OR PERMIT TO PROSPECT **Sec. 22**

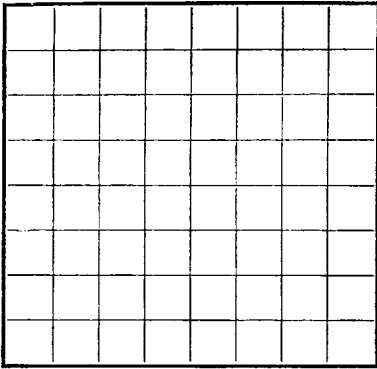

LOCATE WELL CORRECTLY

UNITED STATES
DEPARTMENT OF THE INTERIOR
GEOLOGICAL SURVEY

RECEIVED
FEB 13 1954
U. S. GEOLOGICAL SURVEY
FARMINGTON, N. M.

LOG OF OIL OR GAS WELL

Company **Delhi Oil Corporation** Address **Box #1175, Farmington, New Mexico**
Lessor or Tract **Florance** Field **Blanco** State **New Mexico**
Well No. **2-45** Sec. **22** T. **30N** R. **8W** Meridian **NMPM** County **San Juan**
Location **1550** ft. [S.] of **N** Line and **1500** ft. [W.] of **E** Line of **Sec. 22** Elevation **6020** DF
(Derrick floor relative to sea level)

The information given herewith is a complete and correct record of the well and all work done thereon so far as can be determined from all available records.

Signed *J. P. Martin*
Date **Feb. 17, 1954** Title **Supt.**

The summary on this page is for the condition of the well at above date.

Commenced drilling **11-25-53**, 19... Finished drilling **2-7-54**, 19...

OIL OR GAS SANDS OR ZONES
(Denote gas by G)

No. 1, from **2835** to **2925** No. 4, from _____ to _____
No. 2, from **4580** to **5140** No. 5, from _____ to _____
No. 3, from _____ to _____ No. 6, from _____ to _____

IMPORTANT WATER SANDS

No. 1, from _____ to _____ No. 3, from _____ to _____
No. 2, from _____ to _____ No. 4, from _____ to _____

CASING RECORD

Size casing	Weight per foot	Threads per inch	Make	Amount	Kind of shoe	Cut and pulled from	Perforated		Purpose
							From-	To-	
10-3/4	32.75	8RT	Republic	168	none				Surface
7"	20	8RT	W&W	4380	4-1/2" inside				Production
1.3"	2.75	10RT	API	3881					Tubing

MUDDING AND CEMENTING RECORD

Size casing	Where set	Number sacks of cement	Method used	Mud gravity	Amount of mud used
10-3/4	168	200	Halliburton		
7"	4380	200	Halliburton		

PLUGS AND ADAPTERS

Heaving plug—Material _____ Length _____ Depth set _____
Adapters—Material _____ Size _____

SHOOTING RECORD

Size	Shell used	Explosive used	Quantity	Date	Depth shot	Depth cleaned out
4 1/2"	Tin	ONE	1160	2-4-54	4580 to 5226	5226

TOOLS USED

Rotary tools were used from **0** w/ inside to **4380** feet, and from **4380** w/ 7" to **5226** feet
Cable tools were used from _____ feet to _____ feet, and from _____ feet to _____ feet

DATES

Comp 2-6-54
Open flow test **2-15-54**, 19... Put to producing **SI**, 19...

The production for the first 24 hours was _____ barrels of fluid of which _____% was oil; _____% emulsion; _____% water; and _____% sediment. Gravity, °Bé. _____

If gas well, cu. ft. per 24 hours **3151 MCF** Gallons gasoline per 1,000 cu. ft. of gas _____

Rock pressure, lbs. per sq. in. **91 209 lbs. CP 1050 TP 1050**

EMPLOYEES

_____, Driller **E. P. Martin**, Driller
_____, Driller **L. L. Basill**, Driller

FORMATION RECORD

FROM-	TO-	TOTAL FEET	FORMATION
0	1850	1850	Socons - beds of coarse sandstones and vari-colored shales
1850	2460	610	Kirtland - gray to green shales with minor sandstone beds
2460	2890	430	Fruitland - mostly carbonaceous shales & coals
2890	2945	55	Pictured Cliffs - Sand & sandy shale
2945	4580	1635	Lewis - mostly shales
4580	5140	560	Mesa Verde - sand & sandy shale
5140	5226 TD	86	Mancos - shale

U.S. GEOLOGICAL SURVEY
 DEPARTMENT OF THE INTERIOR
 BUREAU OF LAND MANAGEMENT

UNITED STATES
 DEPARTMENT OF THE INTERIOR
 GEOLOGICAL SURVEY
LOG OF OIL OR GAS WELL

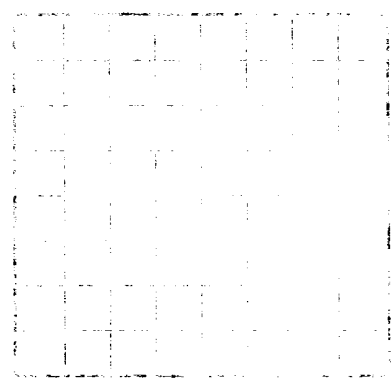

Location of well, including name, section, township, and range, and name of land owner, if known, should be given. The name of the well should be given in full, including the name of the operator, if known. The name of the well should be given in full, including the name of the operator, if known. The name of the well should be given in full, including the name of the operator, if known.

OIL OR GAS BANDS OR ZONES
 (To be used by the operator)
 No. 1 from _____ to _____ feet
 No. 2 from _____ to _____ feet
 No. 3 from _____ to _____ feet

WATER BANDS
 No. 1 from _____ to _____ feet
 No. 2 from _____ to _____ feet

WATER - RECORD

It is of the greatest importance to have a complete history of the well. Please state in detail the dates of redrilling, together with the reasons for the work and its results. If there were any changes made in the casing, state fully, and if any casing was "sidetracked" or left in the well, give its size and location. If the well has been dynamited, give date, position, and number of shots. If plugs or bridges were put in to test for water, state kind of material used, position, and results of pumping or bailing.

HISTORY OF OIL OR GAS WELL

DATE	DESCRIPTION OF WORK	RESULTS	REMARKS
	WINDING AND LIFTING RECORD		
	LOGS AND TESTS		
	SHOOTING RECORD		
	EMPLOYEES		
	FORMATION RECORD		
	FORMATION		
	TOTAL FEET		
	TO		
	FROM		

3 / 11/11

New Mexico Oil Conservation Commission

Official Well Test Sheet

Date 2-15-54

WELL	LOCATION	PRODUCING FORMATION	TOTAL DEPTH
Flavaco 2-15	NE 1/4 Sec. 22 T22N 20W	Mano Verde	5226

Shut in casing head pressure, ²⁰⁹ 117 hours	- - - - -	1050
Shut in tubing pressure, ²⁰⁹ 117 hours	- - - - -	1050
Rock pressure, psi.	- - - - -	
Time Well opened	- - - - -	10:30 AM
Time Well gauged	- - - - -	1:30 PM
Total time open	- - - - -	3 Hrs.
Size of casing	- - - - -	7"
Size of tubing	- - - - -	1.5"
Size of test nipple	- - - - -	5"
Type gauge used	- - - - -	Spring
Impact pressure	- - - - -	21 PSI
Side static pressure	- - - - -	
Initial potential, MCF in 24 hours	- - - - -	215 MCF

Tested by Wm L. Johnson Jr
 Title Asst. Field Eng.

Witnessed by _____
 Title _____



OIL CONSERVATION COMMISSION
AZTEC DISTRICT OFFICE

No. Copies Received **5**

DISTRIBUTION

	NO. FURNISHED	
Operator	3	
Santa Fe	1	
Proration Office		
State Land Office		
U. S. G. S.		
Transporter		
File	1	<input checked="" type="checkbox"/>

NEW MEXICO OIL CONSERVATION COMMISSION
Santa Fe, New Mexico

REQUEST FOR (OIL) - (GAS) ALLOWABLE

New Well
Recompletion

This form shall be submitted by the operator before an initial allowable will be assigned to any completed Oil or Gas well. Form C-104 is to be submitted in QUADRUPLICATE to the same District Office to which Form C-101 was sent. The allowable will be assigned effective 7:00 A.M. on date of completion or recompletion, provided this form is filed during calendar month of completion or recompletion. The completion date shall be that date in the case of an oil well when oil is delivered into the stock tanks. Gas must be reported on 15.025 psia at 60° Fahrenheit.

Farmington, New Mexico

Feb. 17, 1954

(Place)

(Date)

WE ARE HEREBY REQUESTING AN ALLOWABLE FOR A WELL KNOWN AS:

Balhi Oil Corporation

Flamingo

Well No. 2-45

in SW

1/4

NE

1/4

(Company or Operator)

(Lease)

6

Sec. 22

T. 30 N

R. 8 W

NMPM, Flamingo

Pool

(Unit)

San Juan

County. Date Spudded 11-25-53

Date Completed 2-5-54

Please indicate location:

		<u>1550'</u>	
		<u>1500'</u>	

Elevation 6000 M Total Depth 5226 P.B. _____

Top oil/gas pay 1500 Top of Prod. Form None Visible

Casing Perforations: None or _____

Depth to Casing shoe of Prod. String 1500

Natural Prod. Test _____ BOPD

based on _____ bbls. Oil in _____ Hrs _____ Mins.

Test after acid or shot _____ BOPD

Based on _____ bbls. Oil in _____ Hrs _____ Mins.

Gas Well Potential Open Flow - 115 M

Size choke in inches 2"

Date first oil run to tanks or gas to Transmission system: Not connected as of 2/17/54

Transporter taking Oil or Gas: Southern Union Gathering Co.

Casing and Cementing Record

Size	Feet	Sax
<u>10-3/4"</u>	<u>168</u>	<u>200</u>
<u>7"</u>	<u>1380</u>	<u>200</u>
<u>2.9"</u>	<u>3881</u>	<u>100</u>

Remarks: Well SI - not connected as of 2/17/54

I hereby certify that the information given above is true and complete to the best of my knowledge.

Approved: J-19, 1954

Balhi Oil Corporation

(Company or Operator)

By: J. B. Howell
(Signature)

Title: Supt.

Send Communications regarding well to:

Name: Balhi Oil Corporation

Address: Corrigan Tower, Dallas, Texas

OIL CONSERVATION COMMISSION

Original Filed _____

By: John J. Adams

Title: Assistant Secretary

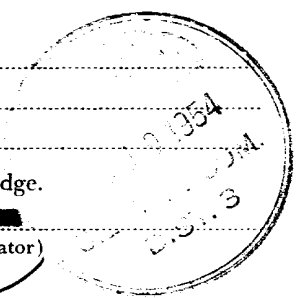

OIL CONSERVATION COMMISSION
AZTEC DISTRICT OFFICE

No. Copies Received **4**

DISTRIBUTION

	No. DISTRIBUTED	
Operator	1	
Santa Fe	1	
Exploration Office		
State Land Office		
U. S. G. S.		
Transporter		<input checked="" type="checkbox"/>
File	1	