

NEW MEXICO OIL CONSERVATION COMMISSION

Santa Fe, New Mexico

Oral Approval received January 20, 1955

NOTICE OF INTENTION TO DRILL OR RECOMPLETE

Notice must be given to the District Office of the Oil Conservation Commission and approval obtained before drilling or recompletion begins. If changes in the proposed plan are considered advisable, a copy of this notice showing such changes will be returned to the sender. Submit this notice in **QUINTUPPLICATE**. One copy will be returned following approval. See additional instructions in Rules and Regulations of the Commission.

Farmington, New Mexico
(Place)**January 20, 1955**
(Date)OIL CONSERVATION COMMISSION
SANTA FE, NEW MEXICO

Gentlemen:

You are hereby notified that it is our intention to commence the (Drilling) (Recompletion) of a well to be known as

El Paso Natural Gas Company

(Company or Operator)

Dalhi State

(Lease)

Well No. **1**, in **K** (Unit) The well islocated **1650** feet from the **South** line and **1650** feet from the**West****South****30** line and **80****SW**, NMPM.

(GIVE LOCATION FROM SECTION LINE)

Blanco

Pool,

San Juan

County

If State Land the Oil and Gas Lease is No. **E-1641-3**

If patented land the owner is

Address

We propose to drill well with drilling equipment as follows: **Rotary tools through the Mesa Verde drilling the way with gas circulation.**The status of plugging bond is **Statewide**Drilling Contractor **Cox Drilling Co.**We intend to complete this well in the **Mesa Verde**formation at an approximate depth of **4855** feet.

D	C	B	A
E	F	G	H
L	X K	J	I
M	N	O	P

Elev. 5690'±, 5700'±

CASING PROGRAM

We propose to use the following strings of Casing and to cement them as indicated:

Size of Hole	Size of Casing	Weight per Foot	New or Second Hand	Depth	Sacks Cement
12 3/4	9 5/8	36	New	170	
8 3/4	7	23	New	4140	

If changes in the above plans become advisable we will notify you immediately.

ADDITIONAL INFORMATION (If recompletion give full details of proposed plan of work.)

Communication. Anyhow filed with the State

oil fracture **Cliff House and Point Lookout formations.**

The W/2 of Section 16 is dedicated to this well.

E-1193-3 (SESW)**B-1093-35 (SESW, NWSW)****E-1193-4 (SESW)****B-10938-34 (W/2SW, NWSW)****E-1641-3 (SESW)**

Sincerely yours,

Approved....., 19.....

Except as follows:

ORIGINAL SIGNED BY

OIL CONSERVATION COMMISSION

By **S. V. Roberts**

Title

El Paso Natural Gas Company

(Company or Operator)

By **S. V. Roberts**Position **Petroleum Engineer**

Send Communications regarding well to

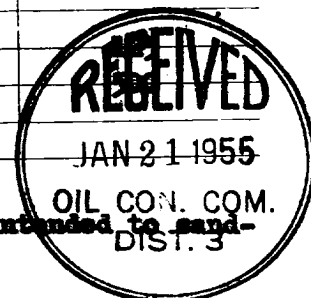
Name **E. J. Coel**Address **Box 997****Farmington, New Mexico**

COMPANY EL PASO NATURAL GAS COMPANY

Well Name & No. DELHI-STATE NO. 1

Lease No. E-1641-3

Location 1650 FEET FROM THE SOUTH LINE, 1650 FEET FROM THE WEST LINE

Corner to NE/4 OF THE SW/4

Sec. 16, T 30 N., R. 8 W., N.M.M. SAN JUAN COUNTY, NEW MEXICO

Ground Elevation 5690.42

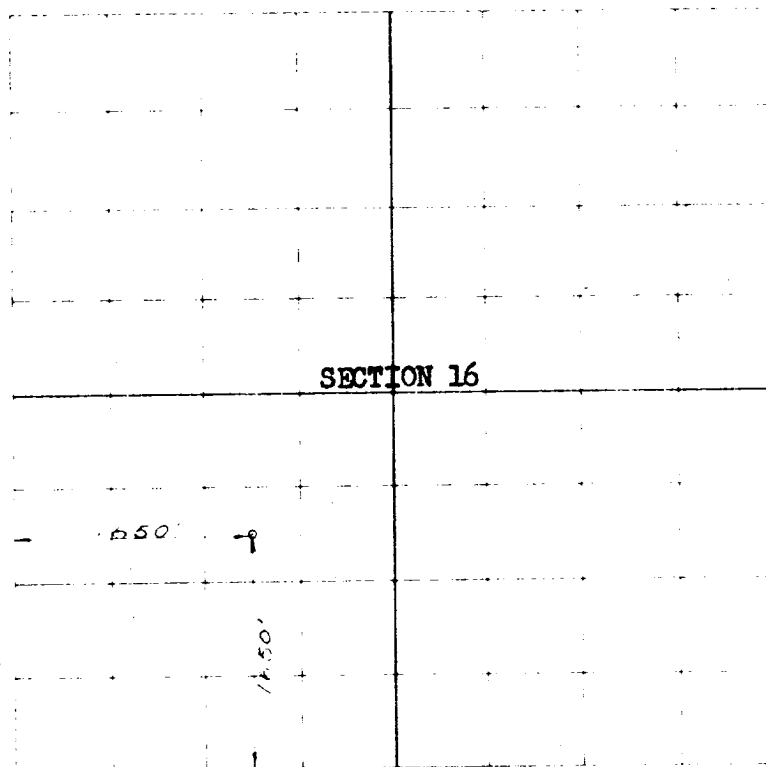

Scale -- 4 inches equals 1 mile

Surveyed OCTOBER 30, 1953

This is to certify that the above plat was prepared from field notes of actual survey and that the same are true and correct to the best of my knowledge and belief.

C.O. Walker

Registered Professional
Engineer and Land Surveyor

Seal

Elmington, New Mexico

320 ACRES ACCORDING TO GOVERNMENT SURVEY PLAT



OIL CONSERVATION COMMISSION		
AZTEC DISTRICT OFFICE		
No. Copies Received <u>7</u>		
DISTRIBUTION		
	NO. FURNISHED	
Operator	<u>2</u>	
Santa Fe	<u>1</u>	
Proration Office		
State Land Office		
U. S. G. S.		
Transporter		
File	<u>1</u>	<input checked="" type="checkbox"/>