

NEW MEXICO OIL CONSERVATION COMMISSION
Santa Fe, New Mexico

NOTICE OF INTENTION TO DRILL OR RECOMPLETE

Notice must be given to the District Office of the Oil Conservation Commission and approval obtained before drilling or recompletion begins. If changes in the proposed plan are considered advisable, a copy of this notice showing such changes will be returned to the sender. Submit this notice in QUINTUPLICATE. One copy will be returned following approval. See additional instructions in Rules and Regulations of the Commission.

Albuquerque, New Mexico

(Place)

July 5, 1955

(Date)

OIL CONSERVATION COMMISSION
SANTA FE, NEW MEXICO

Gentlemen:

You are hereby notified that it is our intention to commence the (Drilling) (~~Recompletion~~) of a well to be known as

Pubco Development, Inc., et al

(Company or Operator)

State

(Lease)

Well No. 19

N $\frac{1}{2}$

(Unit)

The well is

located 990 feet from the North line and 990 feet from the

East

line of Section 2

T. 30N

R. 8W

NMPM.

(GIVE LOCATION FROM SECTION LINE)

Blanco Mesaverde

Pool,

San Juan

County

If State Land the Oil and Gas Lease is No. E-5184 - 40 Ac. - Pubco
E-5382 - 240 Ac. - Texas Co.
B-10603 - 40 Ac. - Pac. Northwest Pipeline Corp.

We propose to drill well with drilling equipment as follows: Rotary tools to the top of the Mesaverde formation; and complete with rotary in the Mesaverde.

The status of plugging bond is \$10,000 Blanket Bond previously approved and on file with the Commission

Drilling Contractor Contract not awarded

We intend to complete this well in the Mesaverde formation at an approximate depth of 5600 feet.

CASING PROGRAM

We propose to use the following strings of Casing and to cement them as indicated:

Size of Hole	Size of Casing	Weight per Foot	New or Second Hand	Depth	String
13-3/4"	10-3/4"	32.75#	New	200'	150
9"	7"	20# & 23#	New	5000'	250

If changes in the above plans become advisable we will notify you immediately.

ADDITIONAL INFORMATION (If recompletion give full details of proposed plan of work.) It is proposed to drill with rotary to the top of the Mesaverde formation, estimated to be at a depth of 4600', and thereafter to drill with gas through the Mesaverde or to the top of the Mancos shale. It is further proposed to selectively sand-oil frac the Cliffhouse and Point Lookout formations. The N $\frac{1}{2}$ of the Section is designated as the drilling unit.

Approved JUL 8 1955, 19.....
Except as follows:

ORIGINAL SIGNED BY

OIL CONSERVATION COMMISSION

By S. V. Roberts

Title

PETROLEUM ENGINEER DIST. NO. 3

Sincerely yours,

PUBCO DEVELOPMENT, INC.

(Company or Operator)

By Frank D. Gorham, Jr.

Vice President

Position Send Communications regarding well to

Name Pubco Development, Inc.

Address Post Office Box 1419

Albuquerque, New Mexico

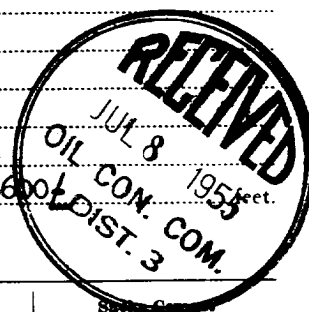

Company Pubco Development Co.

Lease Pubco et al State Well No. 19

Sec. 2 T. 30 N R. 8 W N.W.P.M.

Location 990 feet from north line; 990 feet from east line.

Elevation: 6397 GL

San Juan County

New Mexico

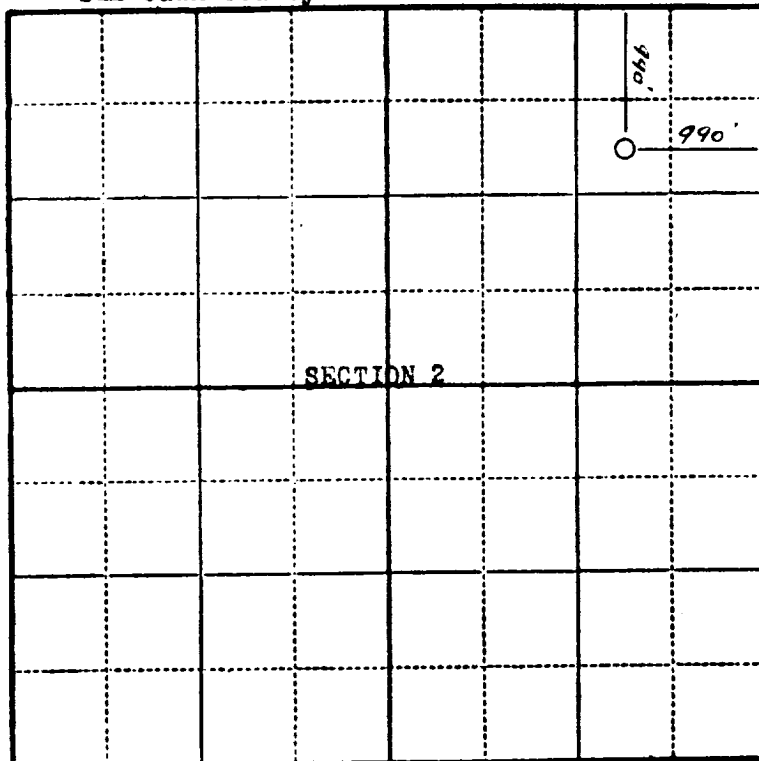

Scale--4 inches equal 1 mile.

This is to certify that the above plat was prepared from field notes of actual surveys made by me or under my supervision and that the same are true and correct to the best of my knowledge and belief.

Stephen H. Kinney
STEPHEN H. KINNEY
Registered Professional
Engineer and Land Surveyor



Surveyed June 27, 1955

Seal:

OIL CONSERVATION COMMISSION
AZTEC DISTRICT OFFICE

No. Copies Received 6

DISTRIBUTION

	NO. FURNISHED	
Operator <u>H.</u>	<u>1</u>	
Santa Fe	<u>1</u>	
Proration Office	<u>1</u>	
State Land Office	<u>2</u>	
U. S. G. S.		
Transporter	<u>1</u>	<input checked="" type="checkbox"/>
File		