

NO. OF COPIES RECEIVED	
DISTRIBUTION	
SANTA FE	/
FILE	/
U.S.G.S.	/
LAND OFFICE	/
OPERATOR	/

# NEW MEXICO OIL CONSERVATION COMMISSION

Form C-101  
Revised 1-1-65

5A. Indicate Type of Lease
STATE <input type="checkbox"/> FEE <input checked="" type="checkbox"/>
5. State Oil & Gas Lease No.

## APPLICATION FOR PERMIT TO DRILL, DEEPEN, OR PLUG BACK

1a. Type of Work		7. Unit Agreement Name	
b. Type of Well		8. Farm or Lease Name	
DRILL <input checked="" type="checkbox"/> DEEPEN <input type="checkbox"/> PLUG BACK <input type="checkbox"/>		9. Well No.	
OIL WELL <input type="checkbox"/> GAS WELL <input checked="" type="checkbox"/> OTHER <input type="checkbox"/> SINGLE ZONE <input checked="" type="checkbox"/> MULTIPLE ZONE <input type="checkbox"/>		10. Field and Pool, or Wildcat	
2. Name of Operator		12. County	
PAN AMERICAN PETROLEUM CORPORATION		San Juan	
3. Address of Operator		19. Proposed Depth	
P. O. Box 480, Farmington, New Mexico		6100'	
4. Location of Well		19A. Formation	
UNIT LETTER <b>N</b> LOCATED <b>790</b> FEET FROM THE <b>South</b> LINE		Bakota	
AND <b>990</b> FEET FROM THE <b>West</b> LINE OF SEC. <b>29</b> TWP. <b>29-N</b> RGE. <b>12-W</b> NMPM		20. Rotary or C.T.	
		Rotary	
21. Elevations (Show whether DF, RT, etc.)		22. Approx. Date Work will start	
Report Later		October 1, 1965	
21A. Kind & Status Plug. Bond		21B. Drilling Contractor	
Statewide		Arapahoe	

23.

## PROPOSED CASING AND CEMENT PROGRAM

SIZE OF HOLE	SIZE OF CASING	WEIGHT PER FOOT	SETTING DEPTH	SACKS OF CEMENT	EST. TOP
12-1/4"	8-5/8"	24.4	350'	250	Surface
7-7/8"	4-1/2"	10.54	6100'	1500*	Surface*
*Stage cementing tool to be used at base of Mesaverde.					

Completion will be as indicated upon reaching total depth.  
Copies of location plat are attached.  
Copies of logs run will be furnished upon completion of well.



IN ABOVE SPACE DESCRIBE PROPOSED PROGRAM: IF PROPOSAL IS TO DEEPEN OR PLUG BACK, GIVE DATA ON PRESENT PRODUCTIVE ZONE AND PROPOSED NEW PRODUCTIVE ZONE. GIVE BLOWOUT PREVENTER PROGRAM, IF ANY.

I hereby certify that the information above is true and complete to the best of my knowledge and belief.

Signed G. W. Eaton, Jr. Title Area Engineer Date September 27, 1965  
(This space for State Use)

APPROVED BY [Signature] APPROVAL VALID 90 DAYS DATE 9-24-65  
CONDITIONS OF APPROVAL, IF ANY: FOR 90 DAYS UNLESS DRILLING COMMENCED,

EXPIRES 12-24-65

**NEW MEXICO OIL CONSERVATION COMMISSION  
WELL LOCATION AND ACERAGE DEDICATION PLAT**

All distances must be from the outer boundaries of the Section

Operator <b>PAN AMERICAN PETROLEUM CORPORATION</b>			Lease <b>GALLEGOS CANYON UNIT</b>		Well No. <b>200</b>
Unit Letter <b>M</b>	Section <b>29</b>	Township <b>29 NORTH</b>	Range <b>12 WEST</b>	County <b>SAN JUAN</b>	
Actual Footage Location of Well: <b>790</b> feet from the <b>SOUTH</b> line and <b>990</b> feet from the <b>WEST</b> line					
Ground Level Elev. <b>Report Later</b>	Producing Formation <b>Dakota</b>		Pool <b>Basin Dakota</b>	Dedicated Acreage: <b>320</b> Acres	

1. Outline the acreage dedicated to the subject well by colored pencil or hachure marks on the plat below.
2. If more than one lease is dedicated to the well, outline each and identify the ownership thereof (both as to working interest and royalty),
3. If more than one lease of different ownership is dedicated to the well, have the interests of all owners been consolidated by communitization, unitization, force-pooling, etc?

( X ) Yes ( ) No If answer is "yes," type of consolidation Unitization

If answer is "no," list the owners and tract descriptions which have actually consolidated. (Use reverse side of this form if necessary.)

No allowable will be assigned to the well until all interests have been consolidated (by communitization, unitization, forced-pooling, or otherwise) or until a non standard unit, eliminating such interests has been approved by the Commission.

Ref: GLO plat dated April 7, 1881.

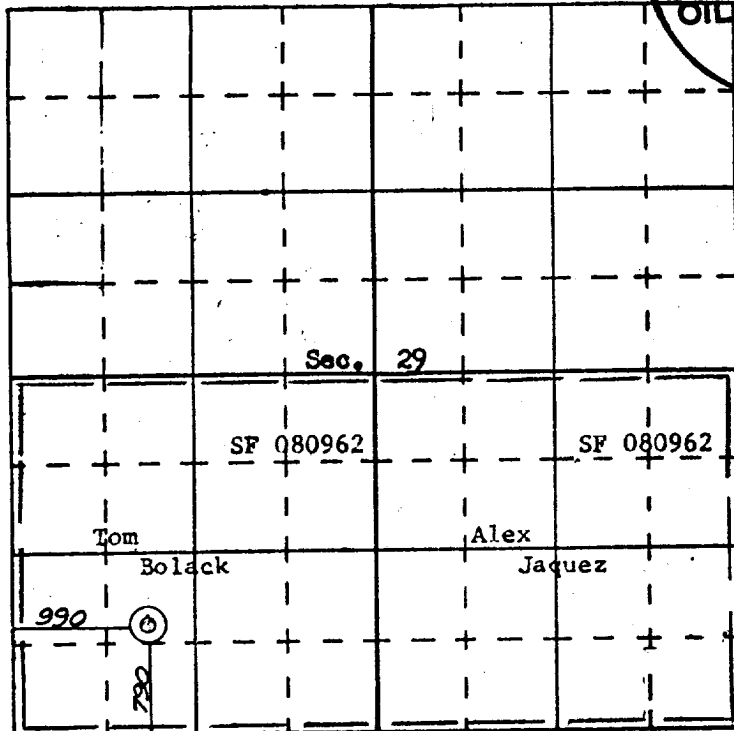

**RECEIVED**  
SEP 29 1965  
OIL CON. COM.  
DIST. 3

**CERTIFICATION**

I hereby certify that the information contained herein is true and complete to the best of my knowledge and belief.

G. W. Eaton, Jr.  
Name  
Area Engineer  
Position  
Pan American Petroleum Corp.  
Company  
September 27, 1965  
Date

I hereby certify that the well location shown on this plat was plotted from field notes of actual surveys made by me or under my supervision, and that the same is true and correct to the best of my knowledge and belief.

September 11, 1965  
Date Surveyed  
James P. Leese  
Registered Professional Engineer  
and/or Land Surveyor

**James P. Leese**  
San Juan Engineering Company  
Certificate No. **1463**